

INSTALLATION GUIDE

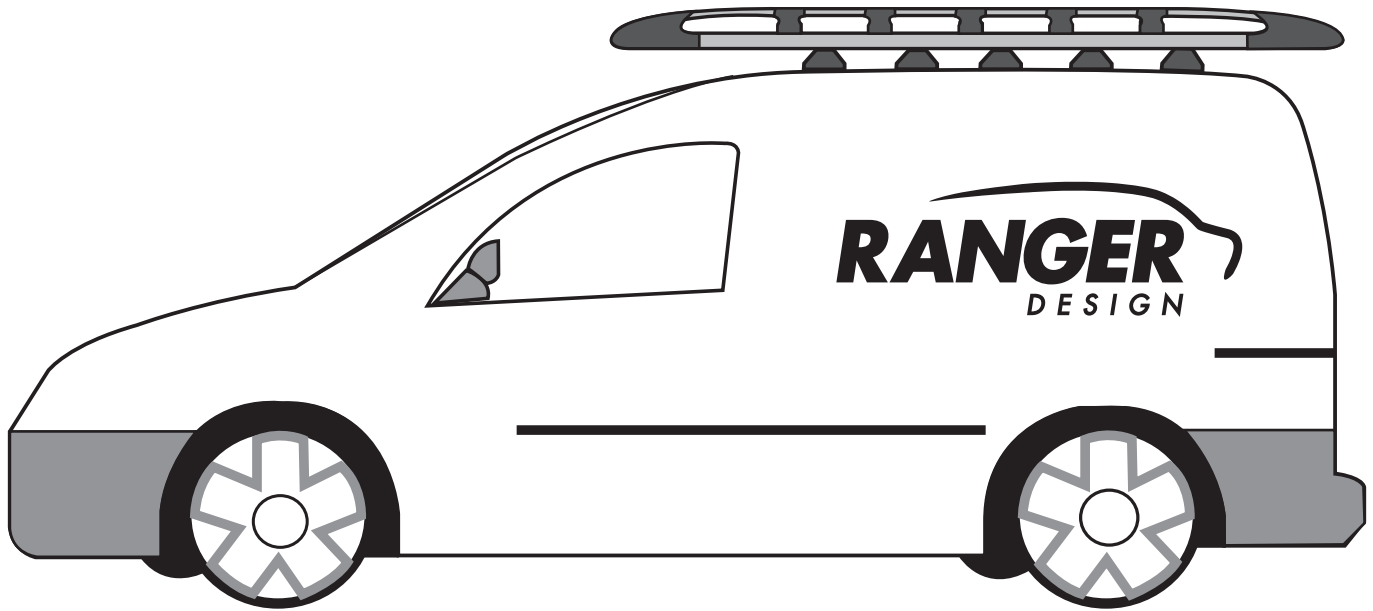

1506-DH Cargo Plus

Sprinter 170" LWB & 170" EWB Wheelbase



PHASE 1 – ASSEMBLY

1.1 SETUP

1.1.2 Verify all parts are present.

15-U4012 BOX

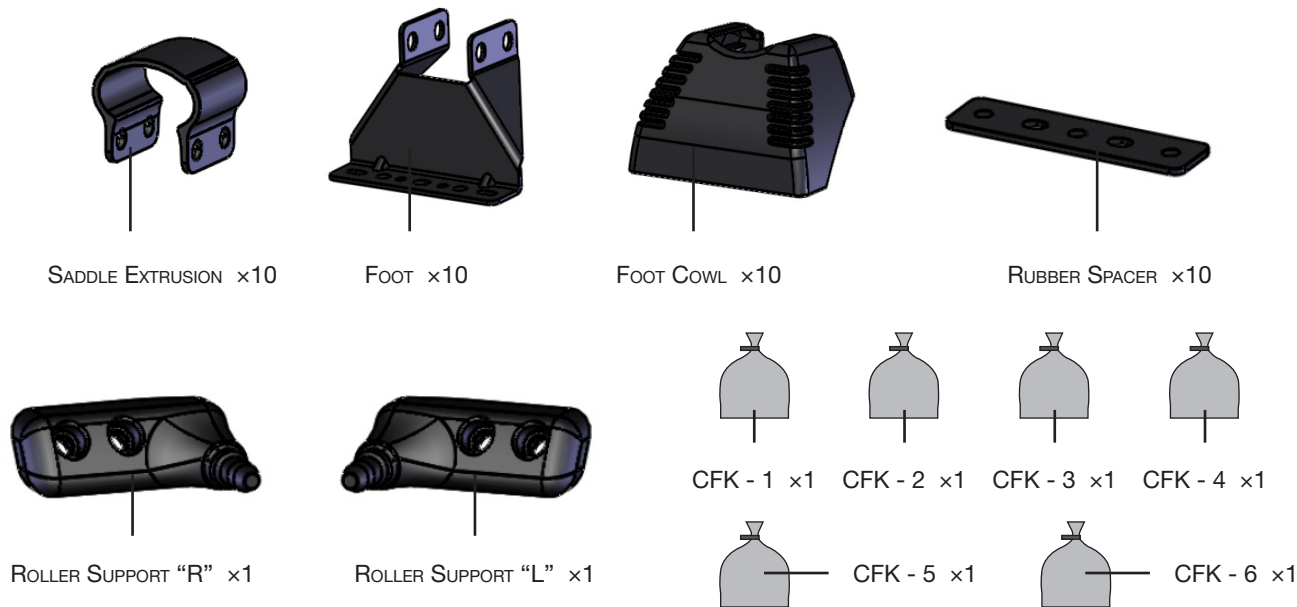

15-U1005 BOX

SIDE RAILS

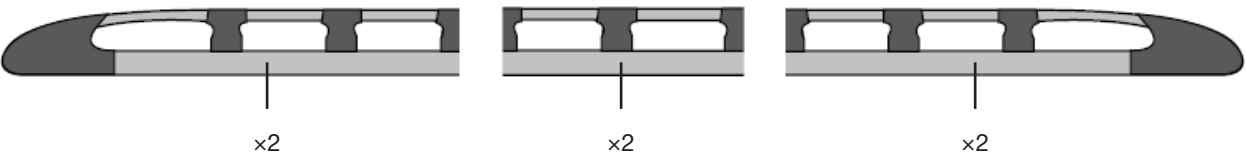

15-U3002 BOX

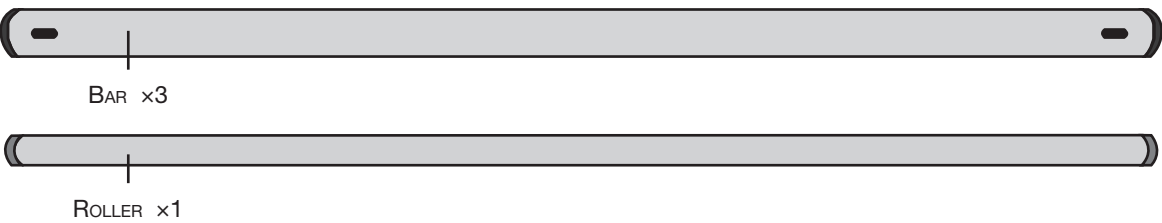

15-U2002 BOX

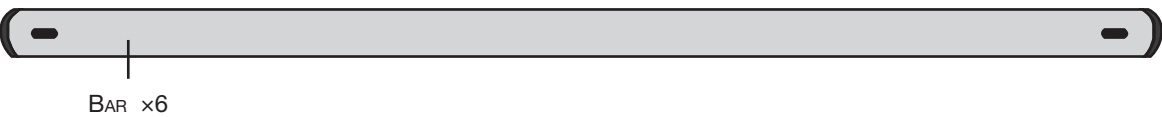

HARDWARE

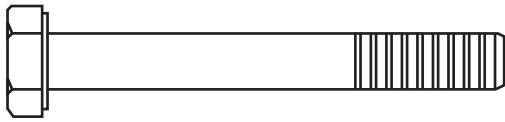

(M8 × 65) ×20



(M8 × 25) ×10



(M8 × 25) ×10



(M8 × 25) ×34



(M8) ×32

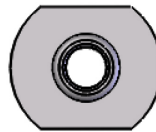

(M8) ×22

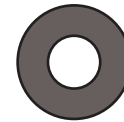

(M8) ×50



(M8) ×4

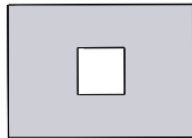

(M8) ×4

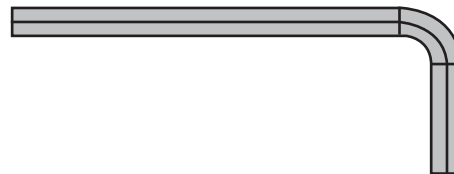

(M8) ×1

REQUIRED ITEMS

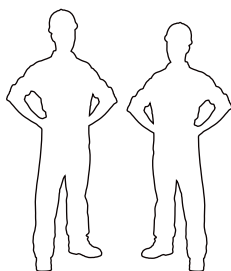

**2
PERSONS**

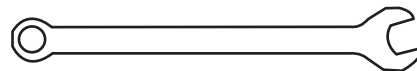

13mm ×2

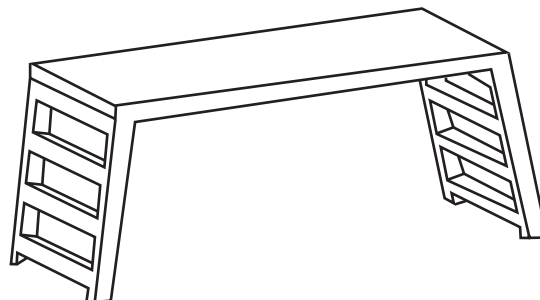

PHASE 2 – INSTALLATION

2.1 INSTALLATION

2.1.1 Install the feet.

W/O OEM TRACK

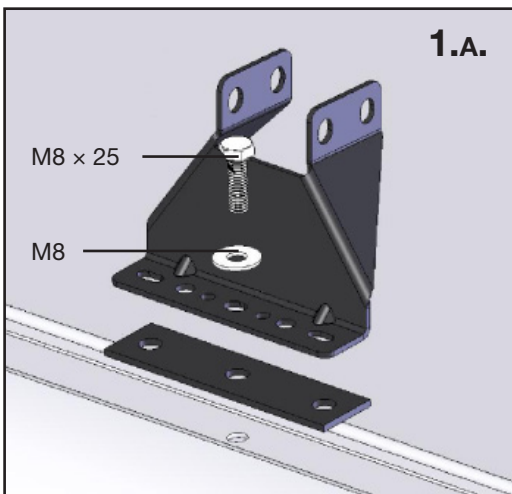
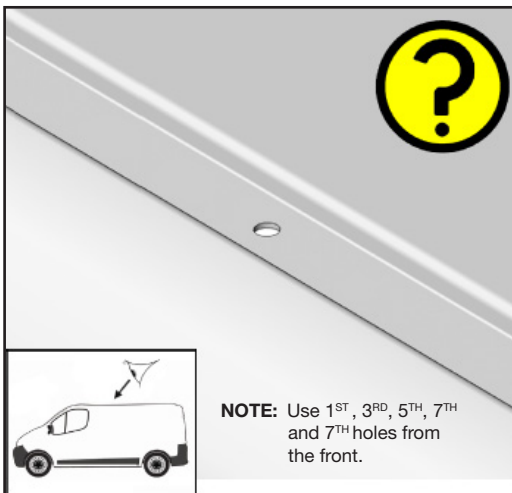

INSIDE

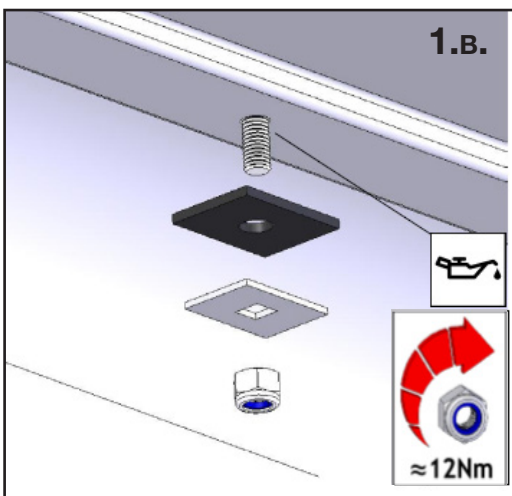

WITH OEM TRACK

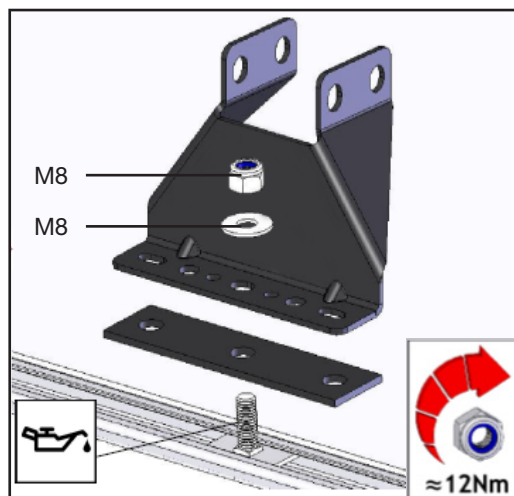
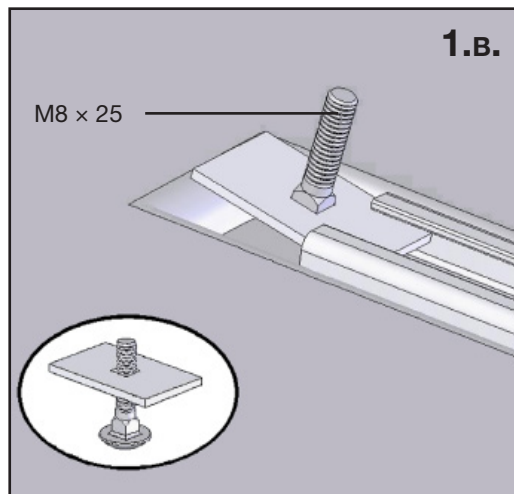
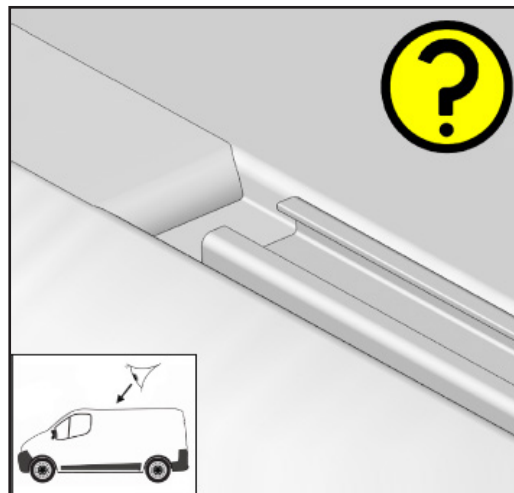

2.1.2 Connect the 2 half side rails.

2x

STEP 1

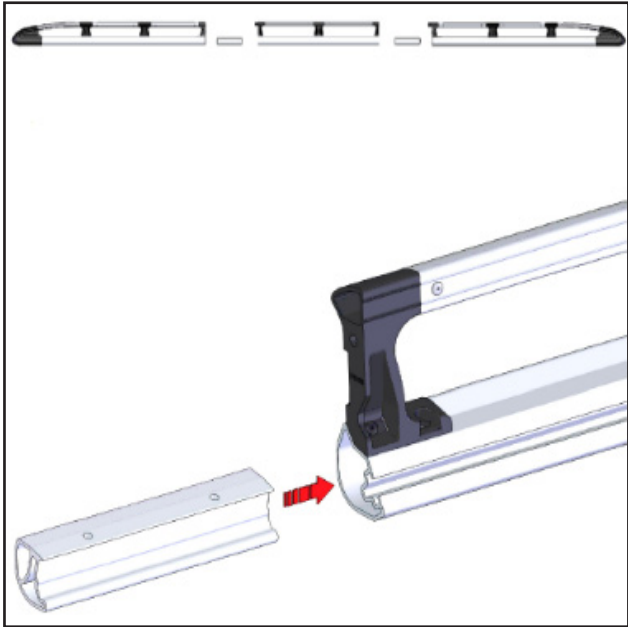

STEP 2

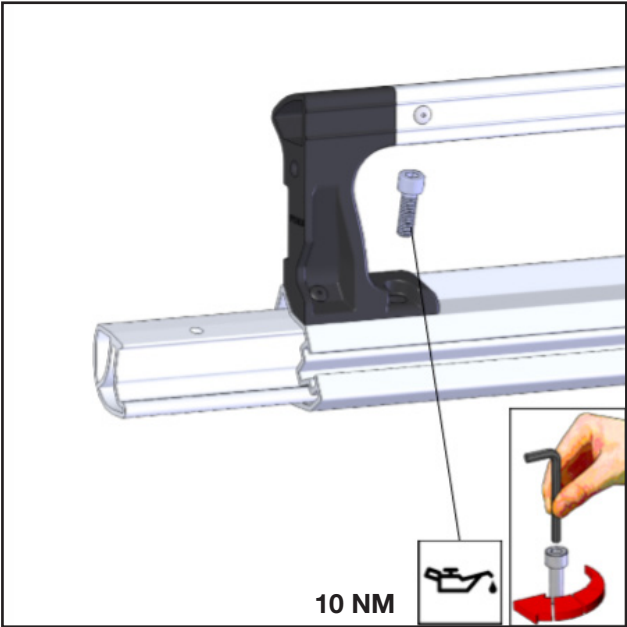

STEP 3

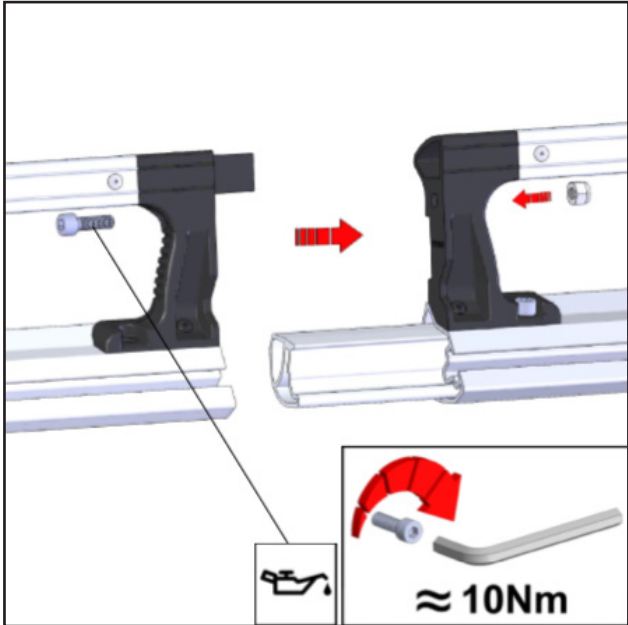

STEP 4

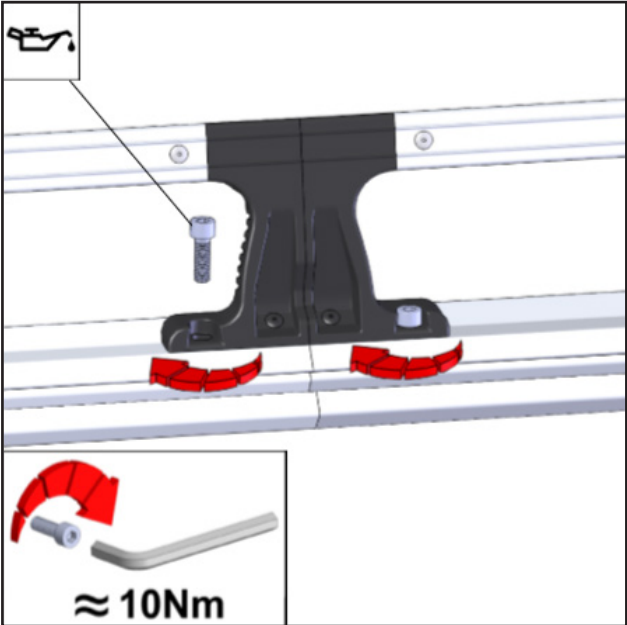

2.1.3 Install 5 bars in the feet.

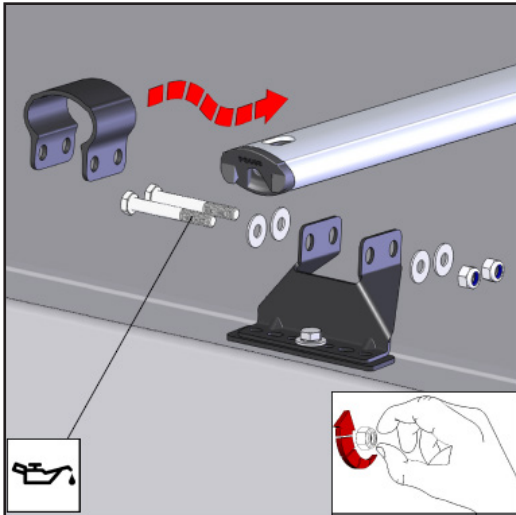

2.1.4 Slide 11 pcs. of channel nuts in each side rails.

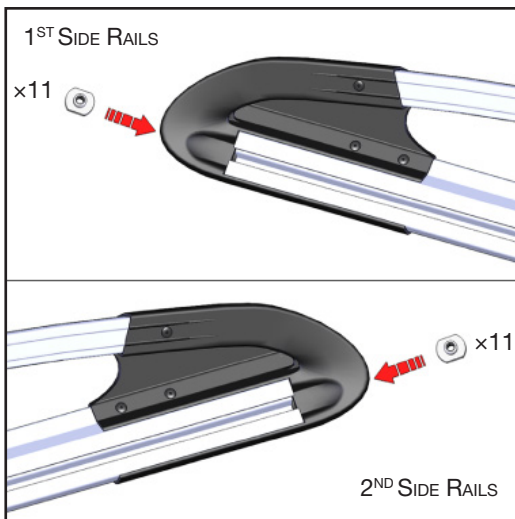

2.1.5 Attach the 2 side rails on both ends of the bar, using the 2ND, 4TH, 6TH, 8TH & 9TH Channel nuts from the front.

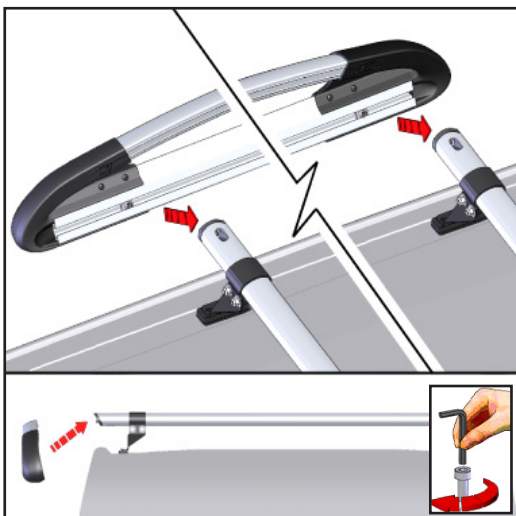

2.1.6 Attach the roller to the side rails using the 2 last channel nuts from the front.

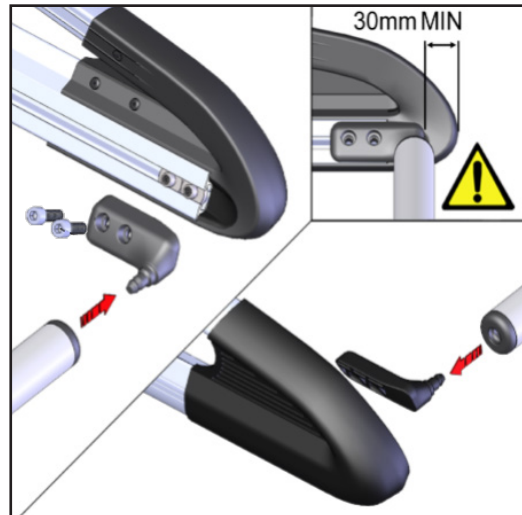

2.1.7 Slide the rack to the appropriate position.

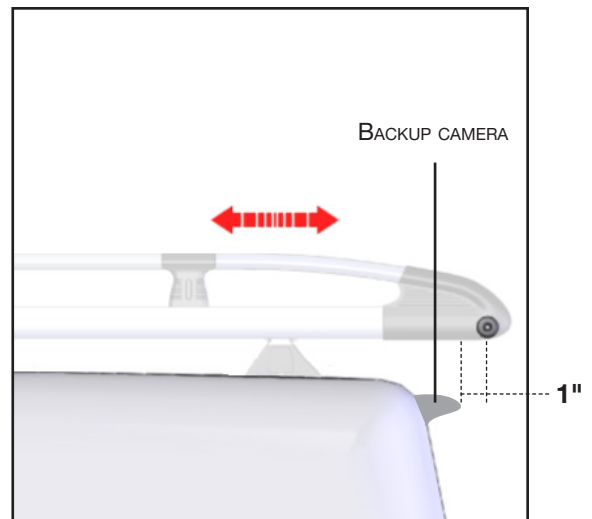

2.1.8 Center the bar on the vehicle.

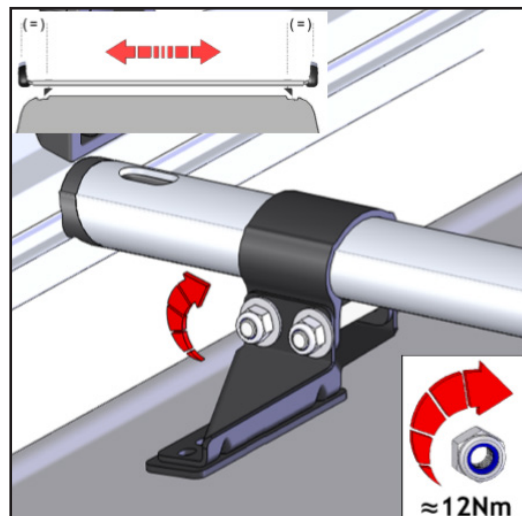

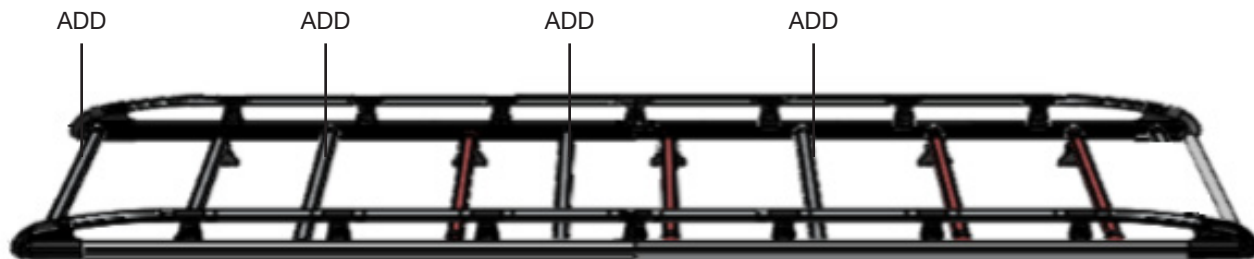

2.1.9 Attach the 4 bar.

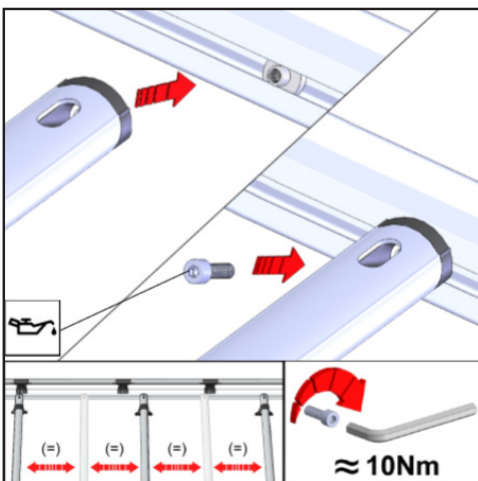

2.1.10 Attach the foot cowl to the foot.

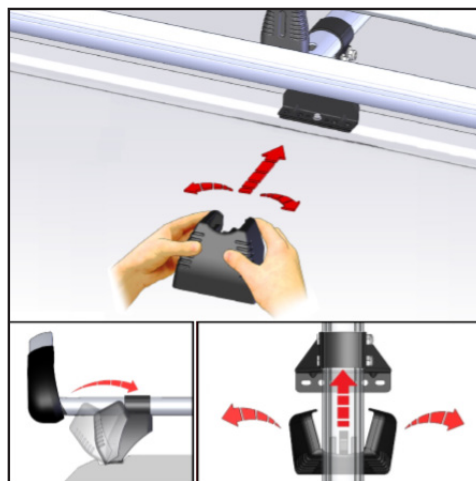

PHASE 3 – TIPS

3.1 SAFETY TIPS

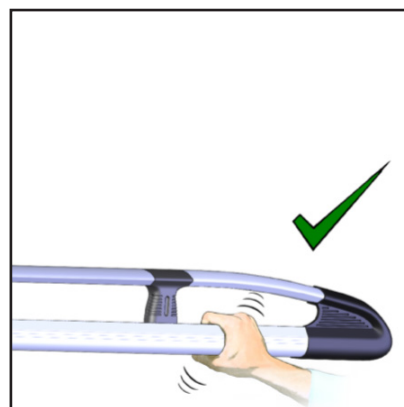
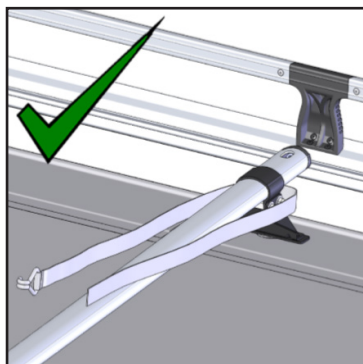
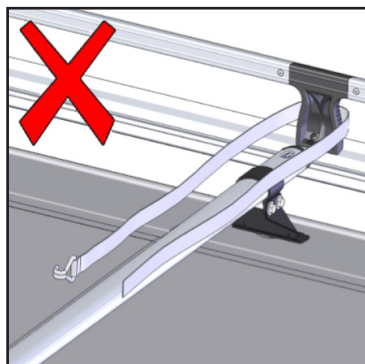
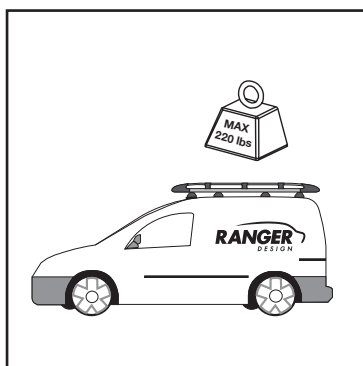
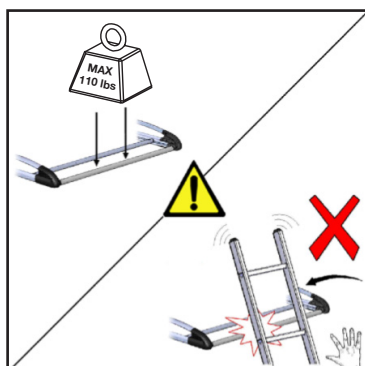

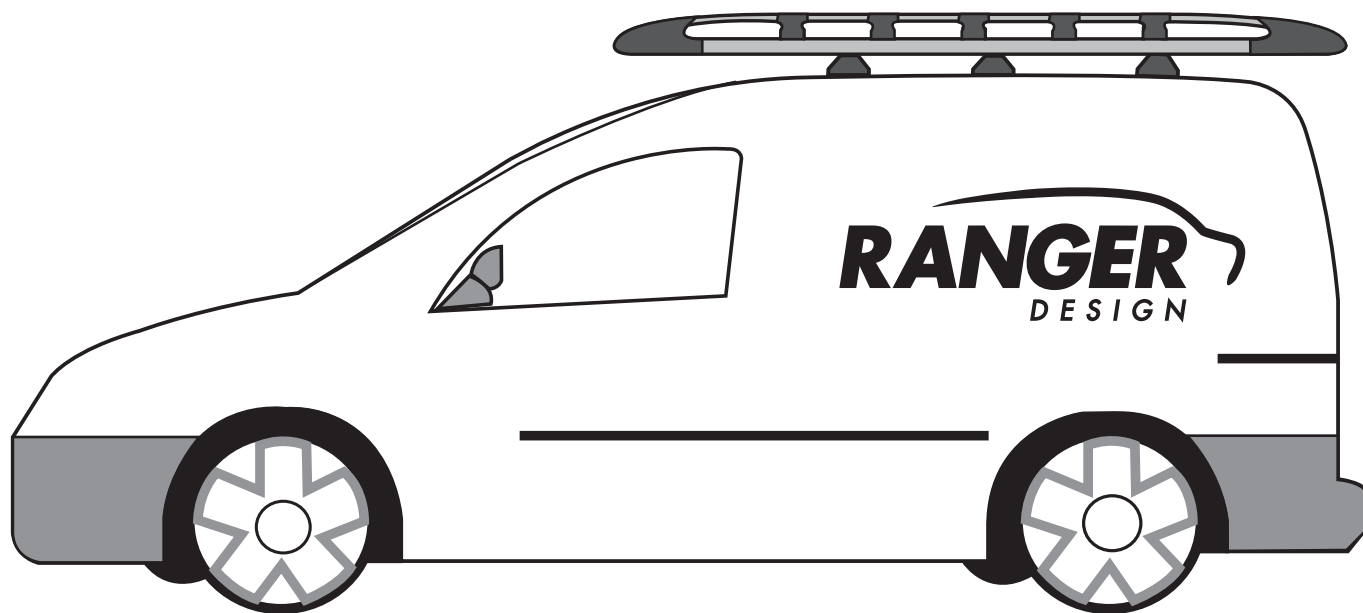

**“You have successfully installed your
1506-DH Cargo Plus**

Thank you for doing business with us.”

For any feedback or suggestions you may have, please contact: cs@rangerdesign.com

