

# PRIME DESIGN™

A Safe Fleet Brand



## 2014+ Ram ProMaster Low/High Roof Base Mounting Kit

Page 2	Packaging Contents
Pages 3-7	L1H1 (118" Wheelbase)
Pages 8-12	L2H1 (136" Wheelbase)
Pages 13-16	L2H2 (Med Roof/136" Wheelbase)
Pages 17-21	L4H2 (159" Wheelbase)
Pages 22-26	L5H2 (159+" Wheelbase, Ext.)

# FBM-1007

**CONTENTS OVERVIEW****TWO & THREE CROSSBAR CONFIGURATIONS**

**NOTE:** This Manual contains information covering two and three Crossbar configurations. If your model is a two Crossbar configuration, disregard all Center Crossbar installation information.



1—FBM-1007 ..... (Qty 1)  
Channels, 117.50" w/Hardware Kits

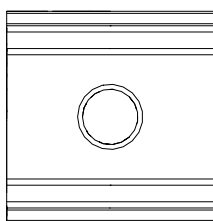

Aluminum Strip Nut (6X)



42" Channels (2X)



24" Channels (2X)



66" Channels (2X)

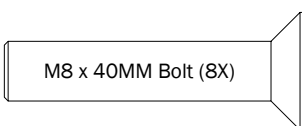

M8 x 40MM Bolt (8X)



Top Connector (4X)



Bottom Connector (4X)



Brackets (6X)



Mountings (8X)



End Caps (8X)



Screws (16X)

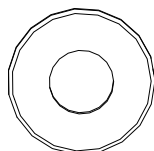

5/16" Flat Washer (6X)



5/16" Lock Washer (6X)

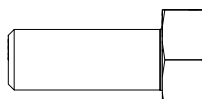

M8 x 20MM (6X)

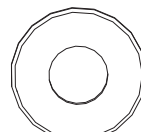

1/4" Flat Washer (8X)



M6 Locknut (8X)

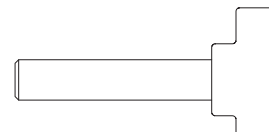

M6 T-Bolt (8X)

2—Crossbars (shown for illustrative purposes only)  
Ordered separately

ErgoRack, Gen4

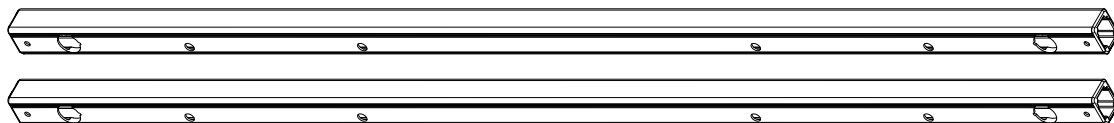

AluRack

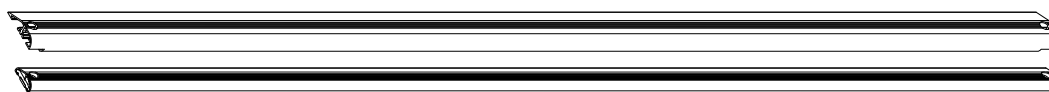

ERGORACK  
CONFIGURATION

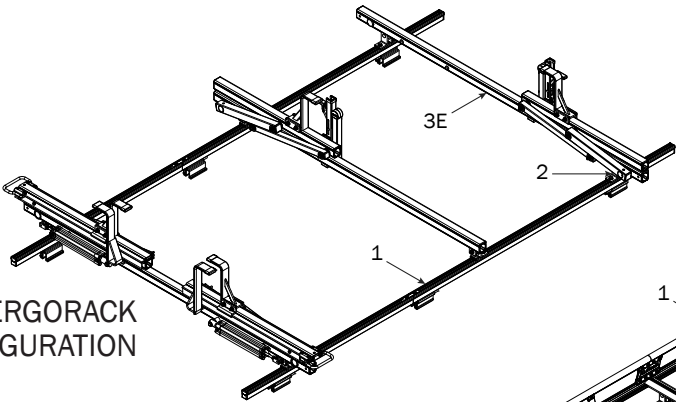

ALURACK  
CONFIGURATION

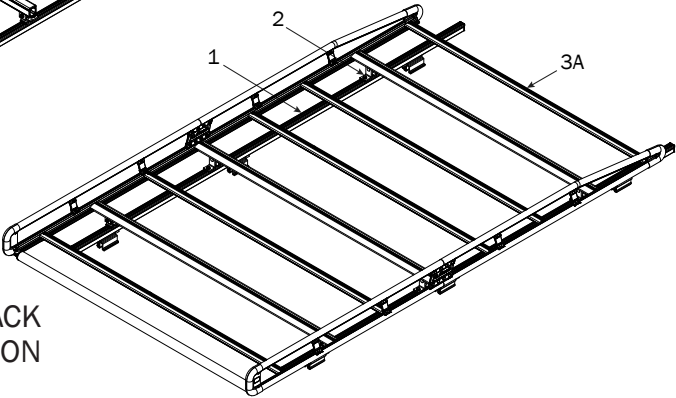

NOTE: Base, Rotation, Crossbar, and Side Rail features are shown for illustrative purposes only. These features are not included with this Base Mounting Kit, and must be purchased separately.

### CHANNEL MOUNTINGS

NOTE: Channel Mountings must be disassembled for installation onto the vehicle's roof.

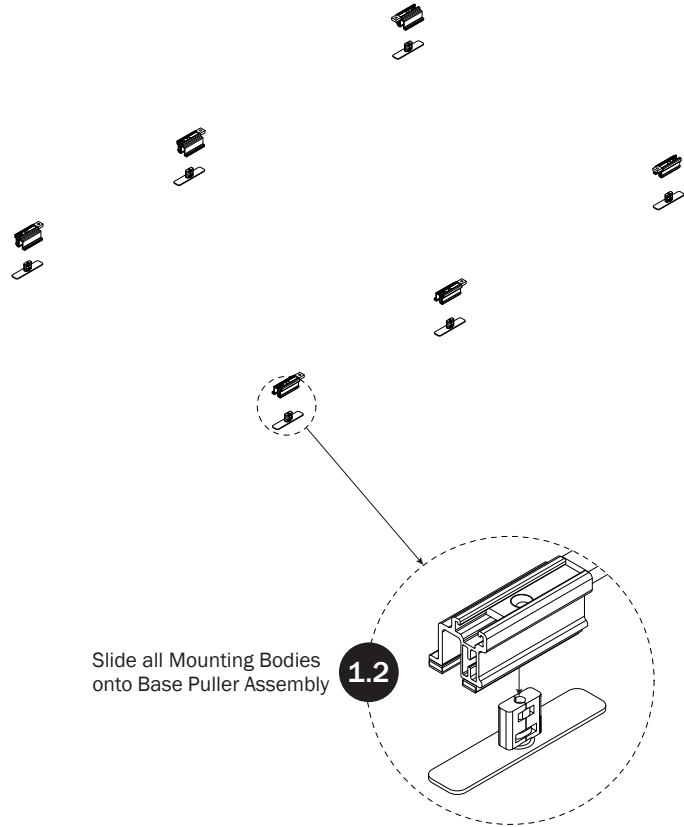
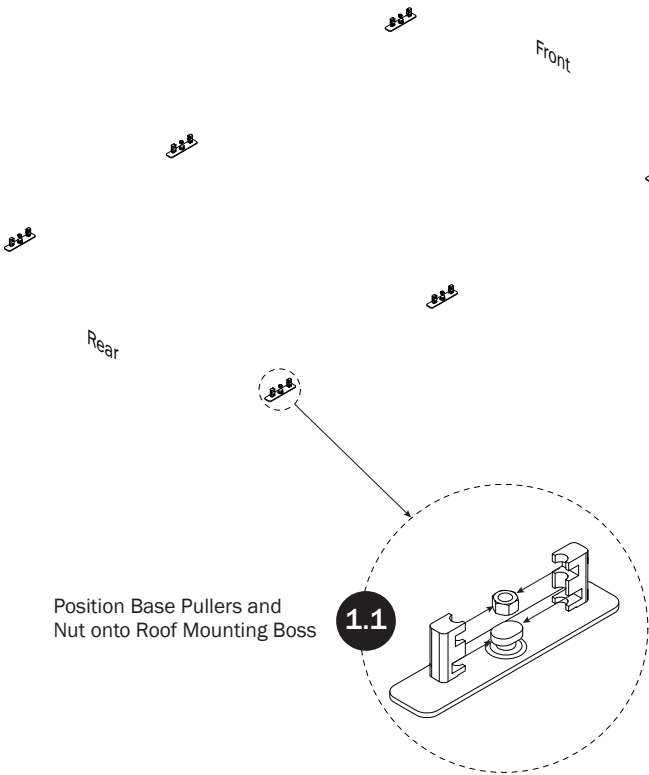

1.3

Slide and position the Channel Connector into the Mounting Body as shown, then screw the 30MM Flat Head bolt into the Base Puller.

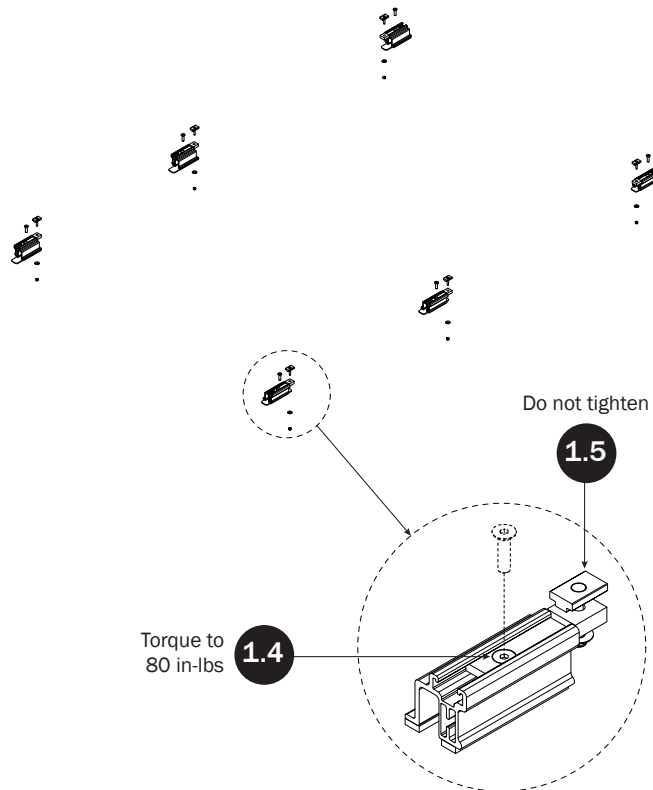

Do not tighten

1.5

Torque to  
80 in-lbs

1.4

1.6

Slide Channels onto  
Mounting Brackets

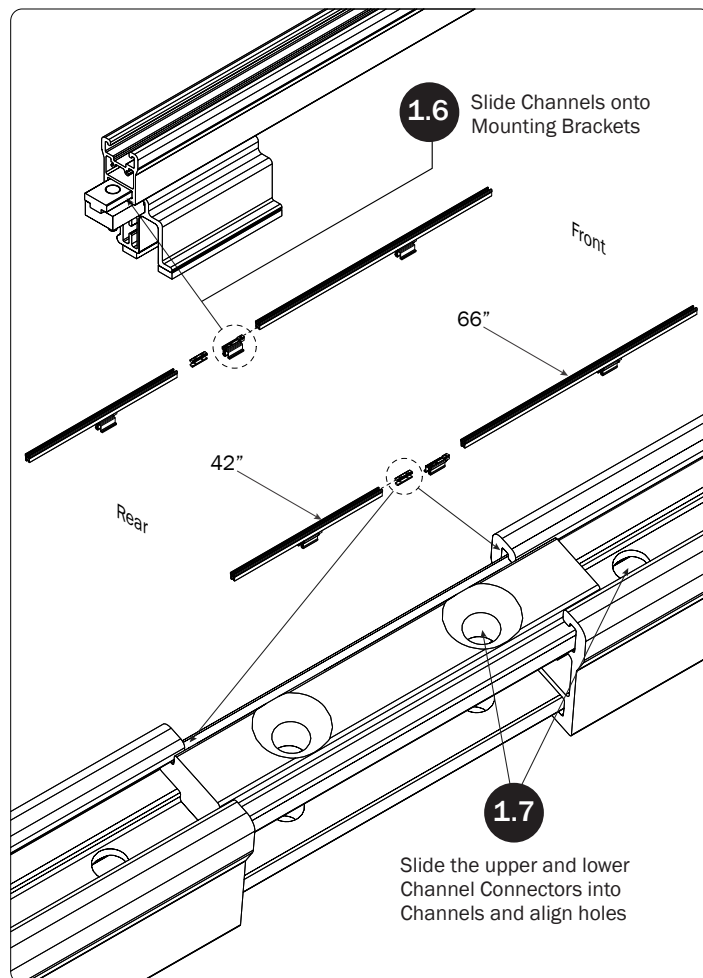

66"

42"

Rear

Front

1.7

Slide the upper and lower  
Channel Connectors into  
Channels and align holes

1.8

Screw the M8 x 40MM Allen Head bolts into the Upper and Lower Channel Splices. Due to tight manufacturing tolerances, both bolts must remain loose until Step 1.9

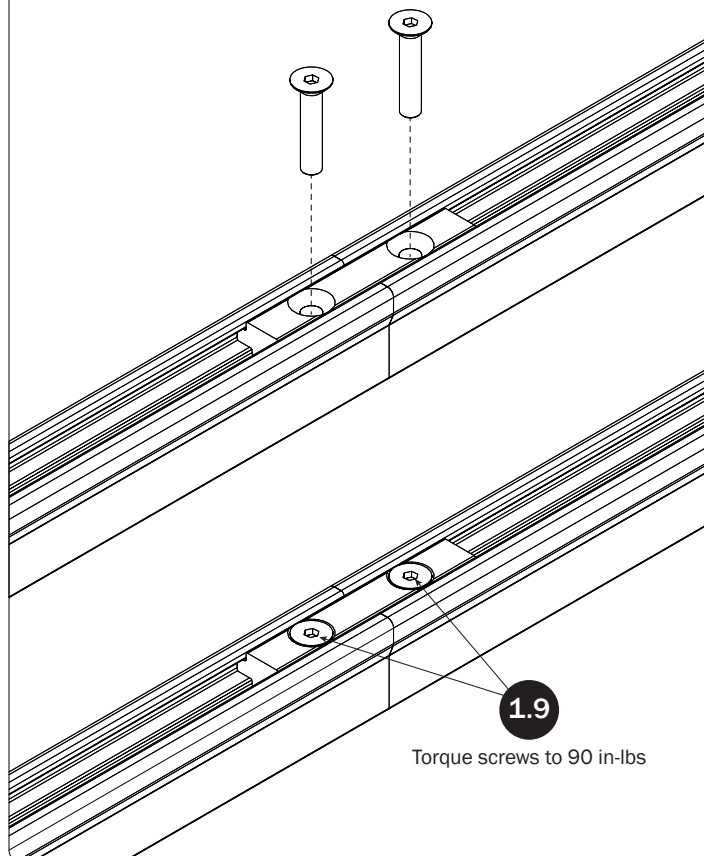

1.9

Torque screws to 90 in-lbs

1.10

Set to distances shown below, then torque Mounting  
Bracket nuts loosened at Step 1.5 to 80 in-lbs

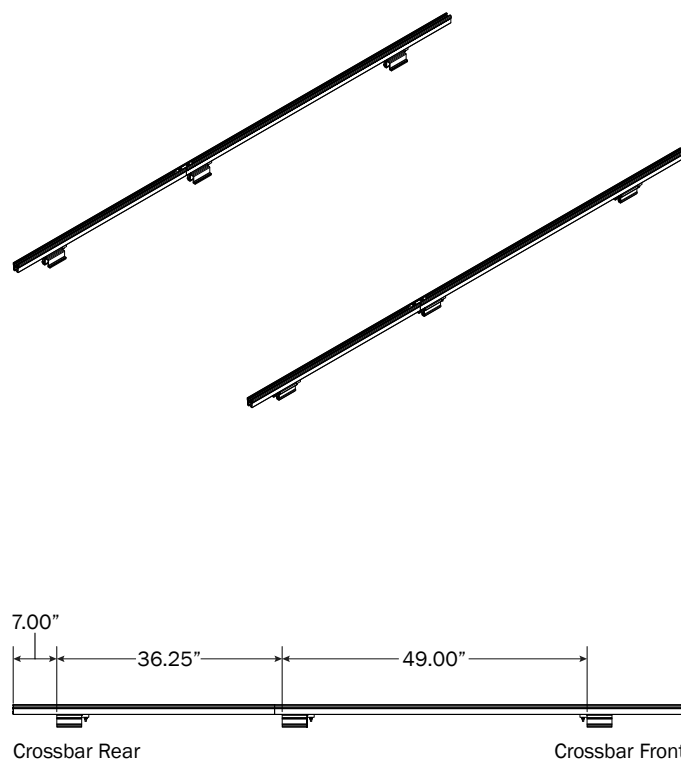

7.00"

36.25"

49.00"

Crossbar Rear

Crossbar Front



## MOUNTING BRACKETS

- 2.1** Slide the Aluminum Strip Nuts into each end of the Channels, and attach the Channel Caps

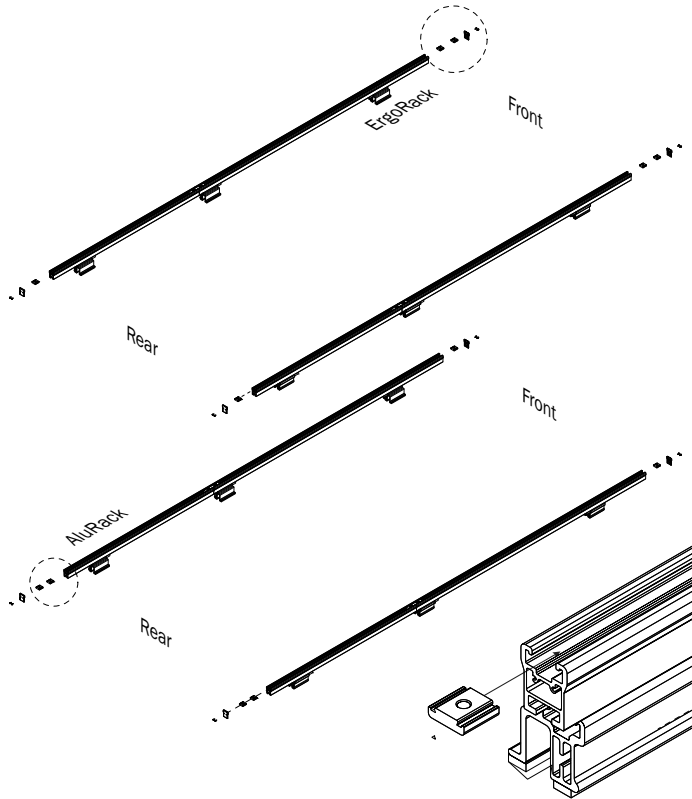

- 2.2** Using the supplied fastening hardware, attach the Crossbar Mounting Brackets into the Aluminum Strip Nuts placed into the Channels at Step 2.1

3 Crossbar models:

Position the center Mounting Brackets as shown for ErgoRack or AluRack models.

\*2 & 3 Crossbar models: Position the front Mounting Brackets as shown.

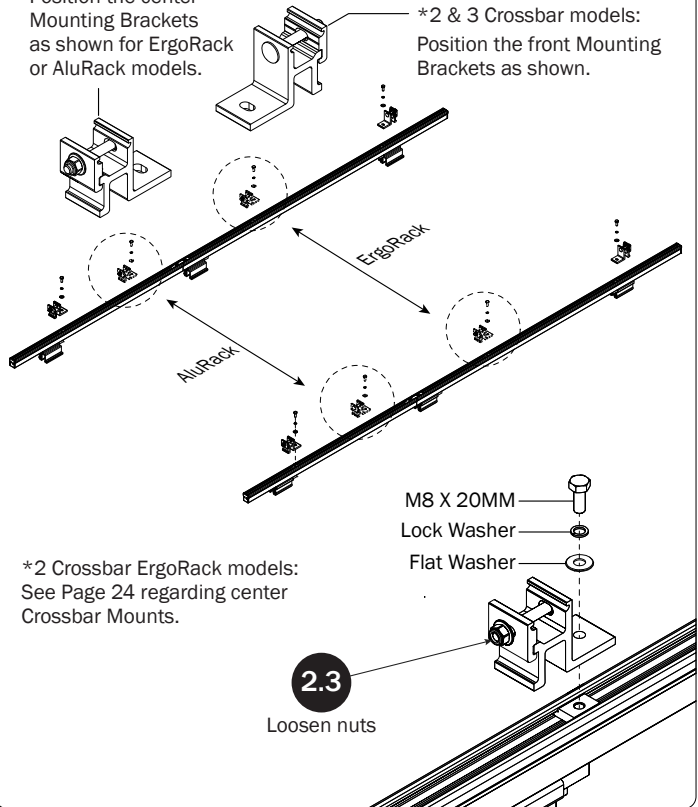

\*2 Crossbar ErgoRack models: See Page 24 regarding center Crossbar Mounts.

- 2.4** Set to distances shown below:  
Use Dimensions A for 2 Crossbar models.  
Use Dimensions B for 3 Crossbar models.

Do not torque the Crossbar Mounting Brackets until Step 3.4. Finger-tighten them into designated dimension to hold them in place, then proceed to your Feature (FEA) Assembly Manual.

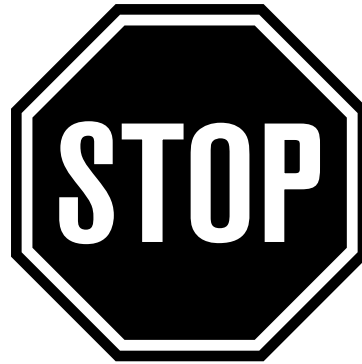
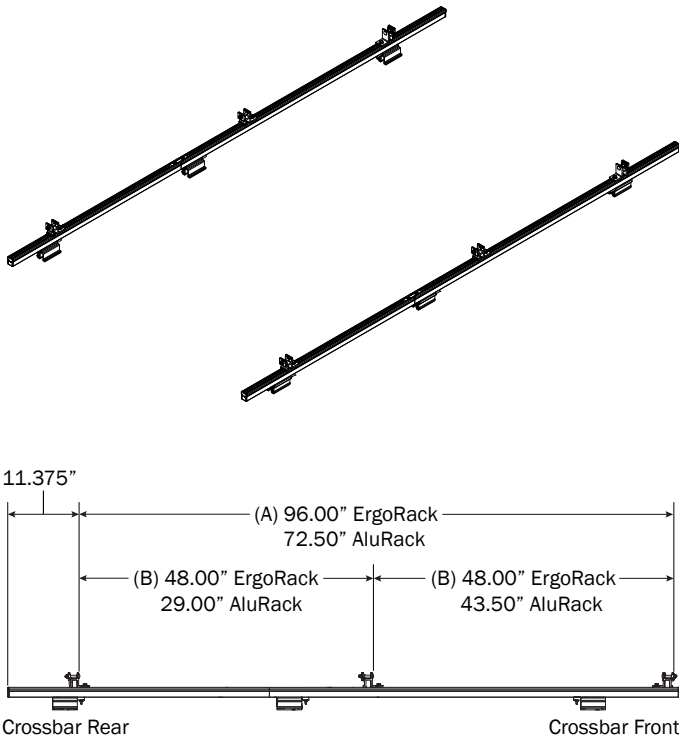

Do not mount the Crossbars to this FBM system at this time.

Refer to the respective FEA or AR Assembly Manual(s) included with your chosen rack configuration features. Depending upon the features chosen, you may need to perform a complete feature assembly onto the Crossbars or Side Rails as noted in that feature's Assembly Manual.

**WARNING:** Failure to position the Crossbars as shown in this FBM Assembly Manual may result in damage to the sliding door and/or ladder rack.

**NOTE:** Crossbars, Side Rails, Base, Clamp Down, or Rotation features are not included in this FBM kit, and must be purchased separately. To purchase applicable features and accessories, please contact your authorized distributor, or a Prime Design Sales & Service Representative.

## CROSSBARS (ERGORACK)

Shown with LH Base, and RH Rotation for illustrative purposes only

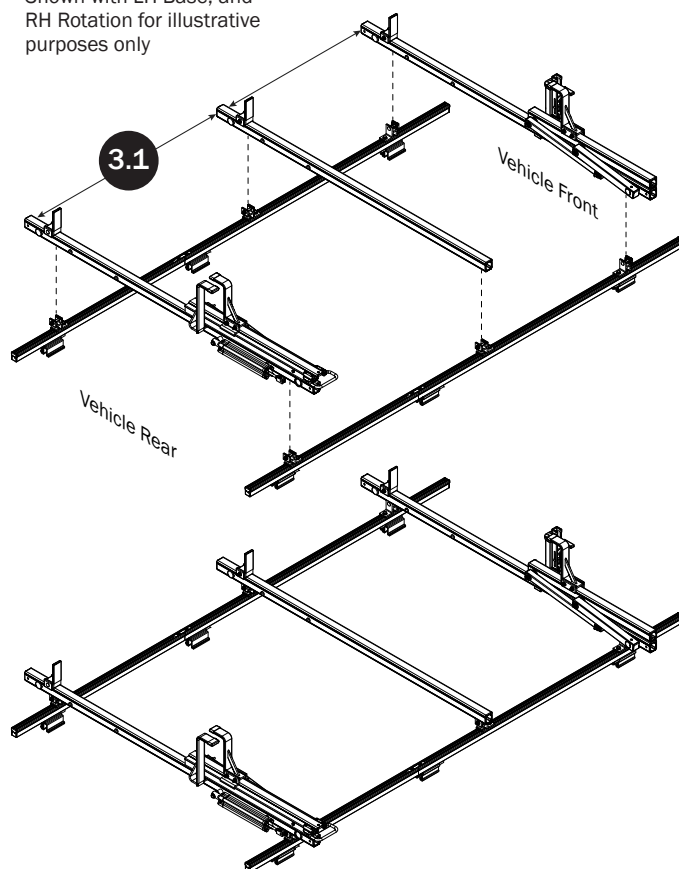

## CROSSBAR ADJUSTMENT

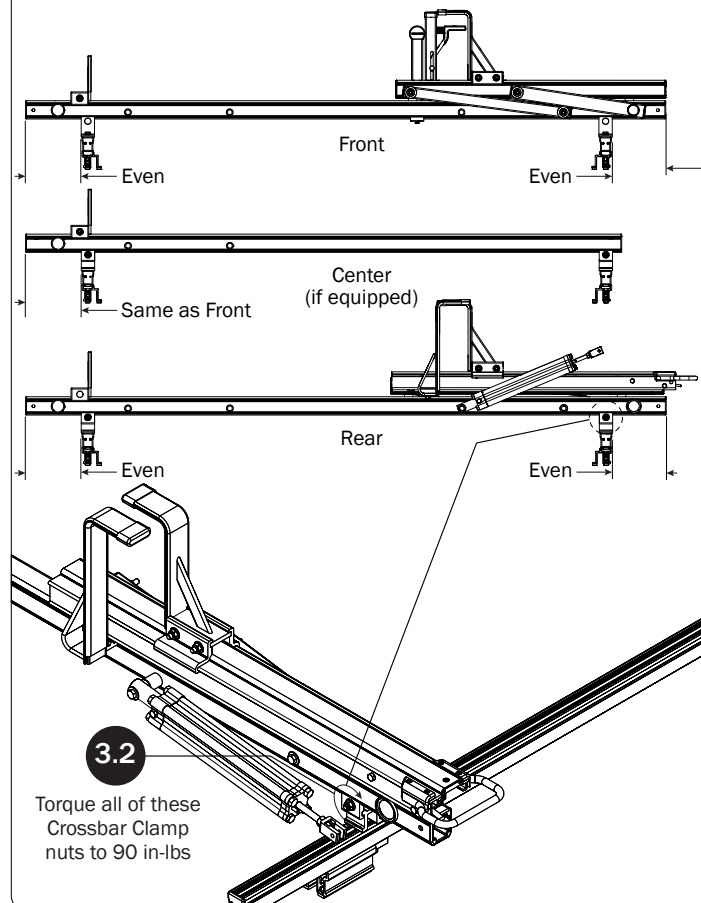

3.3

Verify the specified distance from the ends of both Mounting Bracket to the ends of both Channels.

11.375"

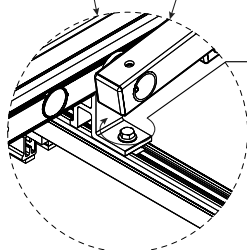
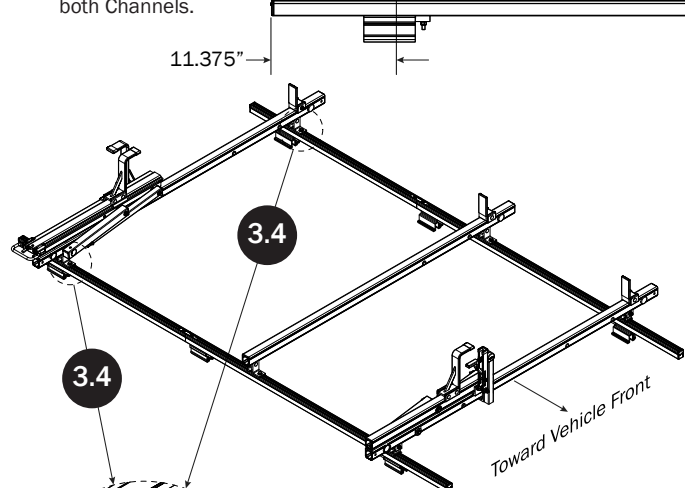

Torque only the Rear Crossbar Mounting Bracket bolts to 90 in-lbs at this time.

The Center (if equipped) and Front Crossbar Mounting Brackets will be torqued to specification when designated in the respective Feature (FEA) Assembly Manual.

## CROSSBARS (ALURACK)

Shown with L1H1 AluRack  
for illustrative purposes only

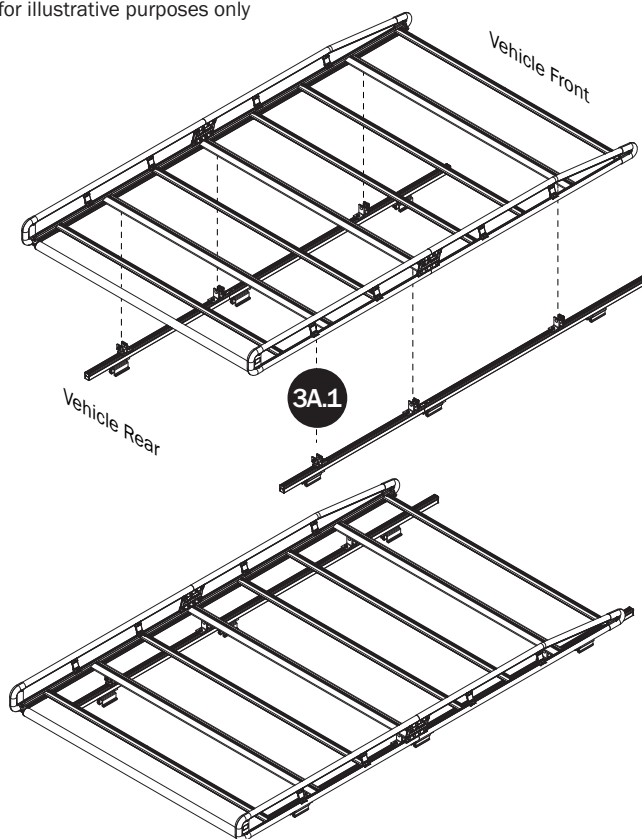

## CROSSBAR ADJUSTMENT

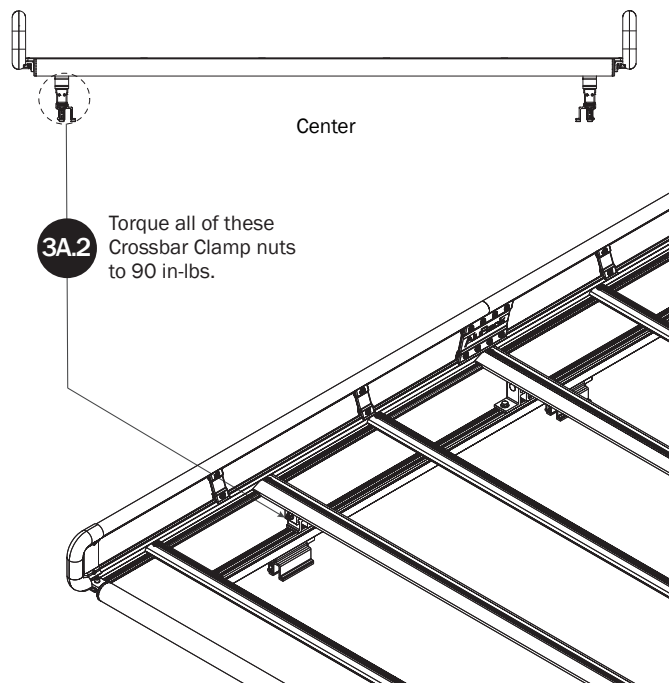

3A.3

Verify the specified  
distance from the  
ends of both Mounting  
Bracket to the ends of  
both Channels.

11.375"

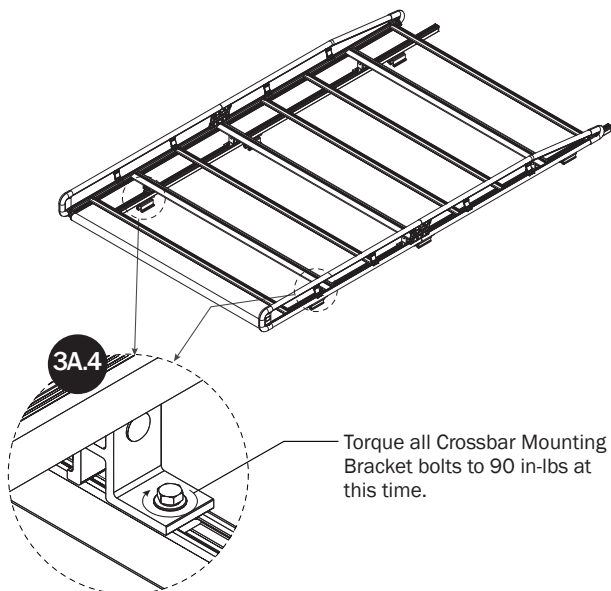

# L2H1 (136.00") FBM ASSEMBLY SEQUENCE

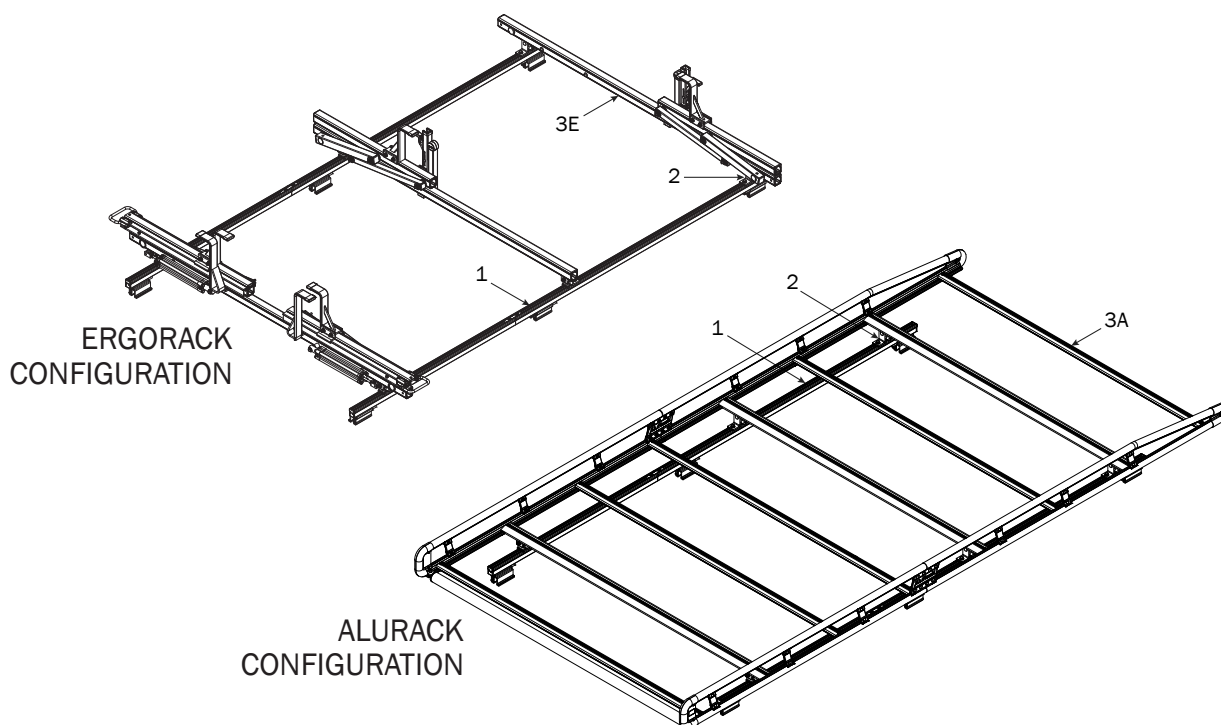

NOTE: Base, Rotation, Crossbar, and Side Rail features are shown for illustrative purposes only. These features are not included with this Base Mounting Kit, and must be purchased separately.

## CHANNEL MOUNTINGS

NOTE: Channel Mountings must be disassembled for installation onto the vehicle's roof.

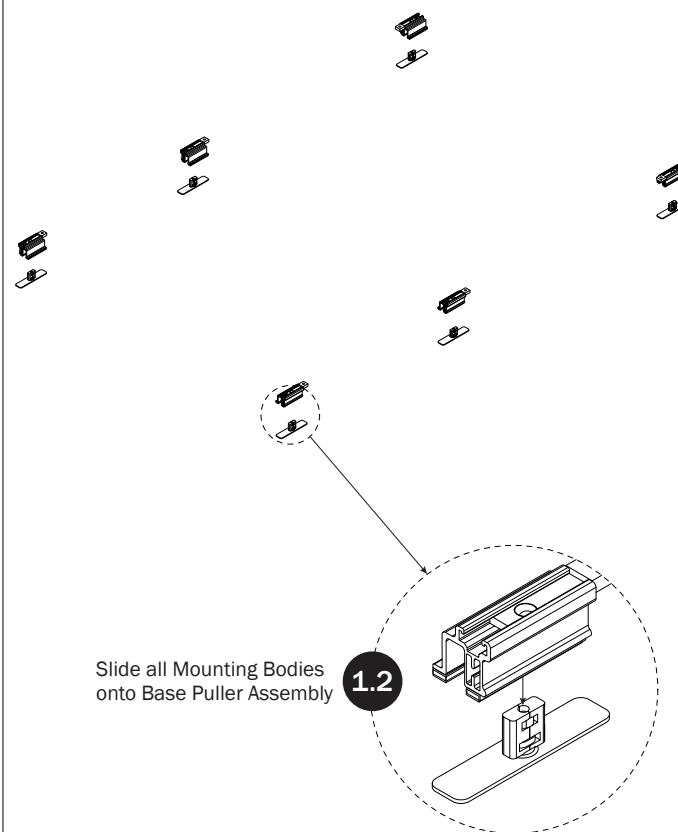
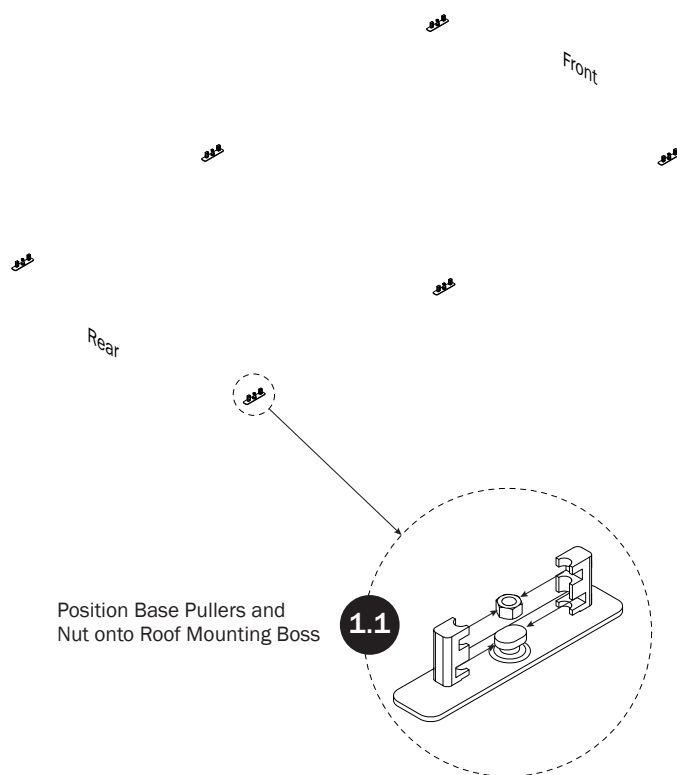

1.3

Slide and position the Channel Connector into the Mounting Body as shown, then screw the 30MM Flat Head bolt into the Base Puller.

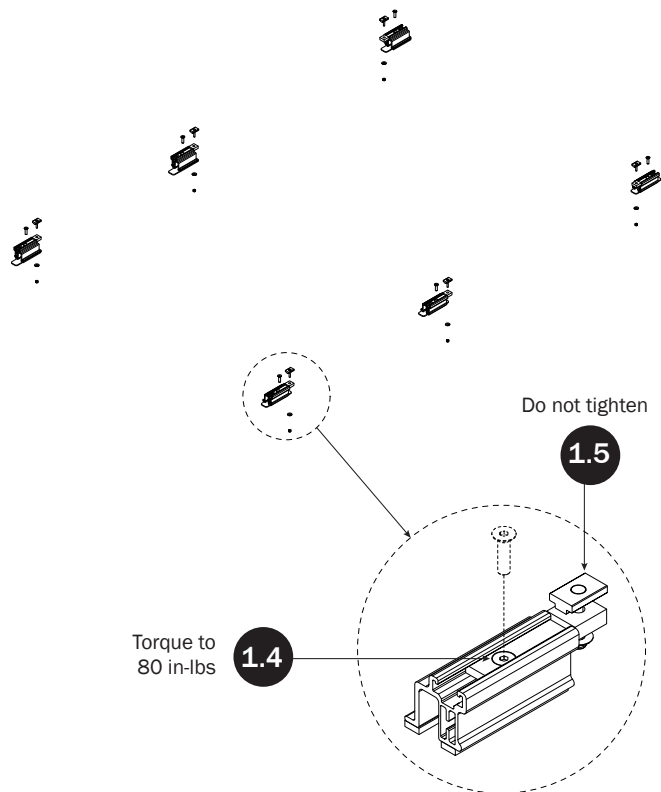

Do not tighten

1.5

Torque to 80 in-lbs

1.4

1.8

Screw the M8 x 40MM Allen Head bolts into the Upper and Lower Channel Splices. Due to tight manufacturing tolerances, both bolts must remain loose until Step 1.9

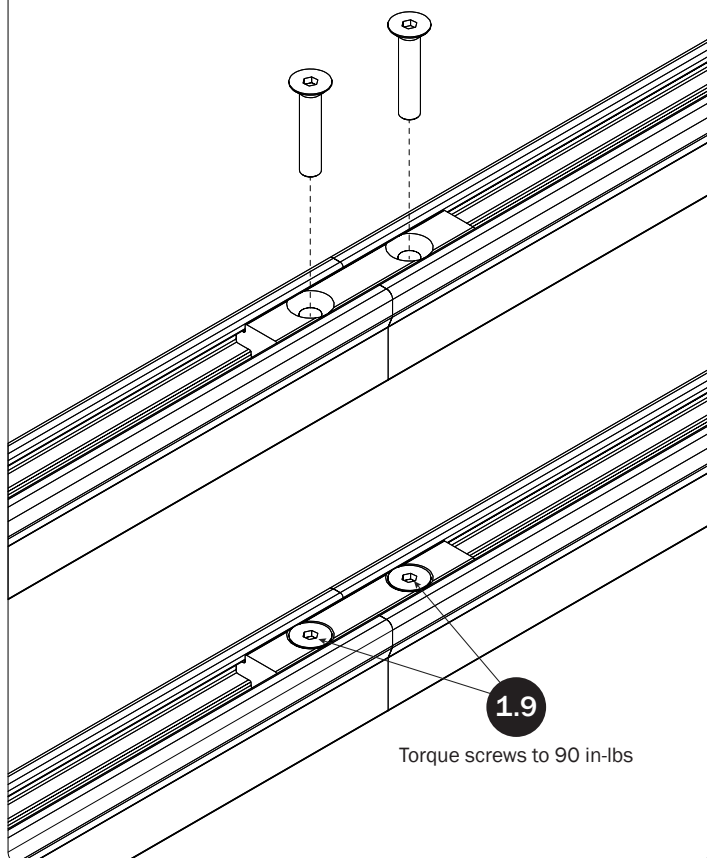

1.9

Torque screws to 90 in-lbs

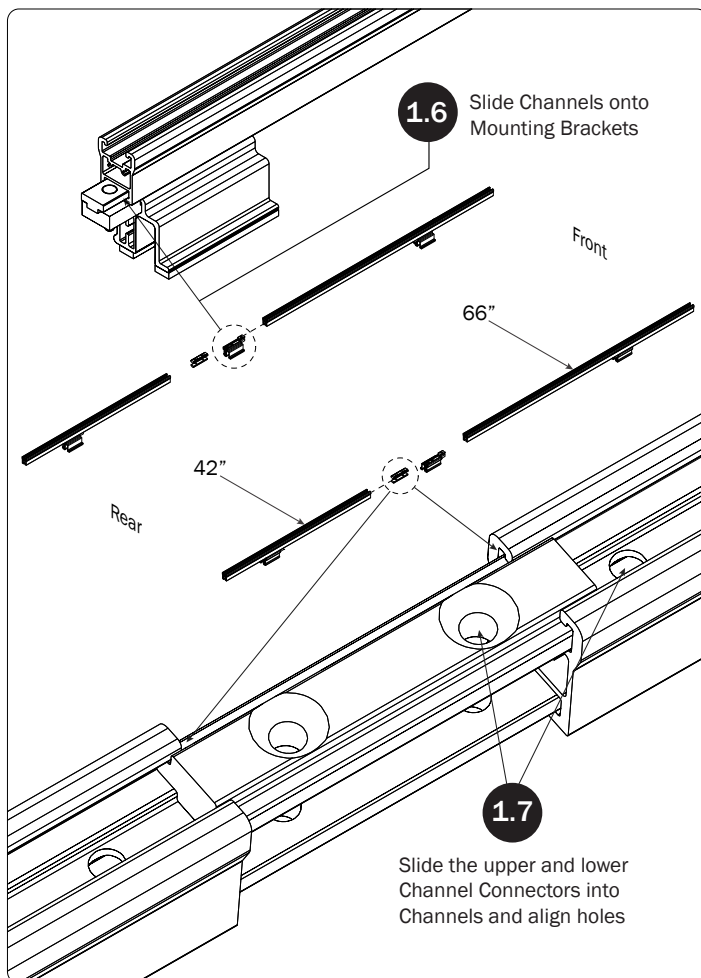

1.6

Slide Channels onto Mounting Brackets

42"

66"

Front

Rear

1.7

Slide the upper and lower Channel Connectors into Channels and align holes

1.10

Set to distances shown below, then torque Mounting Bracket nuts loosened at Step 1.5 to 80 in-lbs

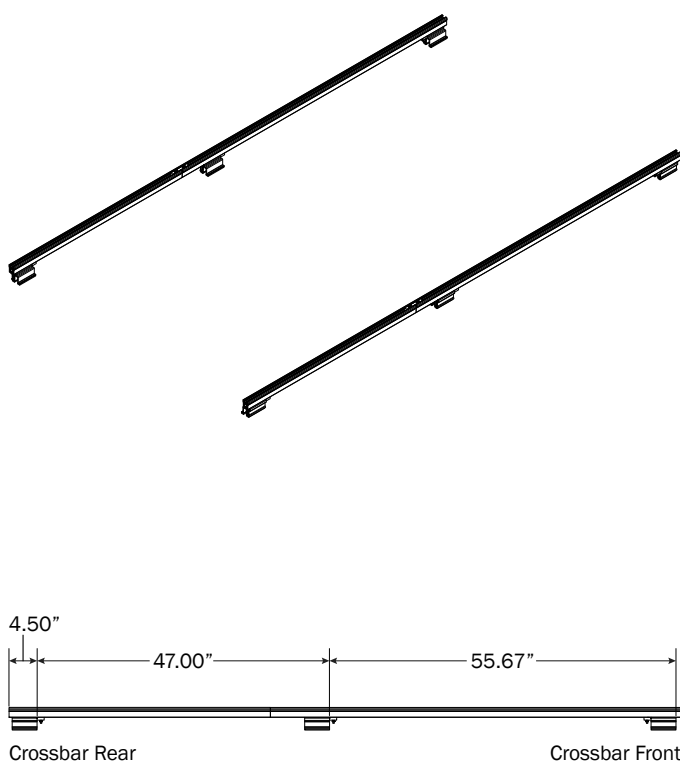

4.50"

47.00"

55.67"

Crossbar Rear

Crossbar Front



## MOUNTING BRACKETS

- 2.1** Slide the Aluminum Strip Nuts into each end of the Channels, and attach the Channel Caps

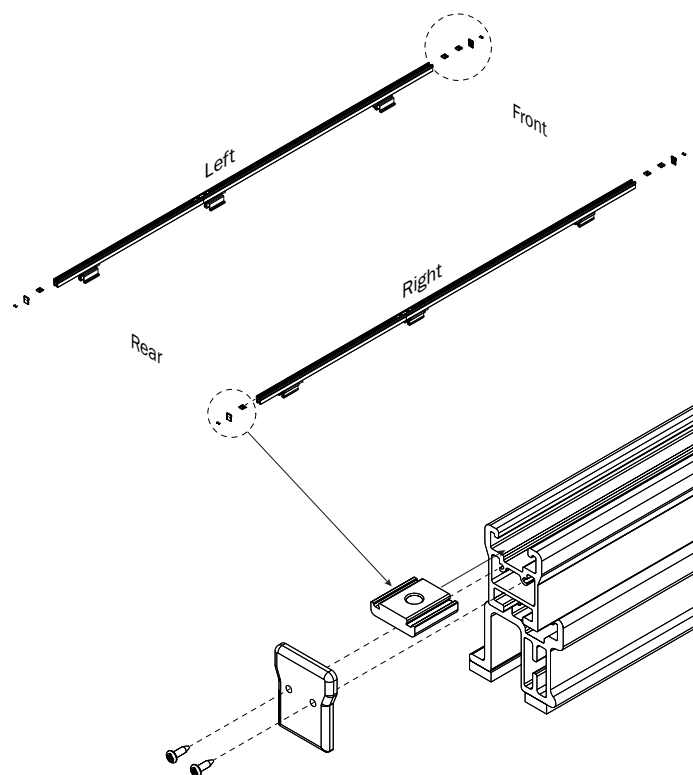

- 2.4** Set to distances shown below:  
Use Dimensions A for 2 Crossbar models.  
Use Dimensions B for 3 Crossbar models.

Do not torque the Crossbar Mounting Brackets until Step 3.4.  
Finger-tighten them into designated dimension to hold them in place, then proceed to your Feature (FEA) Assembly Manual.

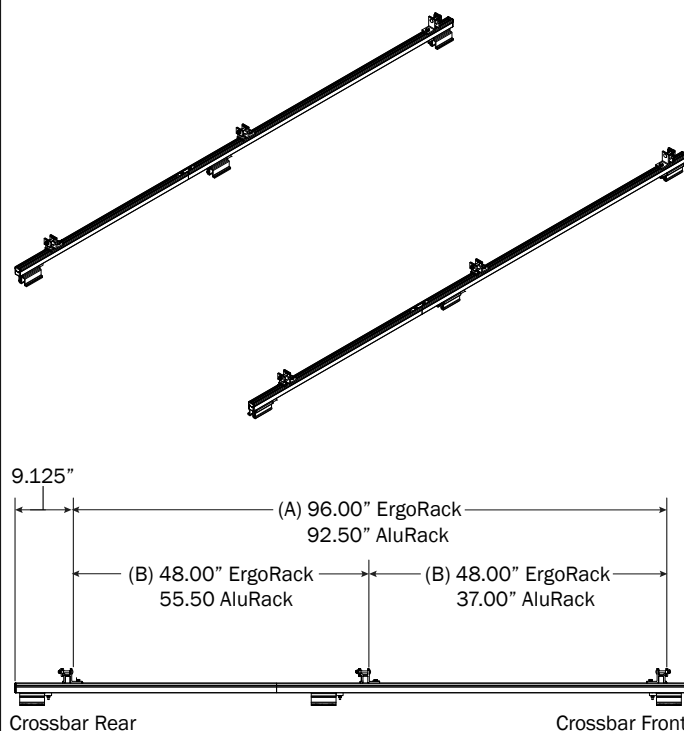

- 2.2** Using the supplied fastening hardware, attach the Crossbar Mounting Brackets into the Aluminum Strip Nuts placed into the Channels at Step 2.1

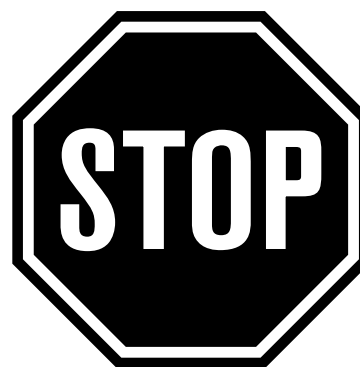
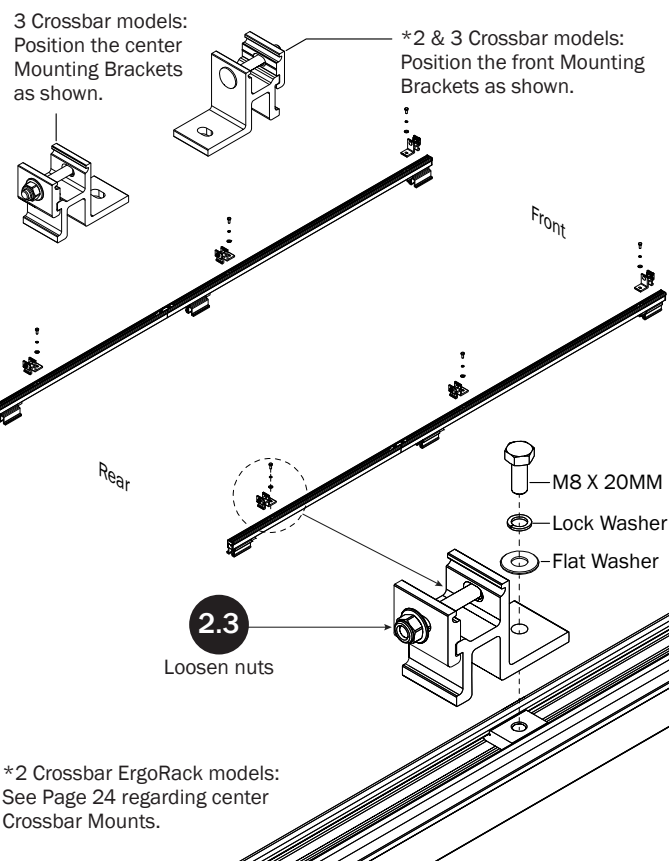

Do not mount the Crossbars to this FBM system at this time.

Refer to the respective FEA or AR Assembly Manual(s) included with your chosen rack configuration features. Depending upon the features chosen, you may need to perform a complete feature assembly onto the Crossbars or Side Rails as noted in that feature's Assembly Manual.

**WARNING:** Failure to position the Crossbars as shown in this FBM Assembly Manual may result in damage to the sliding door and/or ladder rack.

**NOTE:** Crossbars, Side Rails, Base, Clamp Down, or Rotation features are not included in this FBM kit, and must be purchased separately. To purchase applicable features and accessories, please contact your authorized distributor, or a Prime Design Sales & Service Representative.

## CROSSBARS (ERGORACK)

Shown with LH Base, and RH Rotation for illustrative purposes only

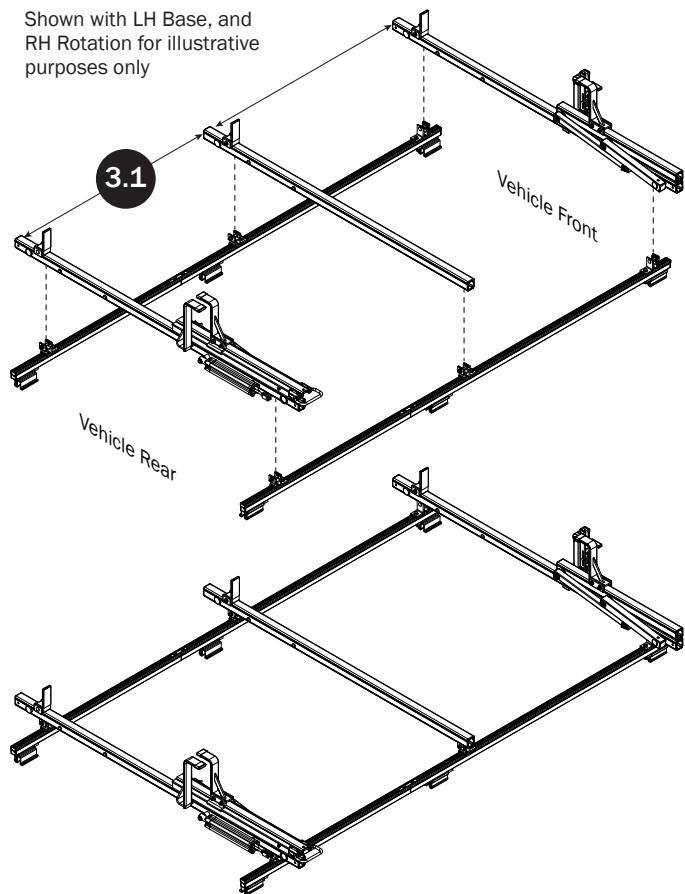

## CROSSBAR ADJUSTMENT

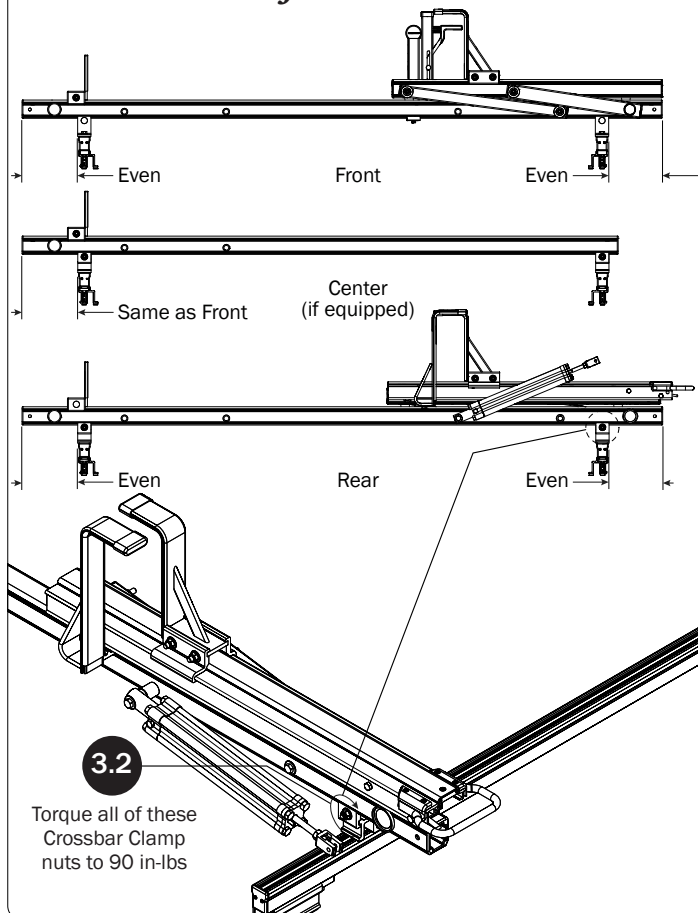

3.3

Verify the specified distance from the ends of both Mounting Bracket to the ends of both Channels.

9.125"

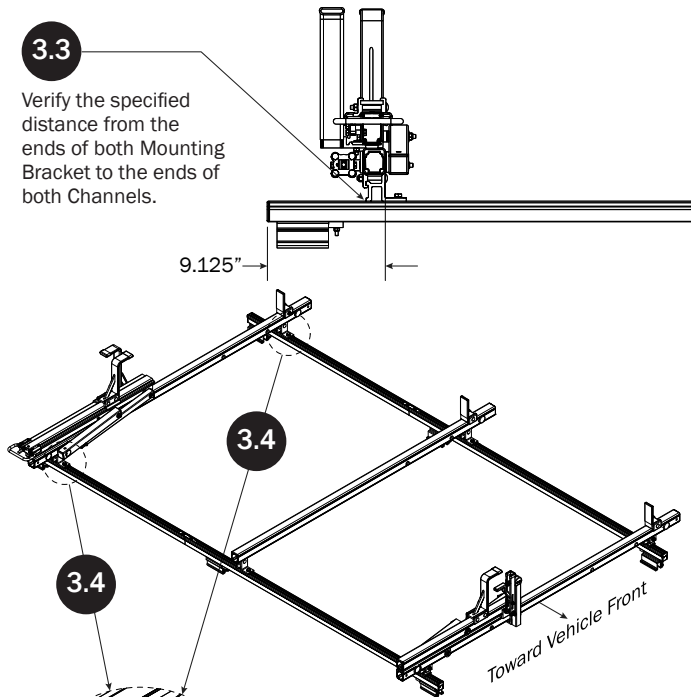

Torque only the Rear Crossbar Mounting Bracket bolts to 90 in-lbs at this time.

The Center (if equipped) and Front Crossbar Mounting Brackets will be torqued to specification when designated in the respective Feature (FEA) Assembly Manual.

**CROSSBARS (ALURACK)**

Shown with L2H1 AluRack  
for illustrative purposes only

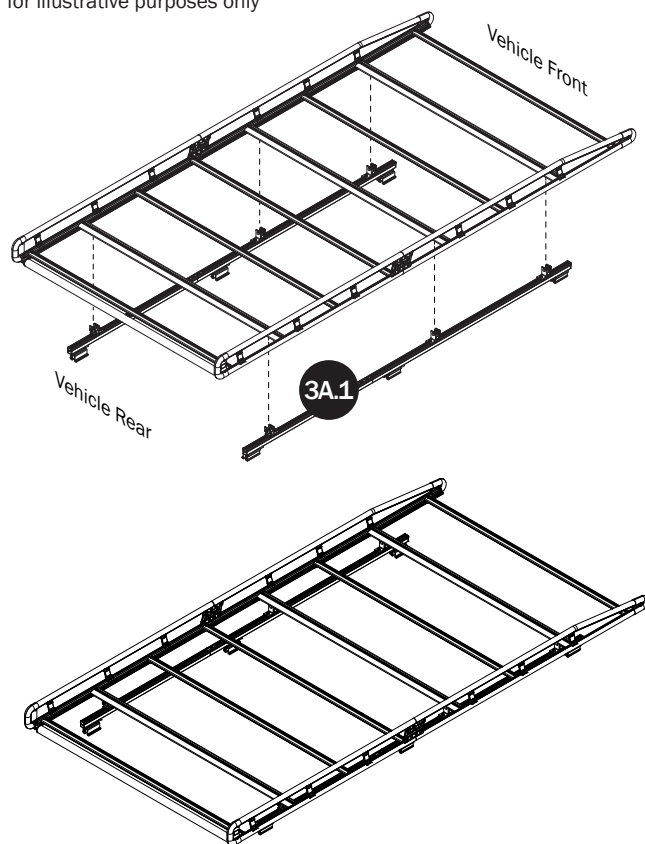
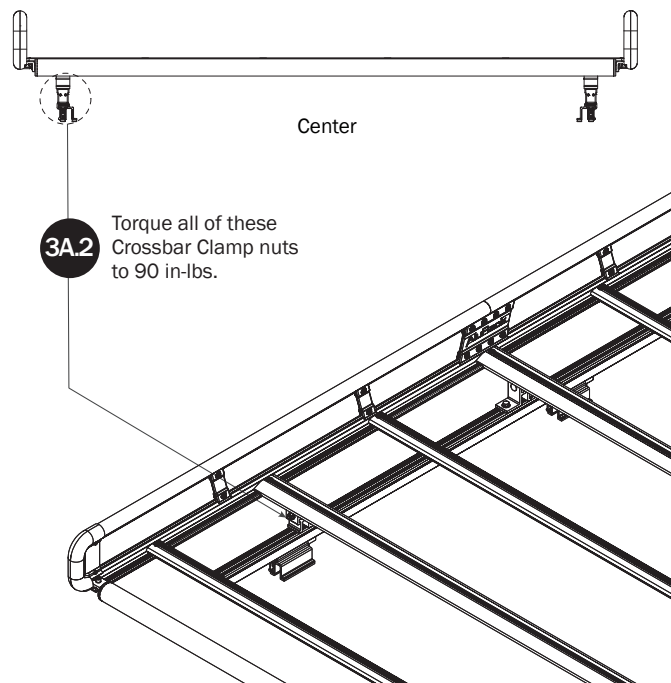
**CROSSBAR  
ADJUSTMENT****3A.3**

Verify the specified distance from the ends of both Mounting Bracket to the ends of both Channels.

9.125"

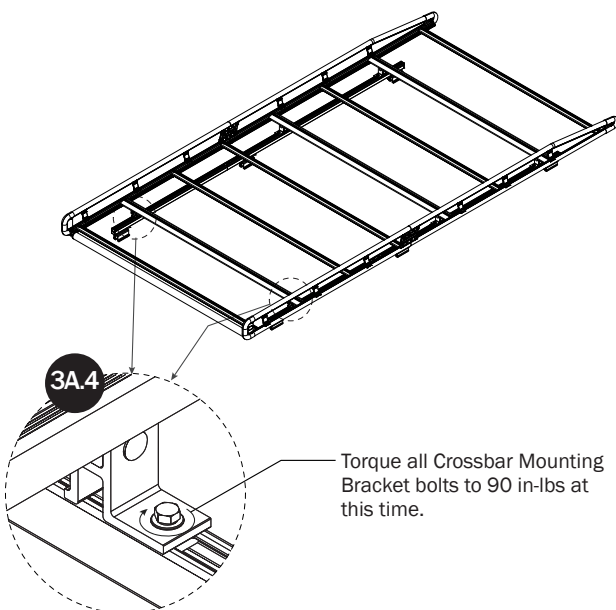



ALURACK ONLY  
CONFIGURATION

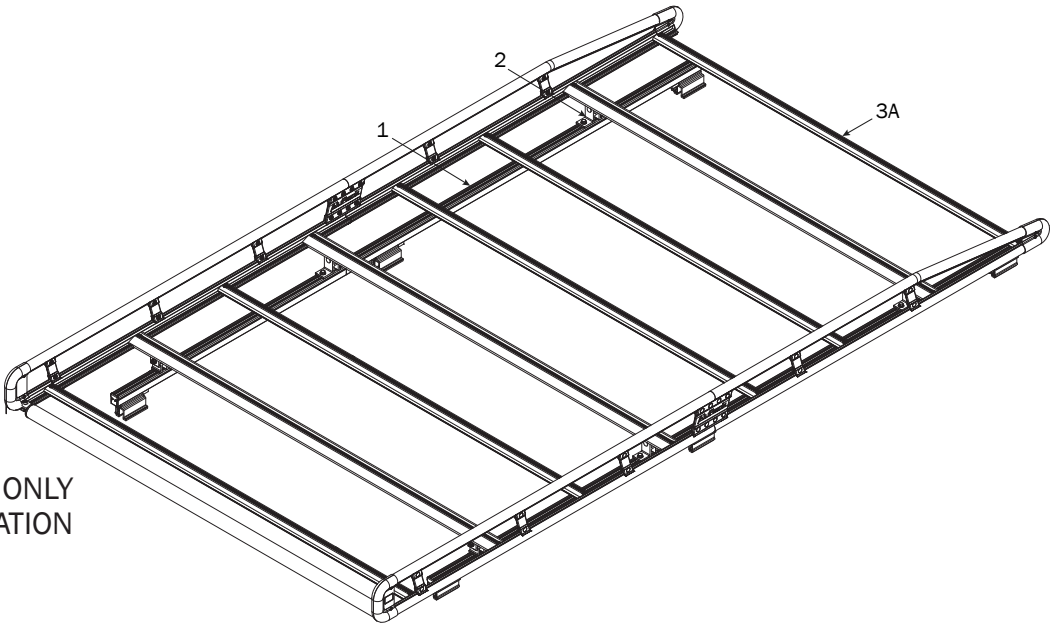

NOTE: Base, Rotation, Crossbar, and Side Rail features are shown for illustrative purposes only. These features are not included with this Base Mounting Kit, and must be purchased separately.

CHANNEL MOUNTINGS

NOTE: Channel Mountings must be disassembled for installation onto the vehicle's roof.

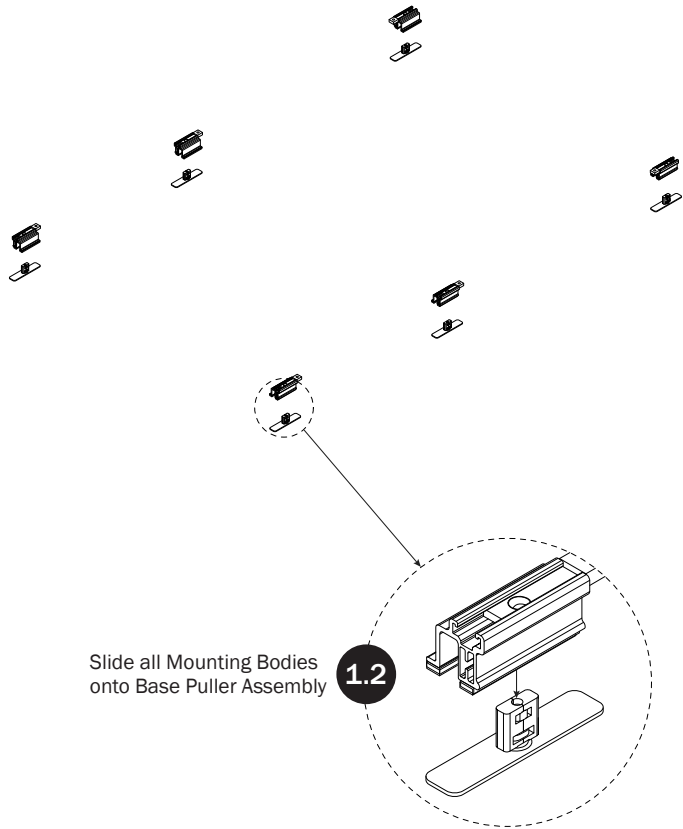
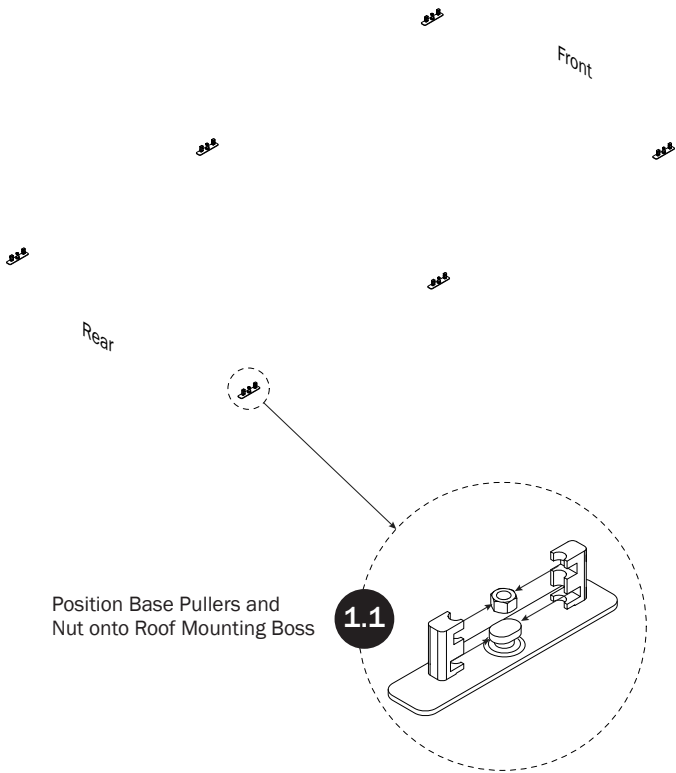

1.3

Slide and position the Channel Connector into the Mounting Body as shown, then screw the 30MM Flat Head bolt into the Base Puller.

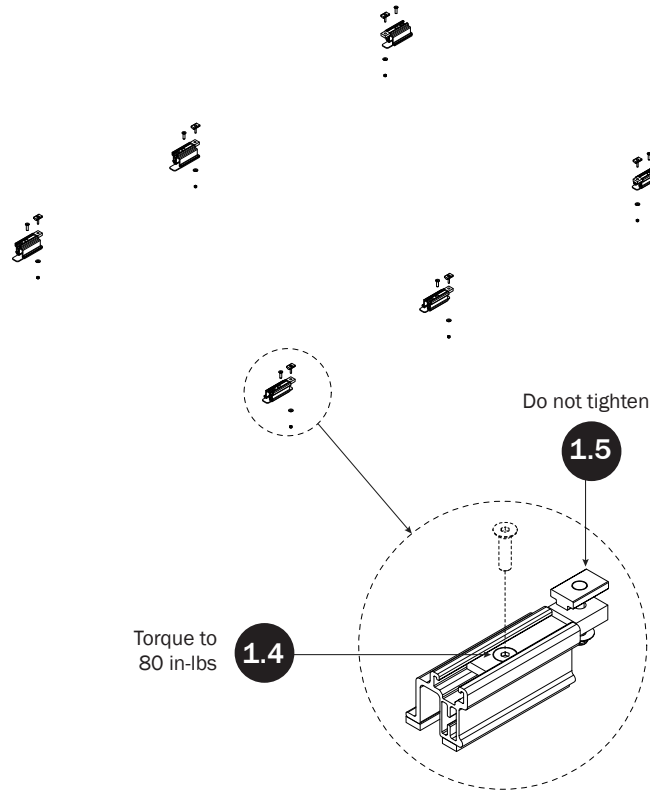

1.6

Slide Channels onto Mounting Brackets

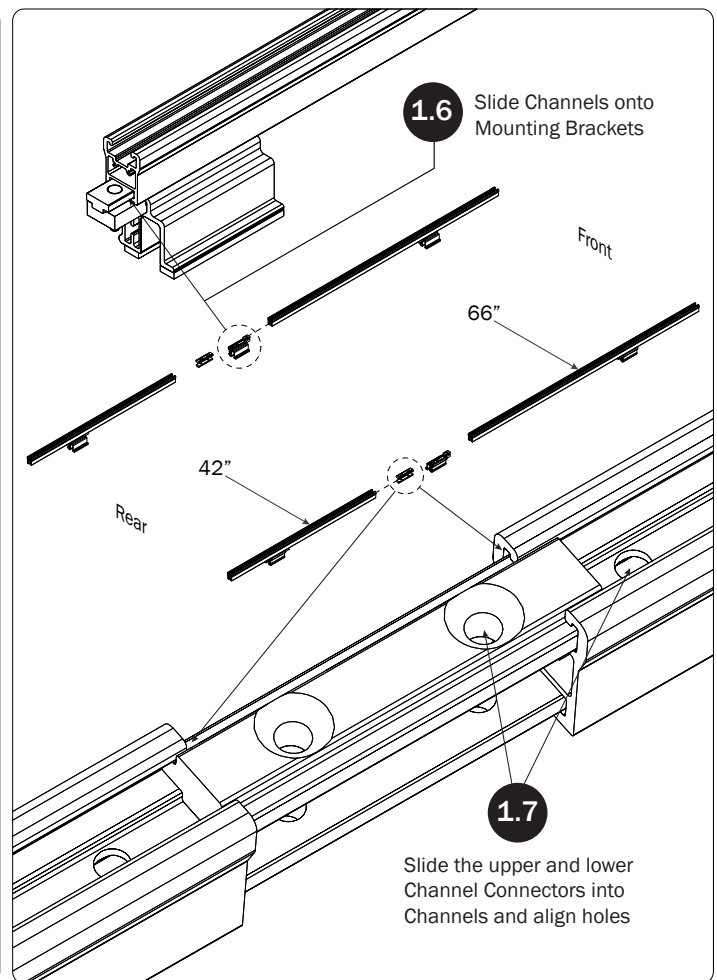

1.8

Screw the M8 x 40MM Allen Head bolts into the Upper and Lower Channel Splices. Due to tight manufacturing tolerances, both bolts must remain loose until Step 1.9

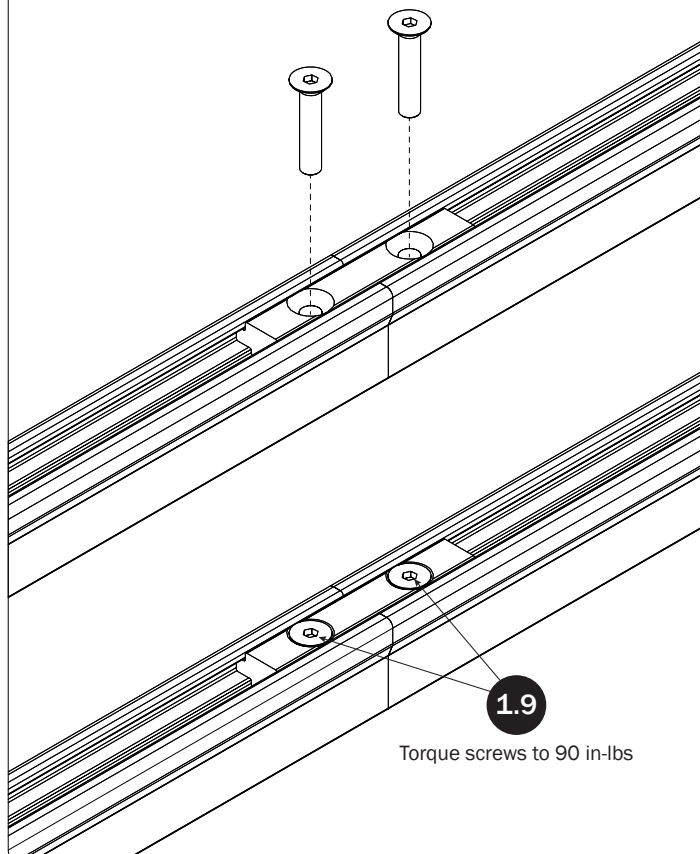

1.10

Set to distances shown below, then torque Mounting Bracket nuts loosened at Step 1.5 to 80 in-lbs

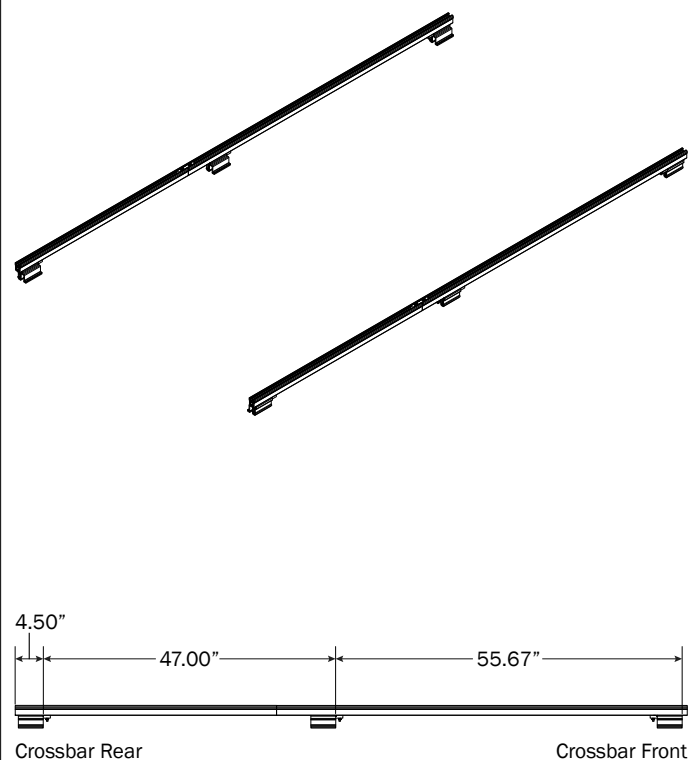

## MOUNTING BRACKETS

- 2.1** Slide the Aluminum Strip Nuts into each end of the Channels, and attach the Channel Caps

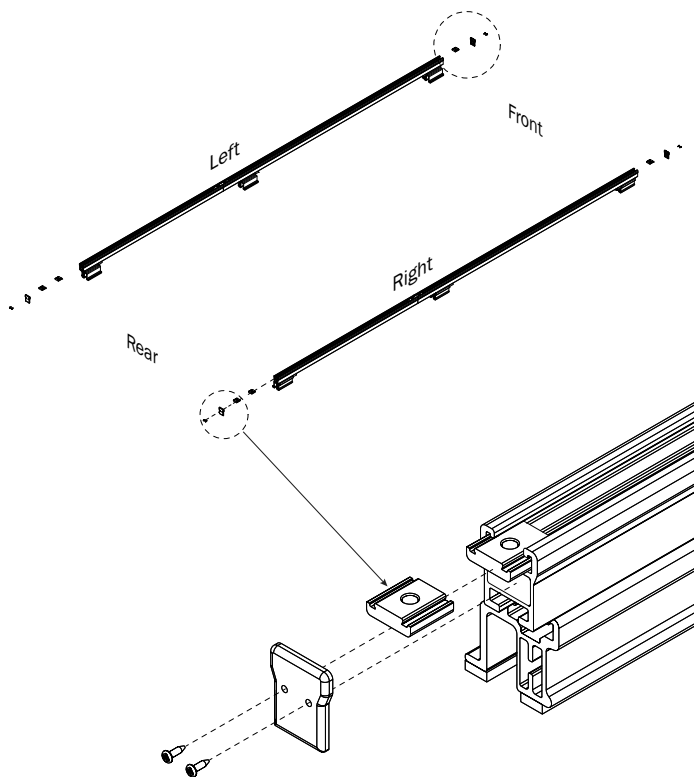

**2.2**

- Using the supplied fastening hardware, attach the Crossbar Mounting Brackets into the Aluminum Strip Nuts placed into the Channels at Step 2.1

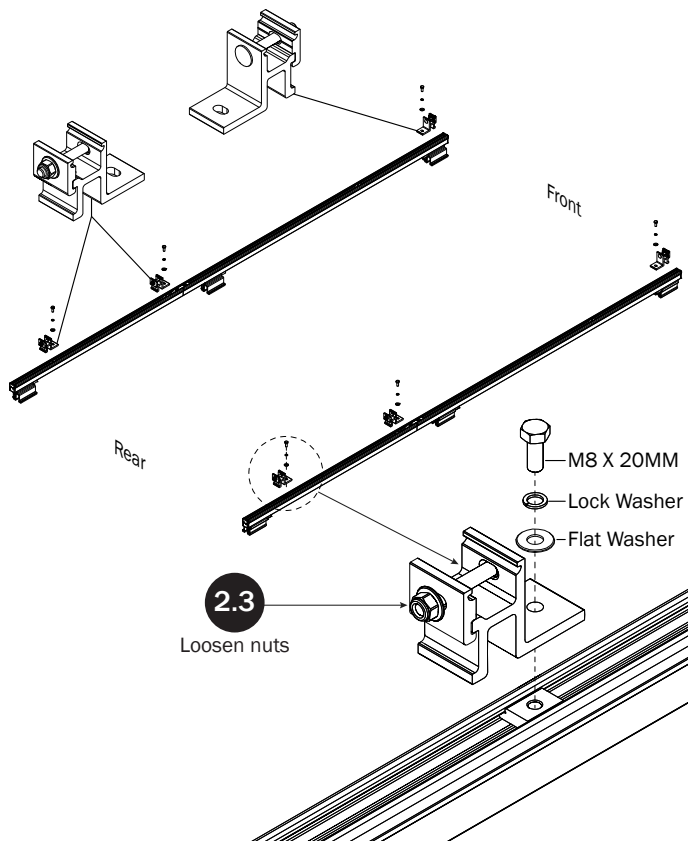

**2.4**

- Set to distances shown below (AluRack only). Do not torque the Crossbar Mounting Brackets until Step 3.4. Finger-tighten them into designated dimension to hold them in place, then proceed to your Feature (FEA) Assembly Manual.

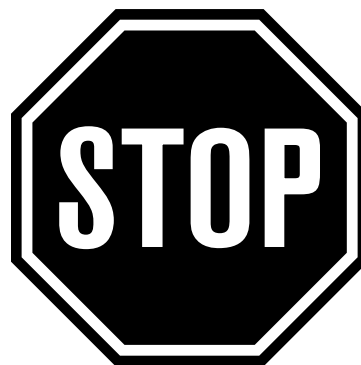
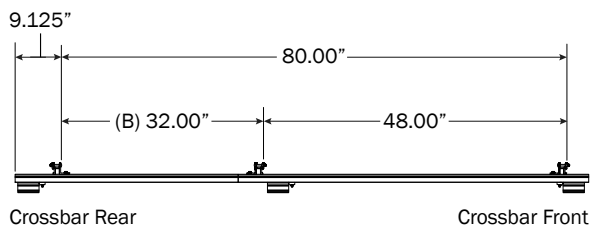

Do not mount the Crossbars to this FBM system at this time.

Refer to the respective FEA or AR Assembly Manual(s) included with your chosen rack configuration features. Depending upon the features chosen, you may need to perform a complete feature assembly onto the Crossbars or Side Rails as noted in that feature's Assembly Manual.

**WARNING:** Failure to position the Crossbars as shown in this FBM Assembly Manual may result in damage to the sliding door and/or ladder rack.

**NOTE:** Crossbars, Side Rails, Base, Clamp Down, or Rotation features are not included in this FBM kit, and must be purchased separately. To purchase applicable features and accessories, please contact your authorized distributor, or a Prime Design Sales & Service Representative.

**CROSSBARS (ALURACK)**

Shown with L2H2 AluRack  
for illustrative purposes only

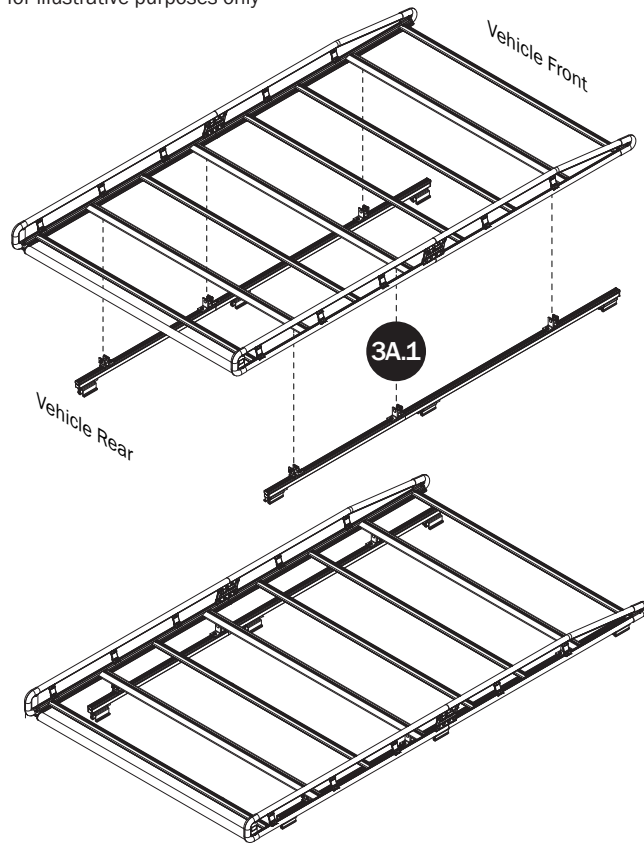
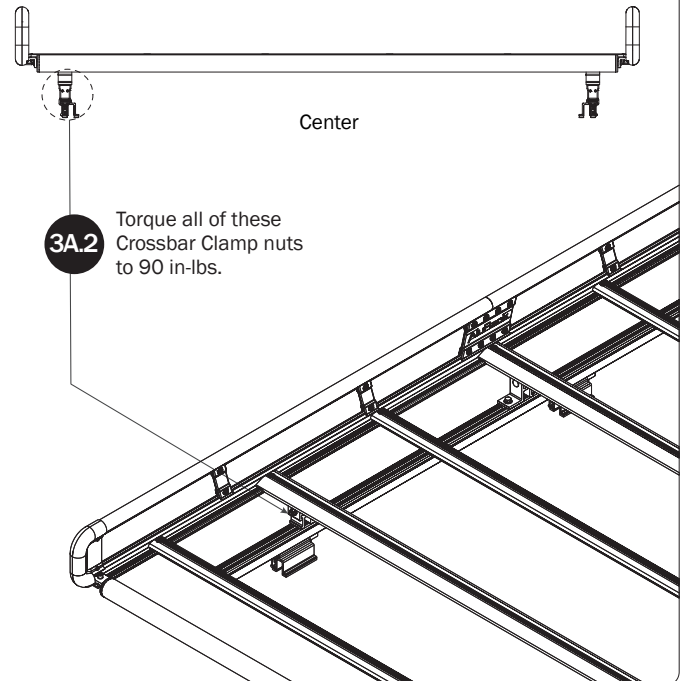
**CROSSBAR  
ADJUSTMENT****3A.3**

Verify the specified  
distance from the  
ends of both Mounting  
Bracket to the ends of  
both Channels.

9.125"

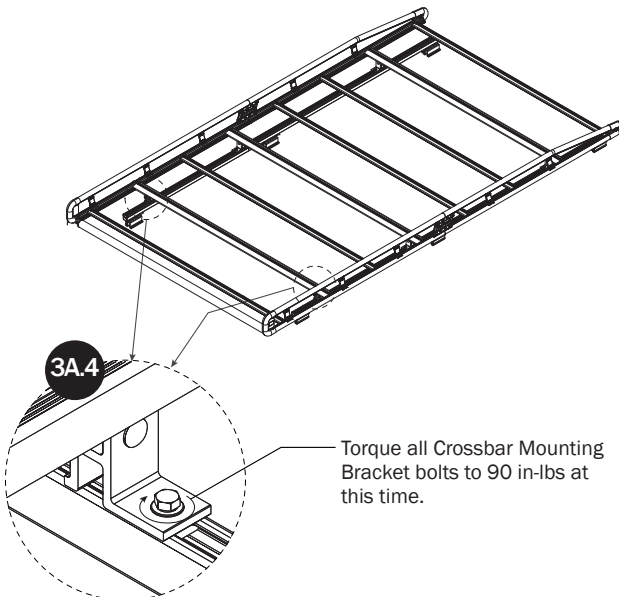

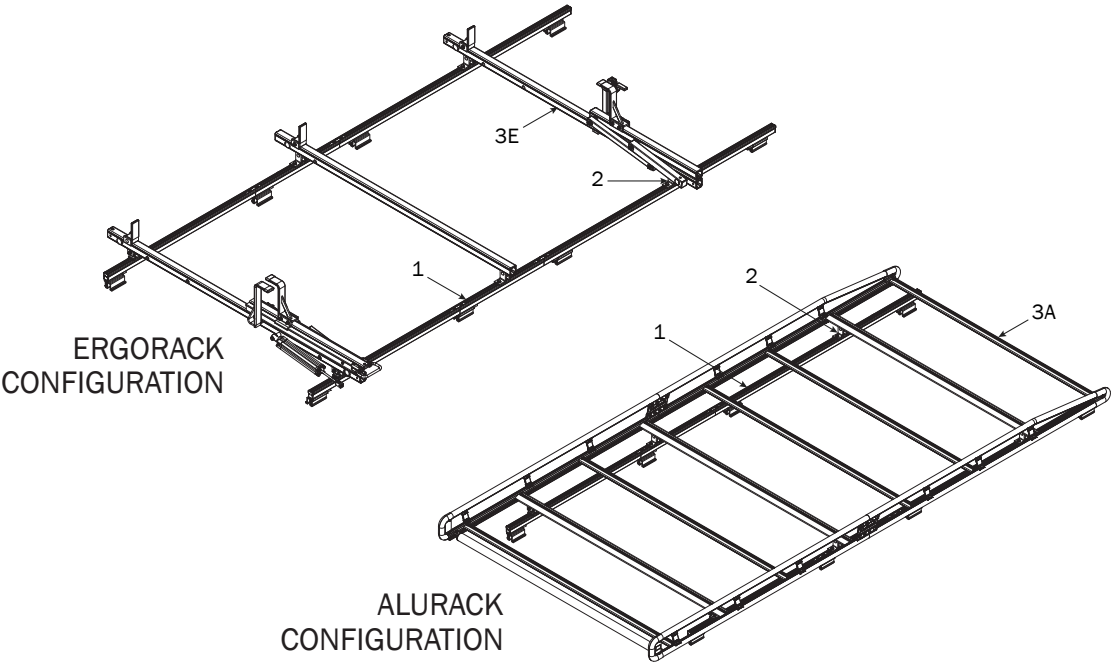

NOTE: Base, Rotation, Crossbar, and Side Rail features are shown for illustrative purposes only. These features are not included with this Base Mounting Kit, and must be purchased separately.

### CHANNEL MOUNTINGS

NOTE: Channel Mountings must be disassembled for installation onto the vehicle's roof.

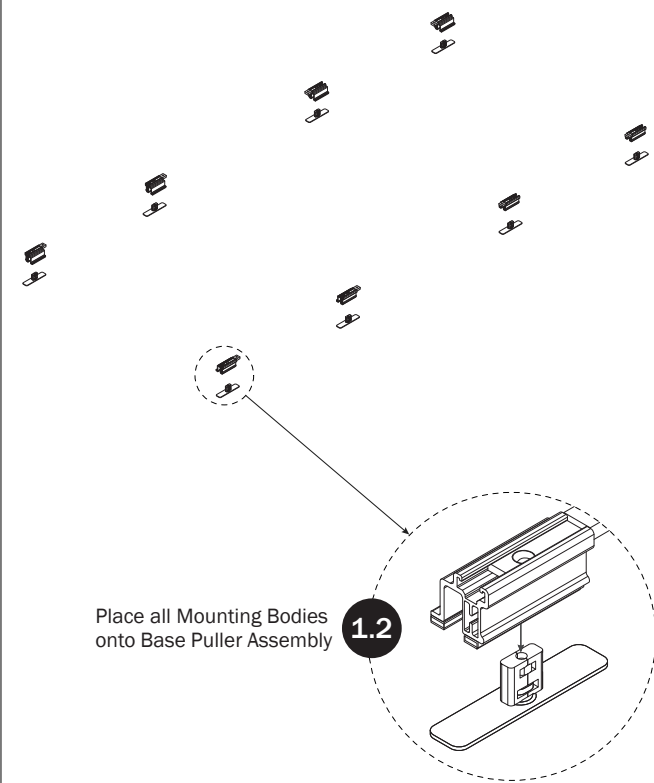
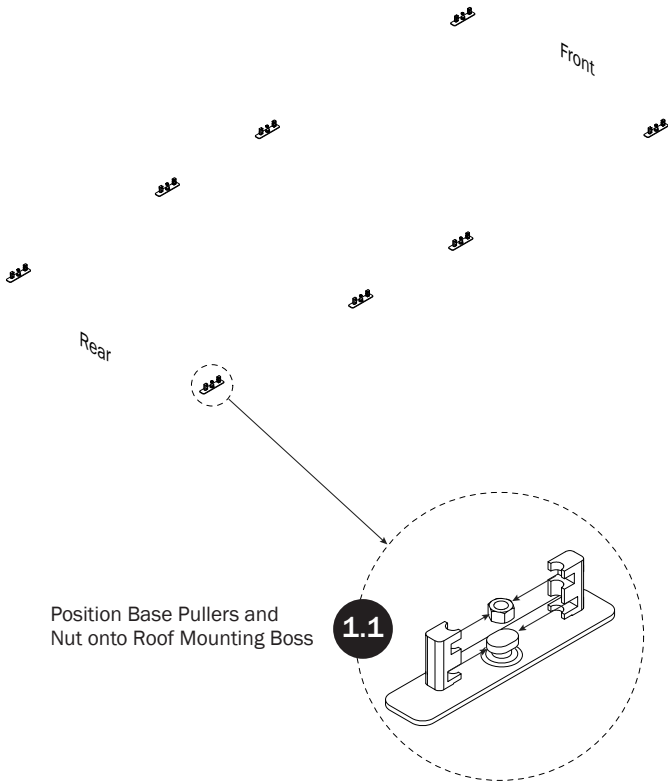

1.3

Slide and position the Channel Connector into the Mounting Body as shown, then screw the 30MM Flat Head bolt into the Base Puller.

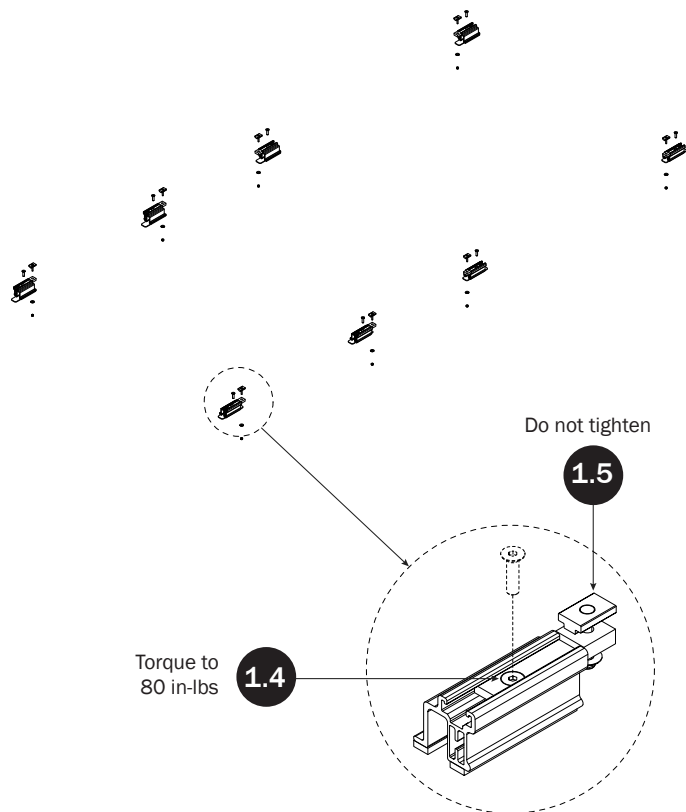

1.6

Slide Channels onto Mounting Brackets

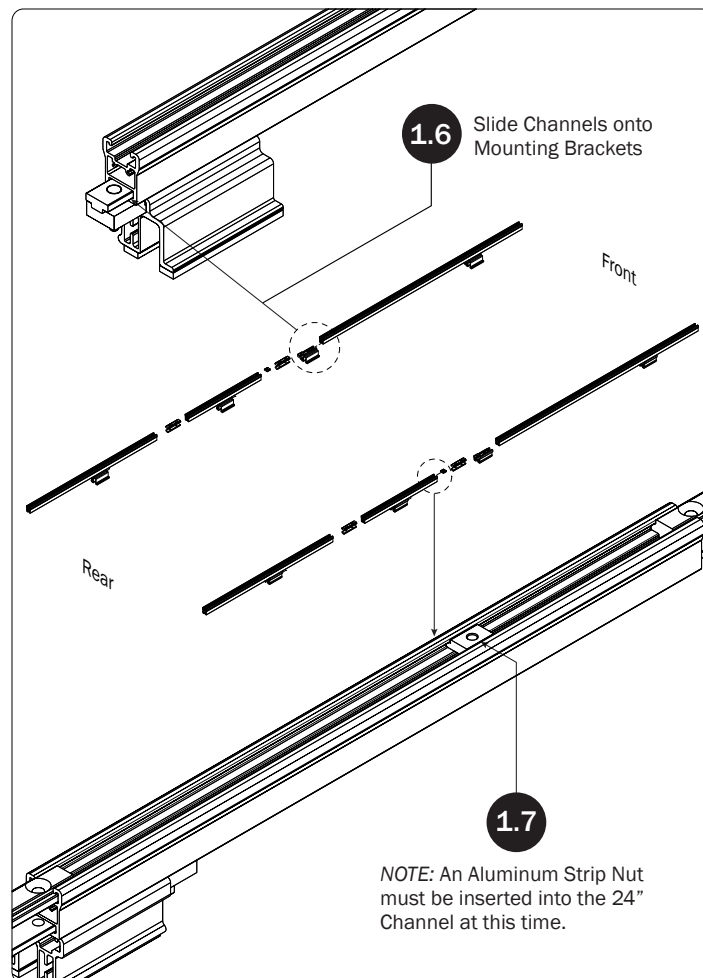

1.9

Screw the M8 x 40MM Allen Head bolts into the Upper and Lower Channel Splices. Due to tight manufacturing tolerances, both bolts must remain loose until Step 1.10

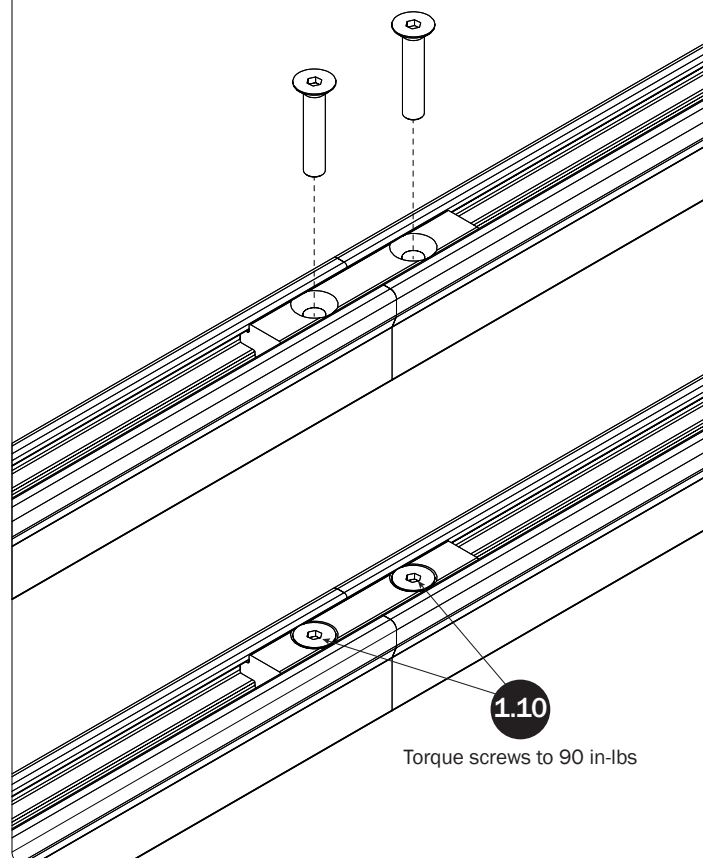

1.8

Slide the upper and lower Channel Connectors into Channels and align holes

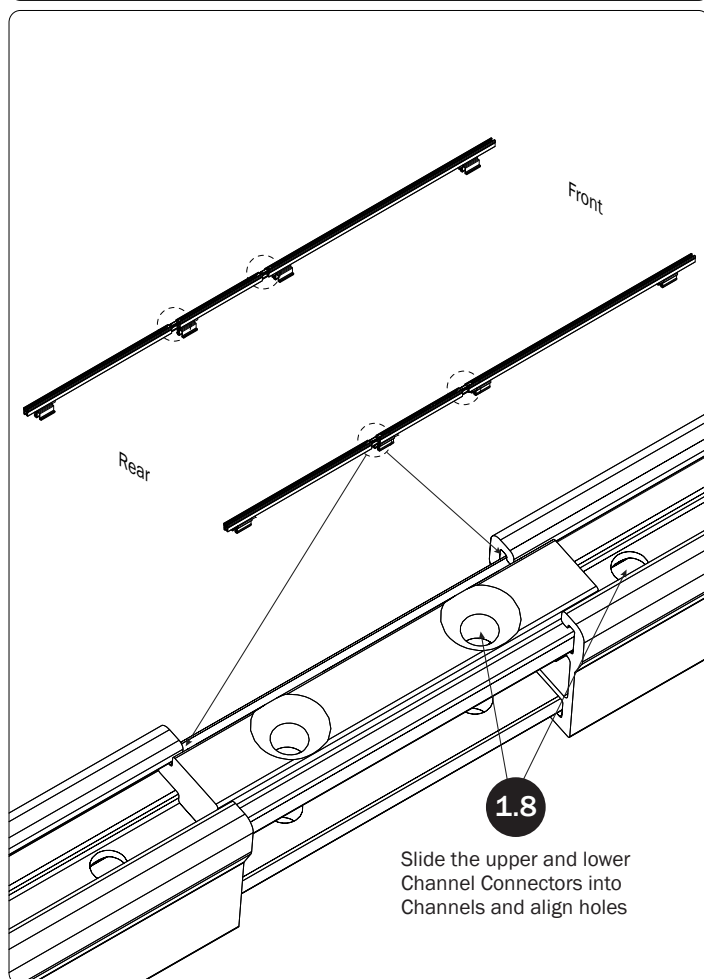



1.11

Set to distances shown below, then torque Mounting Bracket nuts loosened at Step 1.5 to 80 in-lbs

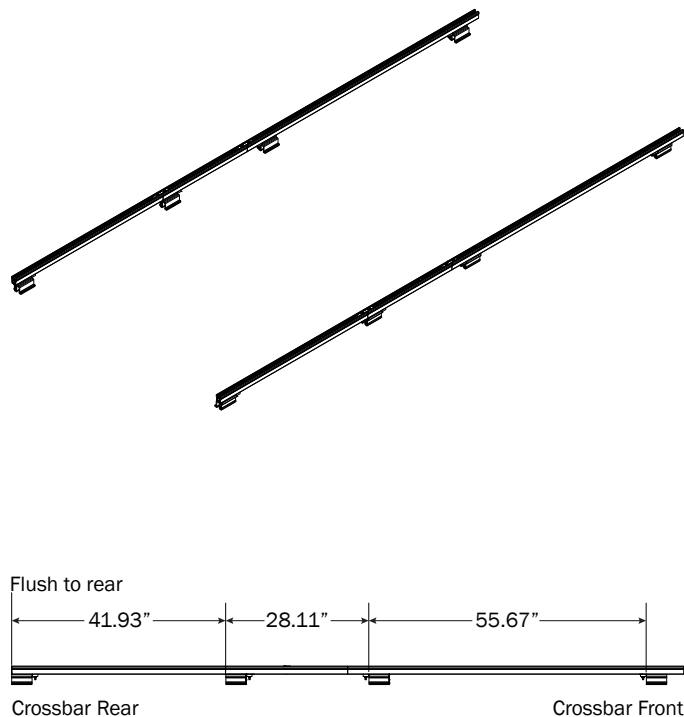

## MOUNTING BRACKETS

2.1

Slide the remaining Aluminum Strip Nuts into each end of the Channels, and attach the Channel Caps

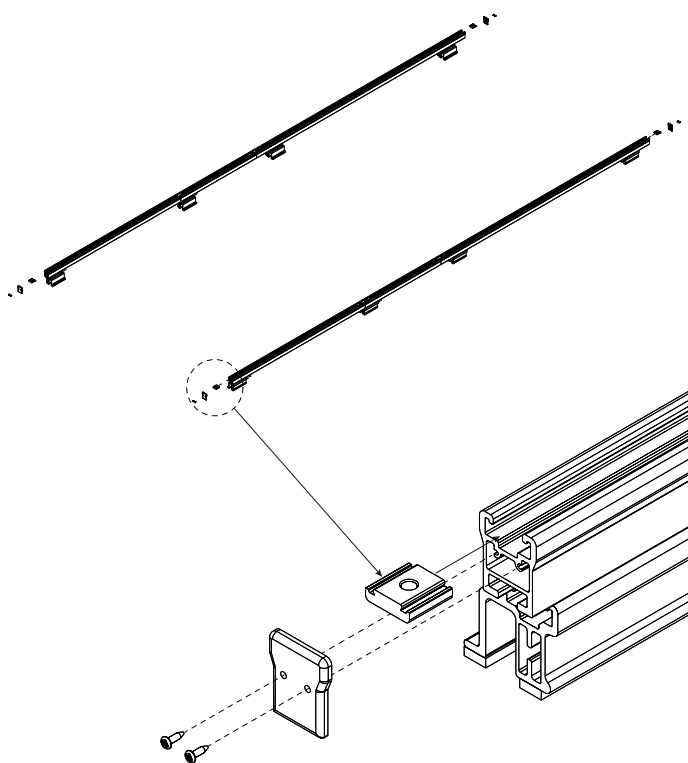

2.2

Using the supplied fastening hardware, attach the Crossbar Mounting Brackets into the Aluminum Strip Nuts placed into the Channels at Step 2.1

3 Crossbar models:  
Position the center  
Mounting Brackets  
as shown.

\*2 & 3 Crossbar models:  
Position the front  
Mounting Brackets  
as shown.

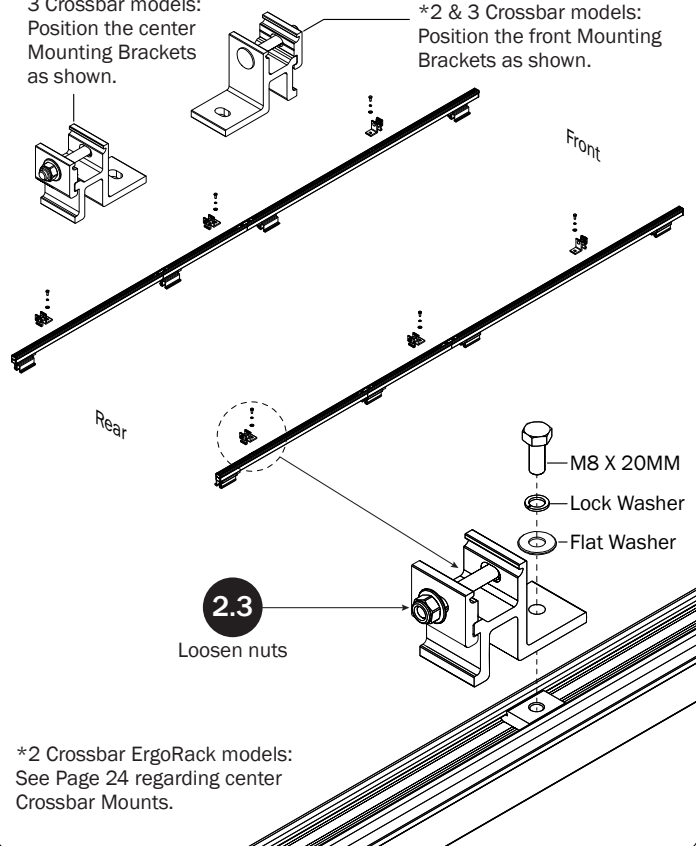

\*2 Crossbar ErgoRack models:  
See Page 24 regarding center  
Crossbar Mounts.

2.4

Set to distances shown below:  
Use Dimensions A for 2 Crossbar models.  
Use Dimensions B for 3 Crossbar models.

Do not torque the Crossbar Mounting Brackets until Step 3.4.  
Finger-tighten them into designated dimension to hold them in  
place, then proceed to your Feature (FEA) Assembly Manual.

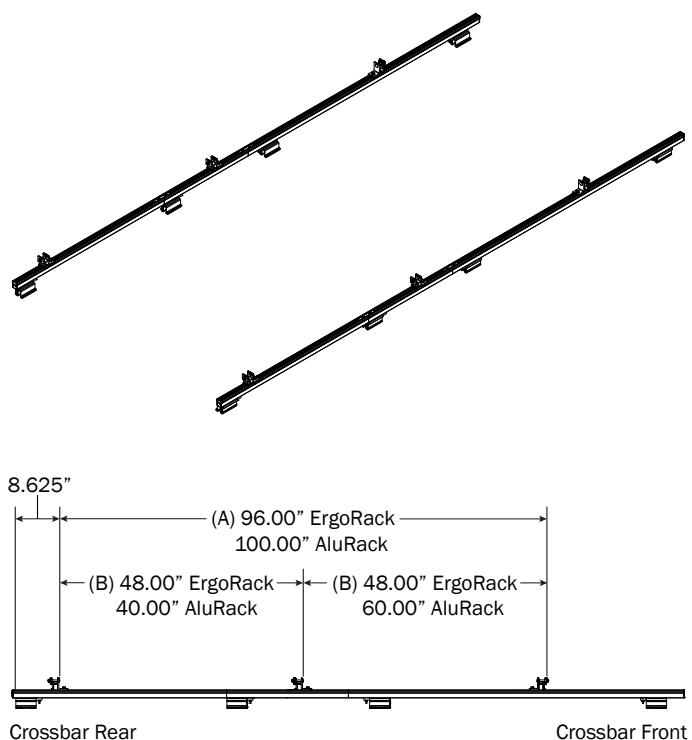

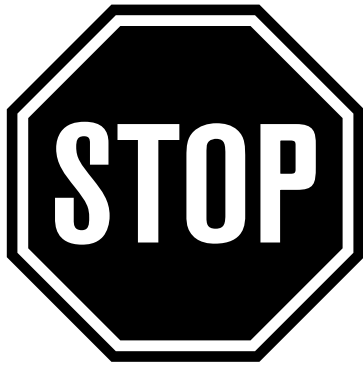

Do not mount the Crossbars to this FBM system at this time.

Refer to the respective FEA Assembly Manual(s) included with your chosen rack configuration features. Depending upon the features chosen, you may need to perform a complete feature assembly onto the Crossbars as noted in that feature's Assembly Manual.

**WARNING:** Failure to position the Crossbars as shown in this FBM Assembly Manual may result in damage to the sliding door and/or ladder rack.

**NOTE:** Base, Clamp Down, or Rotation features are not included in this FBM kit, and must be purchased separately. To purchase applicable features and accessories, please contact your authorized distributor, or a Prime Design Sales & Service Representative.

## CROSSBARS (ERGORACK)

Shown with LH Base, and RH Rotation for illustrative purposes only

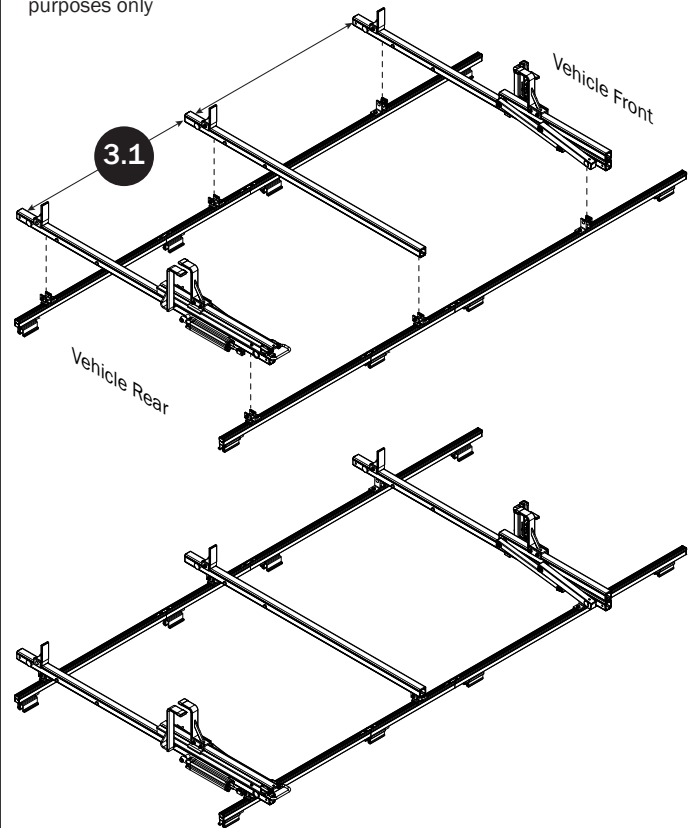

## CROSSBAR ADJUSTMENT

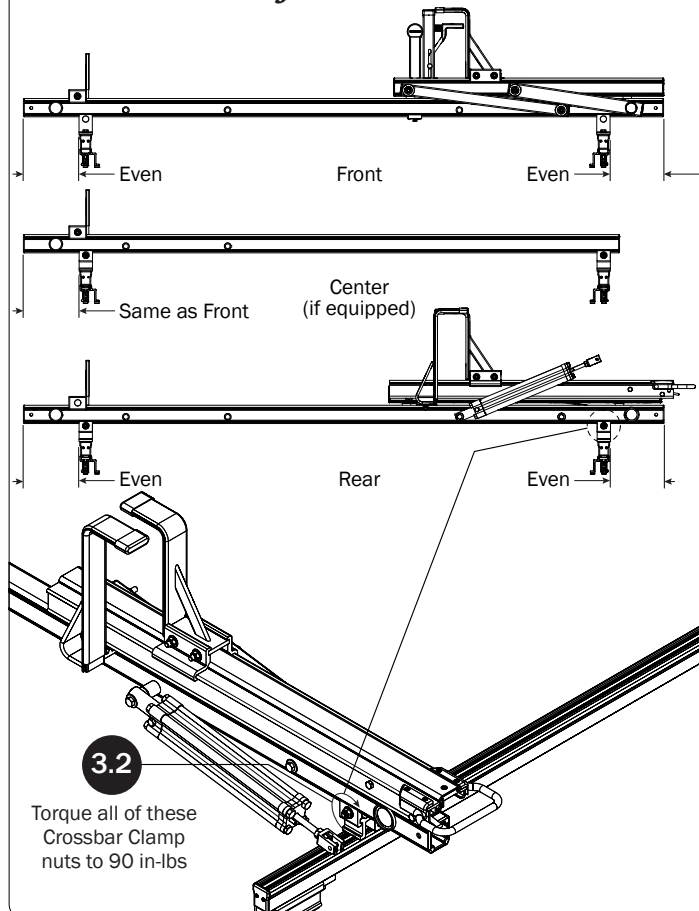

3.3

Verify the specified distance from the ends of both Mounting Bracket to the ends of both Channels.

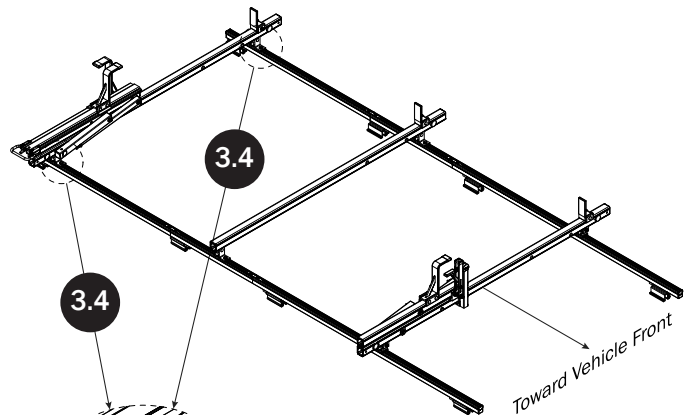
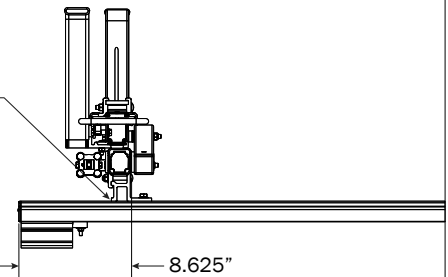

The Center (if equipped) and Front Crossbar Mounting Brackets will be torqued to specification when designated in the respective Feature (FEA) Assembly Manual.



## CROSSBARS (ALURACK)

Shown with L4H2 AluRack  
for illustrative purposes only

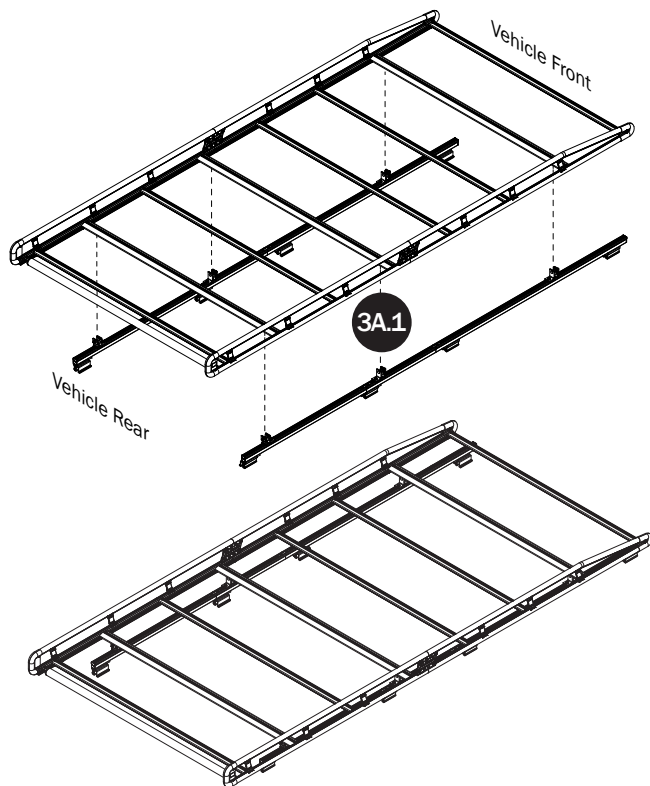

## CROSSBAR ADJUSTMENT

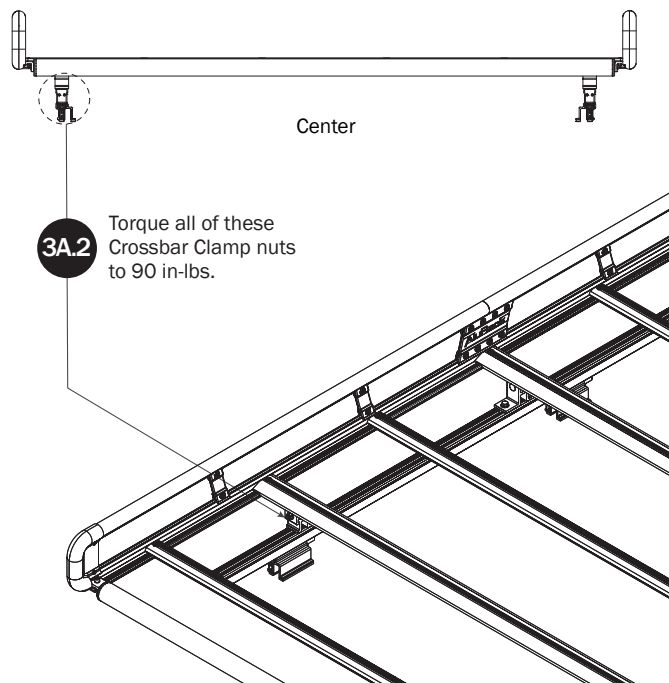

3A.3

Verify the specified distance from the ends of both Mounting Bracket to the ends of both Channels.

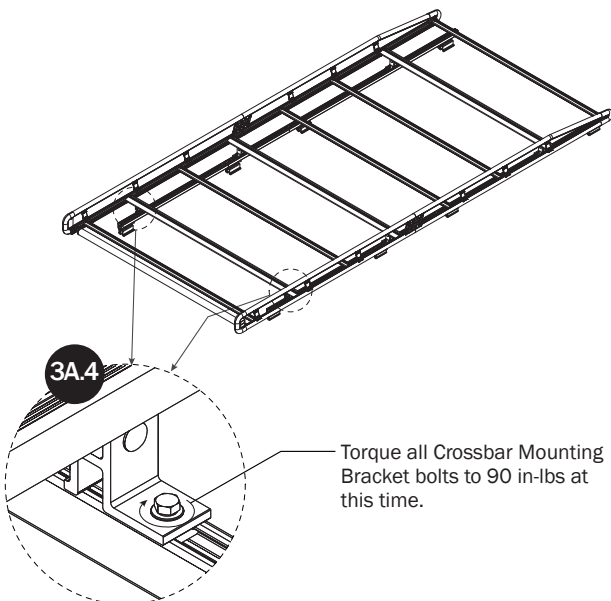
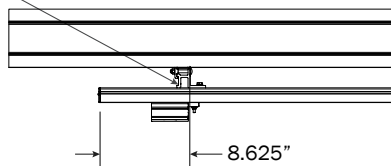

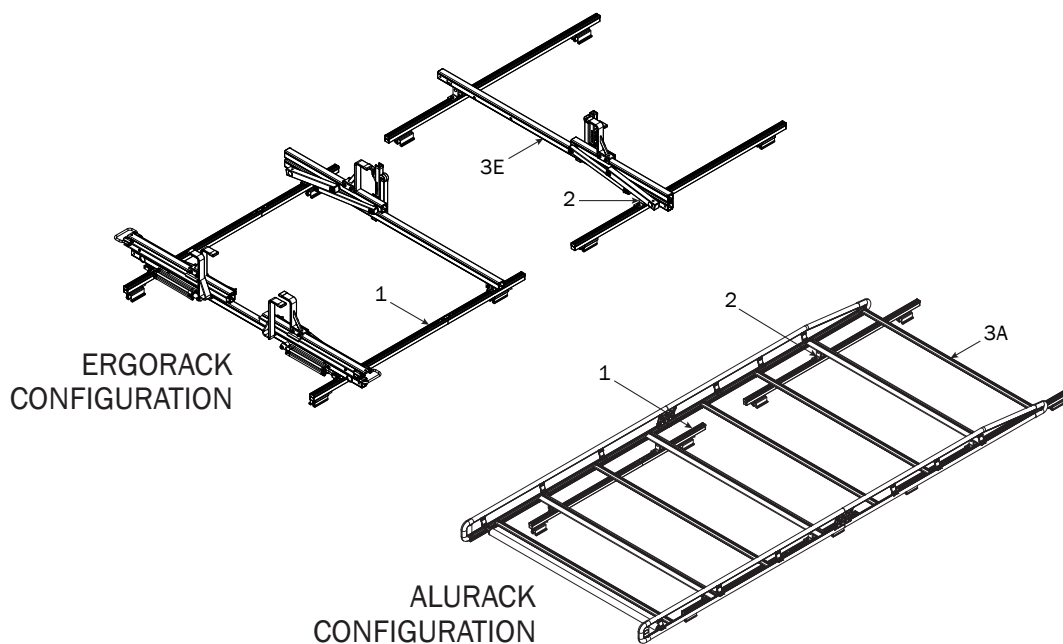
**L5H2 (159.00"+) FBM ASSEMBLY SEQUENCE**

*NOTE: Base, Rotation, Crossbar, and Side Rail features are shown for illustrative purposes only. These features are not included with this Base Mounting Kit, and must be purchased separately.*

**CHANNEL MOUNTINGS**

*NOTE: Channel Mountings must be disassembled for installation onto the vehicle's roof.*

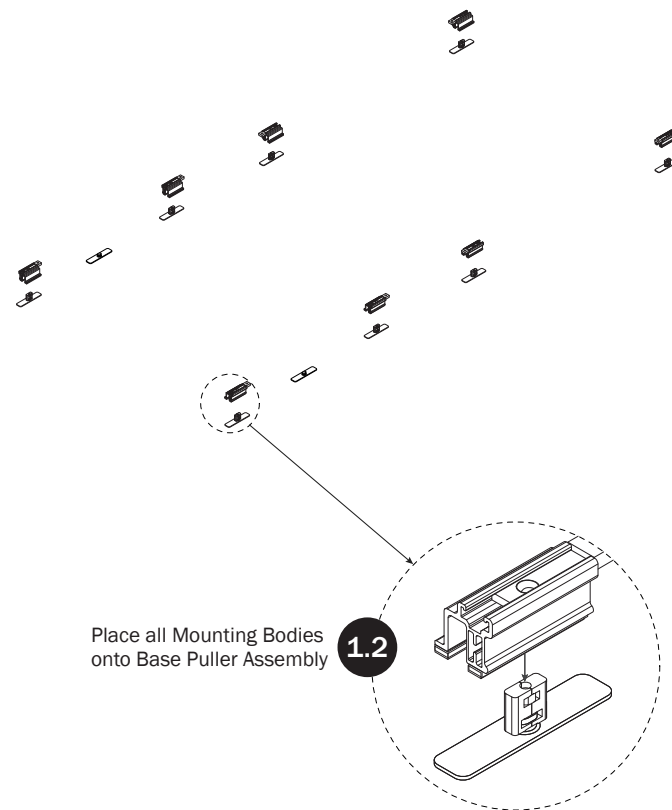
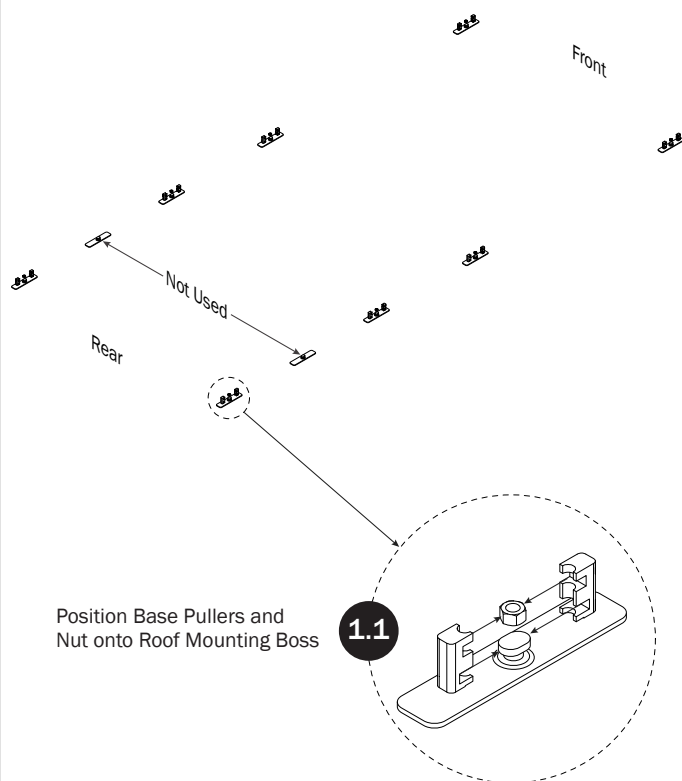

**1.3**

Slide and position the Channel Connector into the Mounting Body as shown, then screw the 30MM Flat Head bolt into the Base Puller.

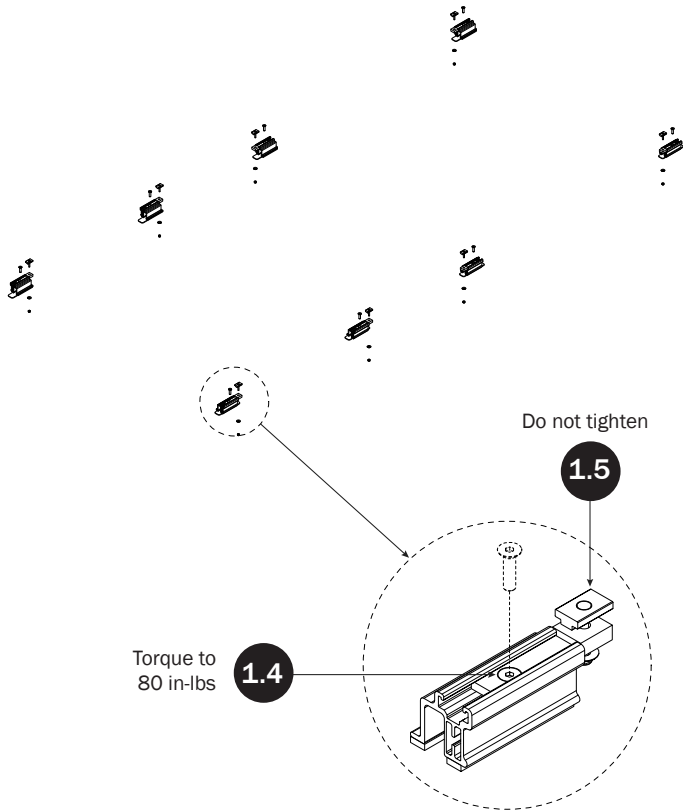
**1.6**

Slide Channels onto Mounting Brackets

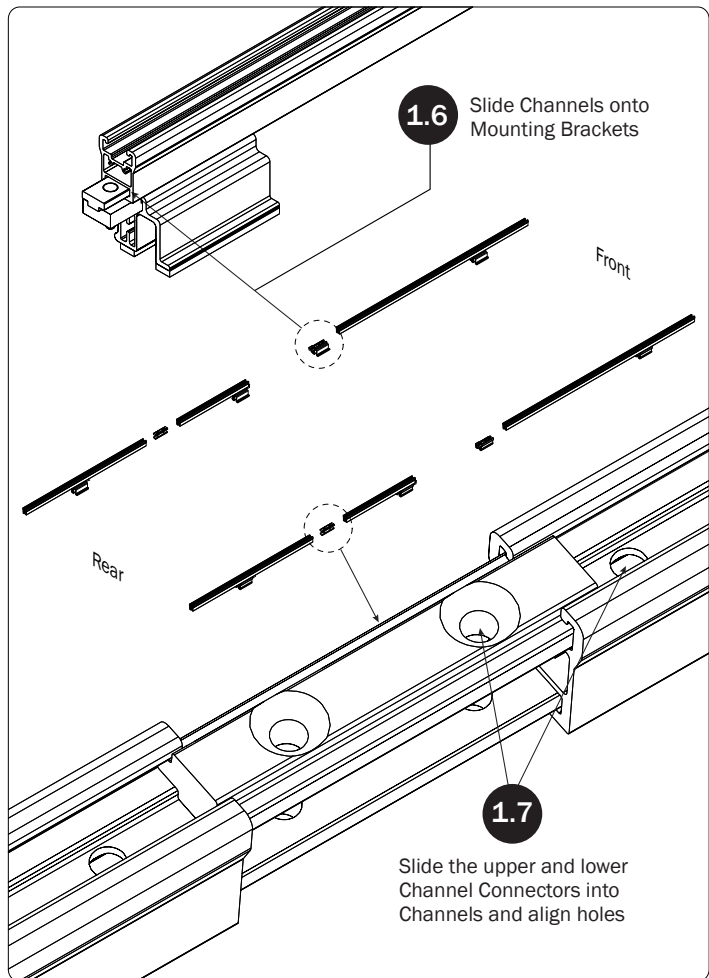
**1.8**

Screw the M8 x 40MM Allen Head bolts into the Upper and Lower Channel Splices. Due to tight manufacturing tolerances, both bolts must remain loose until Step 1.9

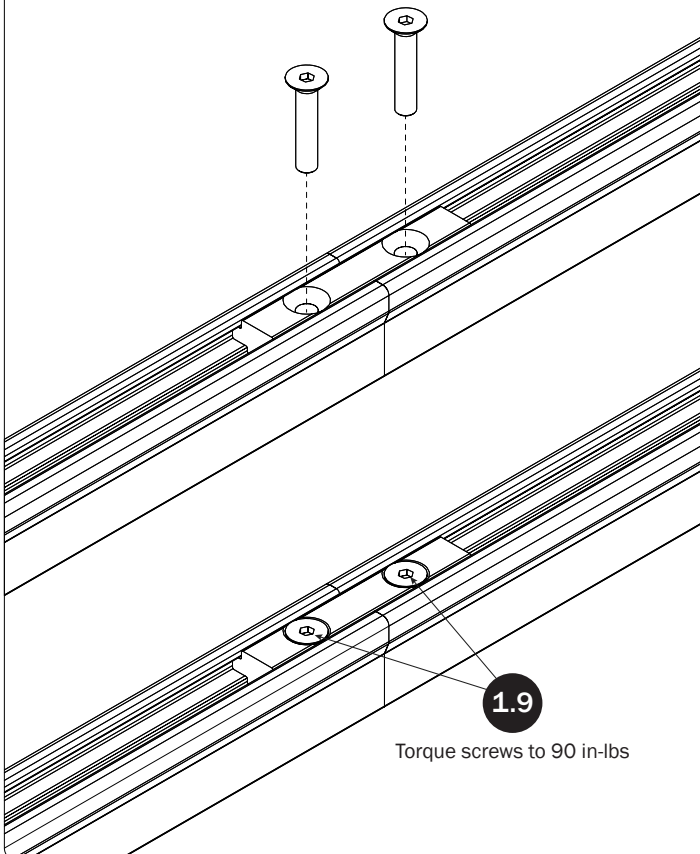
**1.10**

Set to distances shown below, then torque Mounting Bracket nuts loosened at Step 1.5 to 80 in-lbs

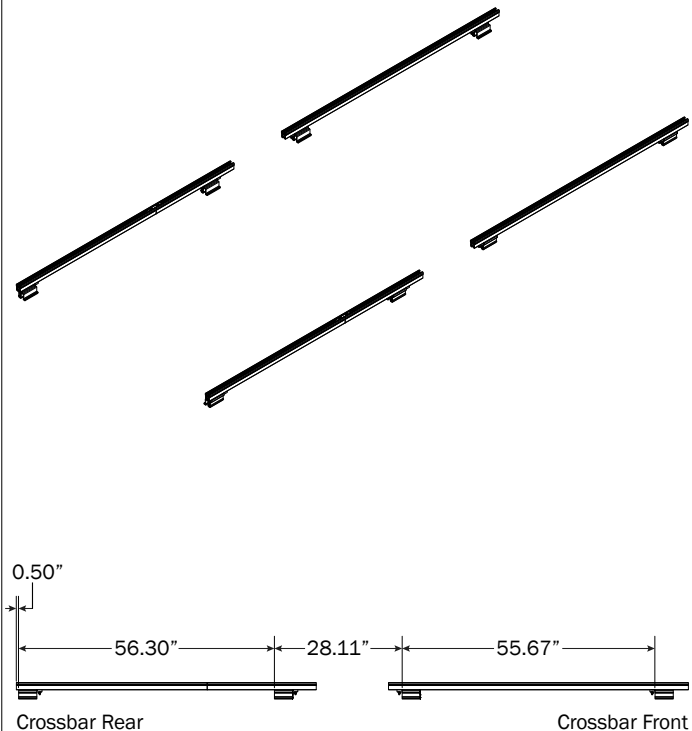

## MOUNTING BRACKETS

- 2.1** Slide the Aluminum Strip Nuts into each end of the Channels, and attach the Channel Caps

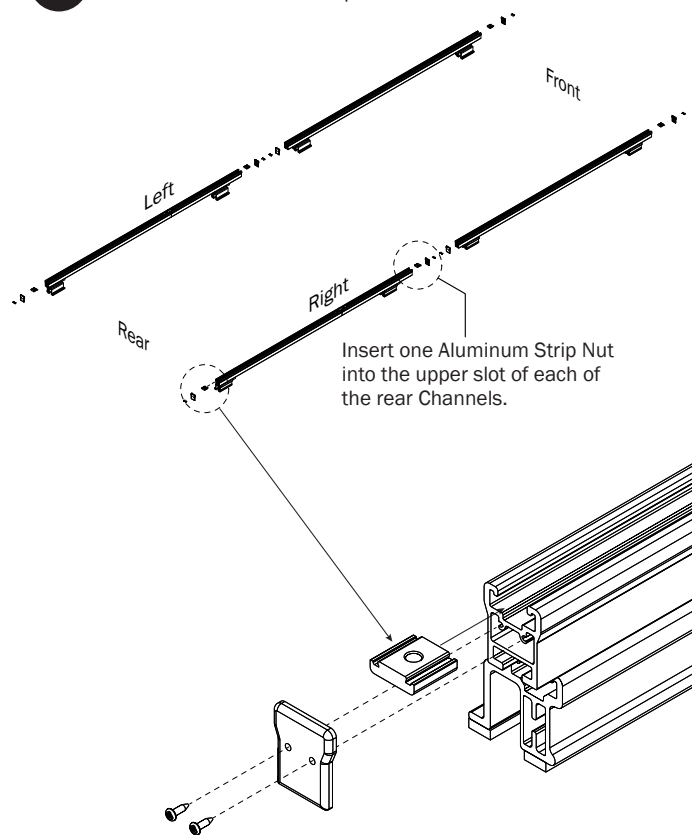

- 2.2** Using the supplied fastening hardware, attach the Crossbar Mounting Brackets into the Aluminum Strip Nuts placed into the Channels at Step 2.1

3 Crossbar models:  
Position the center  
Mounting Brackets  
as shown.

\*2 & 3 Crossbar models:  
Position the front Mounting  
Brackets as shown.

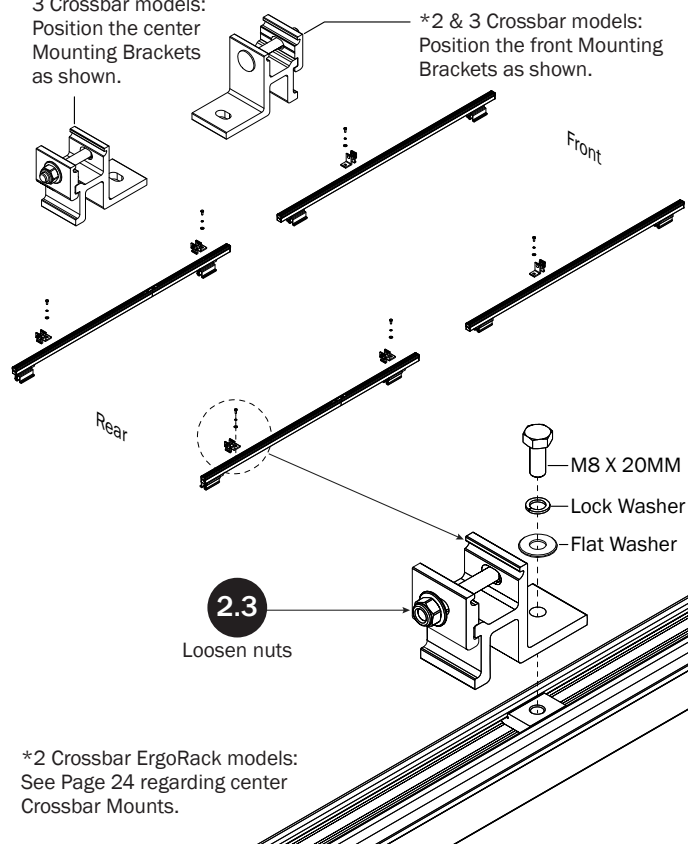

\*2 Crossbar ErgoRack models:  
See Page 24 regarding center  
Crossbar Mounts.

- 2.4** Set to distances shown below:  
Use Dimensions A for 2 Crossbar models.  
Use Dimensions B for 3 Crossbar models.

Do not torque the Crossbar Mounting Brackets until Step 3.4.  
Finger-tighten them into designated dimension to hold them in  
place, then proceed to your Feature (FEA) Assembly Manual.

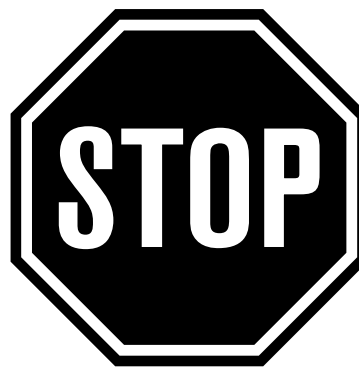
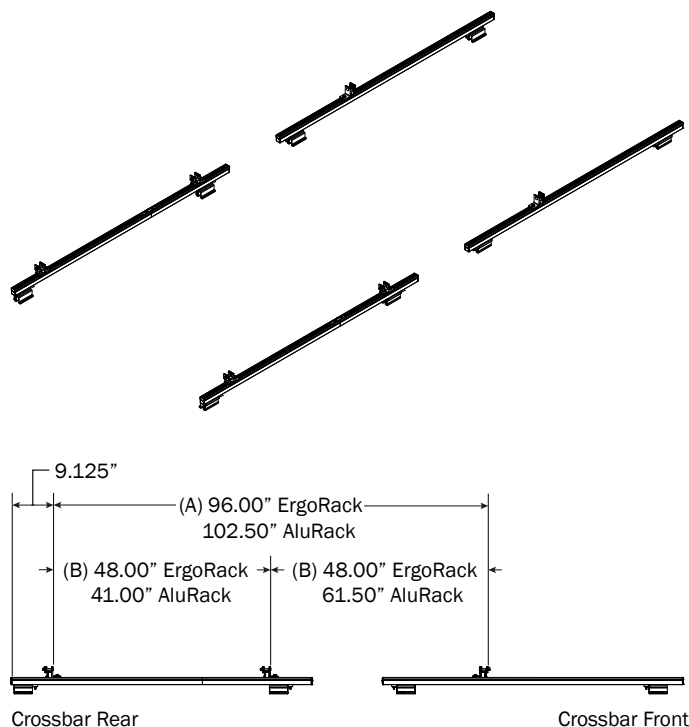

Do not mount the Crossbars to this FBM system at this time.

Refer to the respective FEA Assembly Manual(s) included  
with your chosen rack configuration features. Depending  
upon the features chosen, you may need to perform a  
complete feature assembly onto the Crossbars as noted in  
that feature's Assembly Manual.

**WARNING:** Failure to position the Crossbars as shown in this  
FBM Assembly Manual may result in damage to the sliding  
door and/or ladder rack.

**NOTE:** Base, Clamp Down, or Rotation features are not  
included in this FBM kit, and must be purchased separately.  
To purchase applicable features and accessories, please  
contact your authorized distributor, or a Prime Design Sales  
& Service Representative.

## CROSSBARS (ERGORACK)

Shown with LH Base, and  
RH Rotation for illustrative  
purposes only

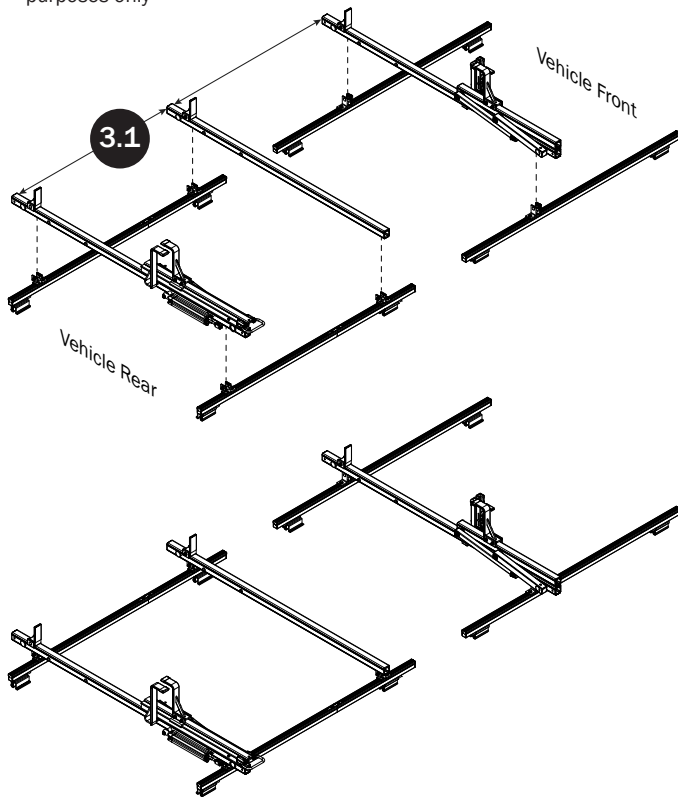

## CROSSBAR ADJUSTMENT

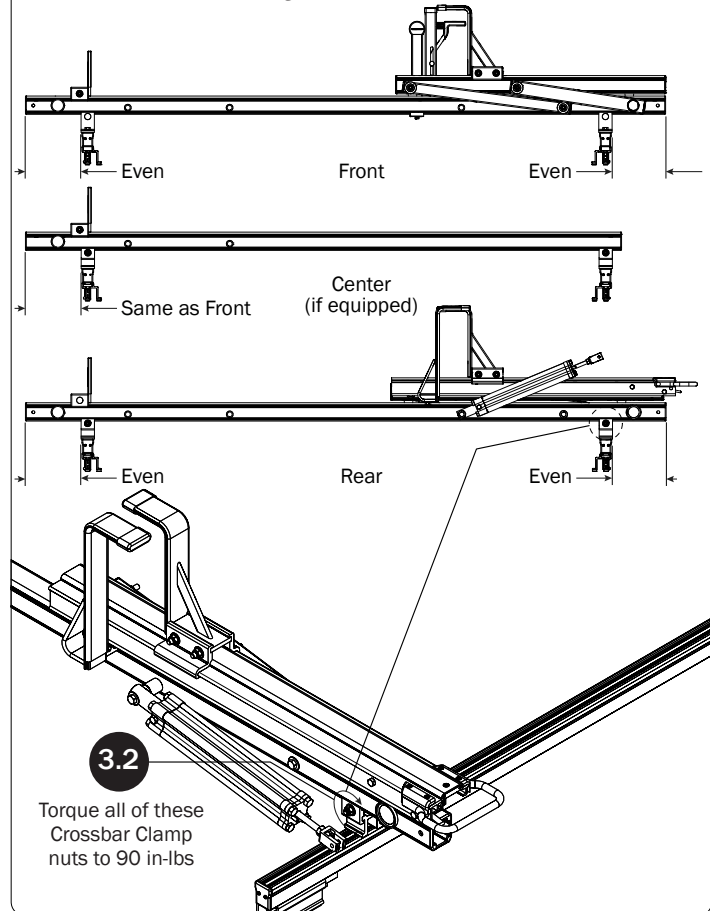

3.3

Verify the specified  
distance from the  
ends of both Mounting  
Bracket to the ends of  
both Channels.

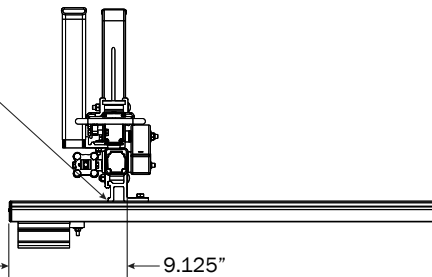

3.4

3.4

Toward Vehicle Front

Torque only the Rear Crossbar Mounting  
Bracket bolts to 90 in-lbs at this time.

The Center (if equipped) and Front  
Crossbar Mounting Brackets will  
be torqued to specification when  
designated in the respective Feature  
(FEA) Assembly Manual.

**CROSSBARS (ALURACK)**

Shown with L5H2 AluRack  
for illustrative purposes only

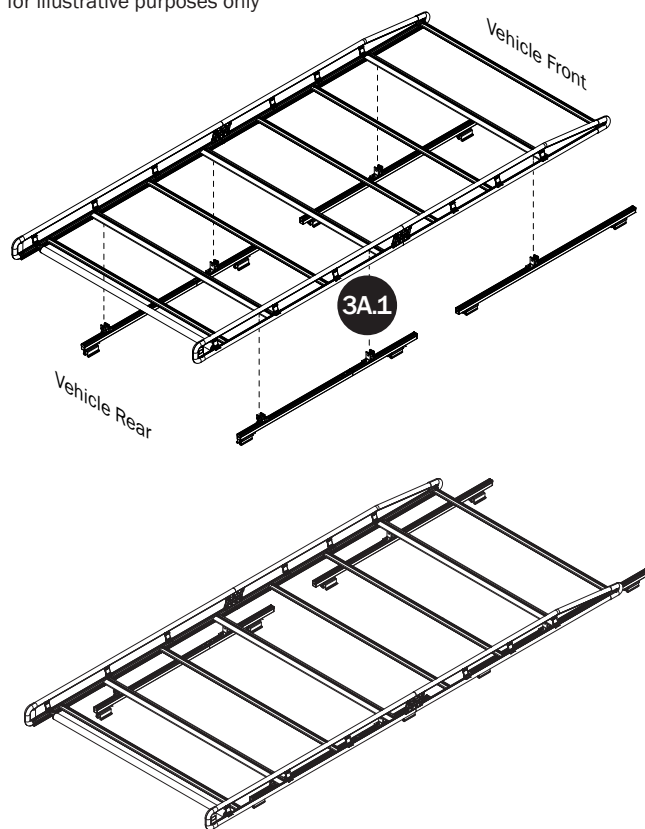
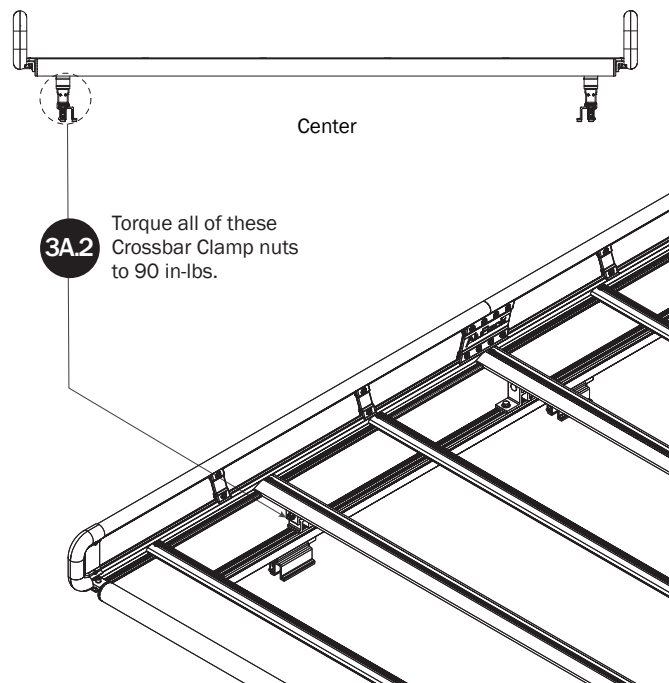
**CROSSBAR  
ADJUSTMENT****3A.3**

Verify the specified  
distance from the  
ends of both Mounting  
Bracket to the ends of  
both Channels.

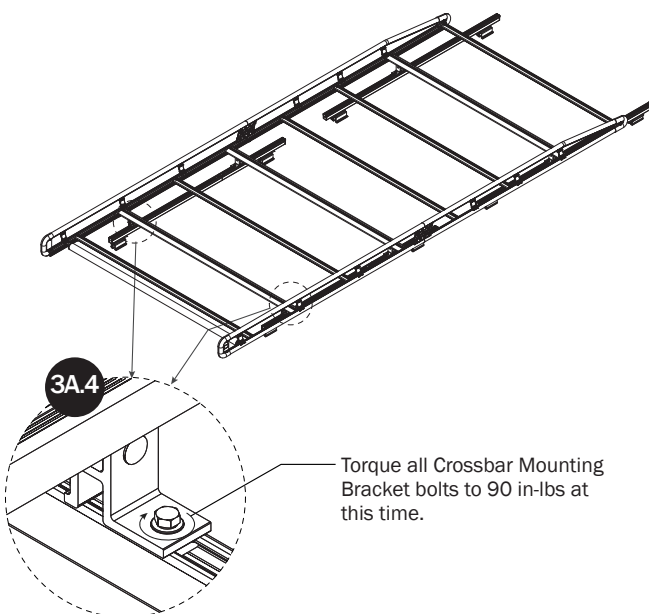
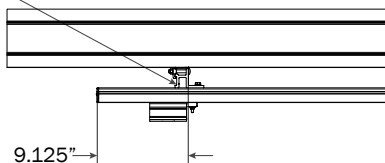



## ***CENTER CROSSBAR MOUNTS*** **FOR 2 CROSSBAR ERGORACK MODELS ONLY**

Place the center Crossbar Mounts into the vehicle's glove box for future use.

