

# PRIME DESIGN™

A Safe Fleet Brand

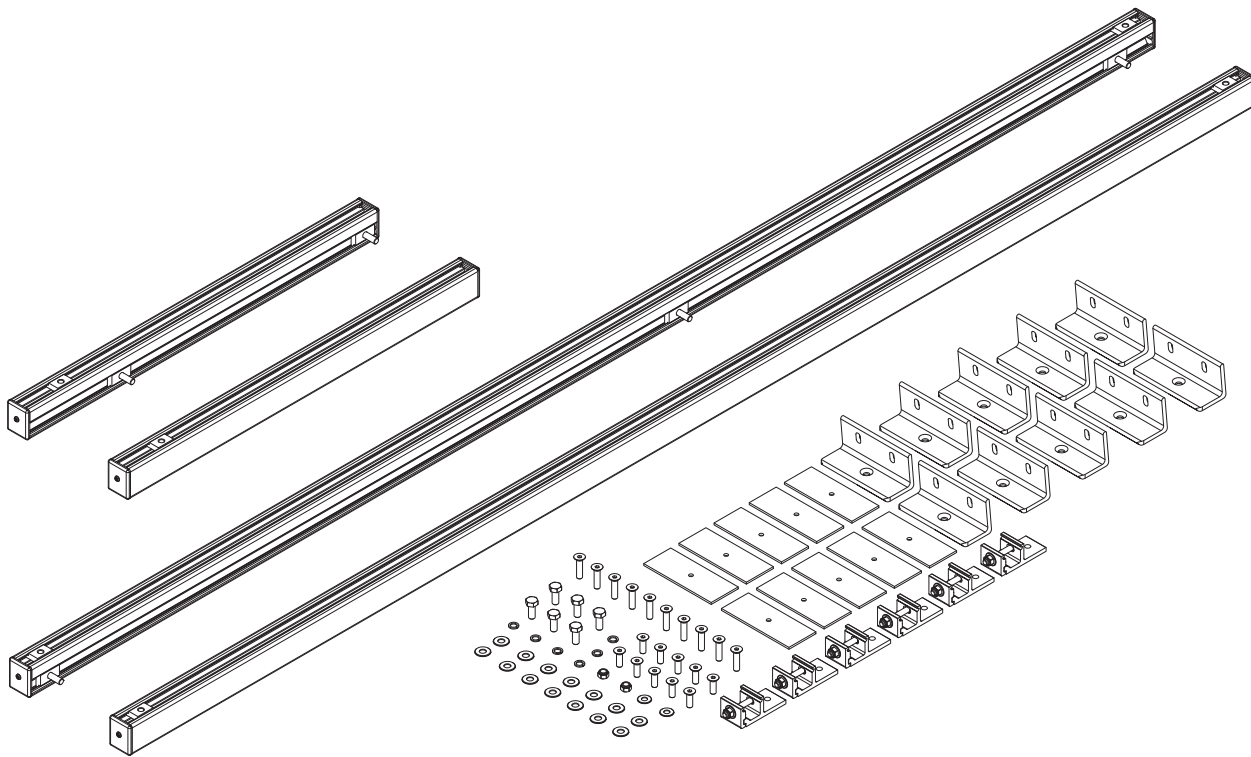

# FBM-1017

## 2015+ Ford Transit Low/Mid/High Roof Base Mounting Kit

Pages 2-3	Packaging Contents
Pages 4-7	Low Roof Medium Wheelbase (130")
Pages 8-11	Low Roof Long Wheelbase (148")
Pages 12-15	Mid/High Roof Medium Wheelbase (130")
Pages 16-19	Mid/High Roof Long Wheelbase (148")
Pages 20-23	Mid/High Roof Long Wheelbase Extended Length (148")

**CONTENTS OVERVIEW****TWO & THREE CROSSBAR CONFIGURATIONS**

**NOTE:** This Manual contains information covering two and three Crossbar configurations. If your model is a two Crossbar configuration (ErgoRack only), disregard all Center Crossbar installation information.

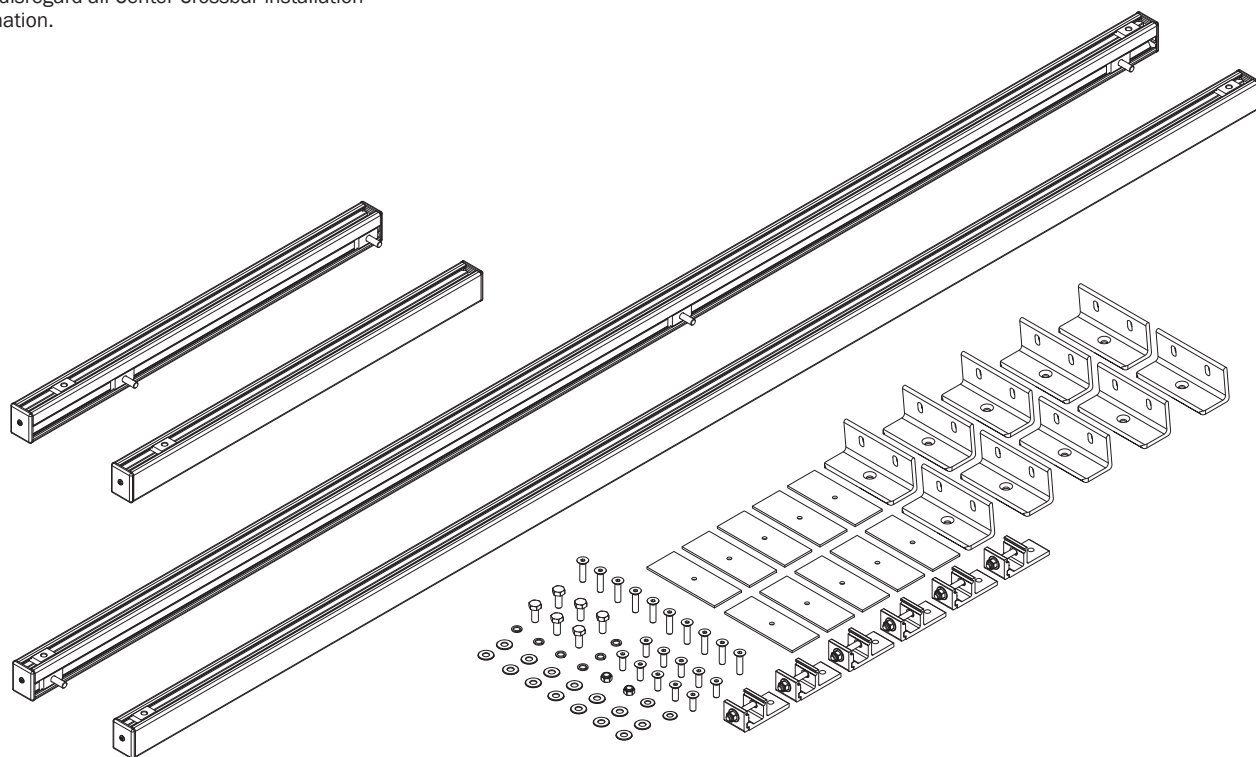

1—FBM-1017 ..... (Qty 1)  
Channels, 116" w/HKT-0132 Hardware Kit



23" Channels (2X)



74" Channels, Pre-assembled (2X)

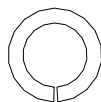
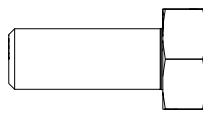

Channel Bracket (6X)

 $\frac{5}{16}$ " Lock Washer (6X)

M8 x 20MM (6X)

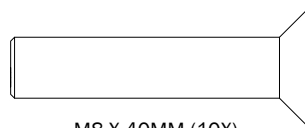

M8 X 40MM (10X)

\*See Note



M8 X 25MM (10X)

\*See Note

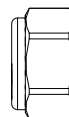

M8 Lock Nut (10X)

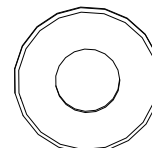
 $\frac{5}{16}$ " Flat Washer (14X)

Mounting Bracket (10X)



Foam Pad (10X)

**NOTE:** OEM threaded tie in heights may require included M8 X 40 MM Flat Head Bolt. Please check to ensure sufficient engagement of threads is achieved.



Anti-Seize (1X)

2—Crossbars (shown for illustrative purposes only)  
Ordered separately

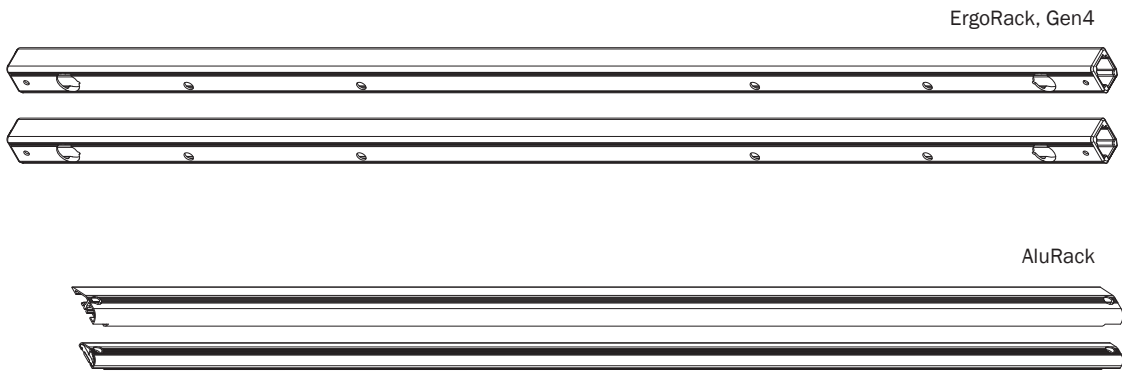

**LOW ROOF MEDIUM WHEEL BASE (130.00")****FBM ASSEMBLY SEQUENCE**

Prior to assembling the Channels and hardware, the OEM roof holes must be chased using an M8 x 1.25 tap and fluid. Doing so will ensure accurate torque is achieved.

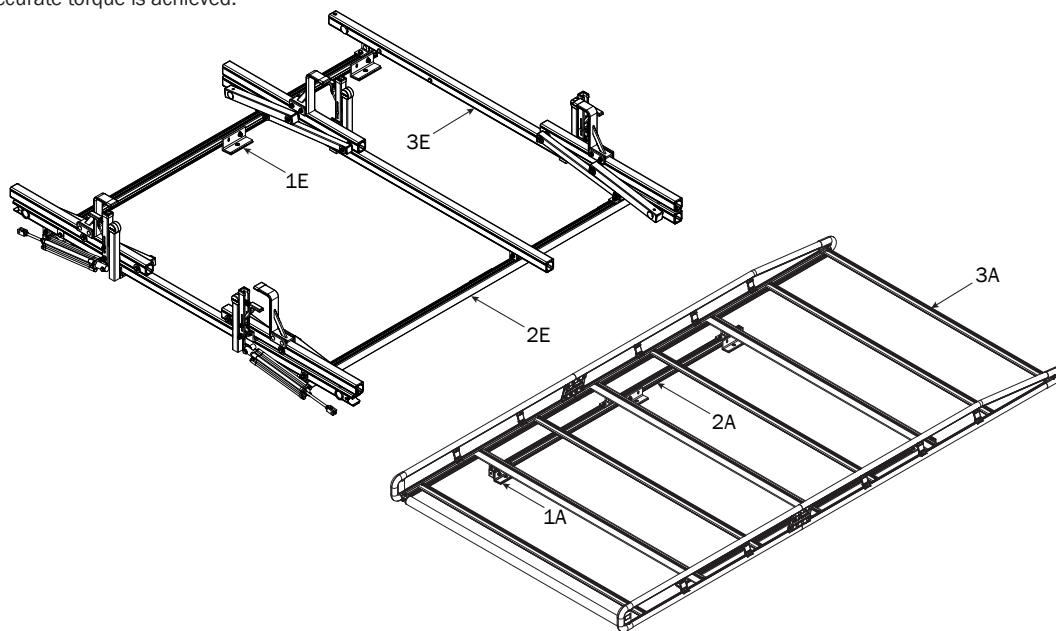

**NOTE:** Base, Rotation, Crossbar, and Side Rail features are shown for illustrative purposes only. These features are not included with this Base Mounting Kit, and must be purchased separately.

**MOUNTING BRACKETS****1**

Apply Anti-Seize to all M8 x 25MM Flat Head Bolts and install the Channel Mounting Brackets with Foam Pads onto the vehicle's roof mounting holes. Do not tighten bolts until Step 2.4.

\* See note on Page 2

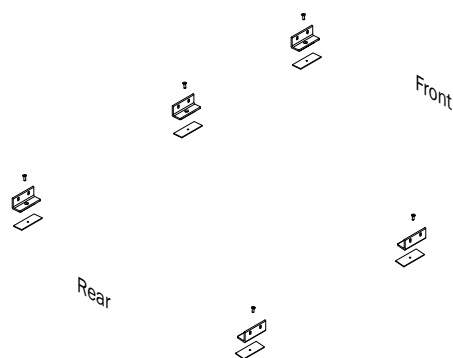

M8 x 25MM Bolt (\*See Note)

Mounting Bracket

Foam Pad

**CHANNELS****2.1**

Apply Anti-Seize to all M8 T Bolt studs, then attach the Channels to the Mounting Brackets using the indicated hardware. Do not tighten until Step 2.3

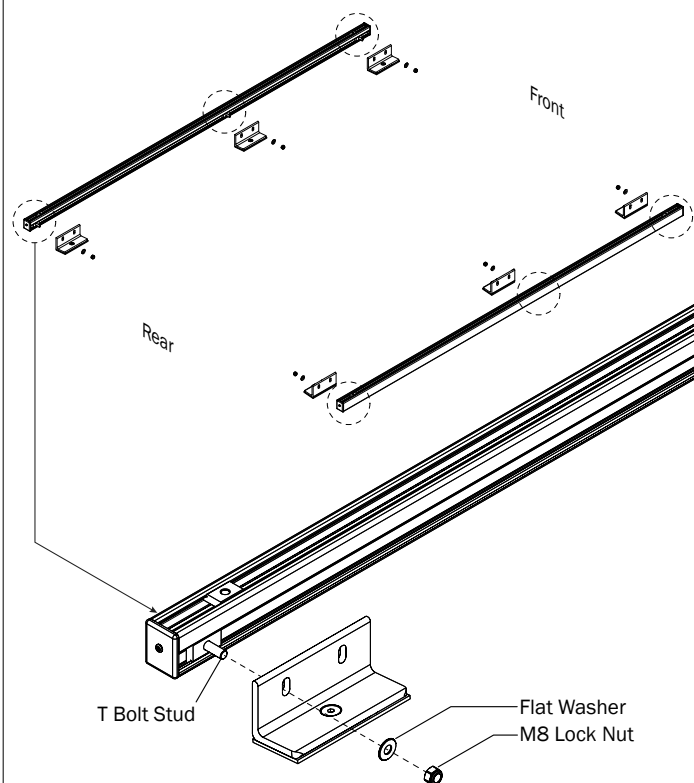

2.2

The Channels include aluminum Strip Nuts for a 3 Crossbar configuration. For 2 Crossbar configurations, disregard the extra Strip Nut.

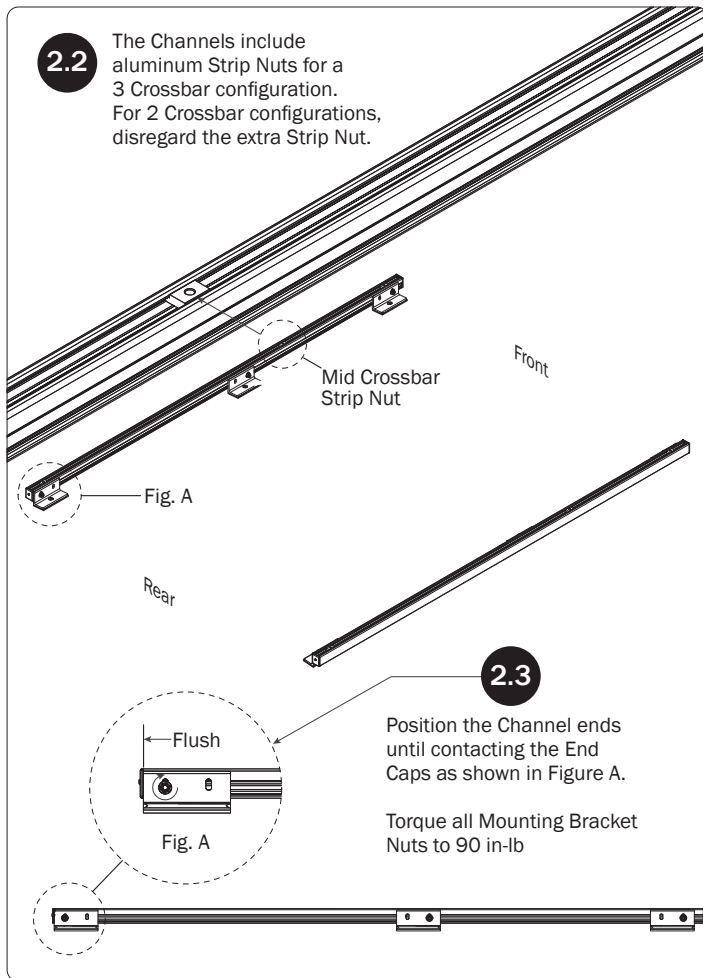

2.4

Torque all M8 x 25MM Flat Head Screws to 150 in-lbs. Apply Silicone Sealant to screw heads to seal against water intrusion.

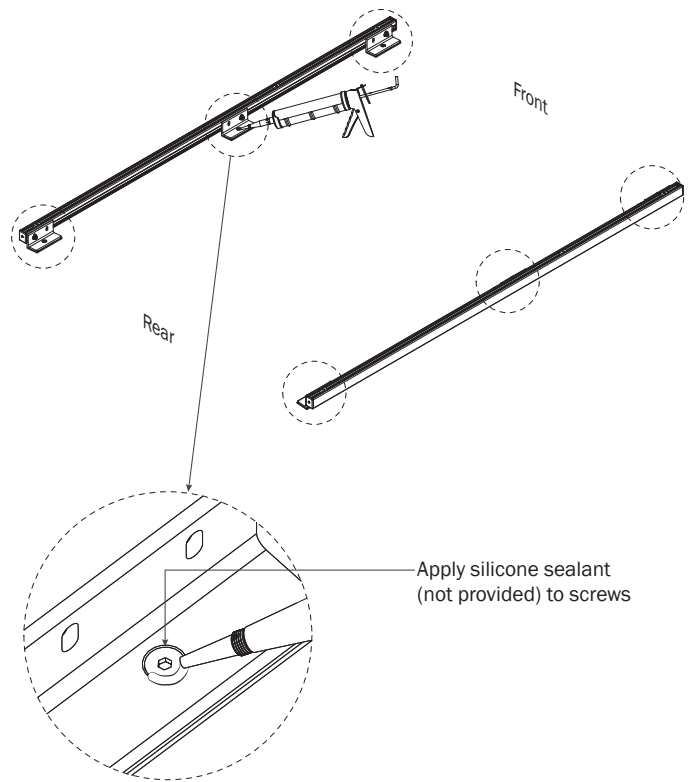

2.5

Attach Mounting Brackets to the Aluminum Strip Nuts located in the Channels

3 Crossbar models: Position the rear and center Mounting Brackets as shown.

\*2 & 3 Crossbar models: Position the front Mounting Brackets as shown.

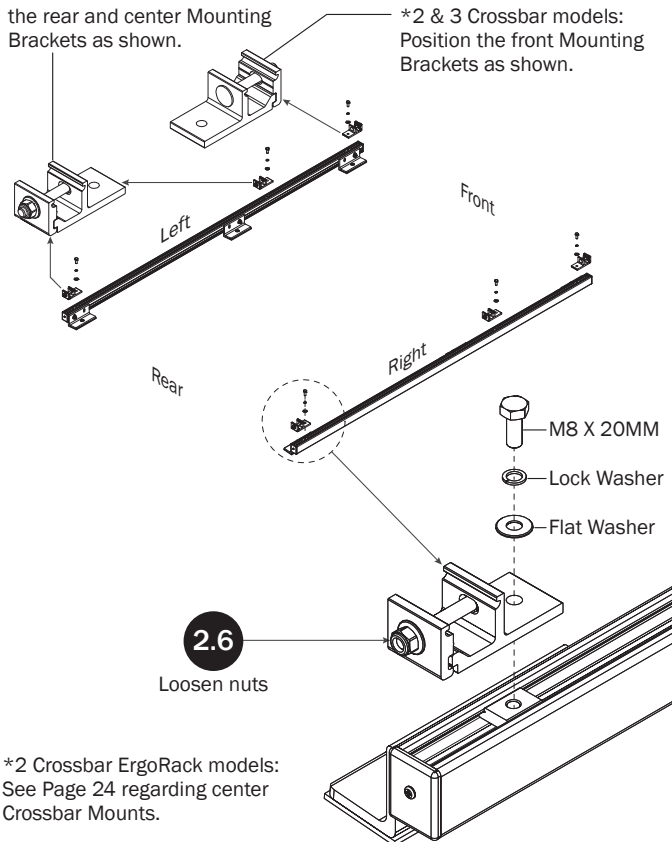

\*2 Crossbar ErgoRack models: See Page 24 regarding center Crossbar Mounts.

2.7

Set to distances shown below:  
Use Dimensions A for 2 Crossbar models.  
Use Dimensions B for 3 Crossbar models.

Do not torque the Crossbar Mounting Brackets until Step 3.4. Finger-tighten them into designated dimension to hold them in place, then proceed to your Feature (FEA) Assembly Manual.

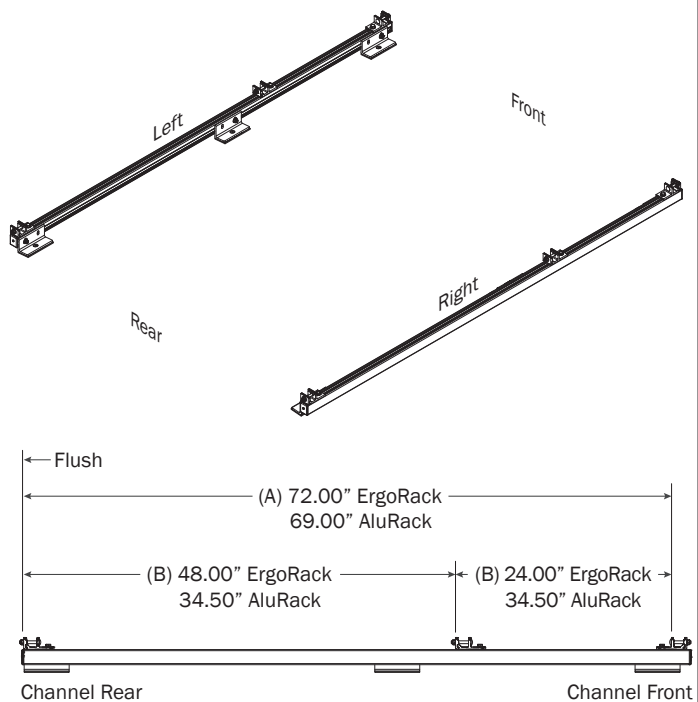



Do not mount the Crossbars to this FBM system at this time.

Refer to the respective FEA or AR Assembly Manual(s) included with your chosen rack configuration features. Depending upon the features chosen, you may need to perform a complete feature assembly onto the Crossbars or Side Rails as noted in that feature's Assembly Manual.

**WARNING:** Failure to position the Crossbars as shown in this FBM Assembly Manual may result in damage to the sliding door and/or ladder rack.

**NOTE:** Crossbars, Side Rails, Base, Clamp Down, or Rotation features are not included in this FBM kit, and must be purchased separately. To purchase applicable features and accessories, please contact your authorized distributor, or a Prime Design Sales & Service Representative.

### CROSSBAR ADJUSTMENT

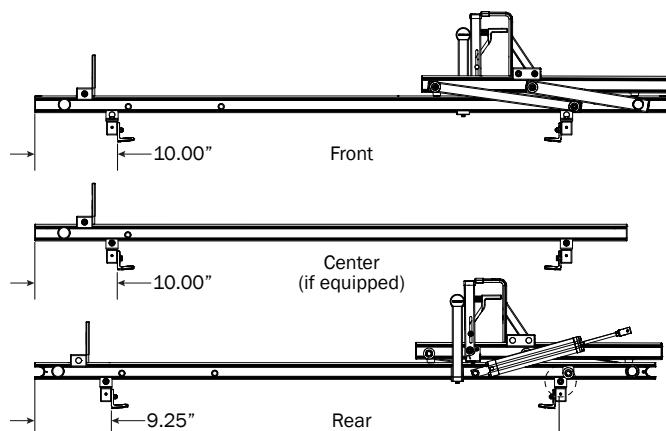

\* NOTE-VBB and VCC Rack Models (no Rotations): Offsets are even on the Left and Right sides.

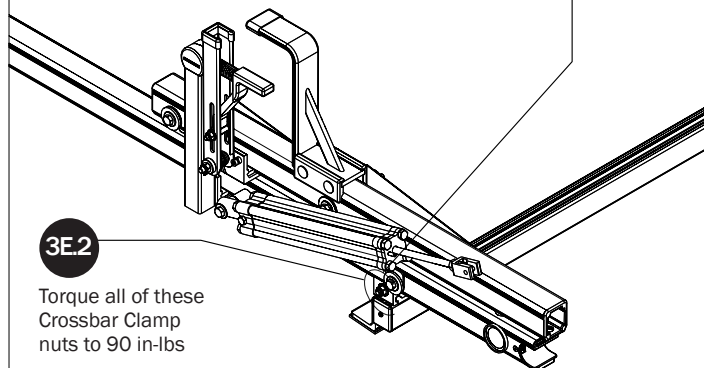

Torque all of these Crossbar Clamp nuts to 90 in-lbs

### CROSSBARS

Shown with LH Base, and RH Rotation for illustrative purposes only

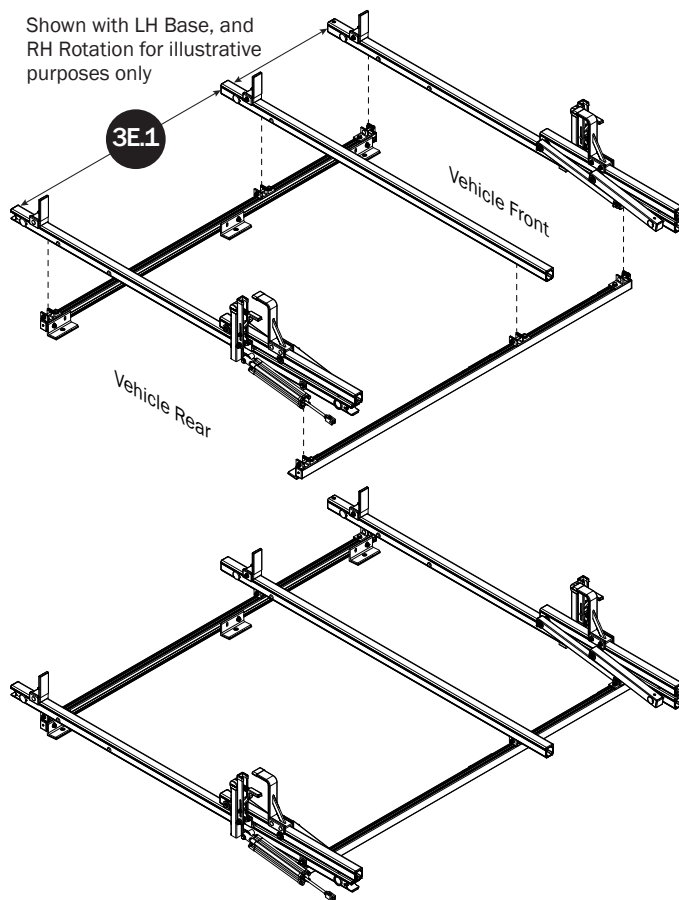

3E3

Verify the specified distance from the ends of both Rear Crossbar Mounting Brackets to the ends of both Channels.

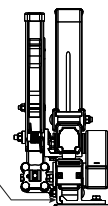

Flush to rear of Channel

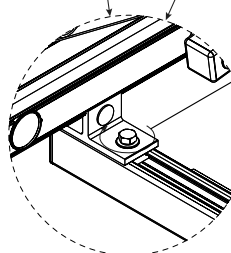
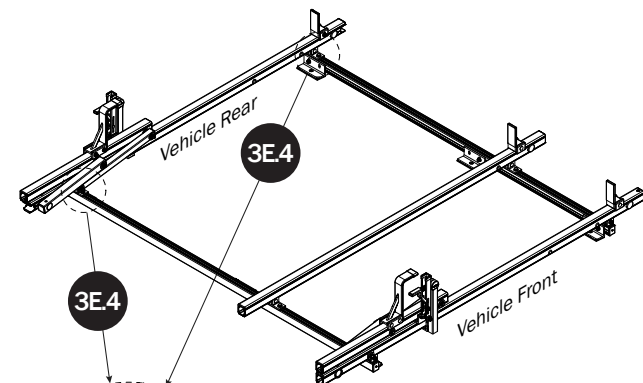

Torque only the Rear Crossbar Mounting Bracket bolts to 90 in-lbs at this time.

The Center (if equipped) and Front Crossbar Mounting Brackets will be torqued to specification when designated in the respective Feature (FEA) Assembly Manual.

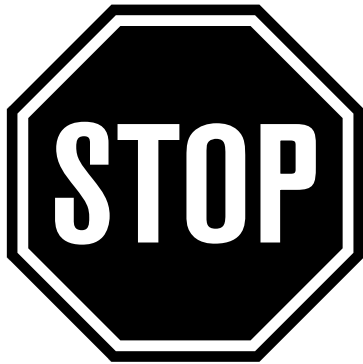

Do not mount the Crossbars to this FBM system at this time.

Refer to the respective FEA or AR Assembly Manual(s) included with your chosen rack configuration features. Depending upon the features chosen, you may need to perform a complete feature assembly onto the Crossbars or Side Rails as noted in that feature's Assembly Manual.

**WARNING:** Failure to position the Crossbars as shown in this FBM Assembly Manual may result in damage to the sliding door and/or ladder rack.

**NOTE:** Crossbars, Side Rails, Base, Clamp Down, or Rotation features are not included in this FBM kit, and must be purchased separately. To purchase applicable features and accessories, please contact your authorized distributor, or a Prime Design Sales & Service Representative.

## CROSSBARS (ALURACK)

Shown with LR MWB  
AluRack for illustrative  
purposes only

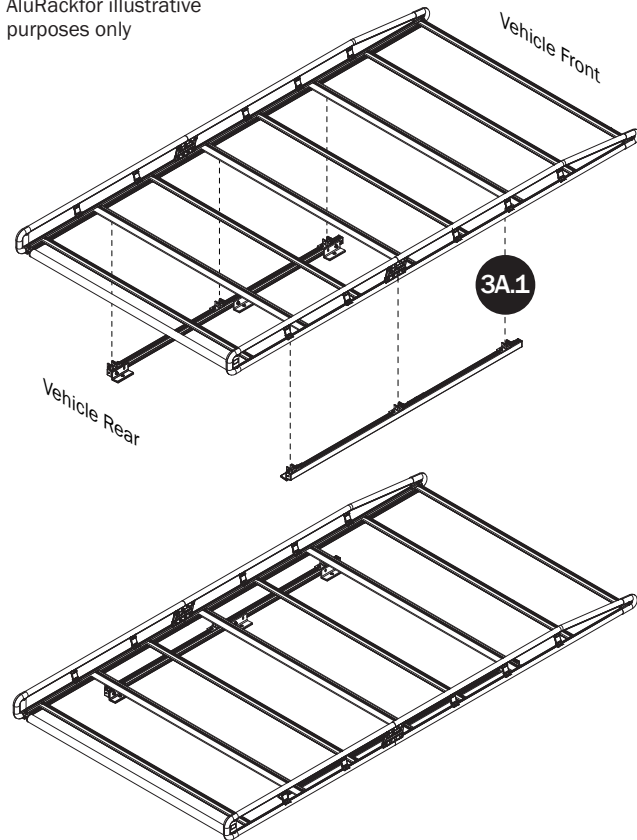

## CROSSBAR ADJUSTMENT

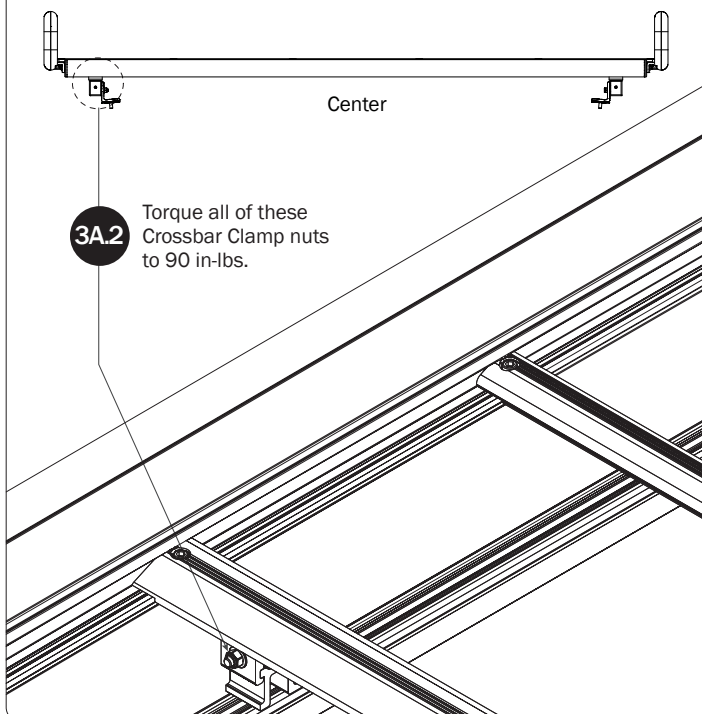

**3A.2** Torque all of these  
Crossbar Clamp nuts  
to 90 in-lbs.

**3A.3**

Verify the specified  
distance from the  
ends of both Mounting  
Bracket to the ends of  
both Channels.

Flush to rear  
of Channel

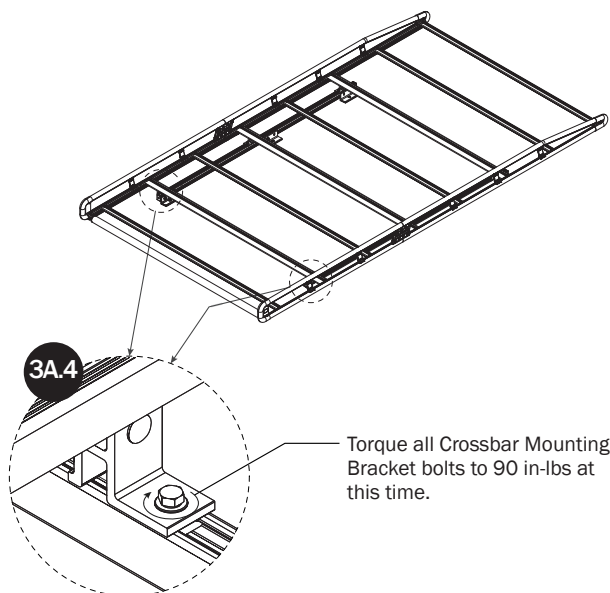

**3A.4**

Torque all Crossbar Mounting  
Bracket bolts to 90 in-lbs at  
this time.

**LOW ROOF LONG WHEEL BASE (148.00")****FBM ASSEMBLY SEQUENCE**

Prior to assembling the Channels and hardware, the OEM roof holes must be chased using an M8 x 1.25 tap and fluid. Doing so will ensure accurate torque is achieved.

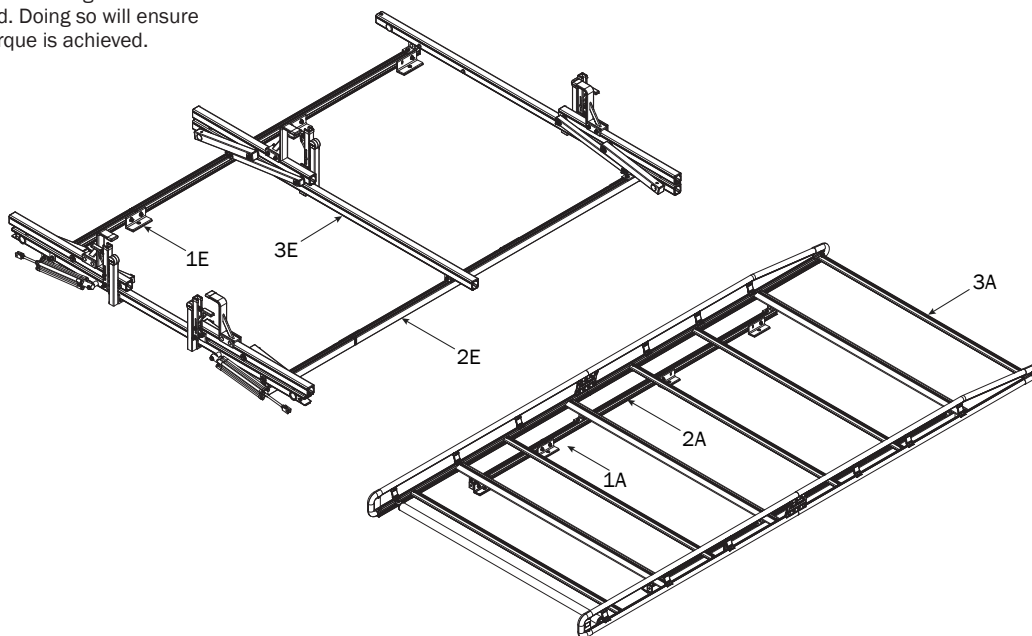

*NOTE: Base, Rotation, Crossbar, and Side Rail features are shown for illustrative purposes only. These features are not included with this Base Mounting Kit, and must be purchased separately.*

**MOUNTING BRACKETS****1**

Apply Anti-Seize to all M8 x 25MM Flat Head Screws and install the Channel Mounting Brackets with Foam Pads onto the vehicle's roof mounting holes. Do not tighten screws until Step 2.4

\* See note on Page 2

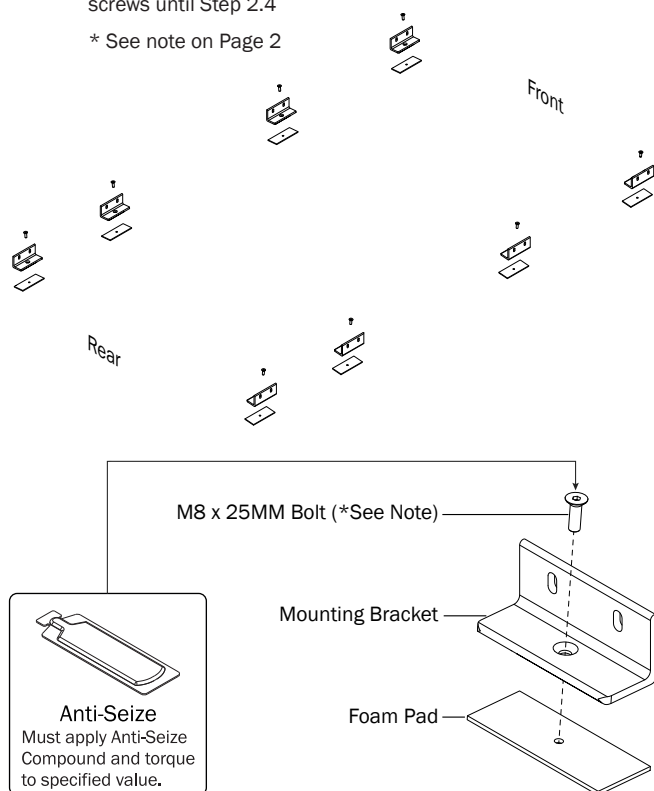
**CHANNELS****2.1**

Apply Anti-Seize to all M8 T Bolt studs, then attach to Mounts using the indicated hardware. Do not tighten until Step 2.3

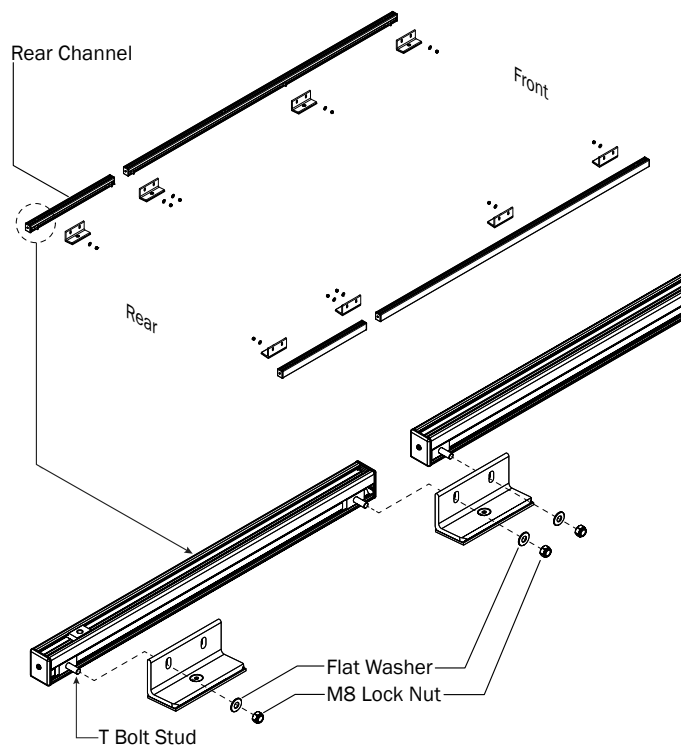

2.2

The Channels include aluminum Strip Nuts for a 3 Crossbar configuration. For 2 Crossbar configurations, disregard the extra Strip Nut.

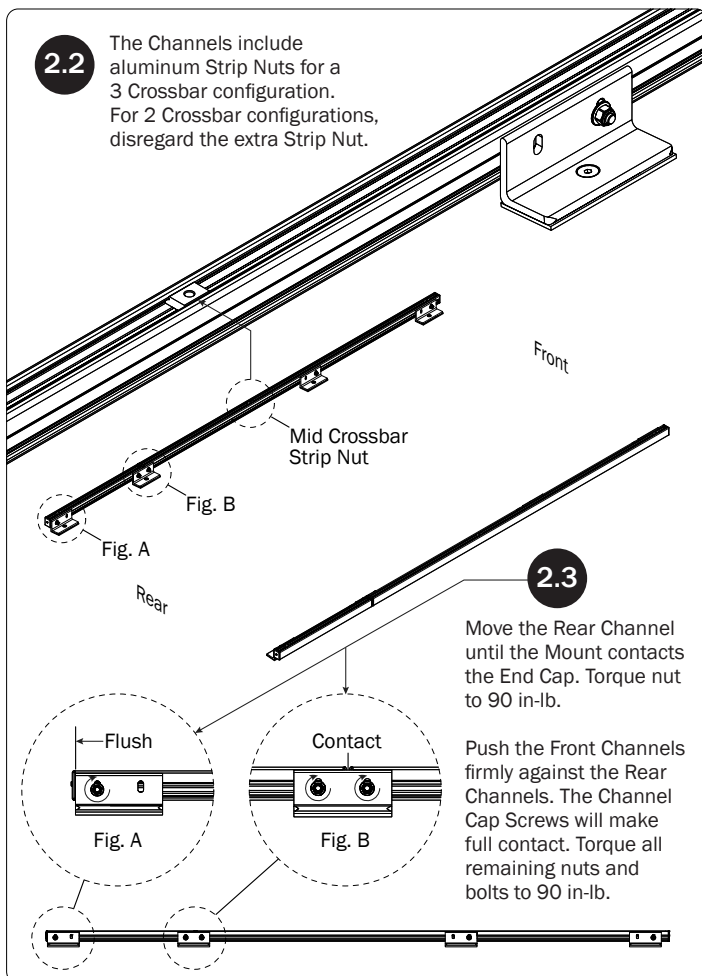

2.3

Move the Rear Channel until the Mount contacts the End Cap. Torque nut to 90 in-lb.

Push the Front Channels firmly against the Rear Channels. The Channel Cap Screws will make full contact. Torque all remaining nuts and bolts to 90 in-lb.

2.4

Torque all M8 x 25MM Flat Head Screws to 150 in-lbs. Apply Silicone Sealant to screw heads to seal against water intrusion.

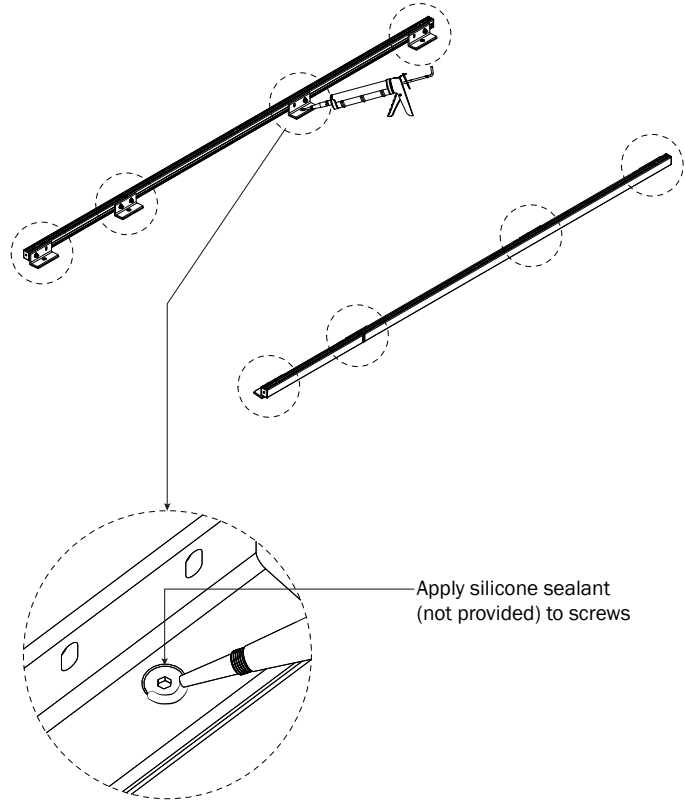

2.5

Attach Mounting Brackets to the Aluminum Strip Nuts located in the Channels

3 Crossbar models: Position the rear and center Mounting Brackets as shown.

\*2 & 3 Crossbar models: Position the front Mounting Brackets as shown.

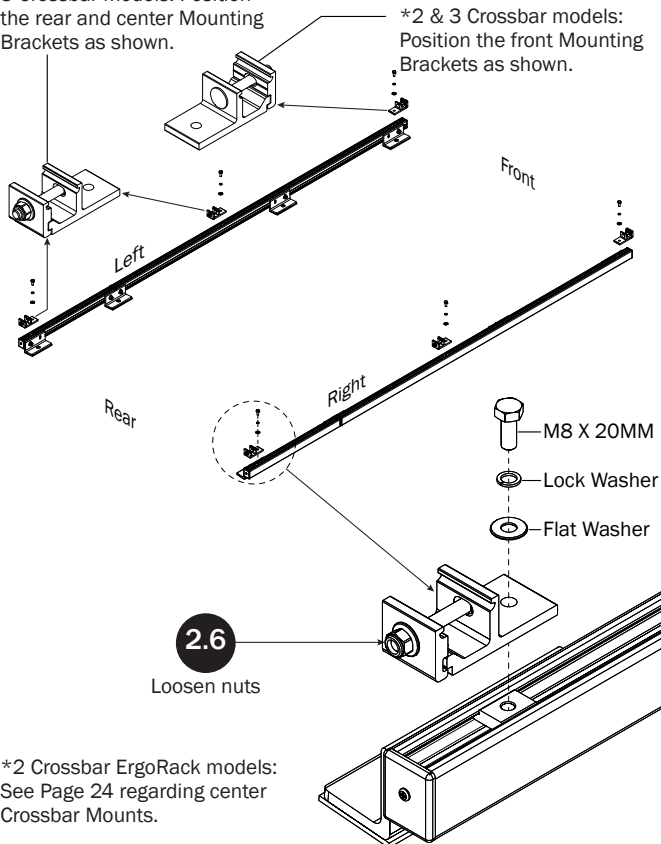

2.7

Set to distances shown below:  
Use Dimensions A for 2 Crossbar models.  
Use Dimensions B for 3 Crossbar models.

Do not torque the Crossbar Mounting Brackets until Step 3.4. Finger-tighten them into designated dimension to hold them in place, then proceed to your Feature (FEA) Assembly Manual.

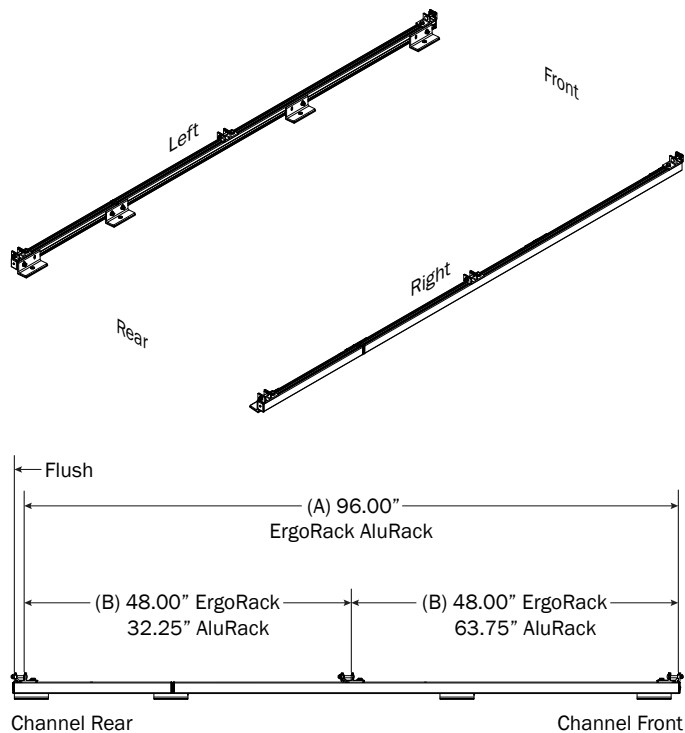

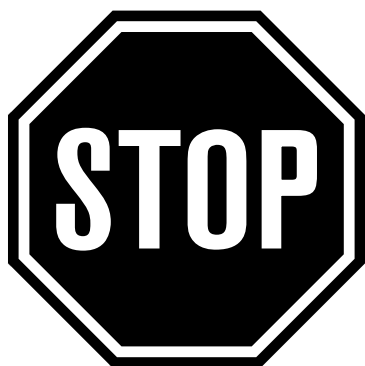

Do not mount the Crossbars to this FBM system at this time.

Refer to the respective FEA or AR Assembly Manual(s) included with your chosen rack configuration features. Depending upon the features chosen, you may need to perform a complete feature assembly onto the Crossbars or Side Rails as noted in that feature's Assembly Manual.

**WARNING:** Failure to position the Crossbars as shown in this FBM Assembly Manual may result in damage to the sliding door and/or ladder rack.

**NOTE:** Crossbars, Side Rails, Base, Clamp Down, or Rotation features are not included in this FBM kit, and must be purchased separately. To purchase applicable features and accessories, please contact your authorized distributor, or a Prime Design Sales & Service Representative.

## CROSSBARS

Shown with LH Base, and RH Rotation for illustrative purposes only

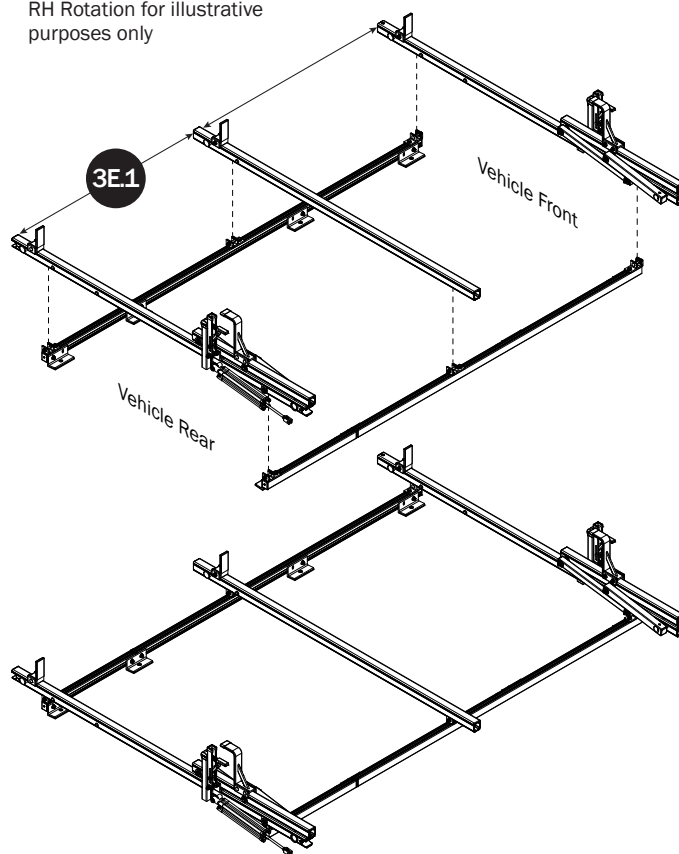

## CROSSBAR ADJUSTMENT

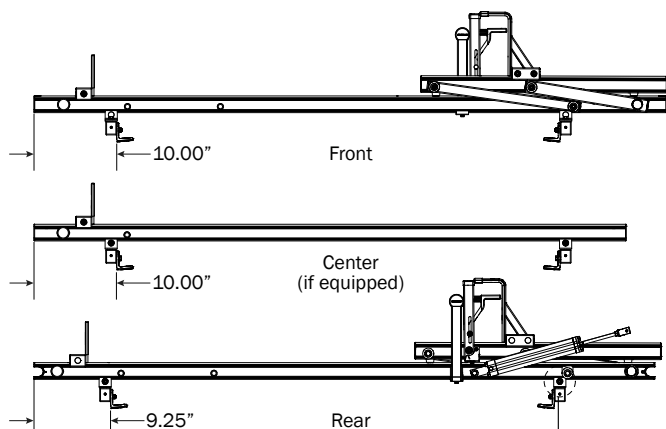

\* NOTE-VBB and VCC Rack Models (no Rotations): Offsets are even on the Left and Right sides.

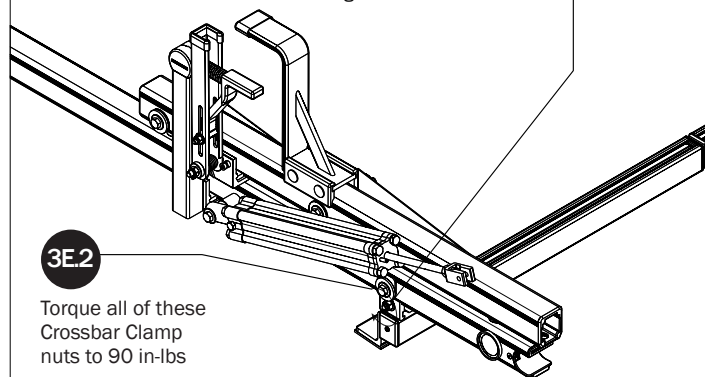

Torque all of these Crossbar Clamp nuts to 90 in-lbs

3E.3

Verify the specified distance from the ends of both Rear Crossbar Mounting Brackets to the ends of both Channels.

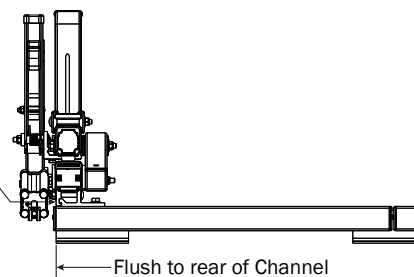

Flush to rear of Channel

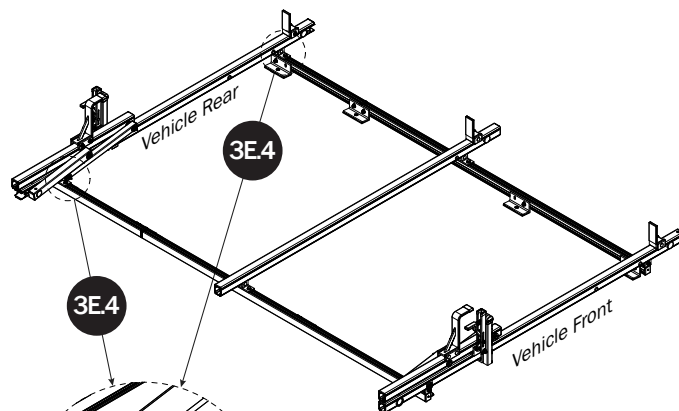

3E.4

Torque only the Rear Crossbar Mounting Bracket bolts to 90 in-lbs at this time.

The Center (if equipped) and Front Crossbar Mounting Brackets will be torqued to specification when designated in the respective Feature (FEA) Assembly Manual.

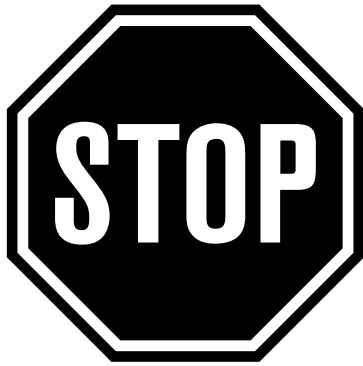

Do not mount the Crossbars to this FBM system at this time.

Refer to the respective FEA or AR Assembly Manual(s) included with your chosen rack configuration features. Depending upon the features chosen, you may need to perform a complete feature assembly onto the Crossbars or Side Rails as noted in that feature's Assembly Manual.

**WARNING:** Failure to position the Crossbars as shown in this FBM Assembly Manual may result in damage to the sliding door and/or ladder rack.

**NOTE:** Crossbars, Side Rails, Base, Clamp Down, or Rotation features are not included in this FBM kit, and must be purchased separately. To purchase applicable features and accessories, please contact your authorized distributor, or a Prime Design Sales & Service Representative.

## CROSSBARS (ALURACK)

Shown with LR LWB AluRack for illustrative purposes only

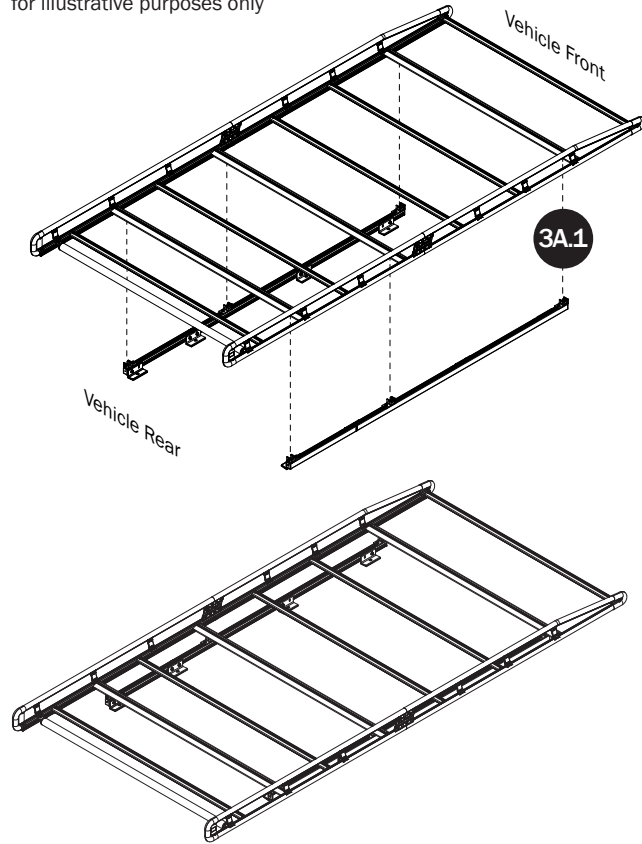

## CROSSBAR ADJUSTMENT

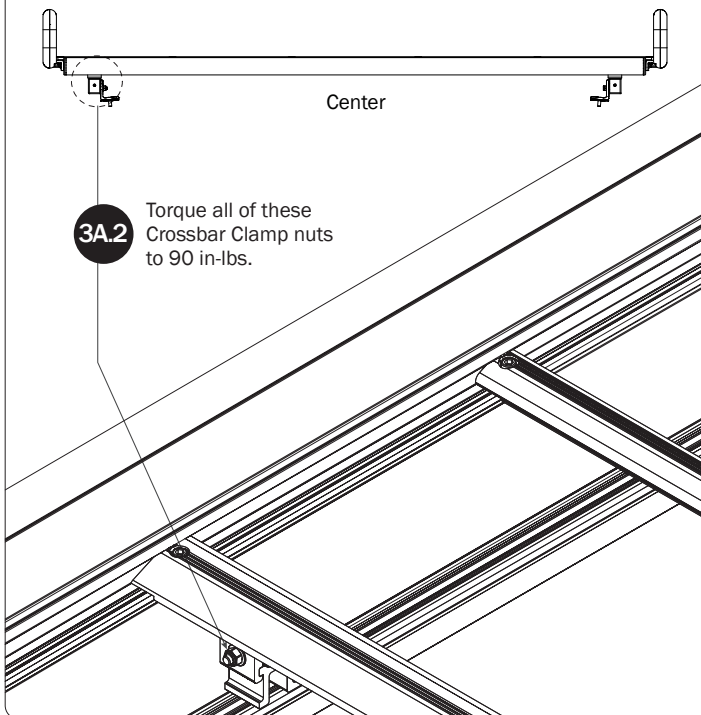

3A.3

Verify the specified distance from the ends of both Mounting Bracket to the ends of both Channels.

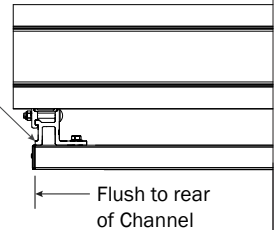

Flush to rear of Channel

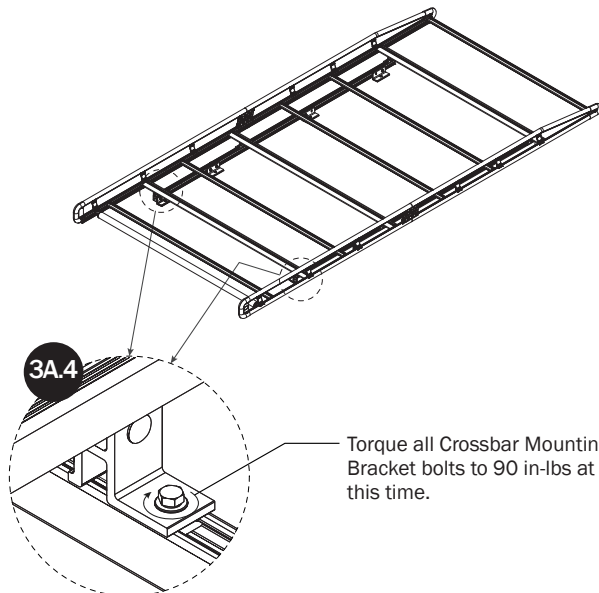

**MID/HIGH ROOF MEDIUM WHEEL BASE (130.00")****FBM ASSEMBLY SEQUENCE**

Prior to assembling the Channels and hardware, the OEM roof holes must be chased using an M8 x 1.25 tap and fluid. Doing so will ensure accurate torque is achieved.

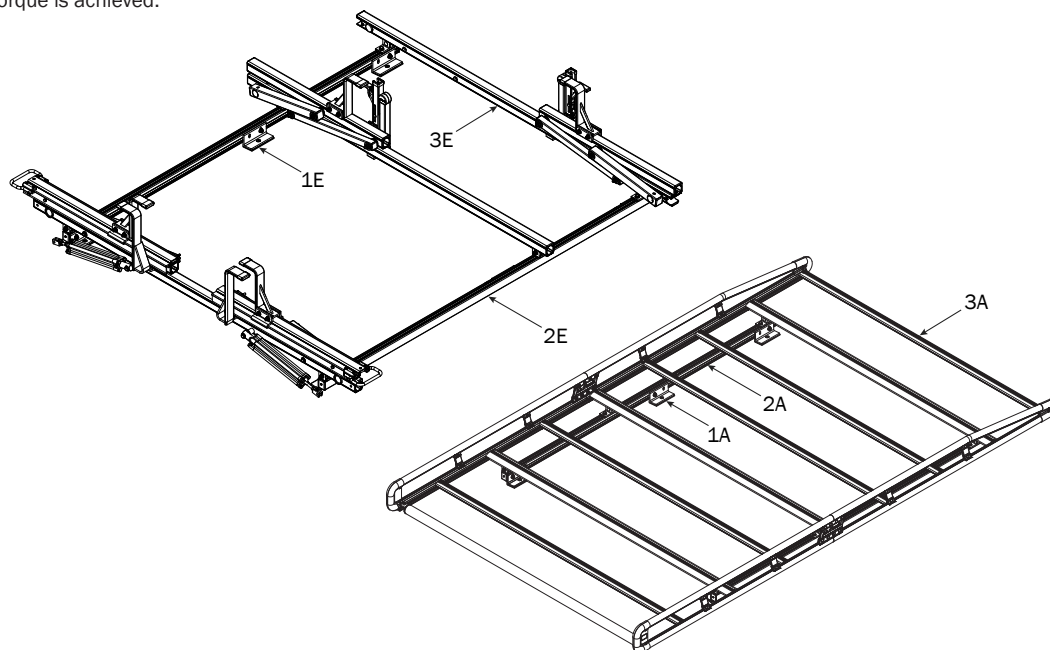

**NOTE:** Base, Rotation, Crossbar, and Side Rail features are shown for illustrative purposes only. These features are not included with this Base Mounting Kit, and must be purchased separately.

**MOUNTING BRACKETS****1**

Apply Anti-Seize to all M8 x 25MM Flat Head Screws and install the Channel Mounting Brackets with Foam Pads onto the vehicle's roof mounting holes. Do not tighten screws until Step 2.4

\* See note on Page 2

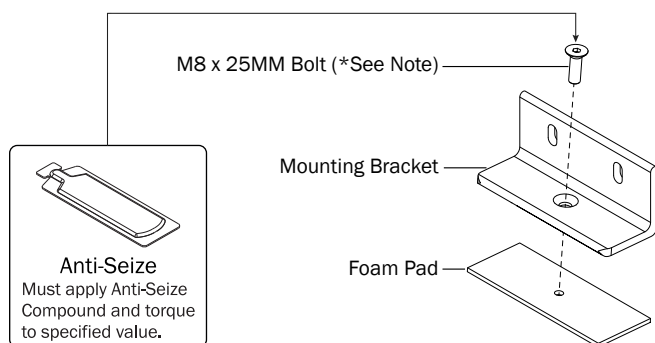
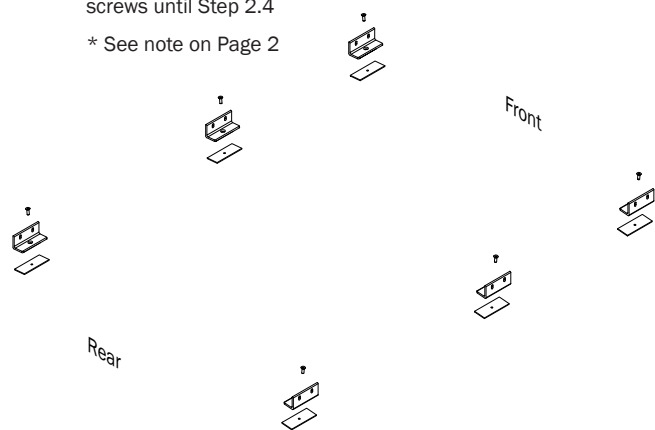
**CHANNELS****2.1**

Apply Anti-Seize to all M8 T Bolt studs, then attach the Channels to the Mounting Brackets using the indicated hardware. Do not tighten until Step 2.3

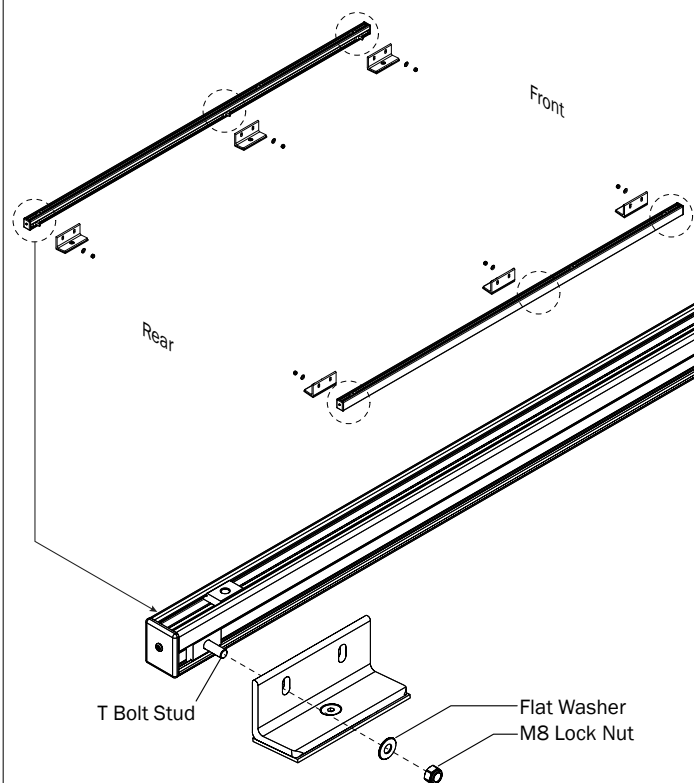

2.2

The Channels include aluminum Strip Nuts for a 3 Crossbar configuration. For 2 Crossbar configurations, disregard the extra Strip Nut.

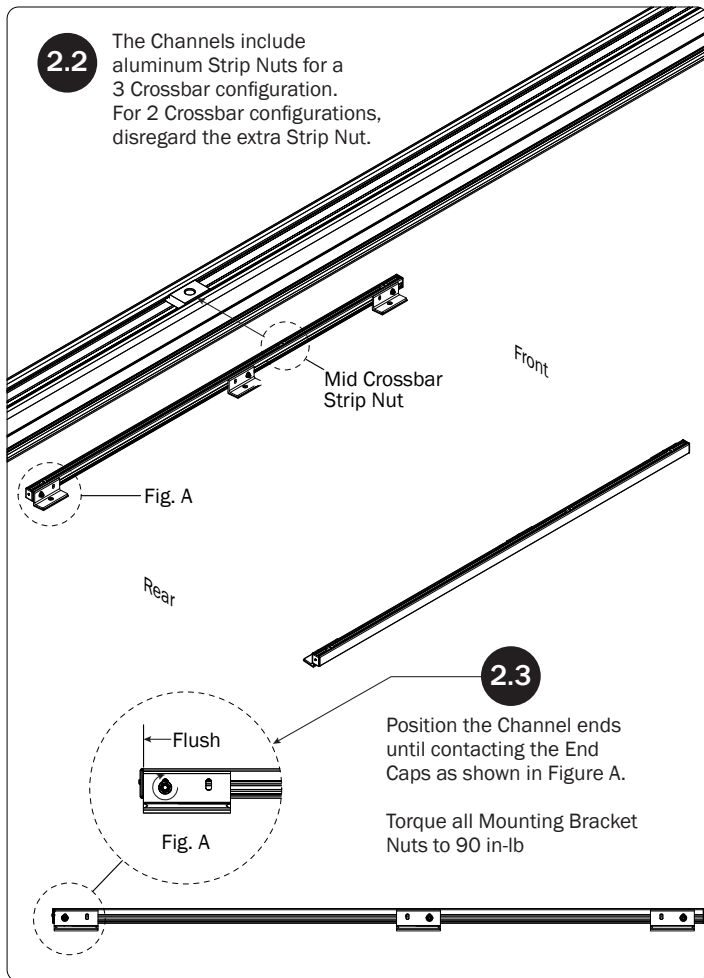

2.3

Position the Channel ends until contacting the End Caps as shown in Figure A.  
Torque all Mounting Bracket Nuts to 90 in-lb

2.4

Torque all M8 x 25MM Flat Head Screws to 150 in-lbs. Apply Silicone Sealant to screw heads to seal against water intrusion.

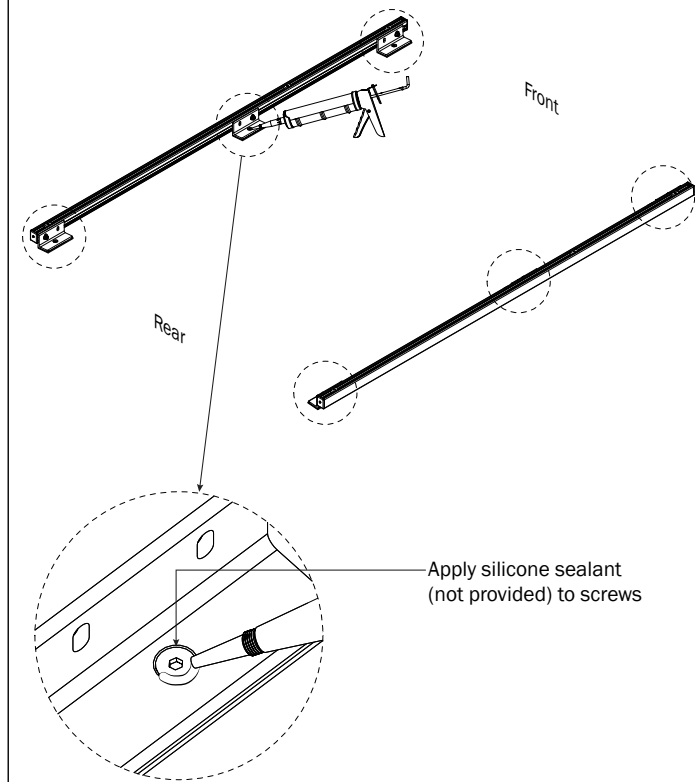

2.5

Attach Mounting Brackets to the Aluminum Strip Nuts located in the Channels

3 Crossbar models: Position the rear and center Mounting Brackets as shown.

\*2 & 3 Crossbar models: Position the front Mounting Brackets as shown.

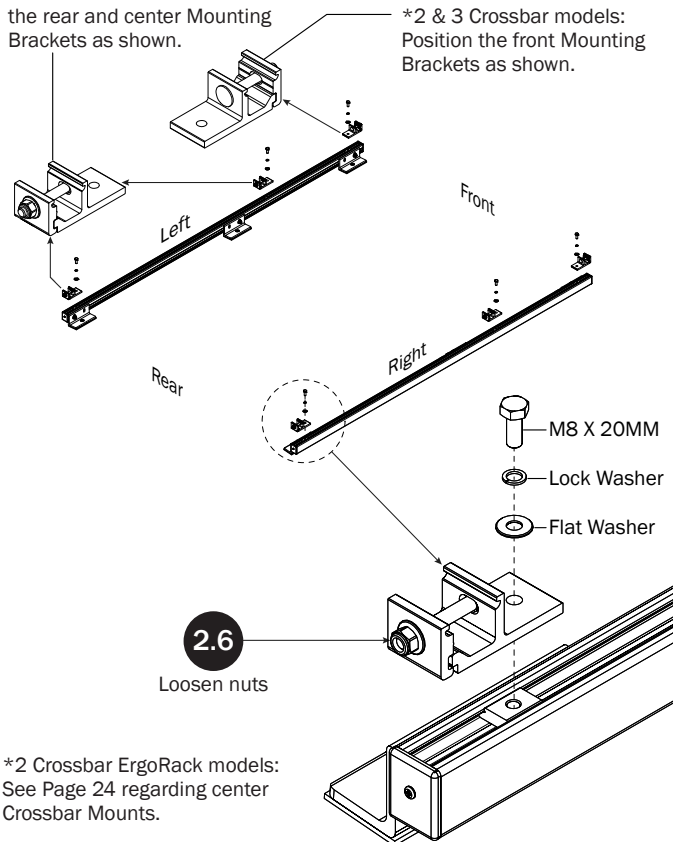

2.6

Loosen nuts

\*2 Crossbar ErgoRack models: See Page 24 regarding center Crossbar Mounts.

2.7

Set to distances shown below:  
Use Dimensions A for 2 Crossbar models.  
Use Dimensions B for 3 Crossbar models.

Do not torque the Crossbar Mounting Brackets until Step 3.4. Finger-tighten them into designated dimension to hold them in place, then proceed to your Feature (FEA) Assembly Manual.

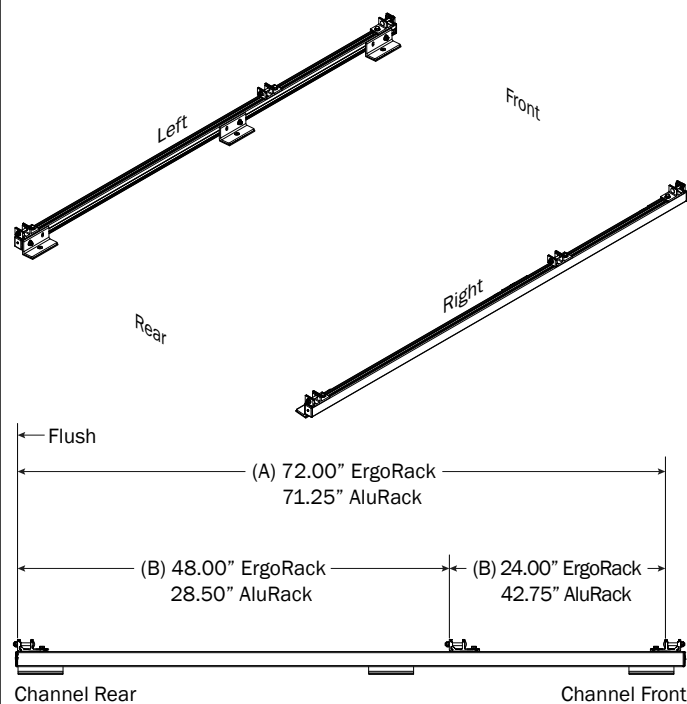

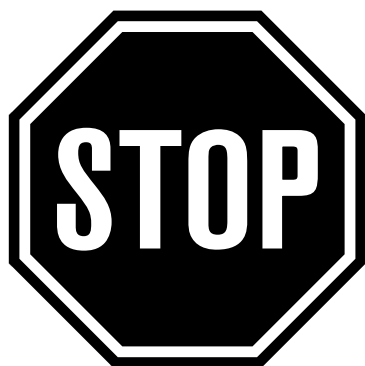

Do not mount the Crossbars to this FBM system at this time.

Refer to the respective FEA or AR Assembly Manual(s) included with your chosen rack configuration features. Depending upon the features chosen, you may need to perform a complete feature assembly onto the Crossbars or Side Rails as noted in that feature's Assembly Manual.

**WARNING:** Failure to position the Crossbars as shown in this FBM Assembly Manual may result in damage to the sliding door and/or ladder rack.

**NOTE:** Crossbars, Side Rails, Base, Clamp Down, or Rotation features are not included in this FBM kit, and must be purchased separately. To purchase applicable features and accessories, please contact your authorized distributor, or a Prime Design Sales & Service Representative.

## CROSSBARS

Shown with LH Base, and RH Rotation for illustrative purposes only

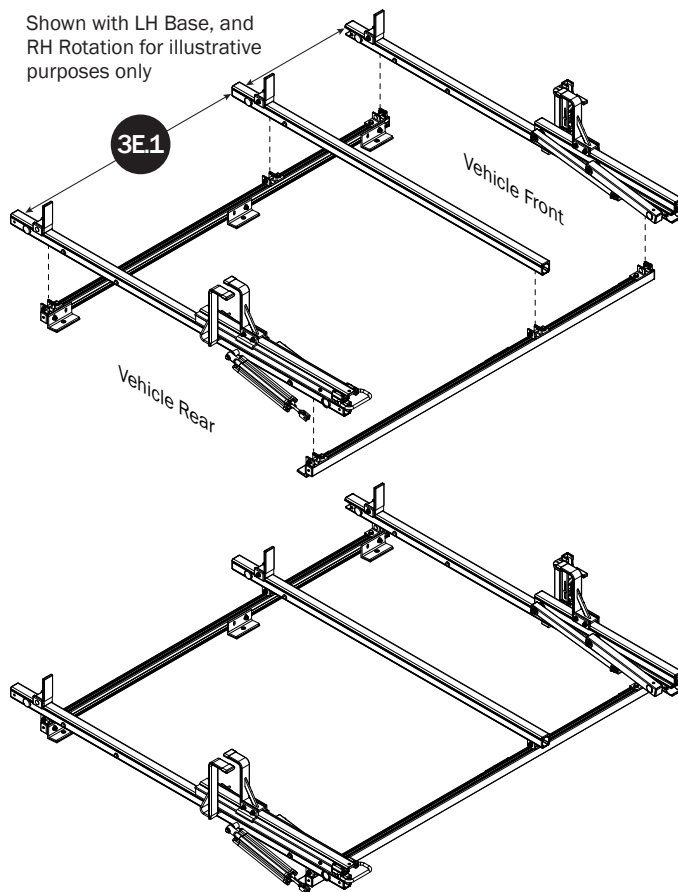

## CROSSBAR ADJUSTMENT

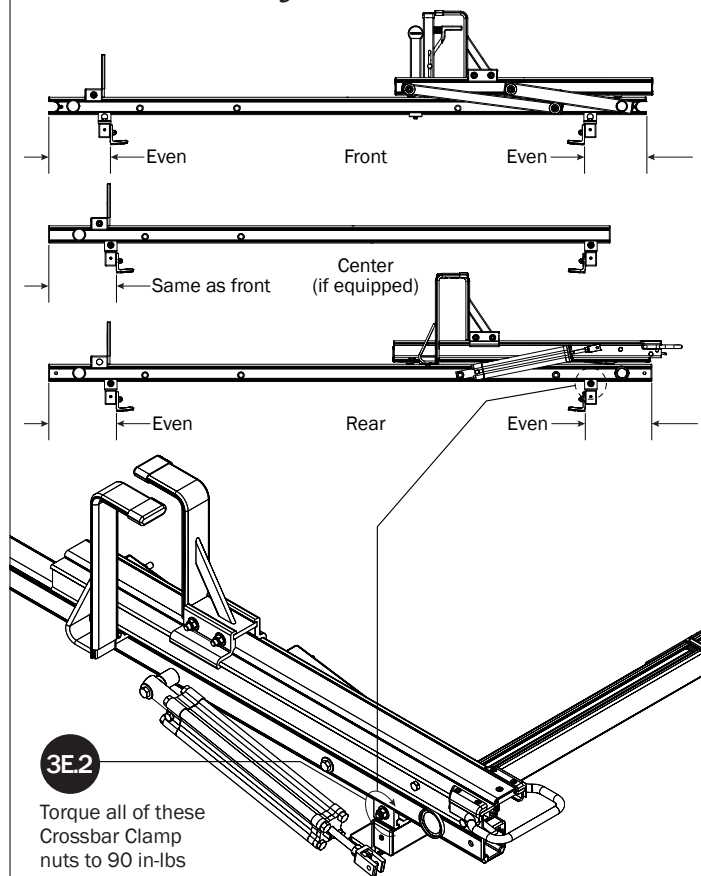

3E.2

Torque all of these Crossbar Clamp nuts to 90 in-lbs

3E.3

Verify the specified distance from the ends of both Rear Crossbar Mounting Brackets to the ends of both Channels.

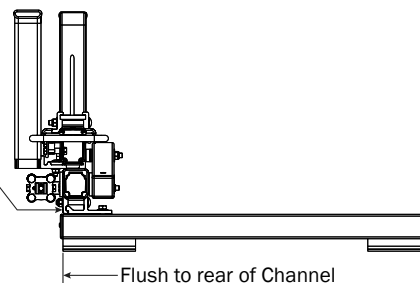

Flush to rear of Channel

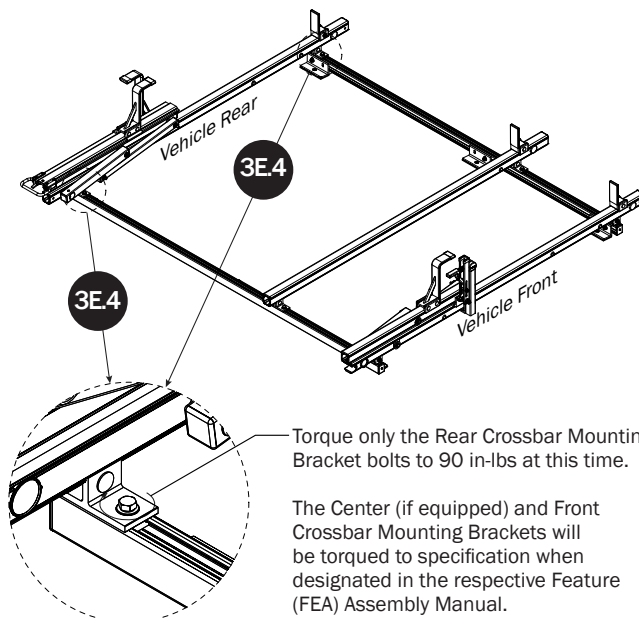

Torque only the Rear Crossbar Mounting Bracket bolts to 90 in-lbs at this time.

The Center (if equipped) and Front Crossbar Mounting Brackets will be torqued to specification when designated in the respective Feature (FEA) Assembly Manual.

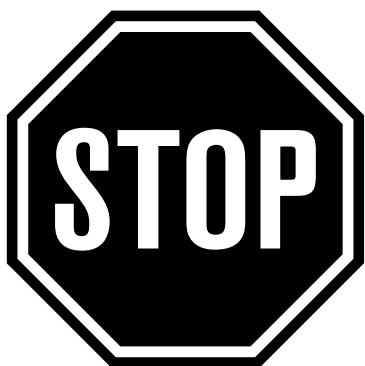

Do not mount the Crossbars to this FBM system at this time.

Refer to the respective FEA or AR Assembly Manual(s) included with your chosen rack configuration features. Depending upon the features chosen, you may need to perform a complete feature assembly onto the Crossbars or Side Rails as noted in that feature's Assembly Manual.

**WARNING:** Failure to position the Crossbars as shown in this FBM Assembly Manual may result in damage to the sliding door and/or ladder rack.

**NOTE:** Crossbars, Side Rails, Base, Clamp Down, or Rotation features are not included in this FBM kit, and must be purchased separately. To purchase applicable features and accessories, please contact your authorized distributor, or a Prime Design Sales & Service Representative.

## CROSSBARS (ALURACK)

Shown with MR/HR MWB  
AluRack for illustrative  
purposes only

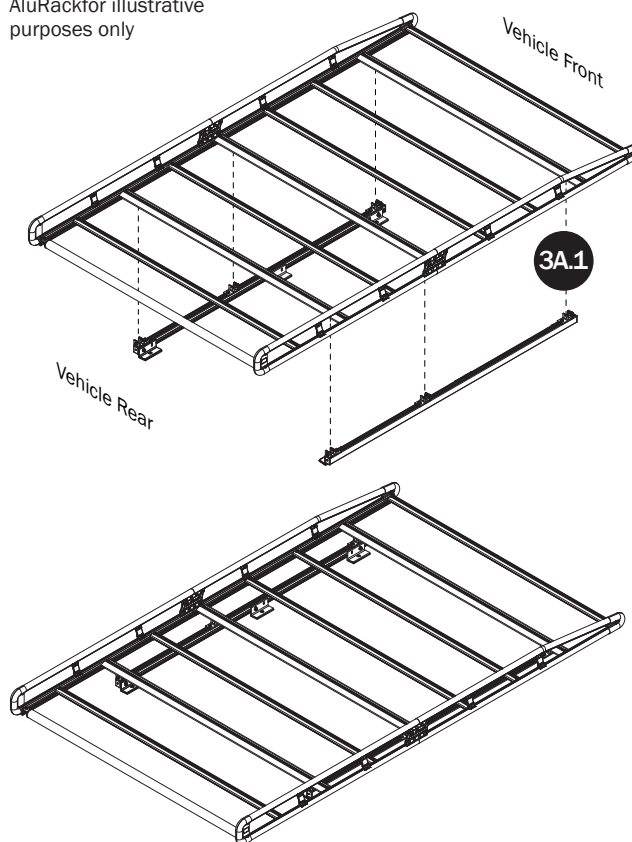

## CROSSBAR ADJUSTMENT

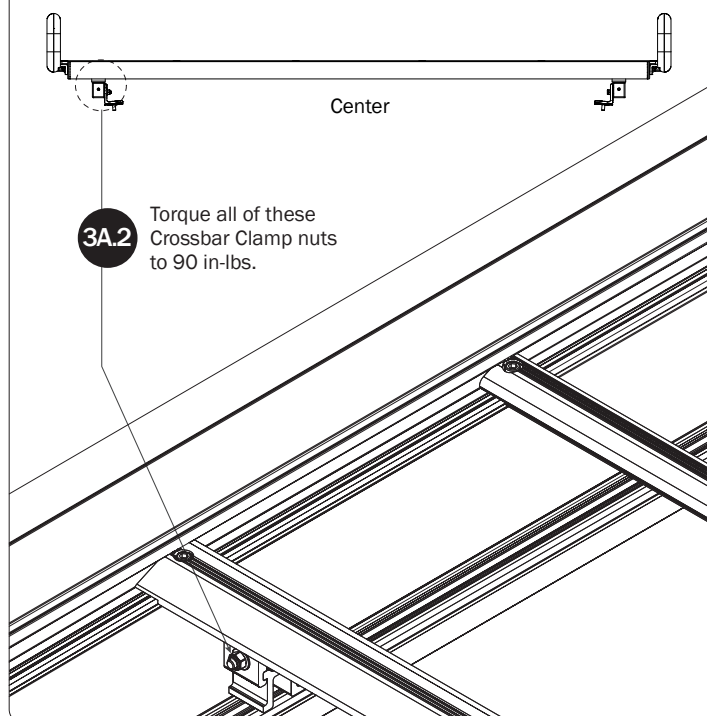

**3A.2** Torque all of these  
Crossbar Clamp nuts  
to 90 in-lbs.

**3A.3**

Verify the specified  
distance from the  
ends of both Mounting  
Bracket to the ends of  
both Channels.

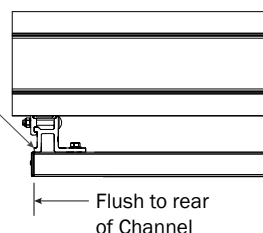

Flush to rear  
of Channel

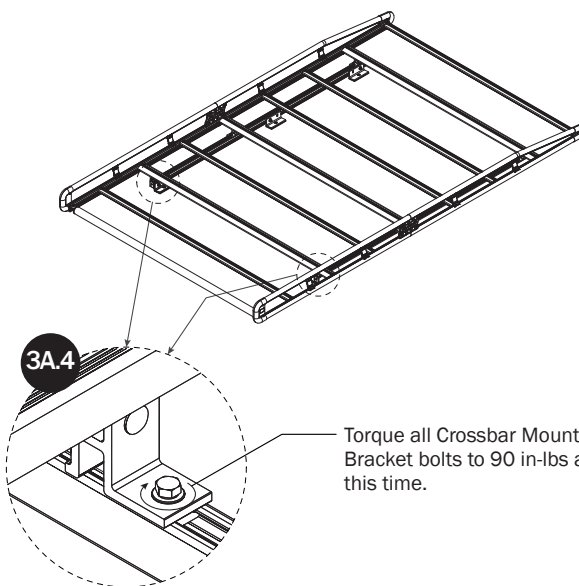

**3A.4**

Torque all Crossbar Mounting  
Bracket bolts to 90 in-lbs at  
this time.

## MID/HIGH ROOF LONG WHEEL BASE (148.00") FBM ASSEMBLY SEQUENCE



Prior to assembling the Channels and hardware, the OEM roof holes must be chased using an M8 x 1.25 tap. Doing so will ensure accurate torque is achieved.

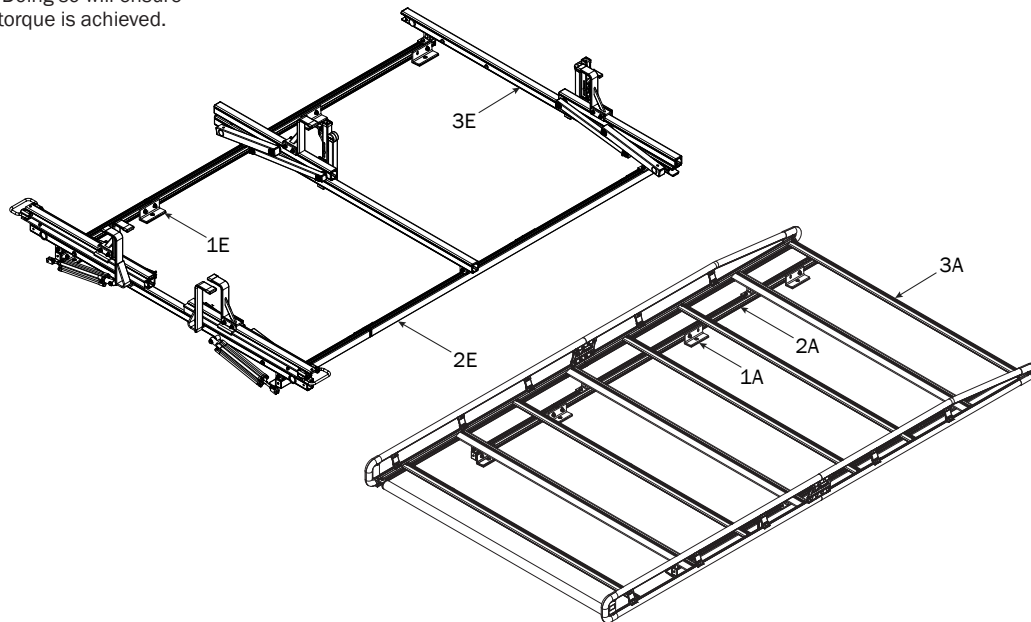

**NOTE:** Base, Rotation, Crossbar, and Side Rail features are shown for illustrative purposes only. These features are not included with this Base Mounting Kit, and must be purchased separately.

### MOUNTING BRACKETS

- 1** Apply Anti-Seize to all M8 x 25MM Flat Head Screws and install the Channel Mounting Brackets with Foam Pads onto the vehicle's roof mounting holes. Do not tighten screws until Step 2.4

\* See note on Page 2

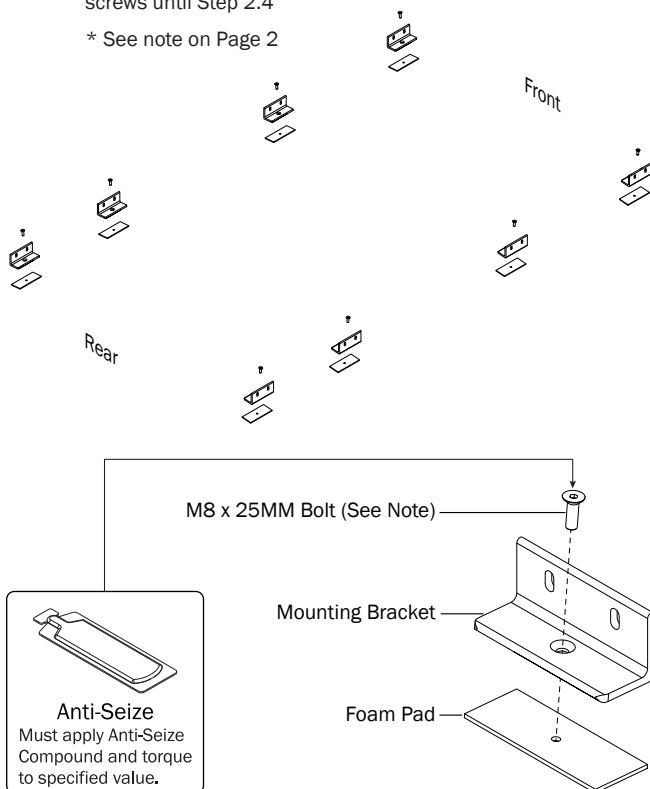

### CHANNELS

- 2.1** Apply Anti-Seize to all M8 T Bolt studs, then attach to Mounts using the indicated hardware. Do not tighten until Step 2.3

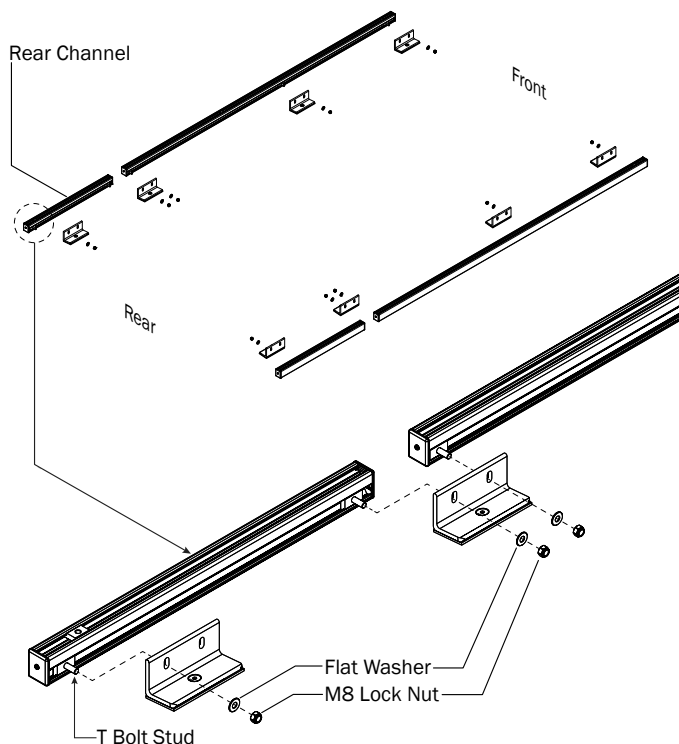

- 2.2** The Channels include aluminum Strip Nuts for a 3 Crossbar configuration. For 2 Crossbar configurations, disregard the extra Strip Nut.

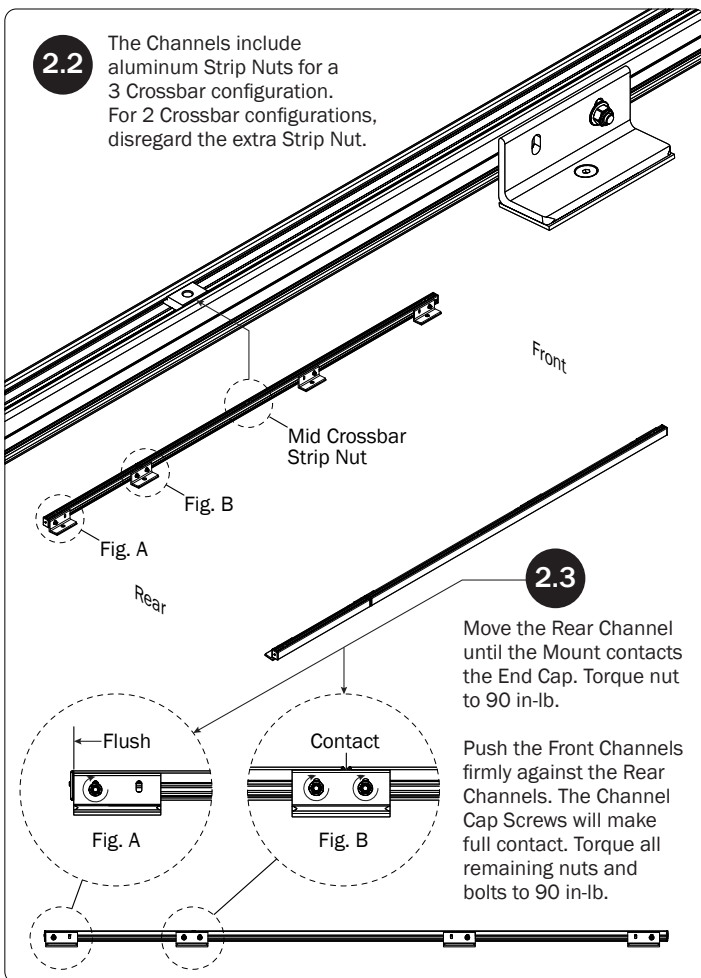
**2.3**

Move the Rear Channel until the Mount contacts the End Cap. Torque nut to 90 in-lb.

Push the Front Channels firmly against the Rear Channels. The Channel Cap Screws will make full contact. Torque all remaining nuts and bolts to 90 in-lb.

- 2.4** Torque all M8 x 25MM Flat Head Screws to 150 in-lbs. Apply Silicone Sealant to screw heads to seal against water intrusion.

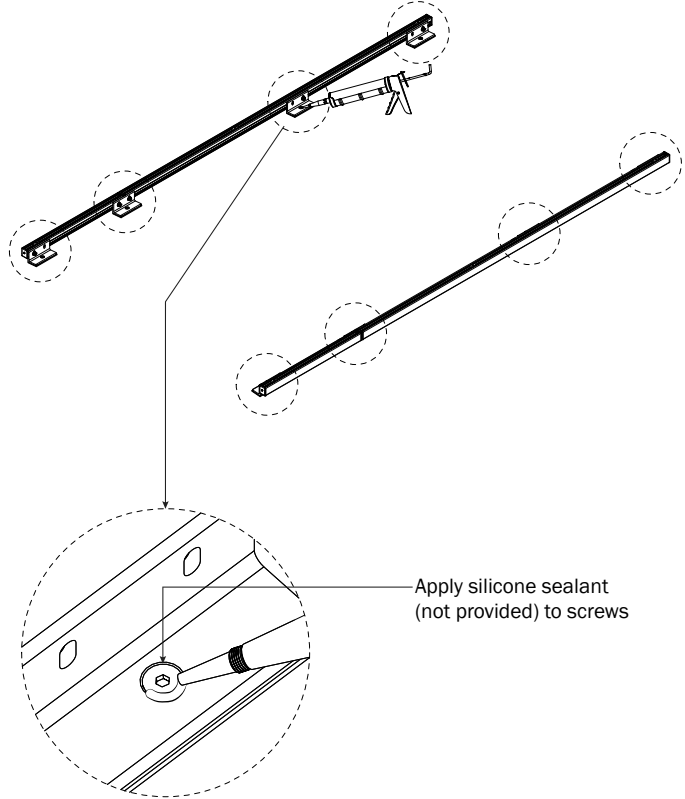

- 2.5** Attach Mounting Brackets to the Aluminum Strip Nuts located in the Channels

3 Crossbar models: Position the rear and center Mounting Brackets as shown.

\*2 & 3 Crossbar models: Position the front Mounting Brackets as shown.

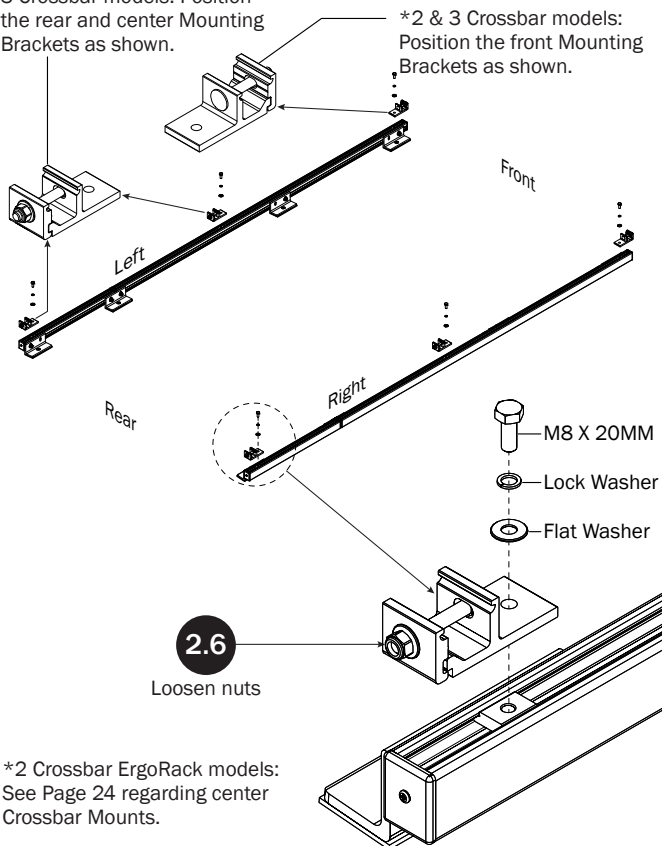

\*2 Crossbar ErgoRack models: See Page 24 regarding center Crossbar Mounts.

- 2.7** Set to distances shown below:  
Use Dimensions A for 2 Crossbar models.  
Use Dimensions B for 3 Crossbar models.

Do not torque the Crossbar Mounting Brackets until Step 3.4. Finger-tighten them into designated dimension to hold them in place, then proceed to your Feature (FEA) Assembly Manual.

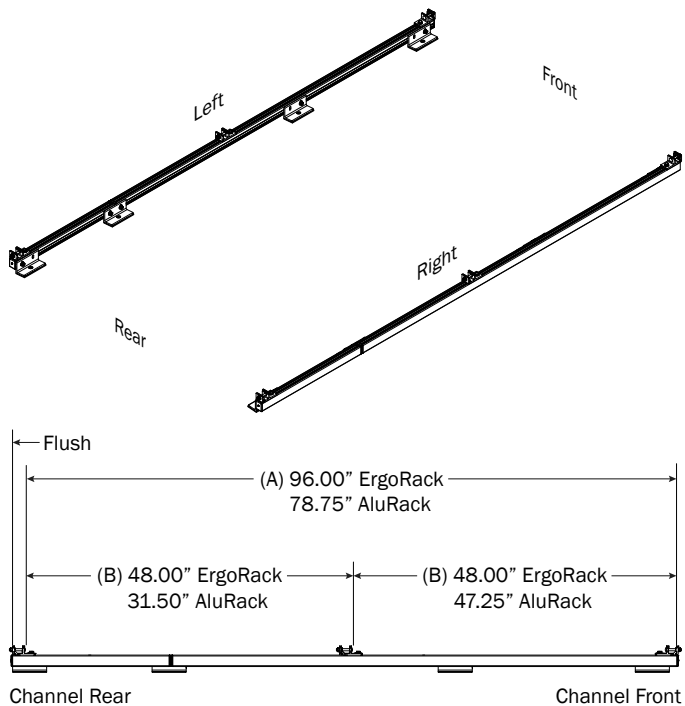

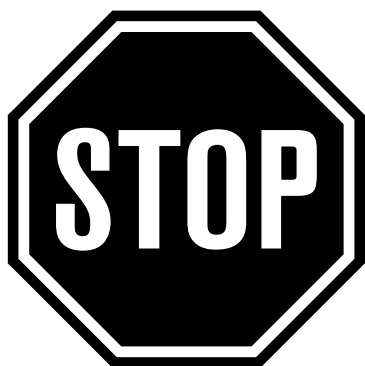

Do not mount the Crossbars to this FBM system at this time.

Refer to the respective FEA or AR Assembly Manual(s) included with your chosen rack configuration features. Depending upon the features chosen, you may need to perform a complete feature assembly onto the Crossbars or Side Rails as noted in that feature's Assembly Manual.

**WARNING:** Failure to position the Crossbars as shown in this FBM Assembly Manual may result in damage to the sliding door and/or ladder rack.

**NOTE:** Crossbars, Side Rails, Base, Clamp Down, or Rotation features are not included in this FBM kit, and must be purchased separately. To purchase applicable features and accessories, please contact your authorized distributor, or a Prime Design Sales & Service Representative.

## CROSSBARS

Shown with LH Base, and RH Rotation for illustrative purposes only

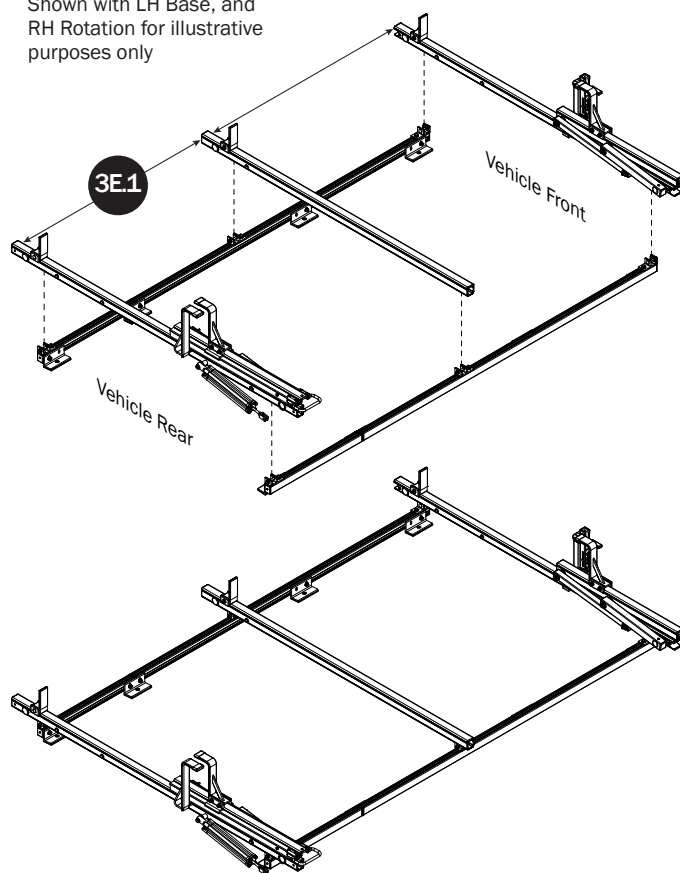

## CROSSBAR ADJUSTMENT

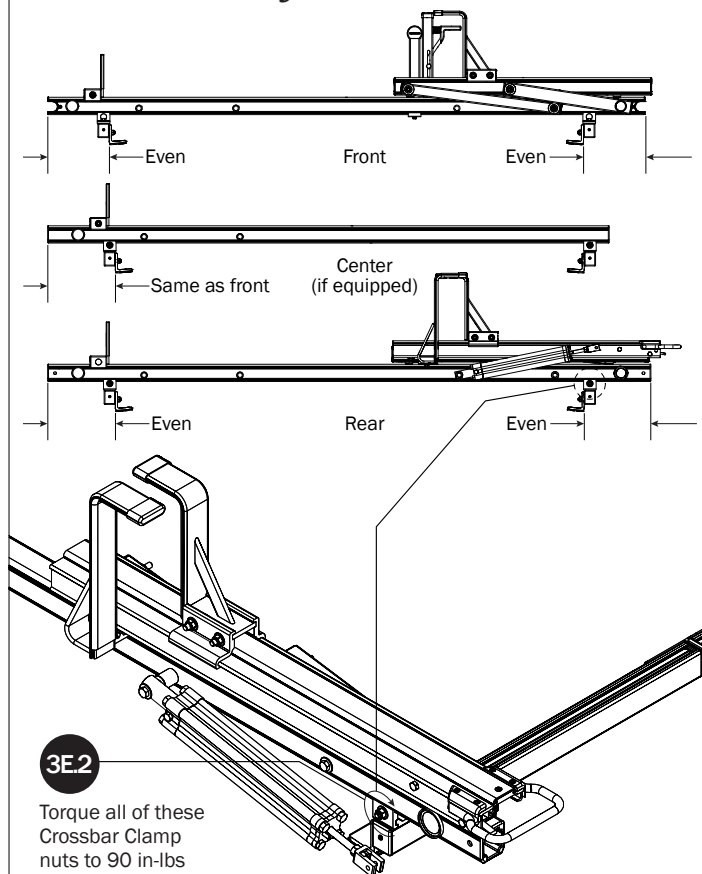

3E.2

Torque all of these Crossbar Clamp nuts to 90 in-lbs

3E.3

Verify the specified distance from the ends of both Rear Crossbar Mounting Brackets to the ends of both Channels.

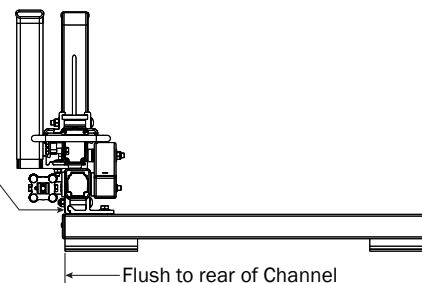

Flush to rear of Channel

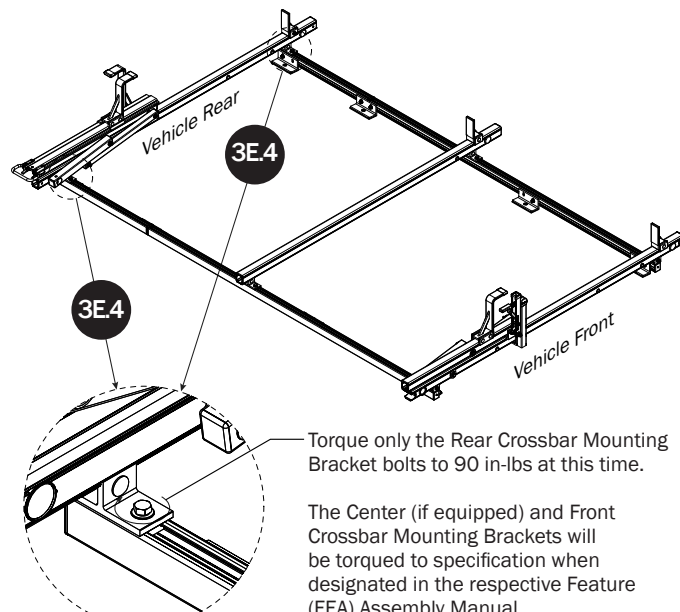

3E.4

Torque only the Rear Crossbar Mounting Bracket bolts to 90 in-lbs at this time.

The Center (if equipped) and Front Crossbar Mounting Brackets will be torqued to specification when designated in the respective Feature (FEA) Assembly Manual.

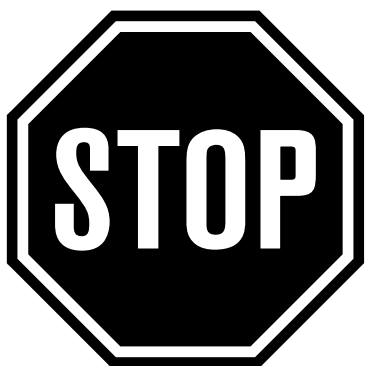

Do not mount the Crossbars to this FBM system at this time.

Refer to the respective FEA or AR Assembly Manual(s) included with your chosen rack configuration features. Depending upon the features chosen, you may need to perform a complete feature assembly onto the Crossbars or Side Rails as noted in that feature's Assembly Manual.

**WARNING:** Failure to position the Crossbars as shown in this FBM Assembly Manual may result in damage to the sliding door and/or ladder rack.

**NOTE:** Crossbars, Side Rails, Base, Clamp Down, or Rotation features are not included in this FBM kit, and must be purchased separately. To purchase applicable features and accessories, please contact your authorized distributor, or a Prime Design Sales & Service Representative.

## CROSSBARS (ALURACK)

Shown with MR/HR LWB  
AluRack for illustrative  
purposes only

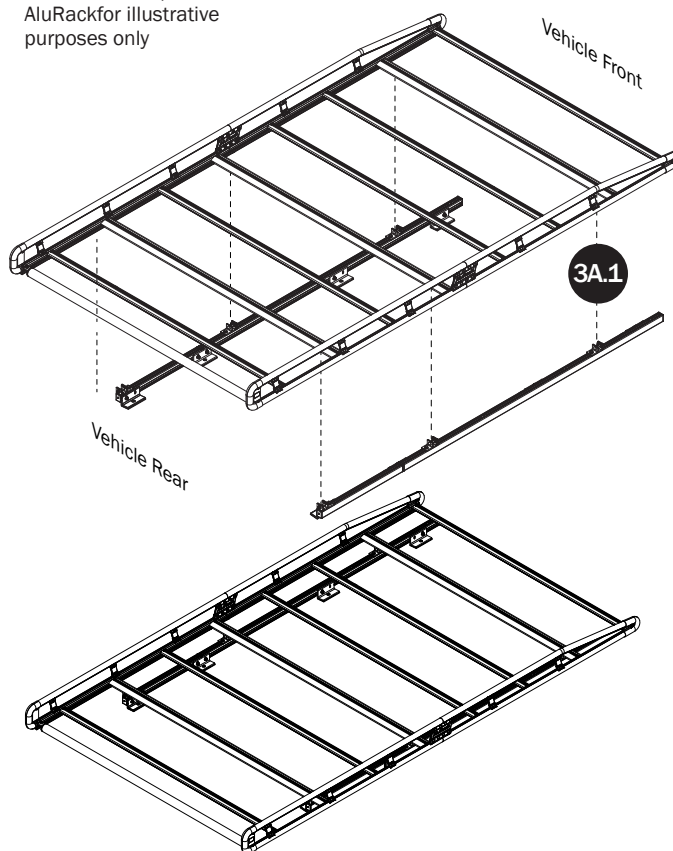

## CROSSBAR ADJUSTMENT

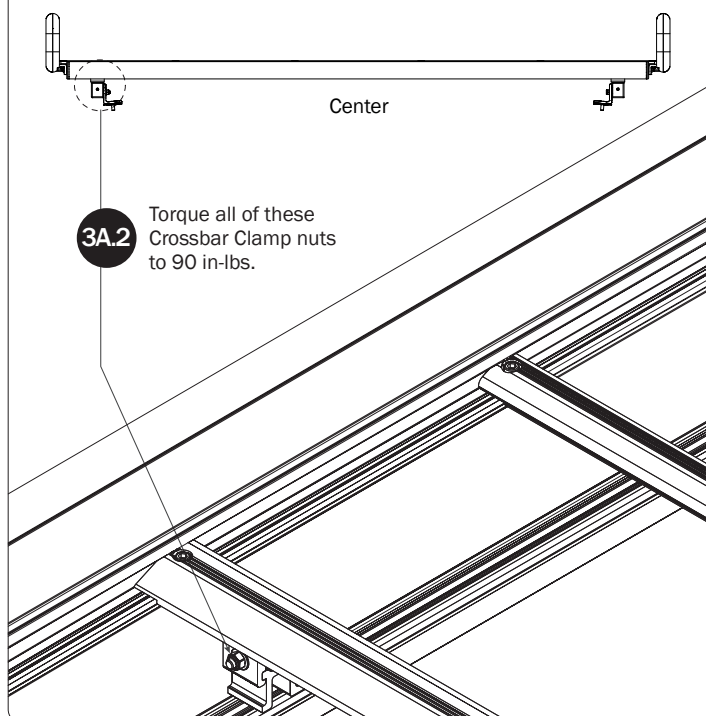

Torque all of these  
Crossbar Clamp nuts  
to 90 in-lbs.

3A.3

Verify the specified  
distance from the  
ends of both Mounting  
Bracket to the ends of  
both Channels.

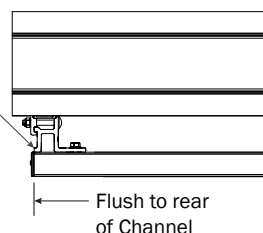

Flush to rear  
of Channel

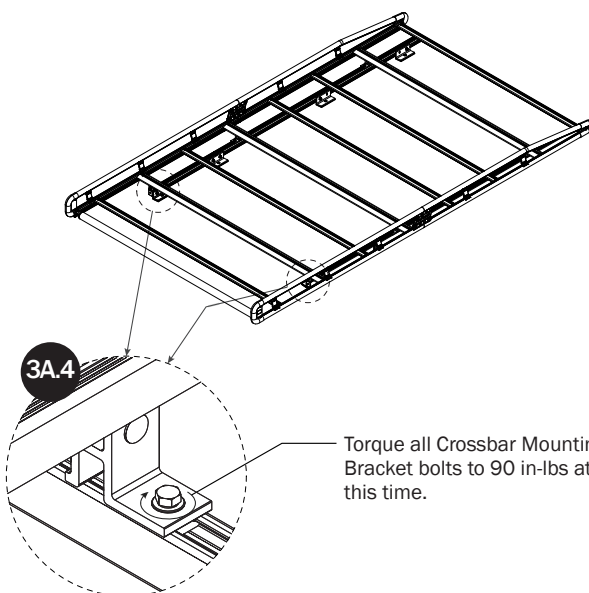

Torque all Crossbar Mounting  
Bracket bolts to 90 in-lbs at  
this time.

**HIGH ROOF LONG WHEEL BASE EXTENDED LENGTH (148.00")****FBM ASSEMBLY SEQUENCE**

Prior to assembling the Channels and hardware, the OEM roof holes must be chased using an M8 x 1.25 tap and fluid. Doing so will ensure accurate torque is achieved.

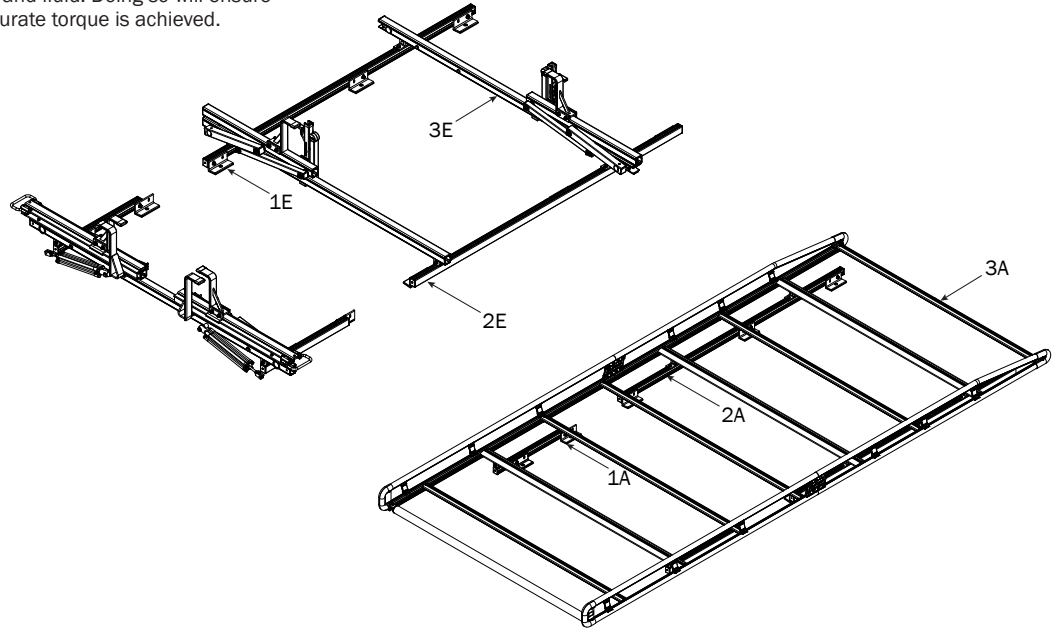

**NOTE:** Base, Rotation, Crossbar, and Side Rail features are shown for illustrative purposes only. These features are not included with this Base Mounting Kit, and must be purchased separately.

**MOUNTING BRACKETS**

- 1** Apply Anti-Seize to all M8 x 25MM Flat Head Screws and install the Channel Mounting Brackets with Foam Pads onto the vehicle's roof mounting holes. Do not tighten screws until Step 2.4

\* See note on Page 2

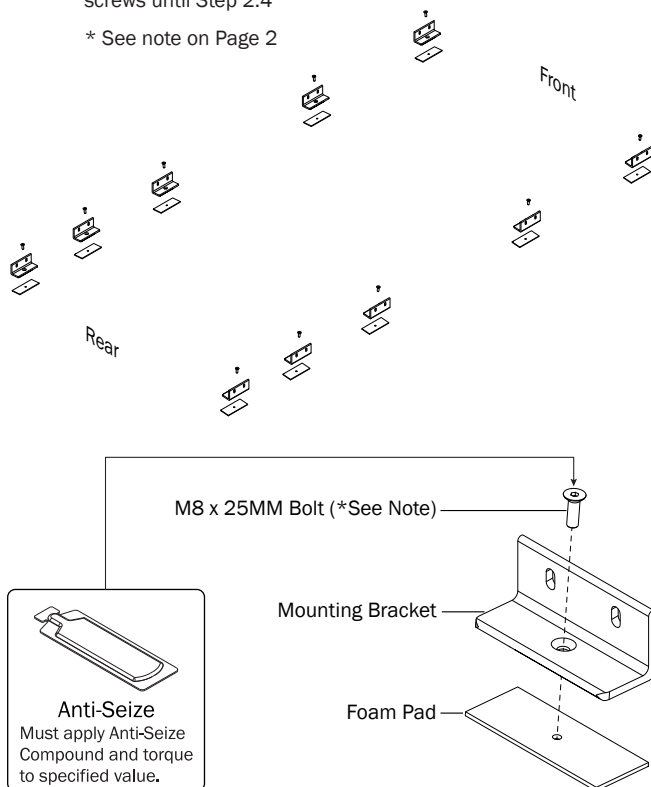
**CHANNELS**

- 2.1** Apply Anti-Seize to all M8 T Bolt studs, then attach the Channels to the Mounting Brackets using the indicated hardware. Do not tighten until Step 2.3

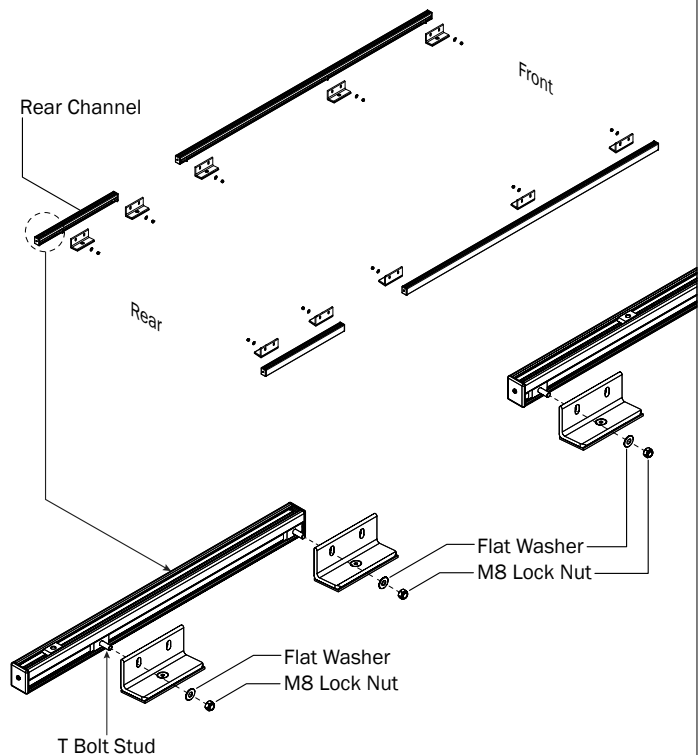

- 2.2** The Channels include aluminum Strip Nuts for a 3 Crossbar configuration. For 2 Crossbar configurations, disregard the extra Strip Nut.

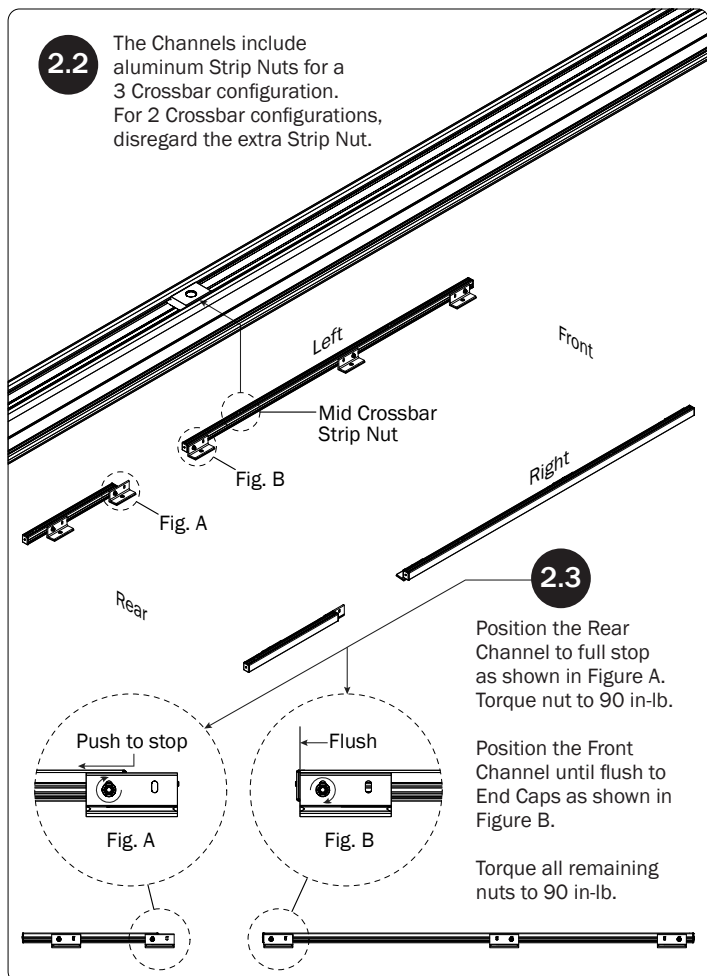

- 2.4** Torque all M8 x 25MM Flat Head Screws to 150 in-lbs. Apply Silicone Sealant to screw heads to seal against water intrusion.

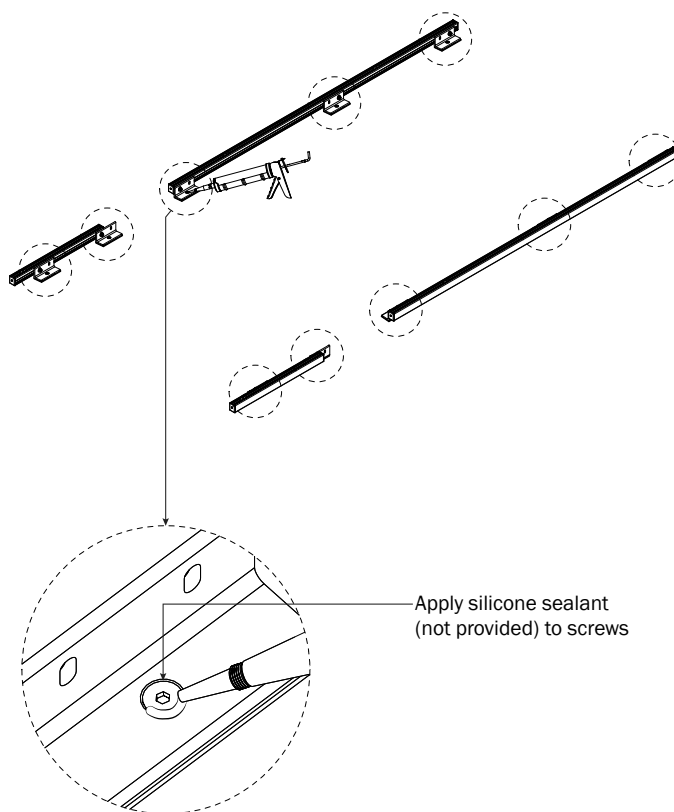

- 2.3** Position the Rear Channel to full stop as shown in Figure A. Torque nut to 90 in-lb.
- Position the Front Channel until flush to End Caps as shown in Figure B.
- Torque all remaining nuts to 90 in-lb.

- 2.5** Attach Mounting Brackets to the Aluminum Strip Nuts located in the Channels

3 Crossbar models: Position the rear and center Mounting Brackets as shown.

\*2 & 3 Crossbar models: Position the front Mounting Brackets as shown.

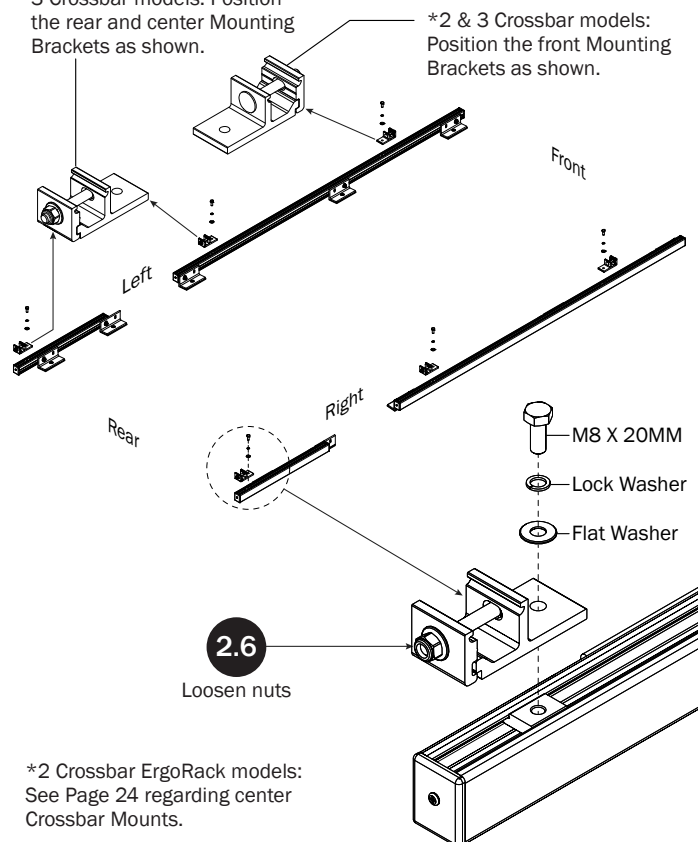

\*2 Crossbar ErgoRack models: See Page 24 regarding center Crossbar Mounts.

- 2.7** Set to distances shown below:  
Use Dimensions A for 2 Crossbar models.  
Use Dimensions B for 3 Crossbar models.

Do not torque the Crossbar Mounting Brackets until Step 3.4. Finger-tighten them into designated dimension to hold them in place, then proceed to your Feature (FEA) Assembly Manual.

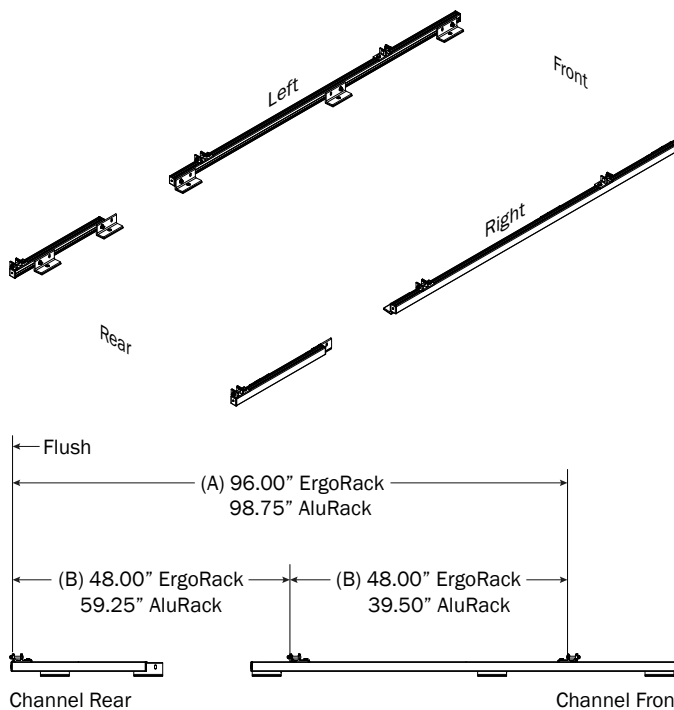



Do not mount the Crossbars to this FBM system at this time.

Refer to the respective FEA or AR Assembly Manual(s) included with your chosen rack configuration features. Depending upon the features chosen, you may need to perform a complete feature assembly onto the Crossbars or Side Rails as noted in that feature's Assembly Manual.

**WARNING:** Failure to position the Crossbars as shown in this FBM Assembly Manual may result in damage to the sliding door and/or ladder rack.

**NOTE:** Crossbars, Side Rails, Base, Clamp Down, or Rotation features are not included in this FBM kit, and must be purchased separately. To purchase applicable features and accessories, please contact your authorized distributor, or a Prime Design Sales & Service Representative.

## CROSSBARS

Shown with LH Base, and RH Rotation for illustrative purposes only

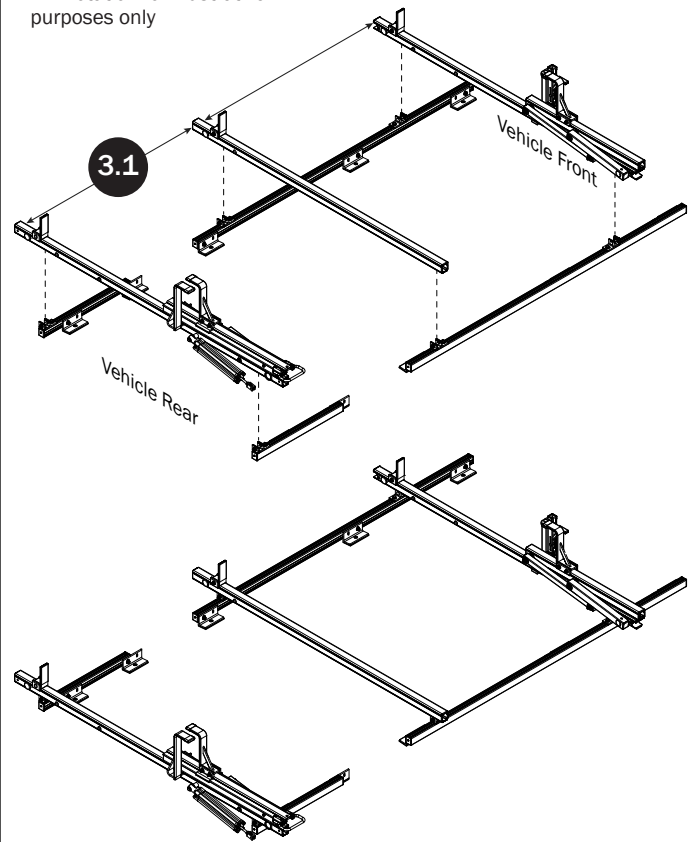

## CROSSBAR ADJUSTMENT

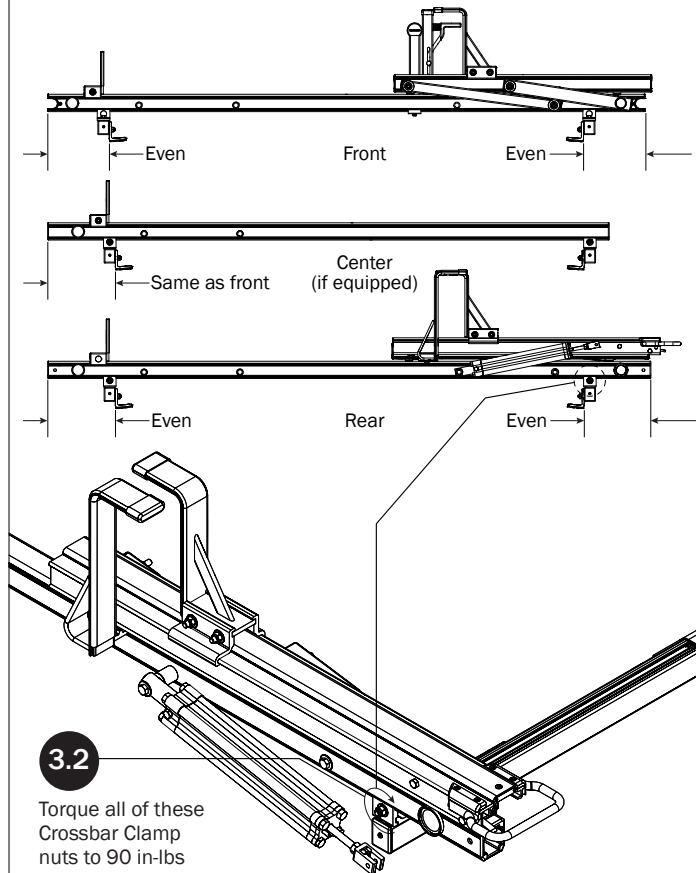

3.3

Verify the specified distance from the ends of both Rear Crossbar Mounting Brackets to the ends of both Channels.

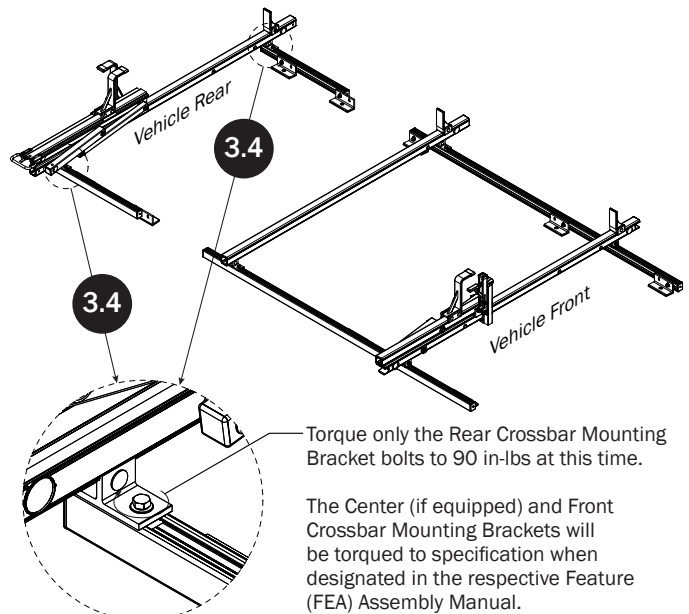
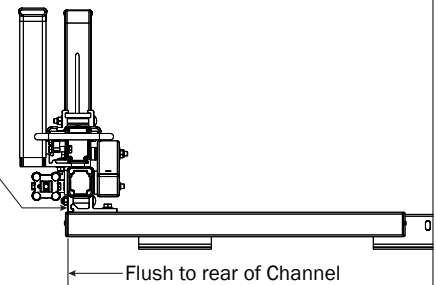



Do not mount the Crossbars to this FBM system at this time.

Refer to the respective FEA or AR Assembly Manual(s) included with your chosen rack configuration features. Depending upon the features chosen, you may need to perform a complete feature assembly onto the Crossbars or Side Rails as noted in that feature's Assembly Manual.

**WARNING:** Failure to position the Crossbars as shown in this FBM Assembly Manual may result in damage to the sliding door and/or ladder rack.

**NOTE:** Crossbars, Side Rails, Base, Clamp Down, or Rotation features are not included in this FBM kit, and must be purchased separately. To purchase applicable features and accessories, please contact your authorized distributor, or a Prime Design Sales & Service Representative.

## CROSSBARS (ALURACK)

Shown with HR LWBEL AluRack for illustrative purposes only

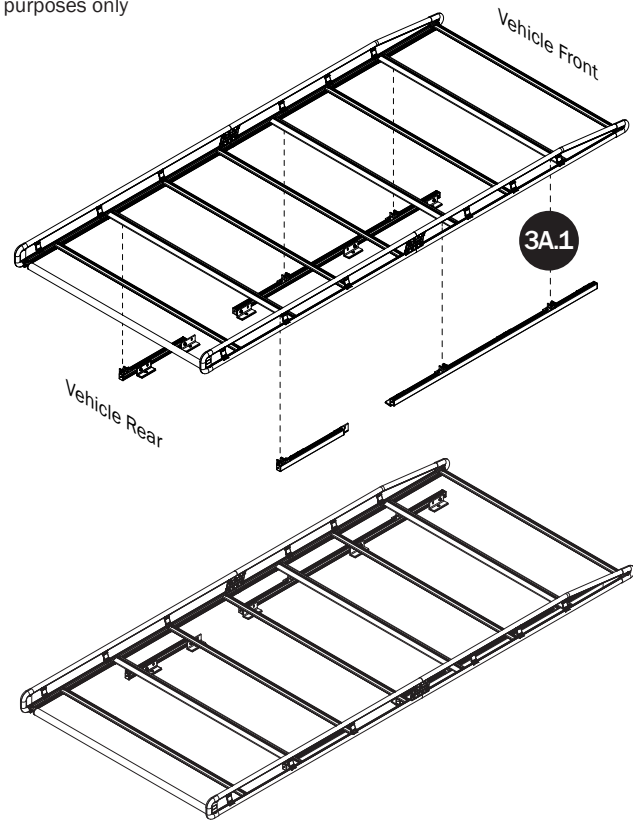

## CROSSBAR ADJUSTMENT

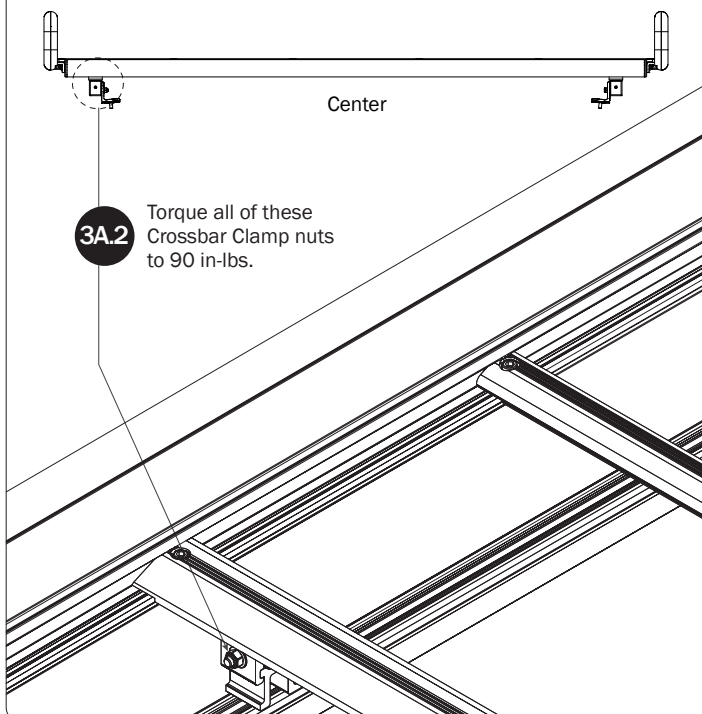

3A.3

Verify the specified distance from the ends of both Mounting Bracket to the ends of both Channels.

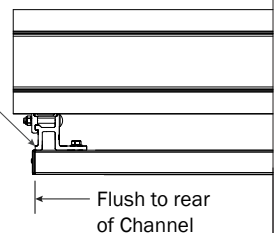

Flush to rear of Channel

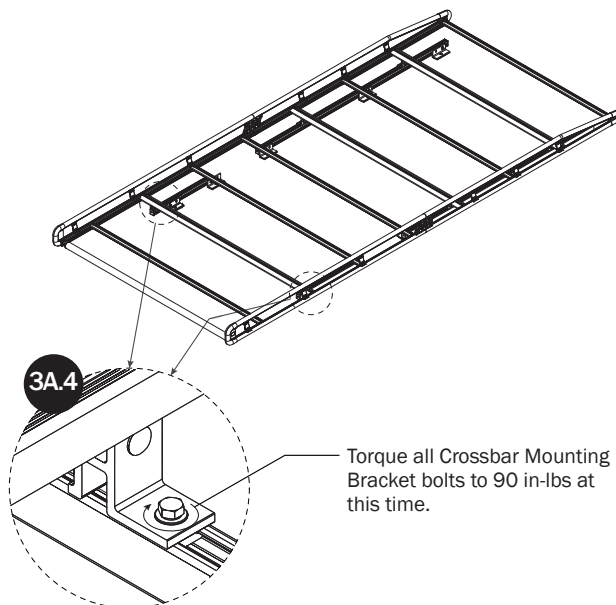

## ***CENTER CROSSBAR MOUNTS*** **FOR 2 CROSSBAR ERGORACK MODELS ONLY**

Place the center Crossbar Mounts into the vehicle's glove box for future use.

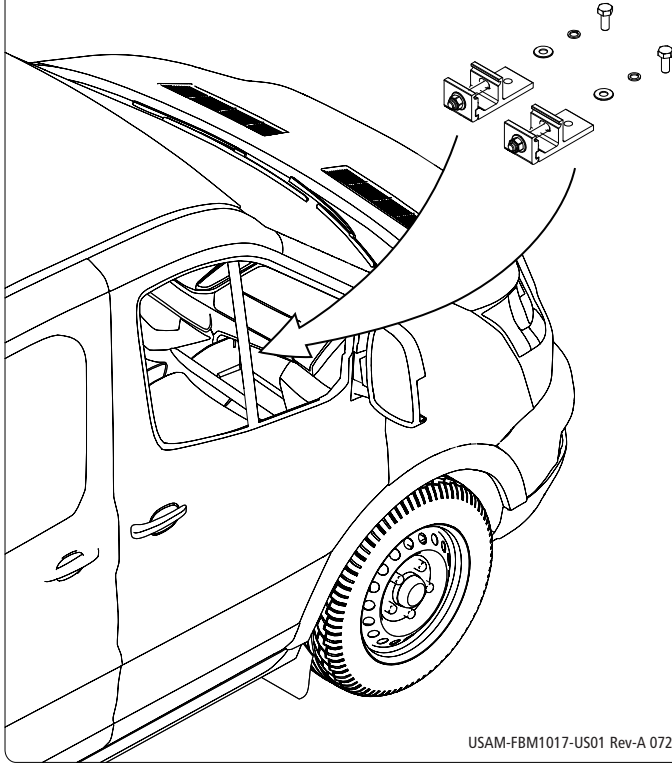

USAM-FBM1017-US01 Rev-A 0720