

PRIME DESIGN™

A Safe Fleet Brand

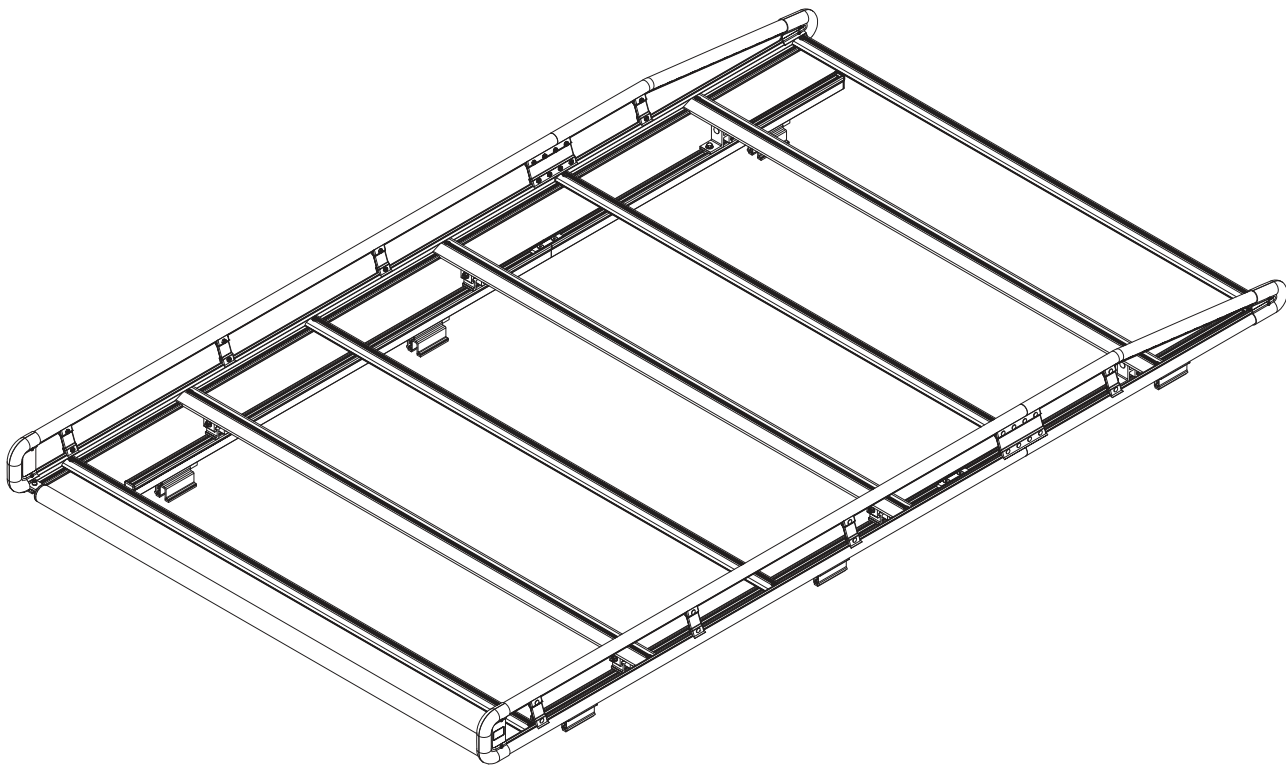

AR1407

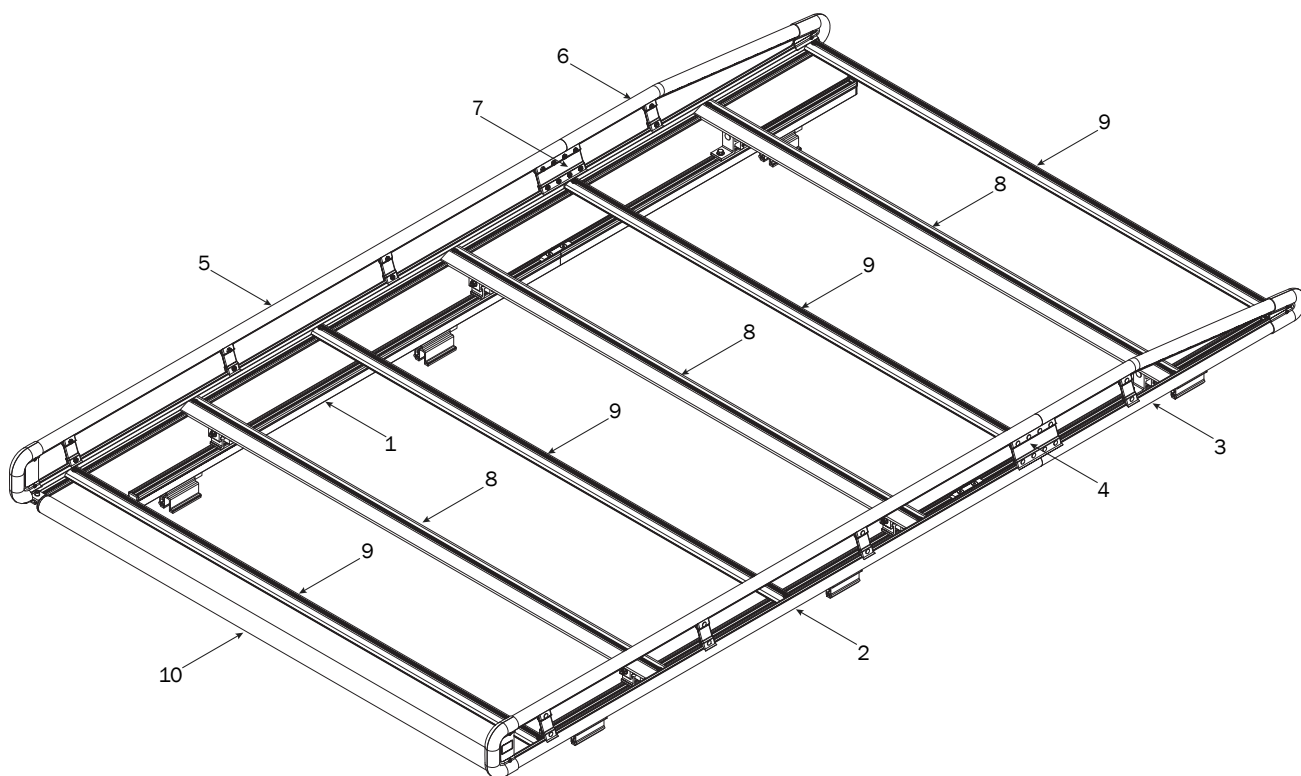

- 1—FBM3-0026-A..... (Qty 1)
Channels with hardware



Channels (2X)



Channels (2X)

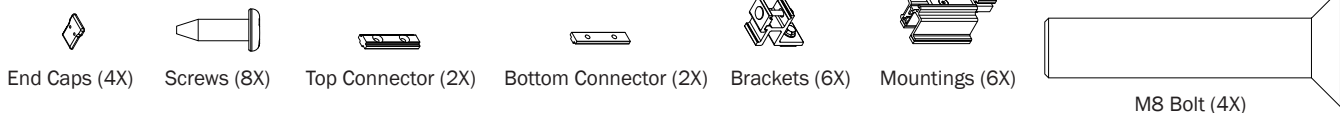

- 2—Side Rail Assembly..... (Qty 1)
Rear, Right Hand, 76.00"

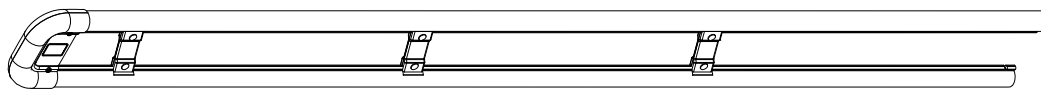

- 3—Side Rail Assembly..... (Qty 1)
Front, Right Hand, 36.00"

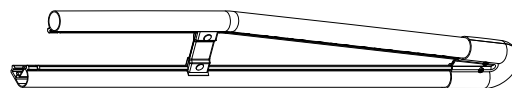

- 4—Side Rail Connector (Qty 1)
Right Hand, 6.00"

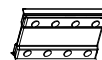

- 5—Side Rail Assembly (Qty 1)
Rear, Left Hand, 76.00"

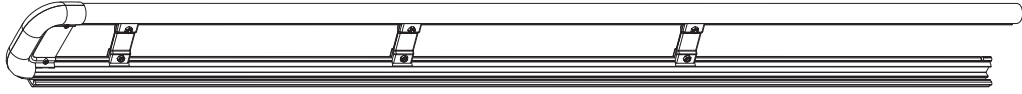

- 6—Side Rail Assembly (Qty 1)
Front, Left Hand, 36.00"

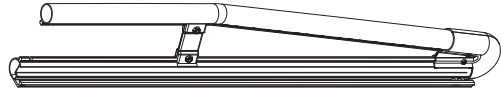

- 7—Side Rail Connector (Qty 1)
Left Hand, 6.00"

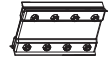

- 8—AluRack Construction Crossbar (Qty 3)
With hardware, 67.00"



- 9—AluRack Standard Crossbar (Qty 4)
With hardware, 67.00"



- 10—Roller Tube Assembly (Qty 1)
With caps, 63.75"



HKT-0081-Hardware Kit

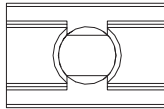

M8 Strip Nut (16X)

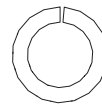

M8 Lock Washer (16X)

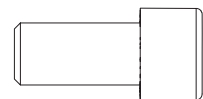

M8 Cap Head Bolt (16X)



Roller Holder (2X)

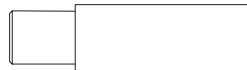

Roller Tube Pin (2X)

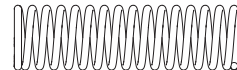

Roller Spring (2X)



Anti-Seize (1X)

FBM3-0026-A FBM MOUNTING

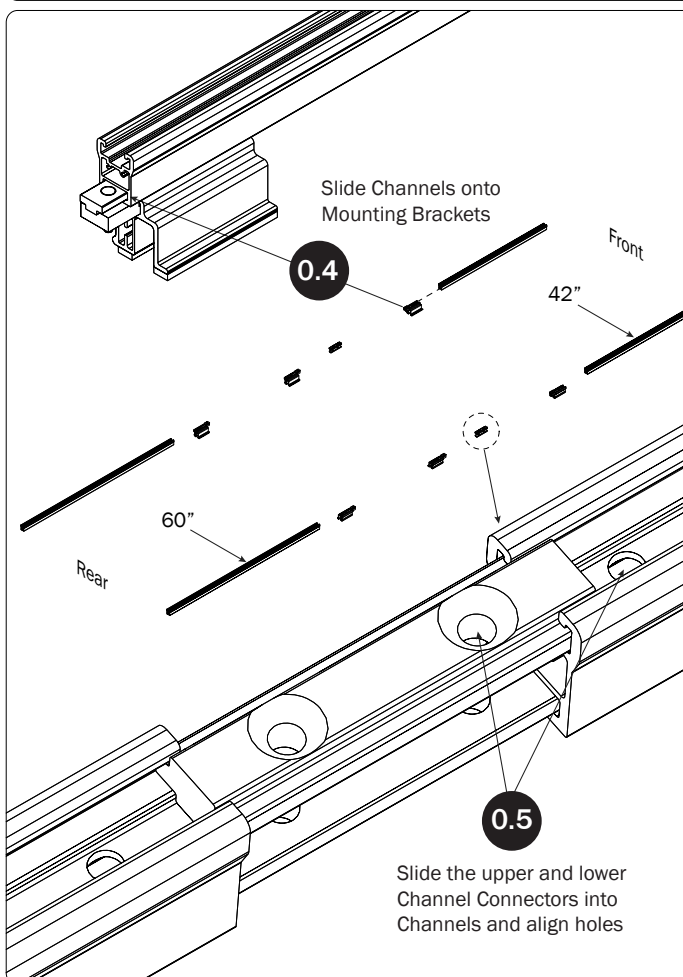
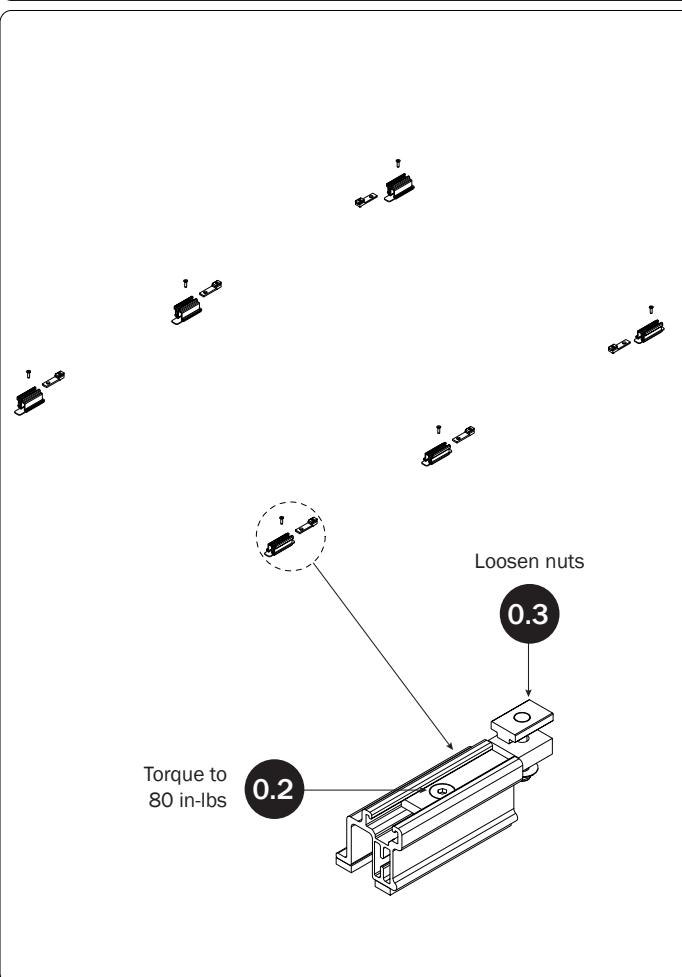
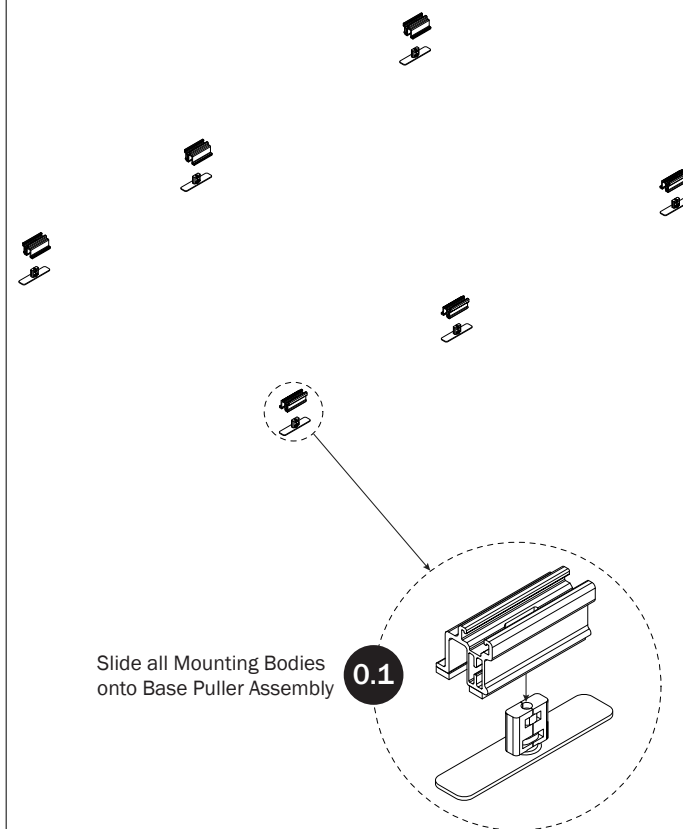
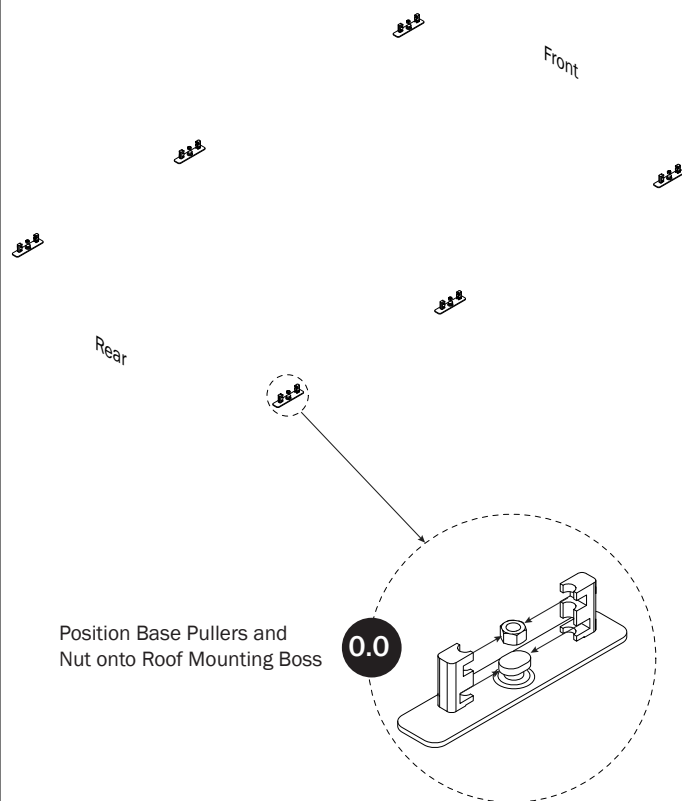

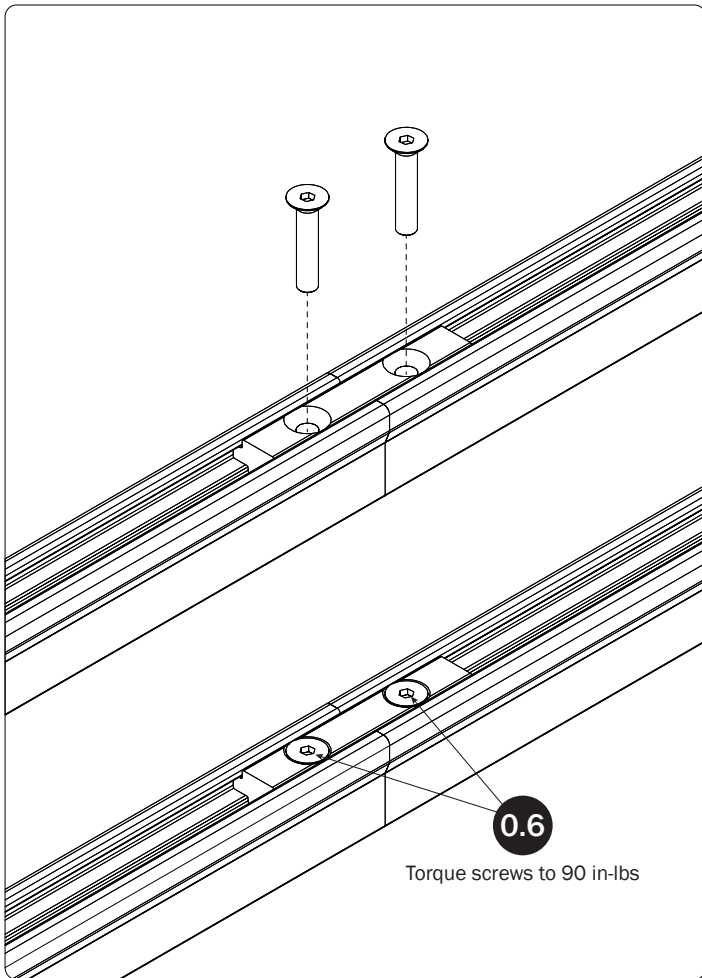

0.7 Set to distances then torque Mounting Bracket nuts to 80 in-lbs

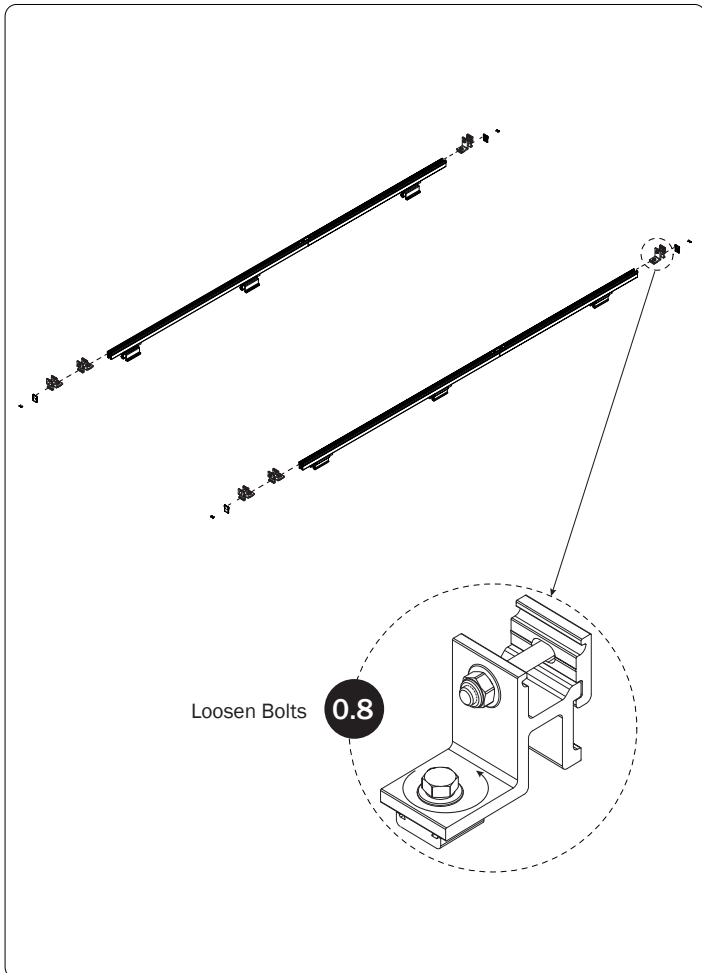
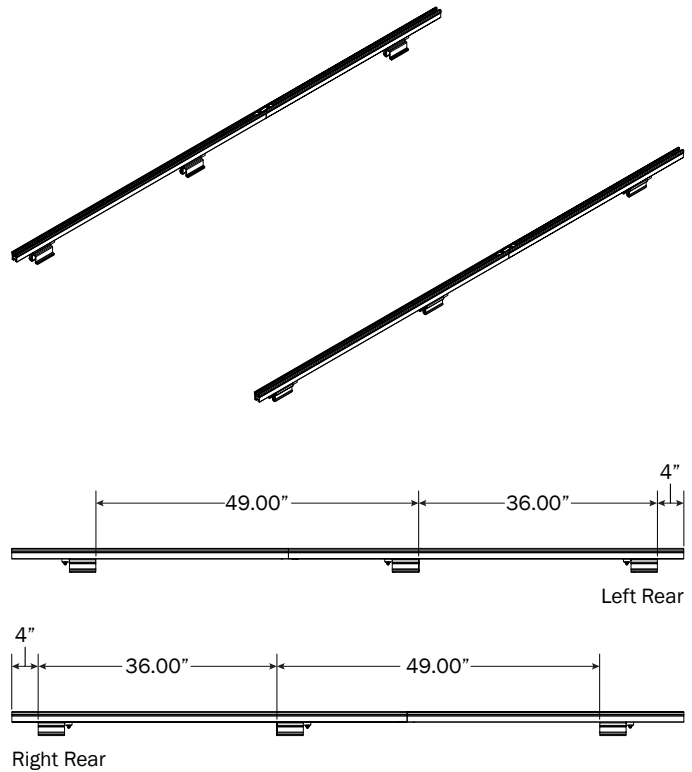

0.9 Finger-tighten to retain positions. Do not torque until Step 7.5

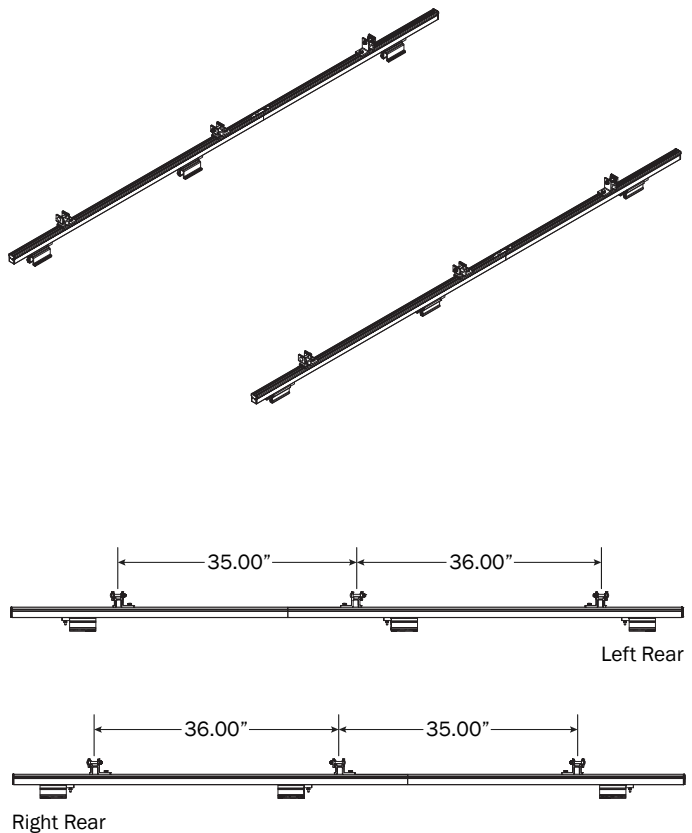

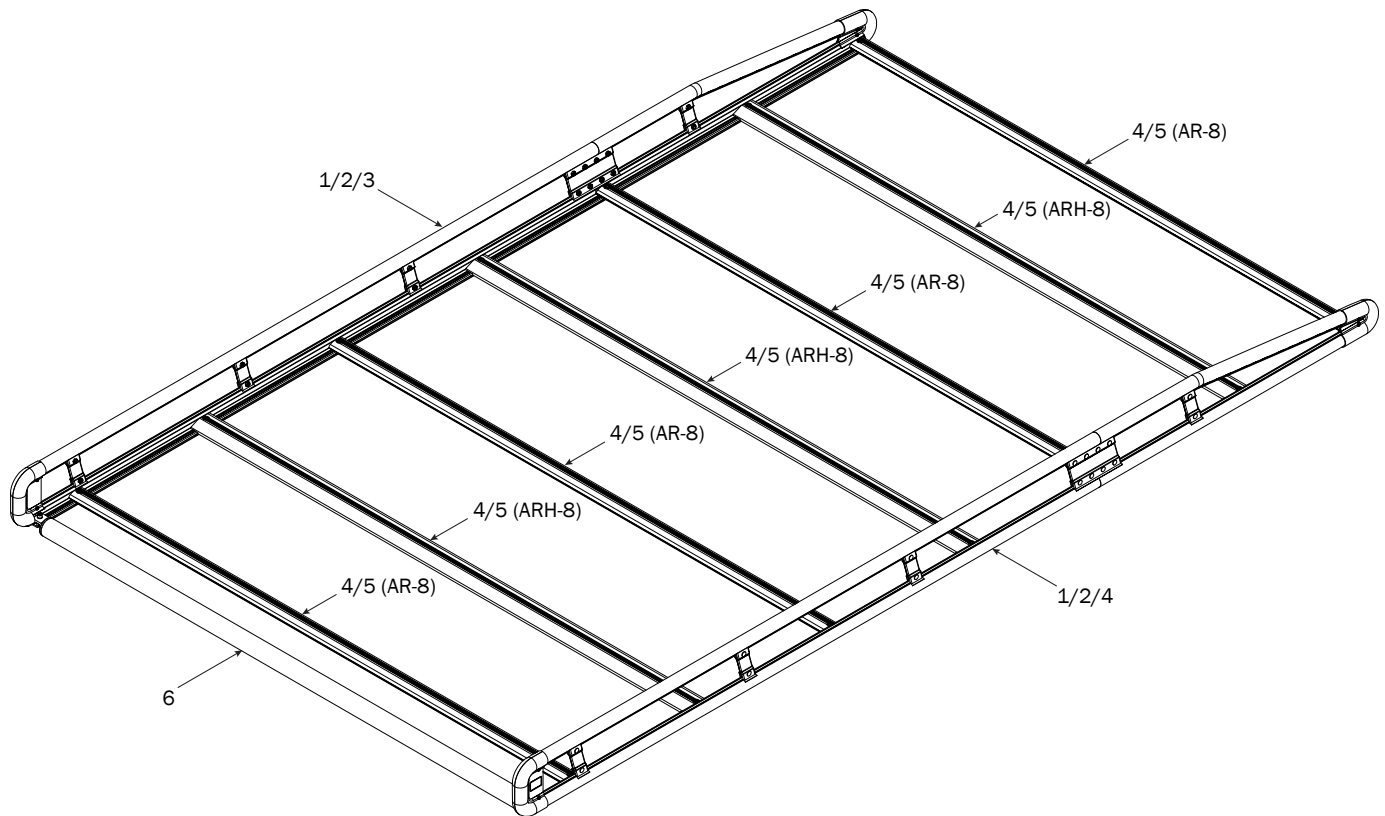
ALURACK ASSEMBLY**STRIP NUT ASSEMBLY**

- 1** Insert Strip Nuts (7x) per side into Side Rails as shown

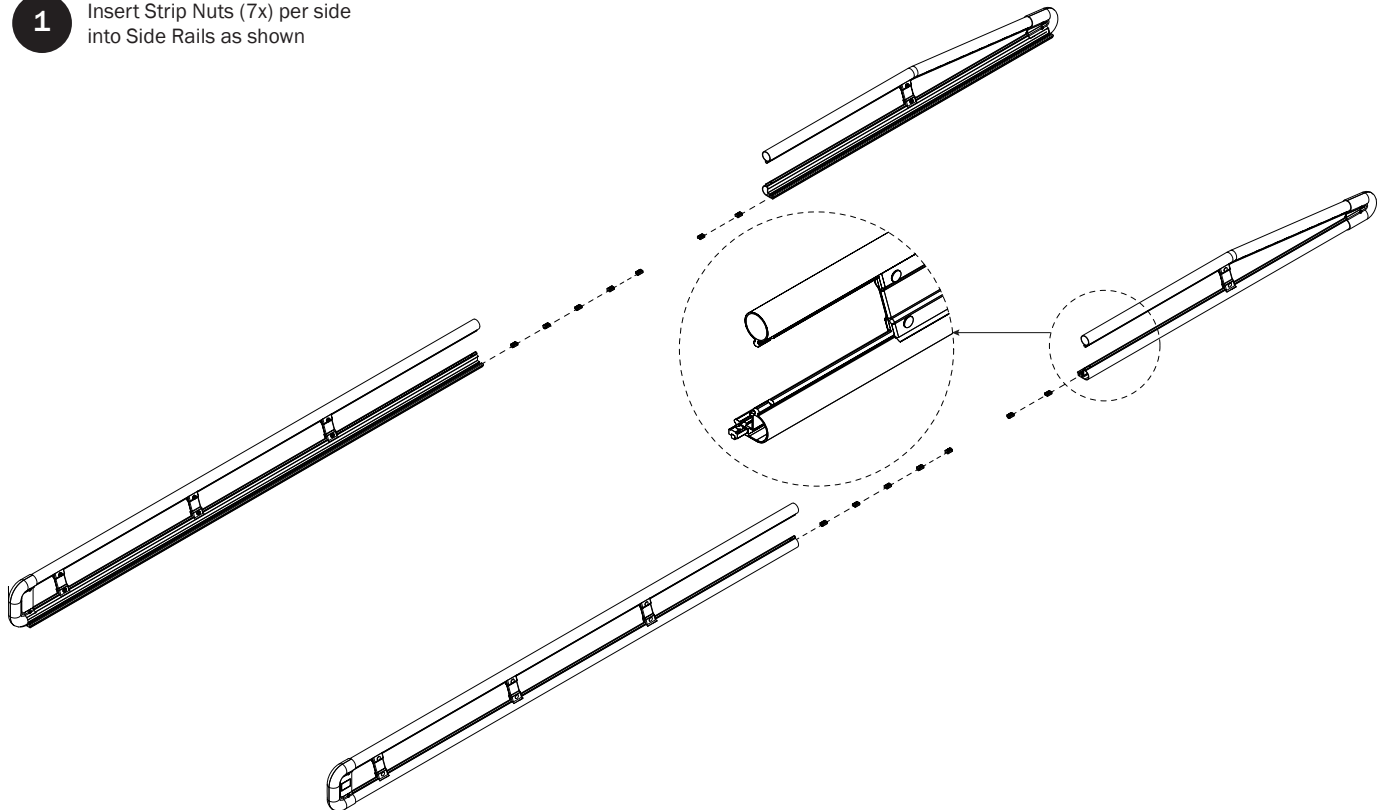

SIDE RAIL ASSEMBLY

2.1 Assemble Side rails as shown

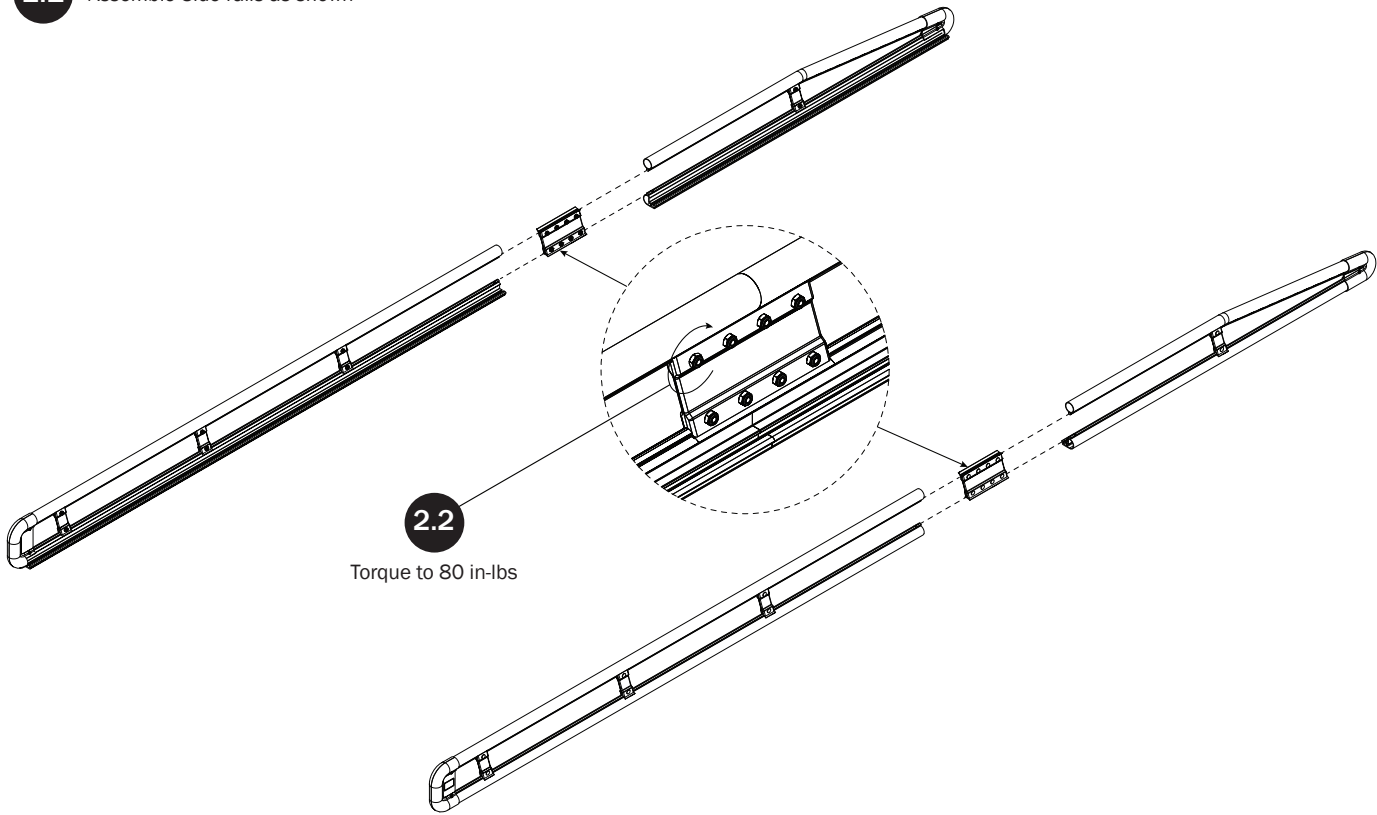

LEFT SIDE RAIL AND CROSSBARS

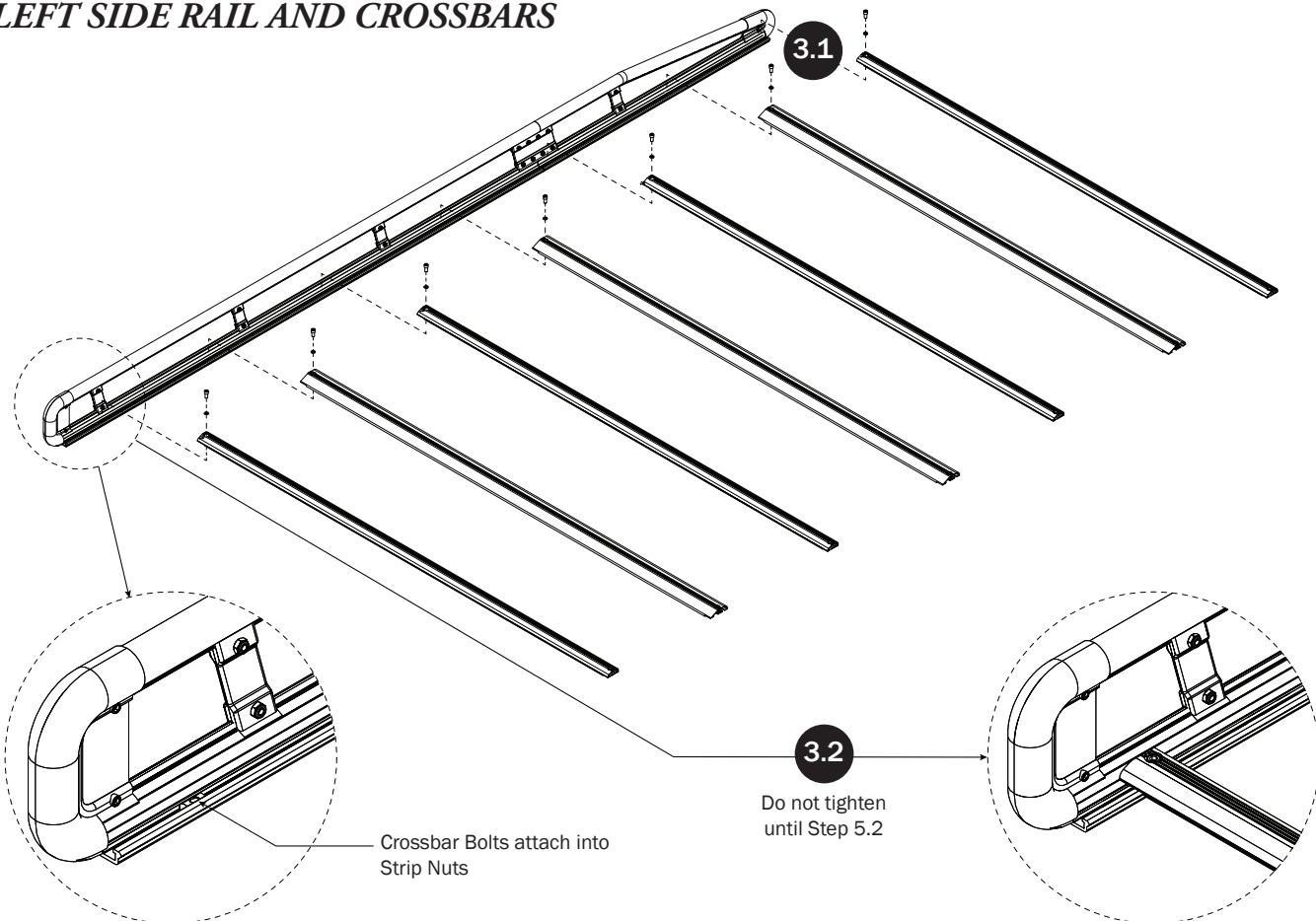

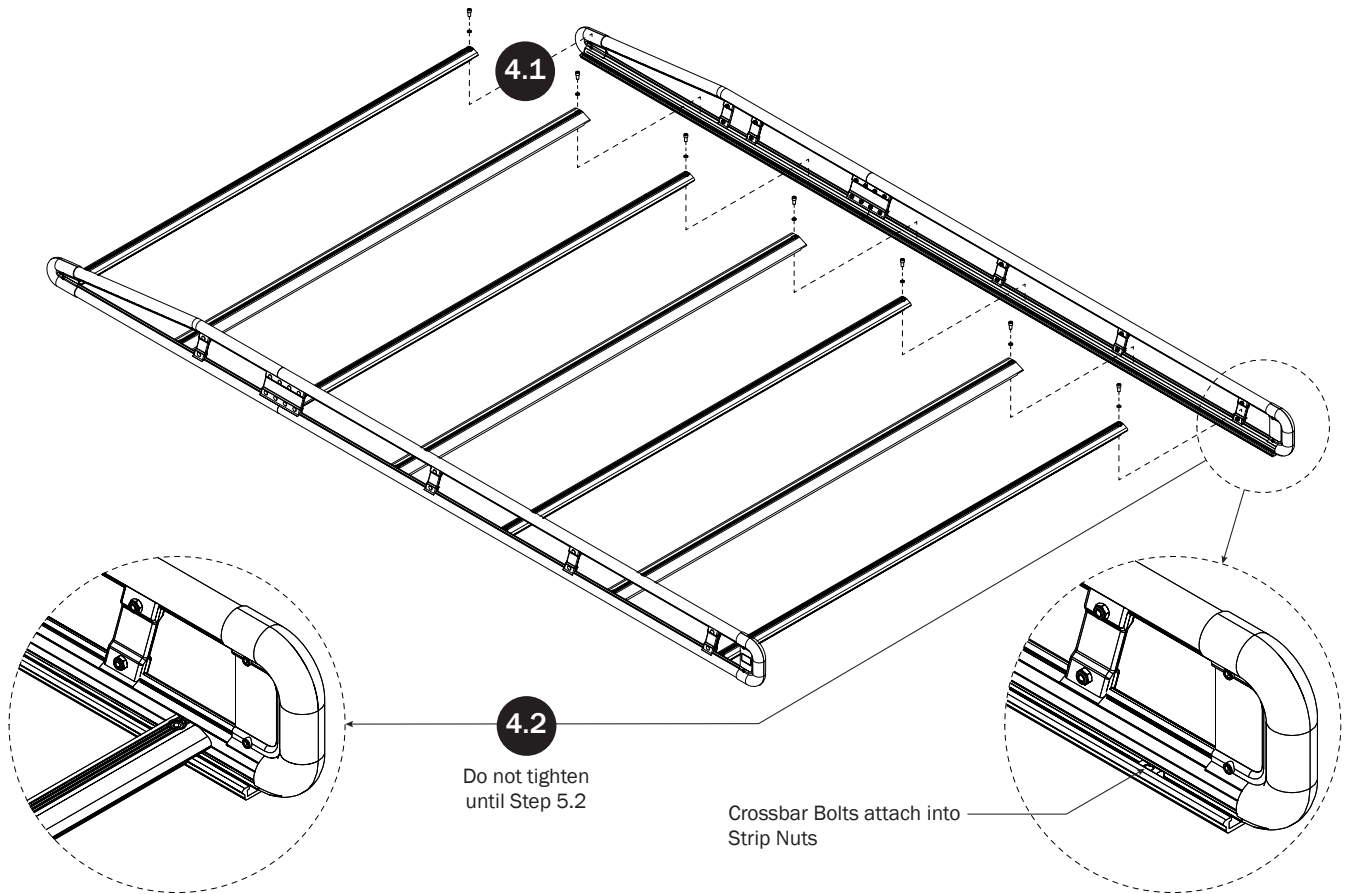
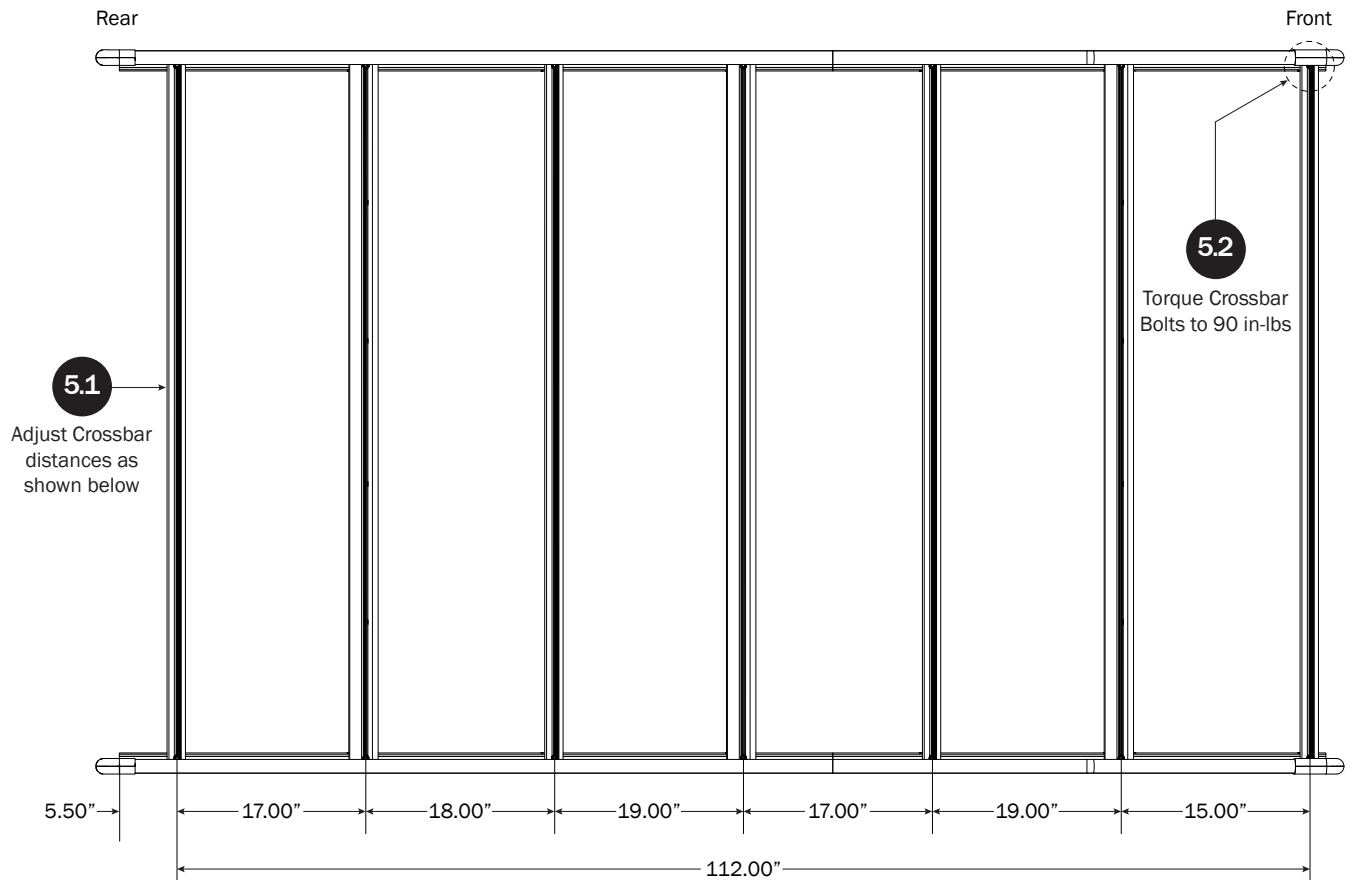
RIGHT SIDE RAIL AND CROSSBARS**CROSSBAR ADJUSTMENT**

ROLLER ASSEMBLY

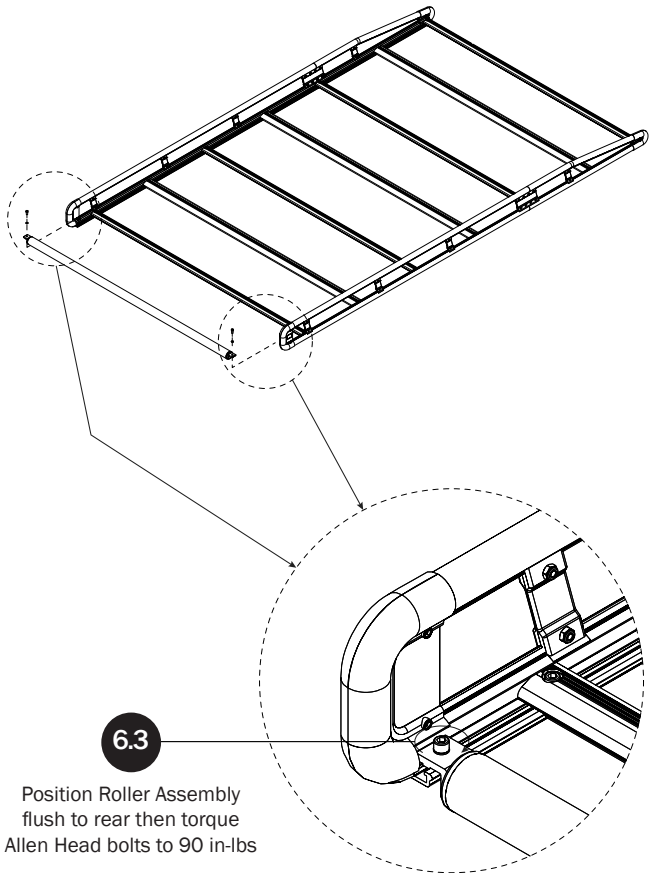
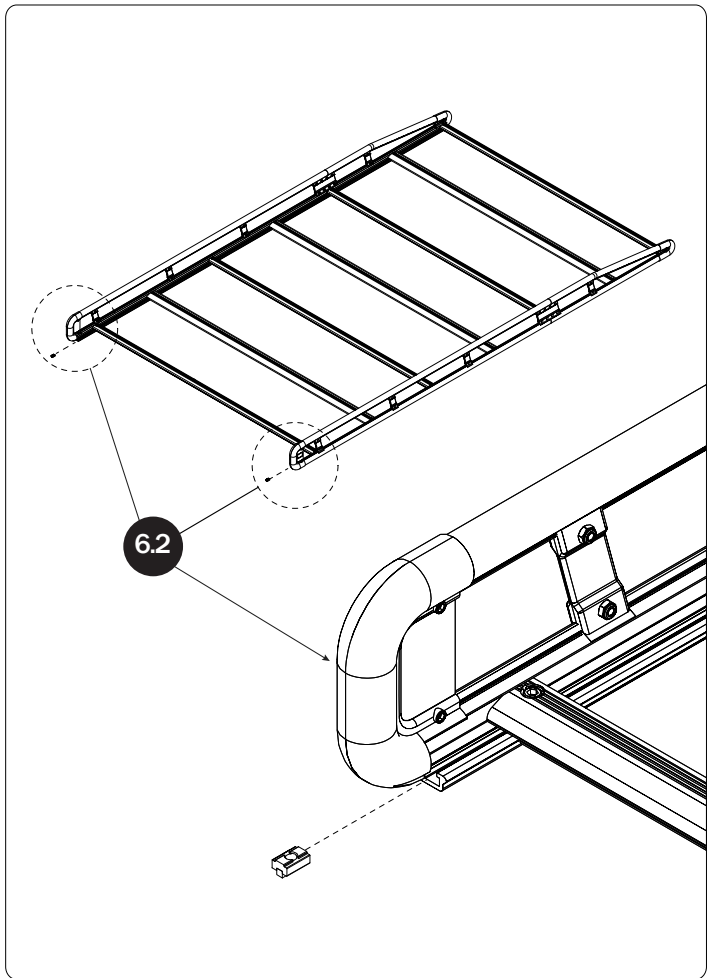
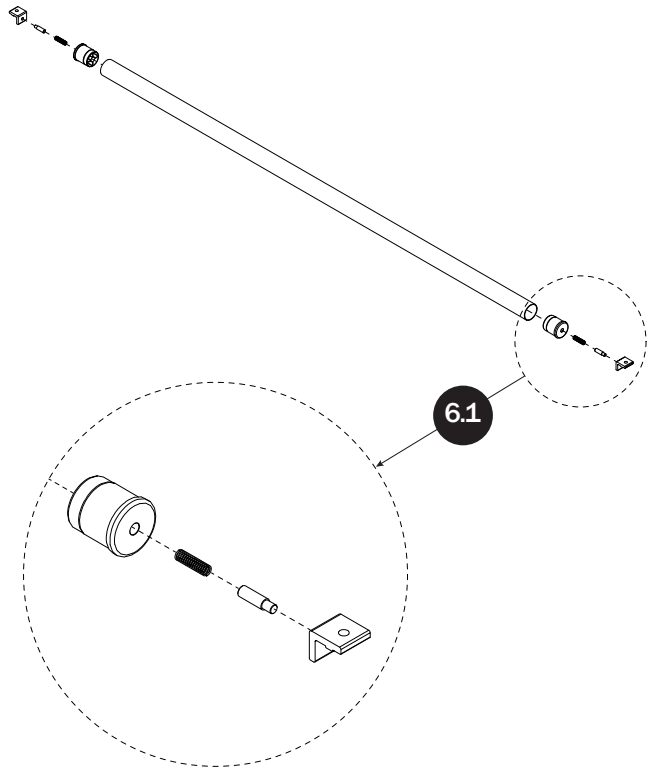

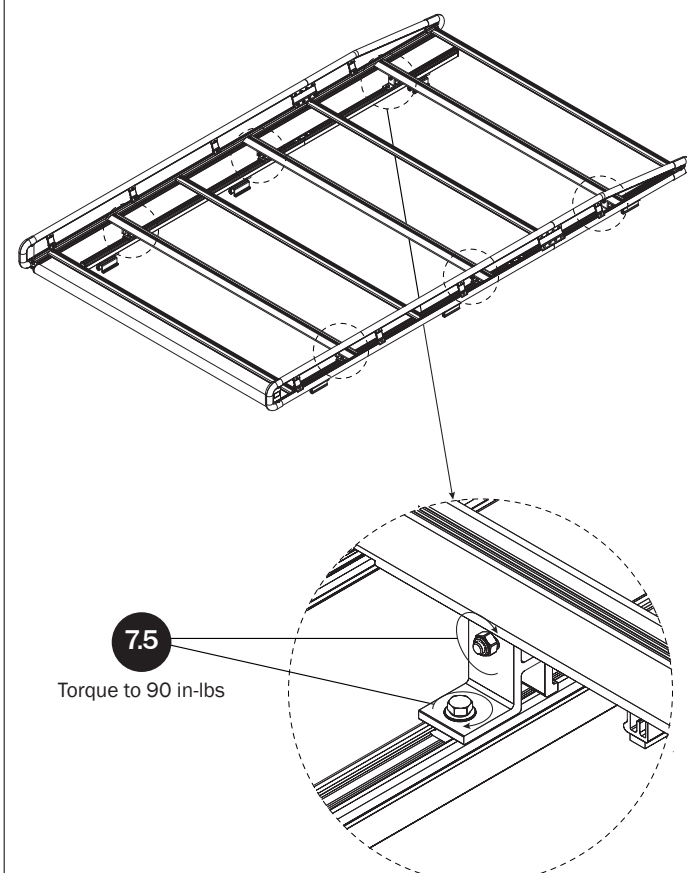
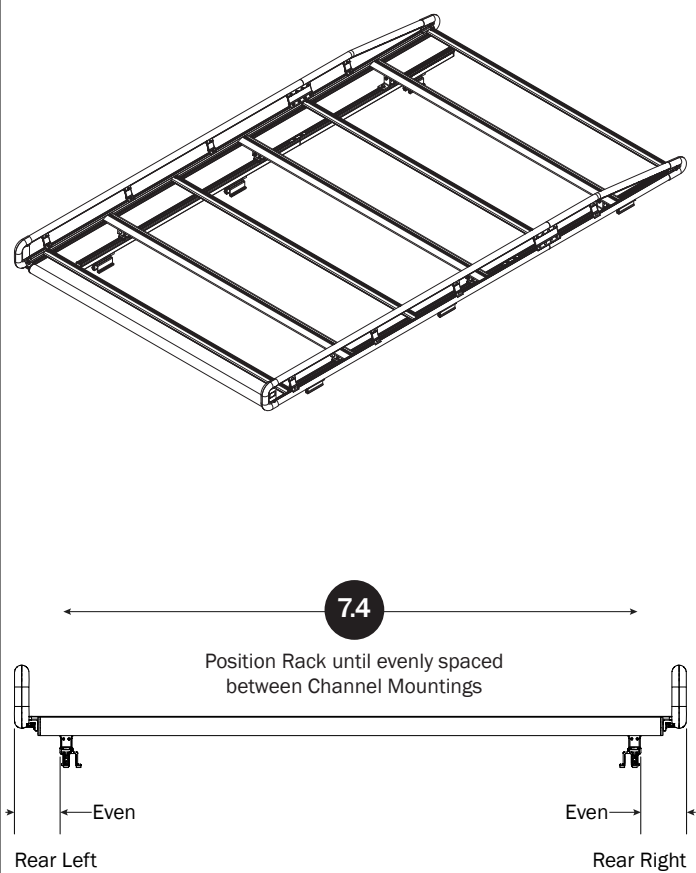
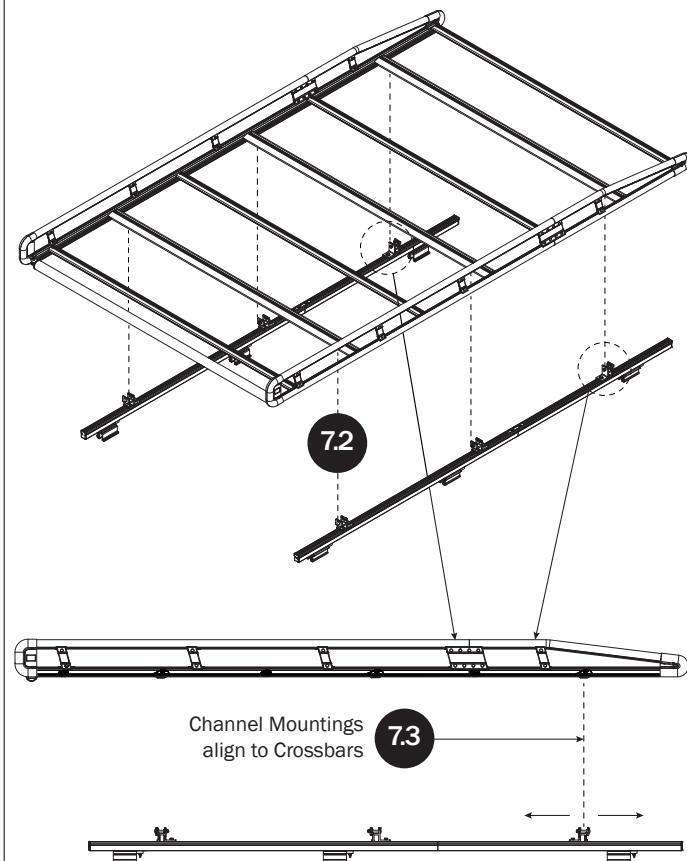
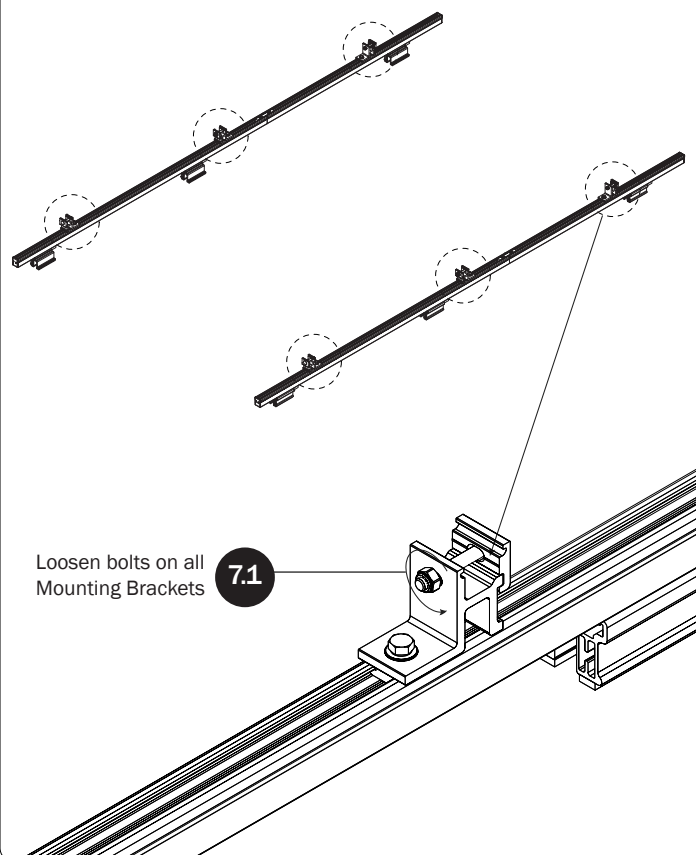
MOUNTING RACK TO CHANNELS

Page Intentionally Left Blank

