

# PRIME DESIGN™

A Safe Fleet Brand

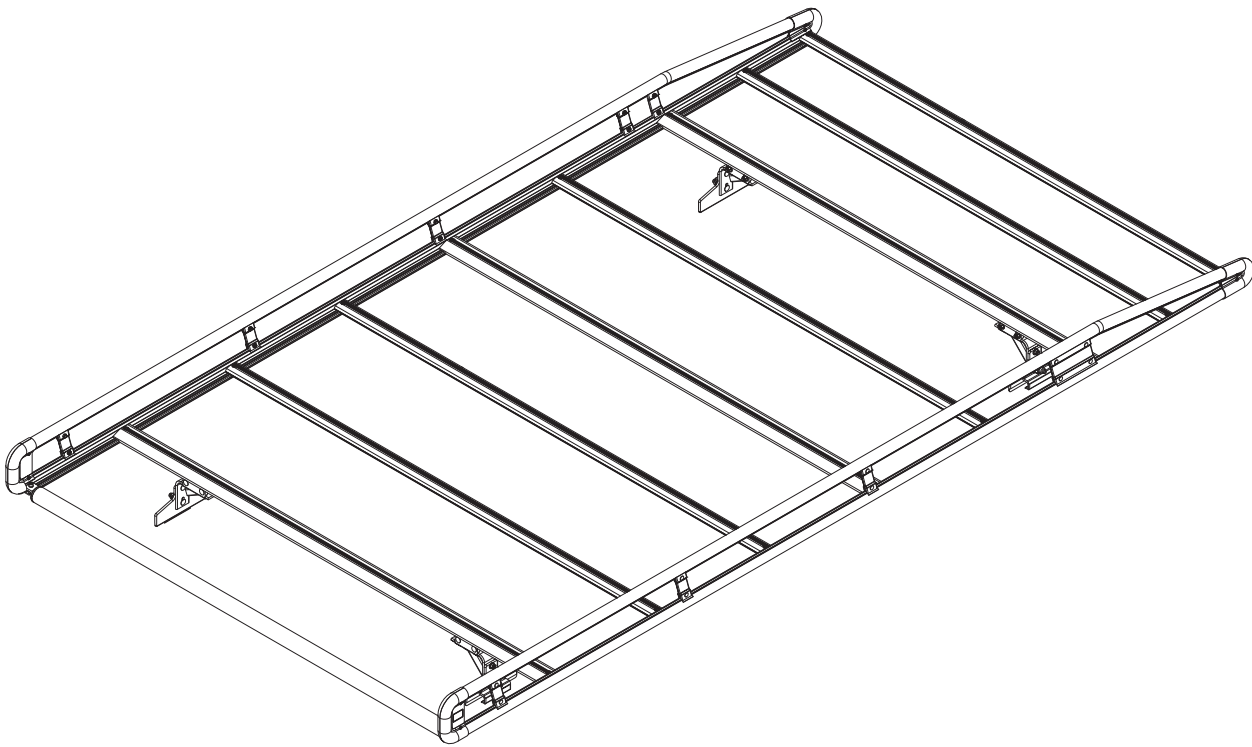

## AR1303-S

## CONTENTS OVERVIEW

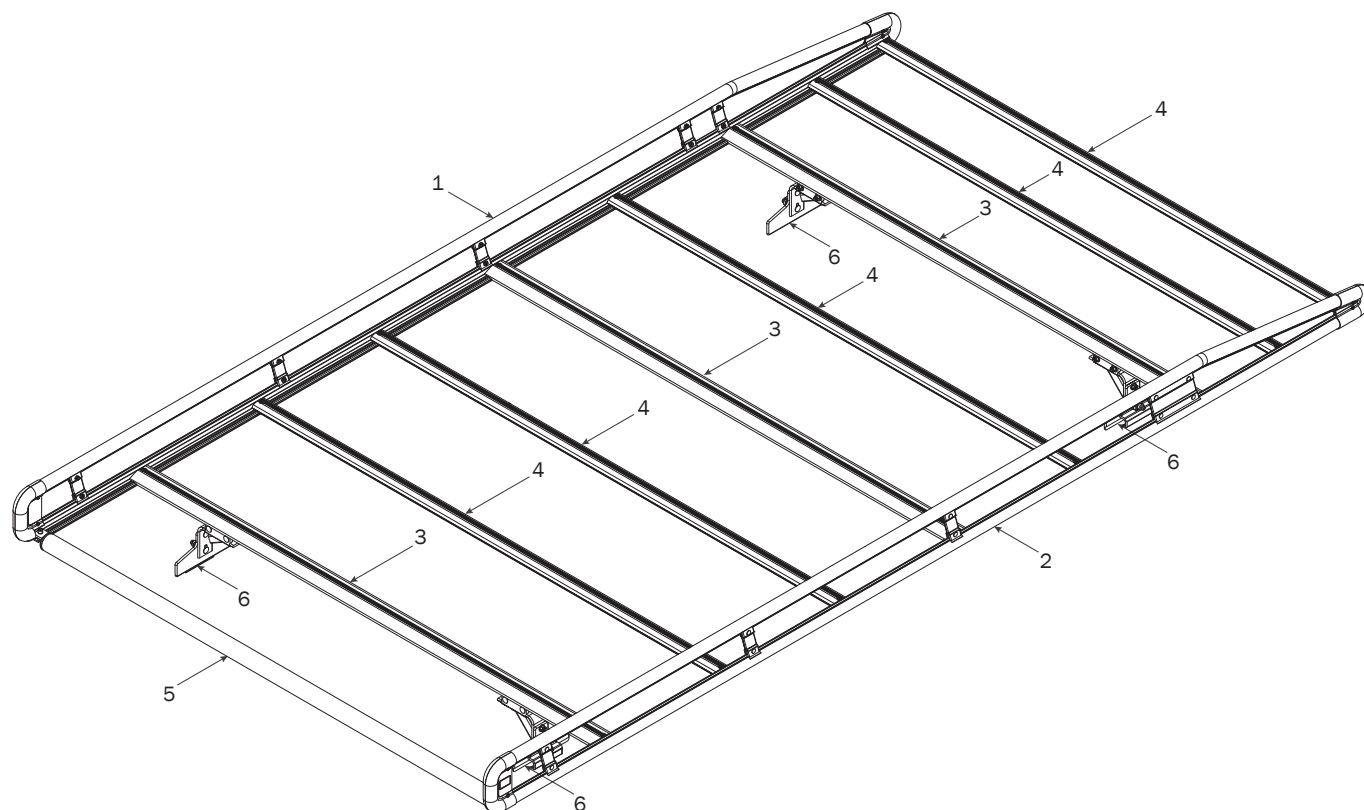

1—Side Rail Assembly ..... (Qty 1)  
Left Hand, 123.00"



2—Side Rail Assembly ..... (Qty 1)  
Right Hand, 123.00"

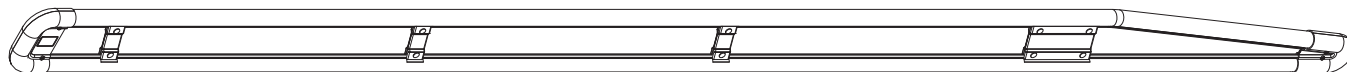

3—AluRack Heavy Duty Crossbar ..... (Qty 3)  
With hardware, 67.00"



4—AluRack Standard Crossbar ..... (Qty 5)  
With hardware, 67.00"



5—Roller Tube Assembly ..... (Qty 1)  
With caps, 63.75"

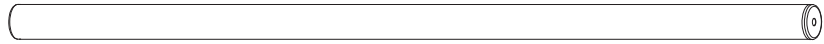

6—Mounting Bracket Assembly ..... (Qty 4)  
AluRack, 4.5" Guttered

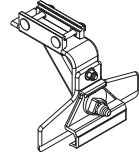

HKT-0083-Hardware Kit

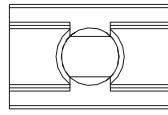

M8 Strip Nut (19X)

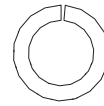

M8 Lock Washer (19X)

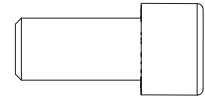

M8 Cap Head Bolt (19X)



Roller Holder (2X)



Roller Tube Pin (2X)

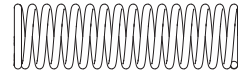

Roller Spring (2X)



Anti-Seize (1X)

## MOUNTING BRACKETS BRACKET PRE-ASSEMBLY

- 0.1** Assemble the Guttered Mounting Plate and secure with washer and nut. Do not tighten until the rack is mounted onto the vehicle.

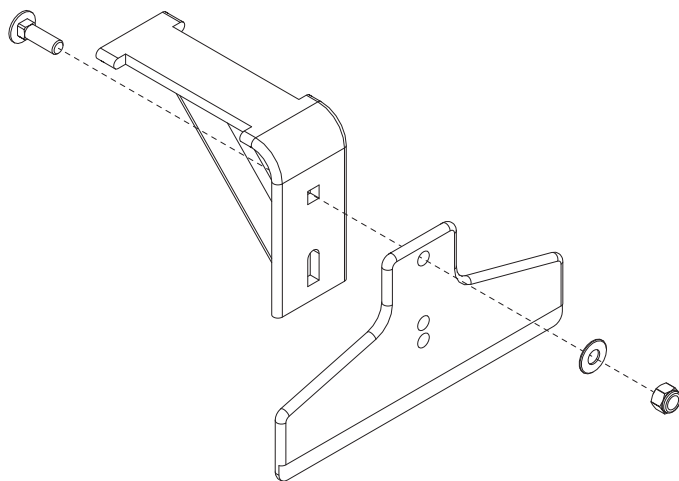

- 0.2** Assemble the Z Plate and secure with washer and nut. Do not tighten until the rack is mounted onto the vehicle.

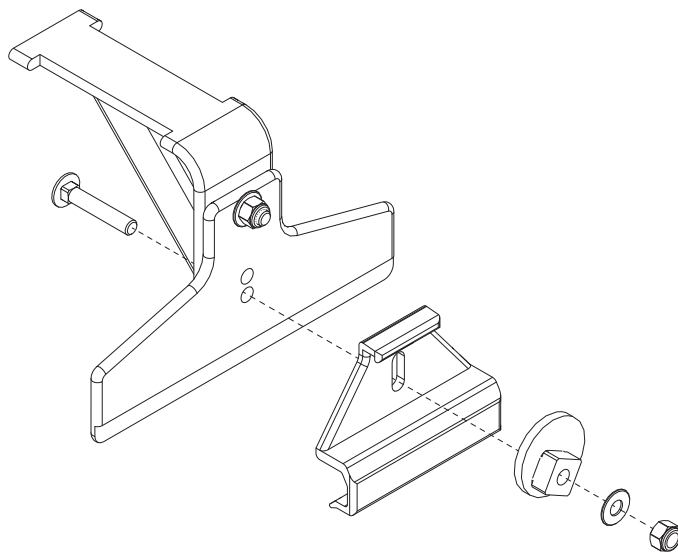

- 0.3** Assemble the Crossbar Mounting Connectors and secure with hardware. Do not tighten until the rack is mounted on the vehicle.

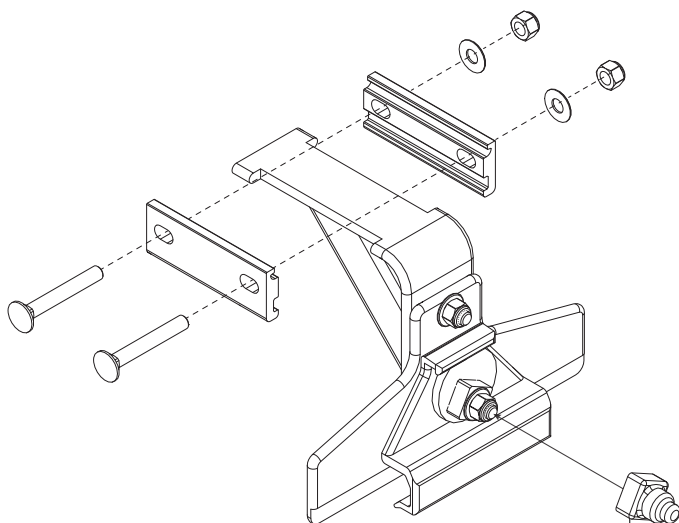

Apply cap

**0.4**

- 0.5** Repeat Steps 0.1–0.4 to assemble the remaining Mounting Brackets.

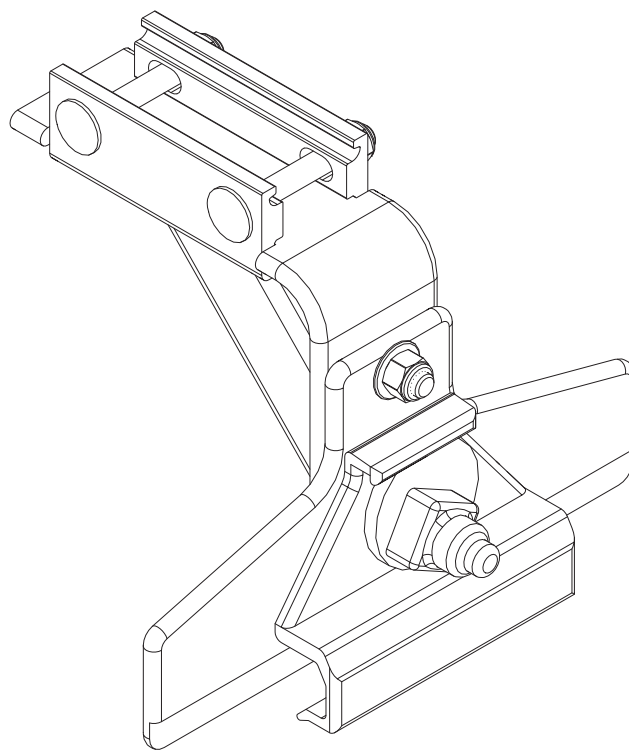

## ALURACK ASSEMBLY SEQUENCE

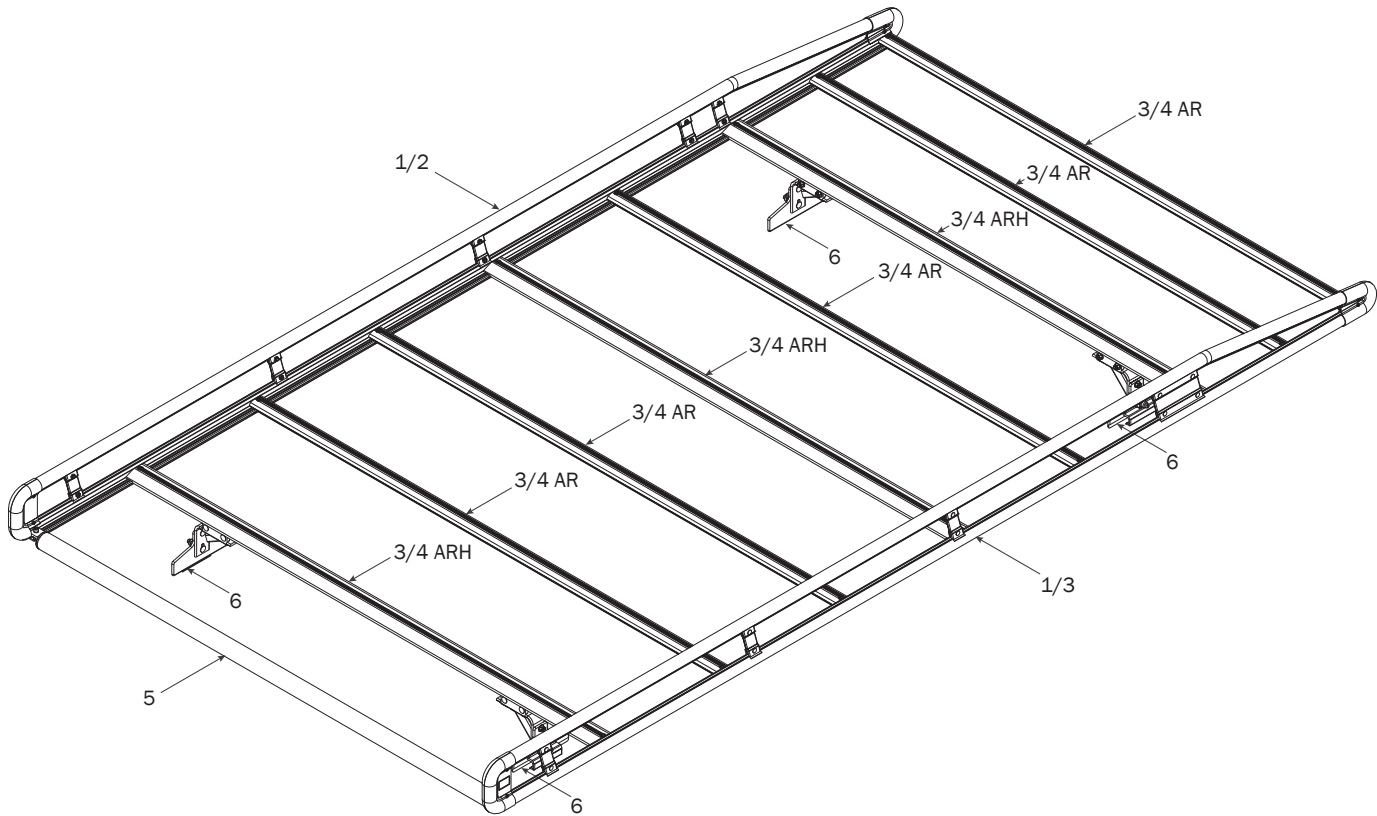

## STRIP NUT ASSEMBLY

- 1 Insert Strip Nuts (8x) per side into Side Rails as shown

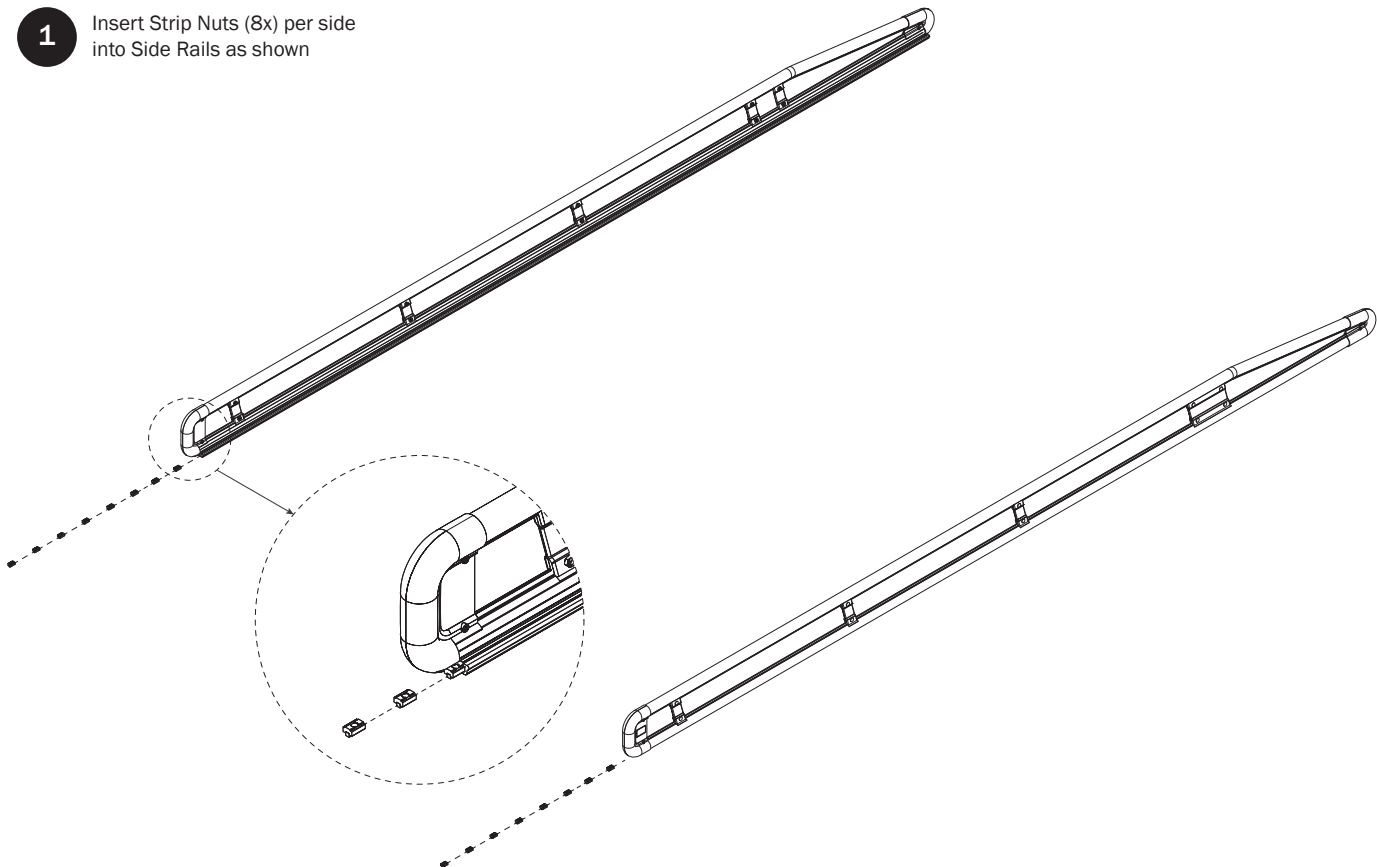

## LEFT SIDE RAIL AND CROSSBARS

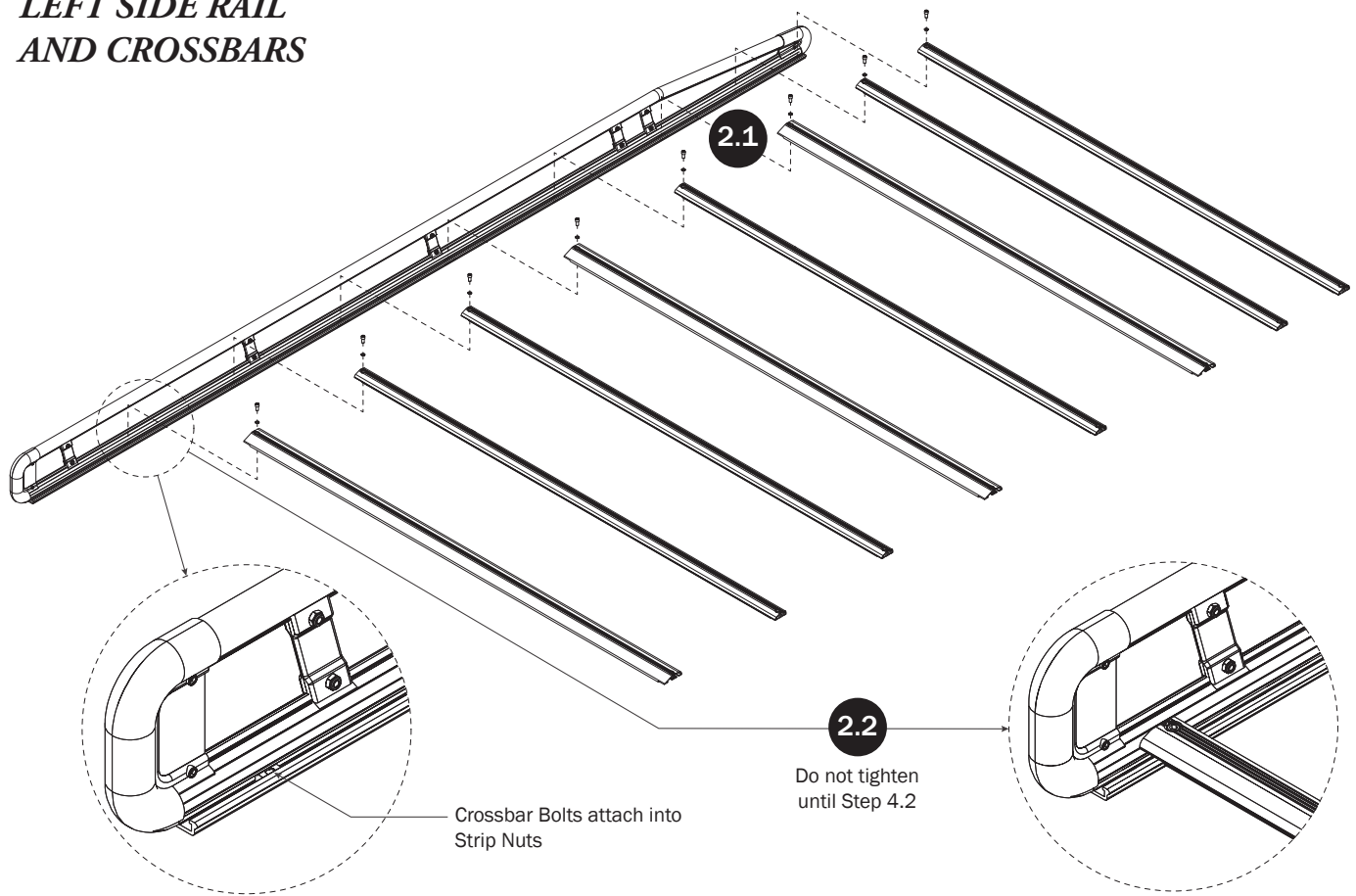

## RIGHT SIDE RAIL AND CROSSBARS

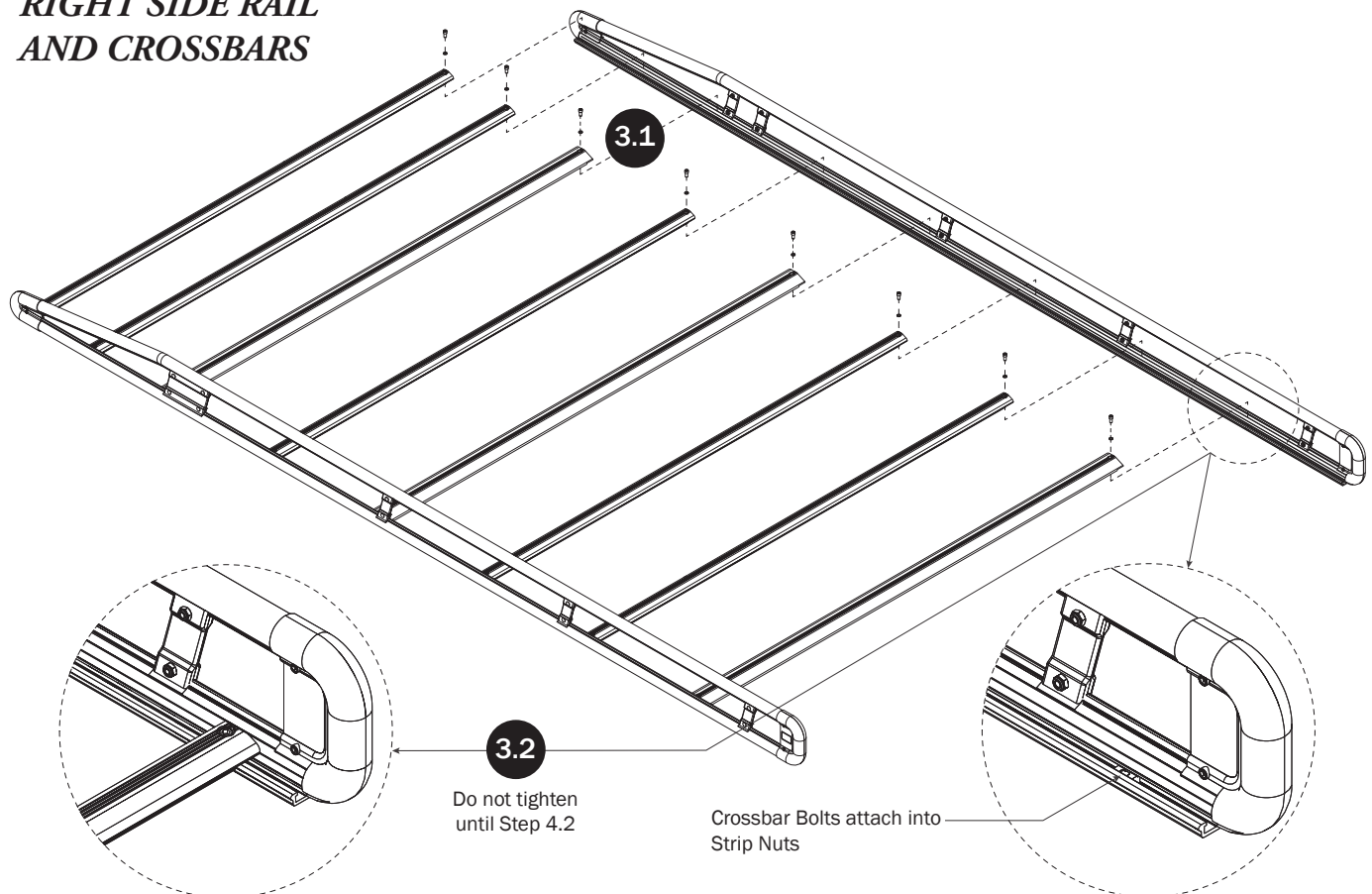

CROSSBAR ADJUSTMENT

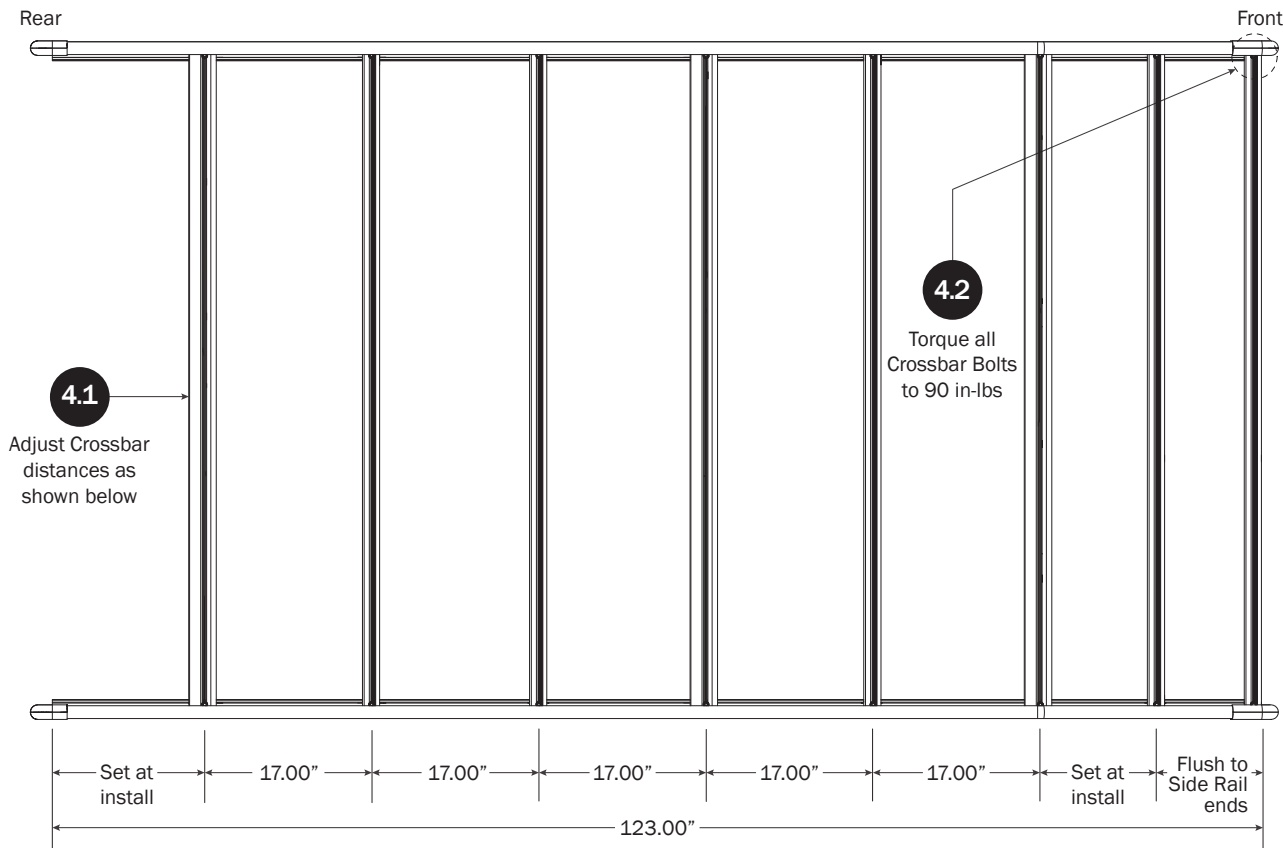

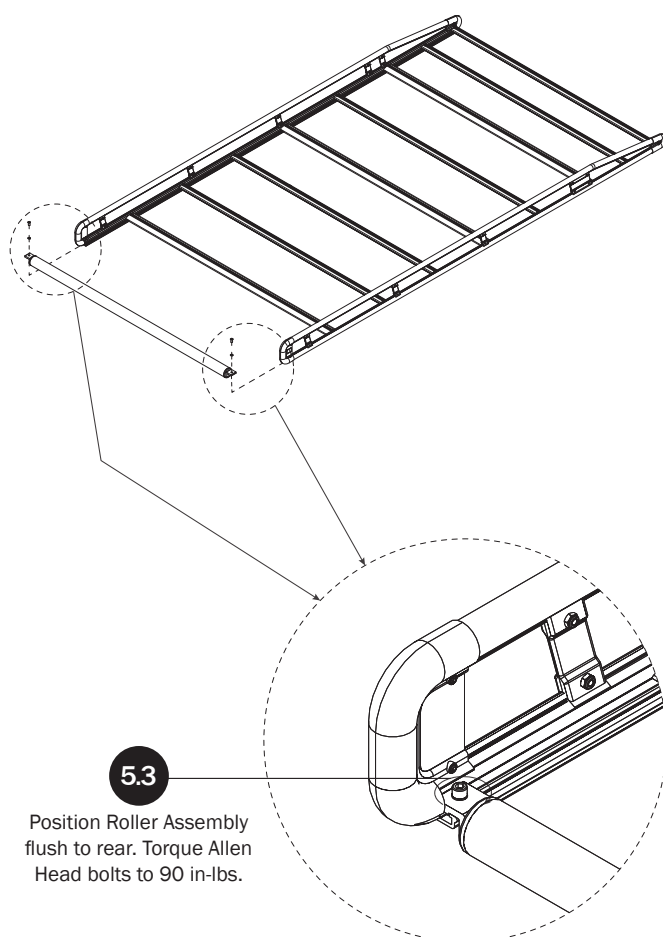
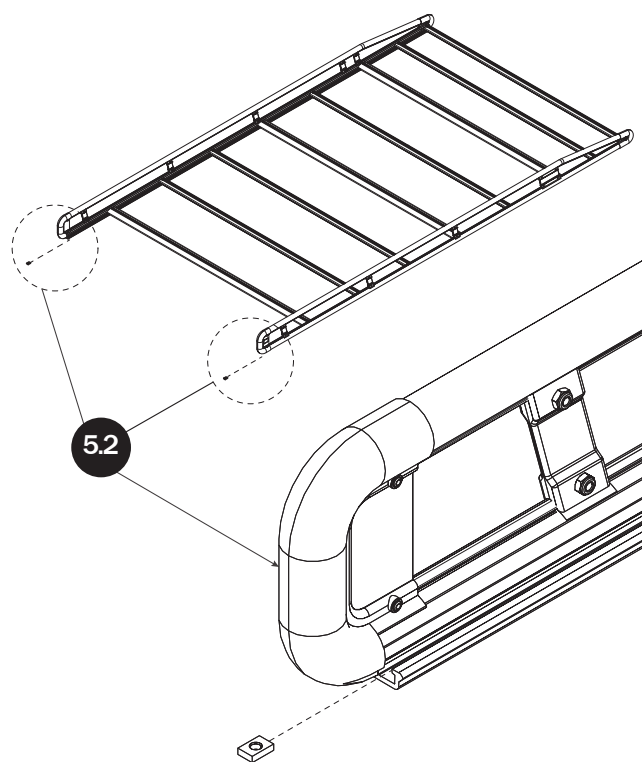
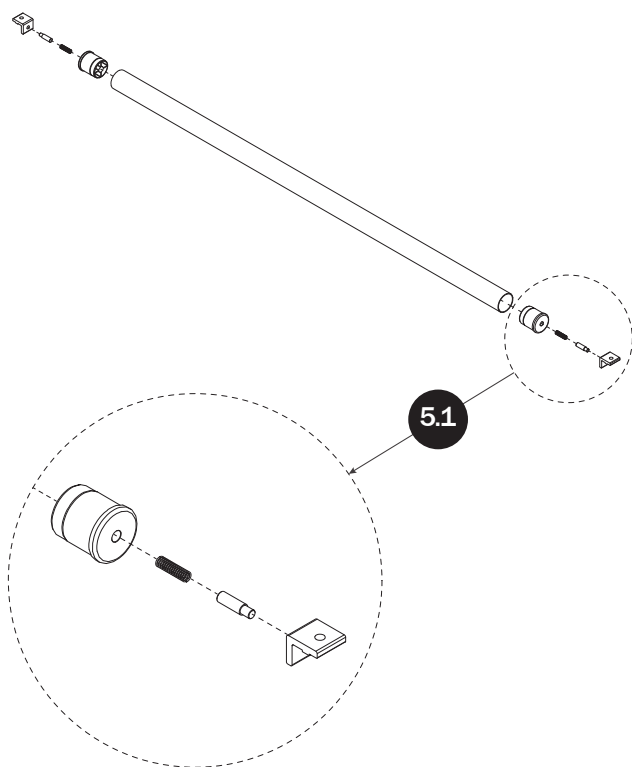
**ROLLER ASSEMBLY**



## MOUNTING

Step 6.1: Loosen nuts on all Mounting Brackets

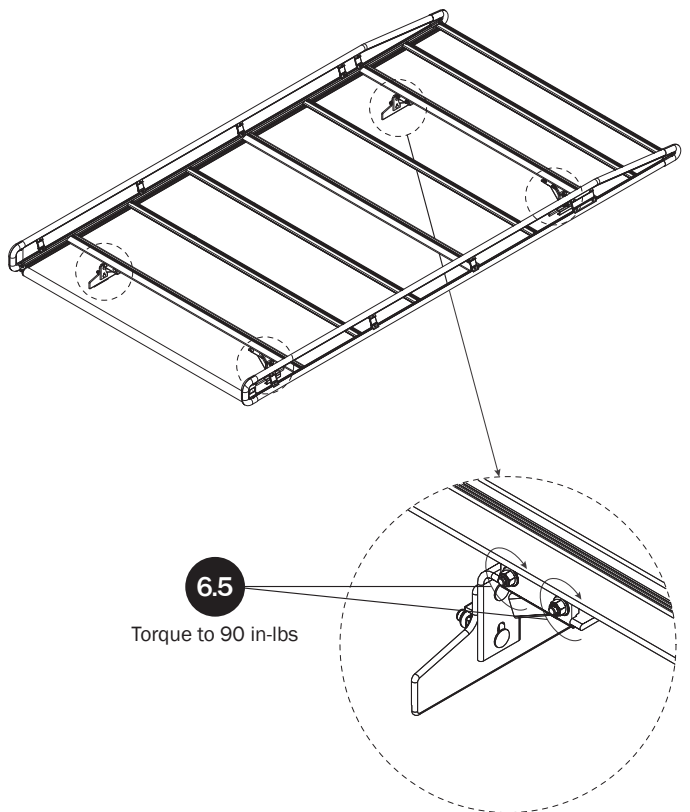
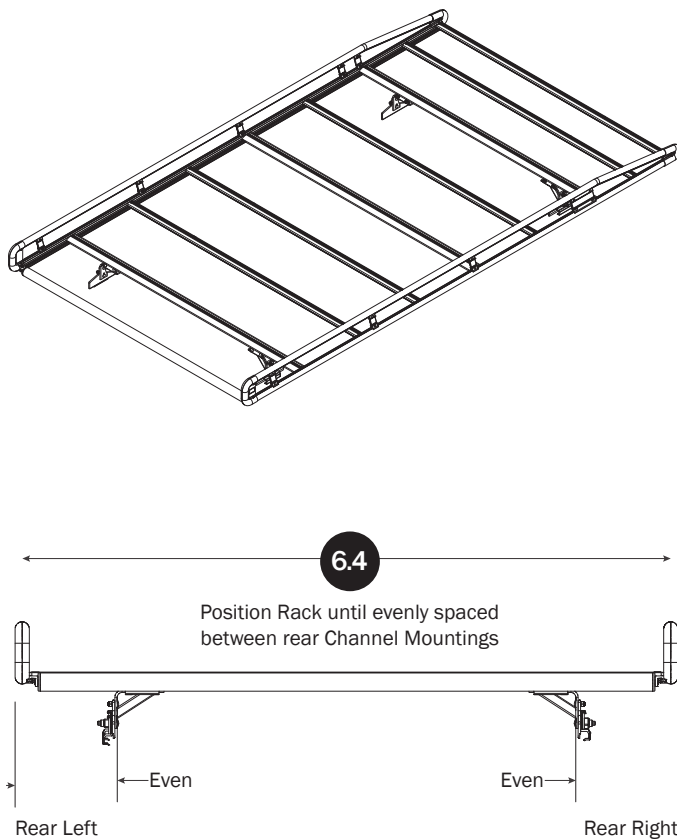
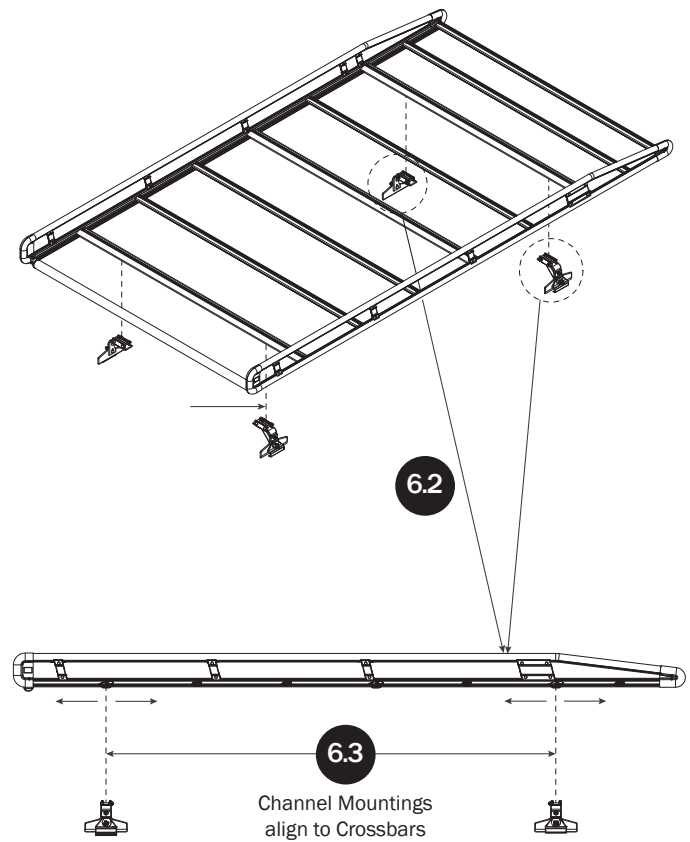
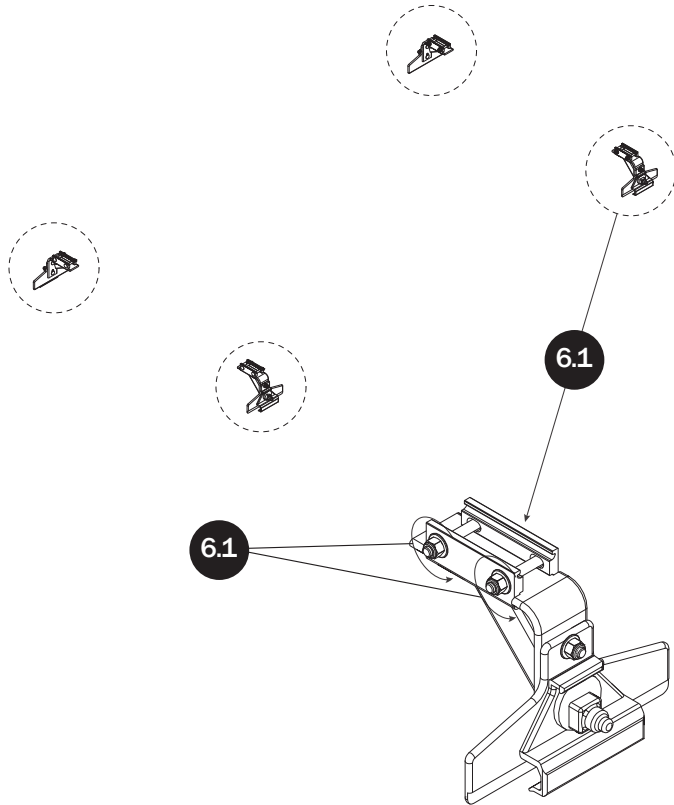

Page Intentionally Left Blank

Page Intentionally Left Blank

