

PRIME DESIGN™

A Safe Fleet Brand

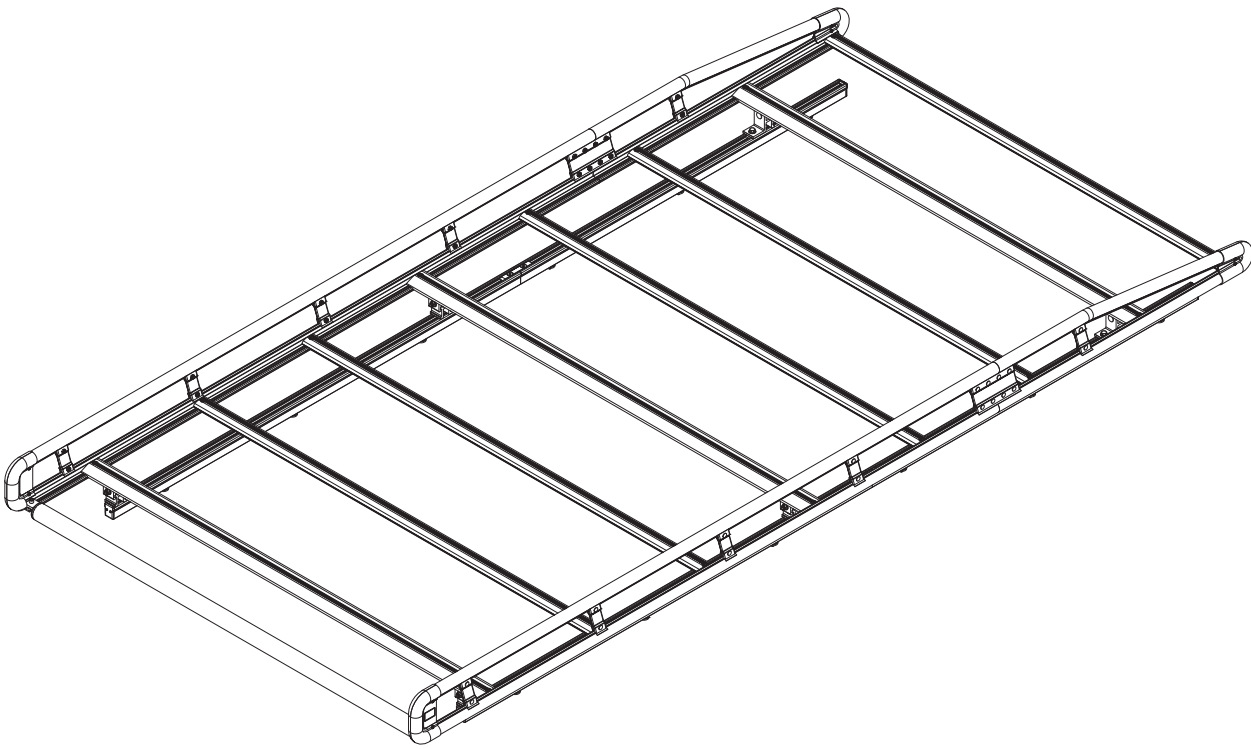

AR1929

CONTENTS OVERVIEW

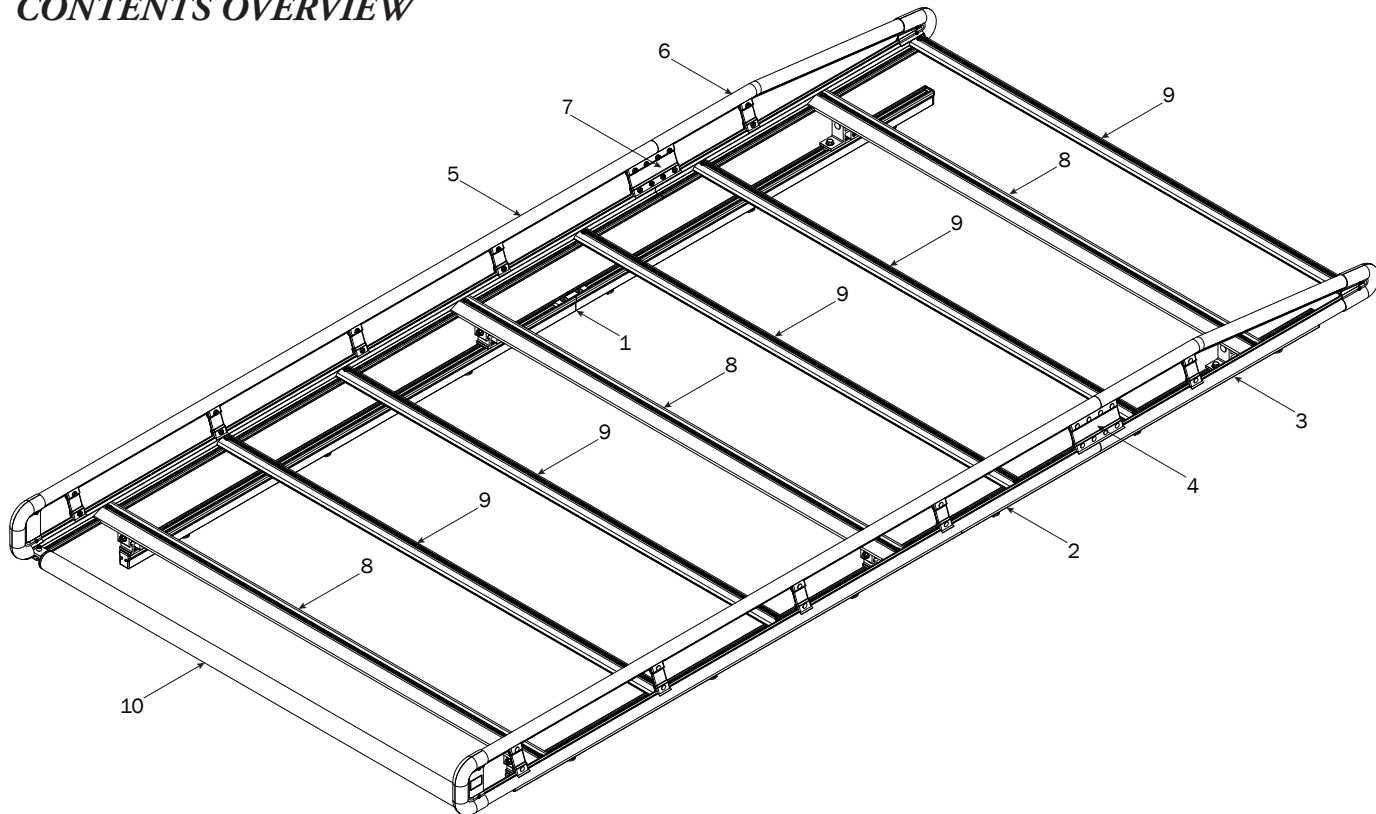

1—FBM3-0057-A..... (Qty 1)
Channels with hardware

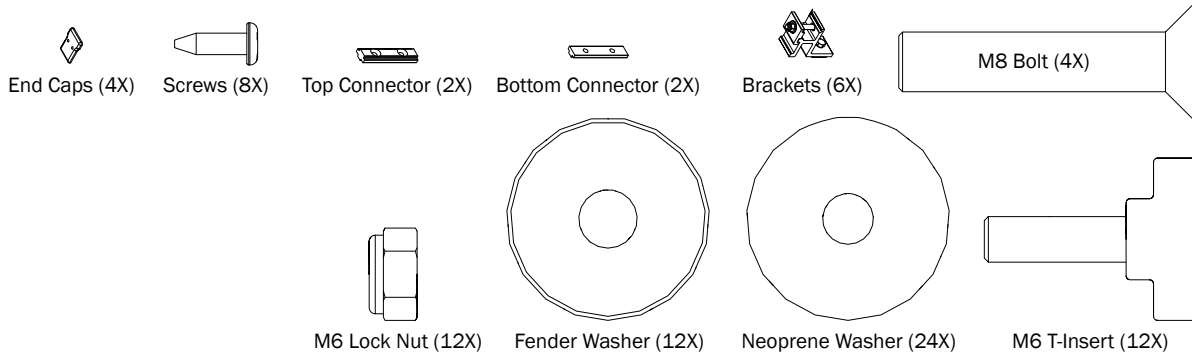

2—Side Rail Assembly..... (Qty 1)
Left Hand, 84.00"

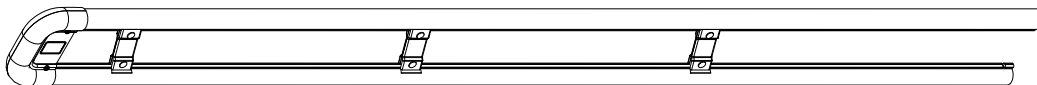

3—Side Rail Assembly..... (Qty 1)
Right Hand, 36.00"

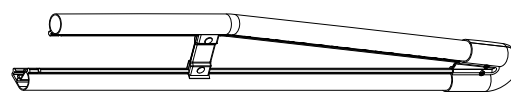

4—Side Rail Connector (Qty 1)
Right Hand, 6.00"



5—Side Rail Assembly..... (Qty 1)
Rear, Left Hand, 84.00”

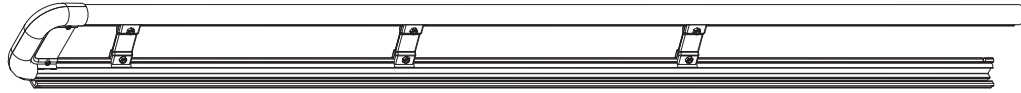

6—Side Rail Assembly..... (Qty 1)
Front, Left Hand, 36.00”

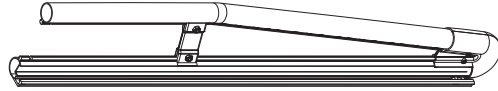

7—Side Rail Connector (Qty 1)
Left Hand, 6.00”

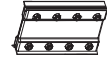

8—AluRack Construction Crossbar..... (Qty 3)
With hardware, 59.00”



9—AluRack Standard Crossbar (Qty 5)
With hardware, 59.00”



10—Roller Assembly..... (Qty 1)
With hardware, 55.75”



HKT-0083 Hardware Kit

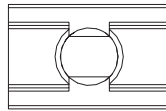

M8 Strip Nut (18X)

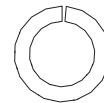

M8 Lock Washer (18X)

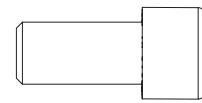

M8 Cap Head Bolt (18X)



Roller Holder (2X)



Roller Tube Pin (2X)

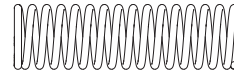

Roller Spring (2X)



Anti-Seize (1X)

FBM3-0057-A
MOUNTING BRACKETS

0.1 Assemble Channel hardware through roof as shown, but do not tighten.

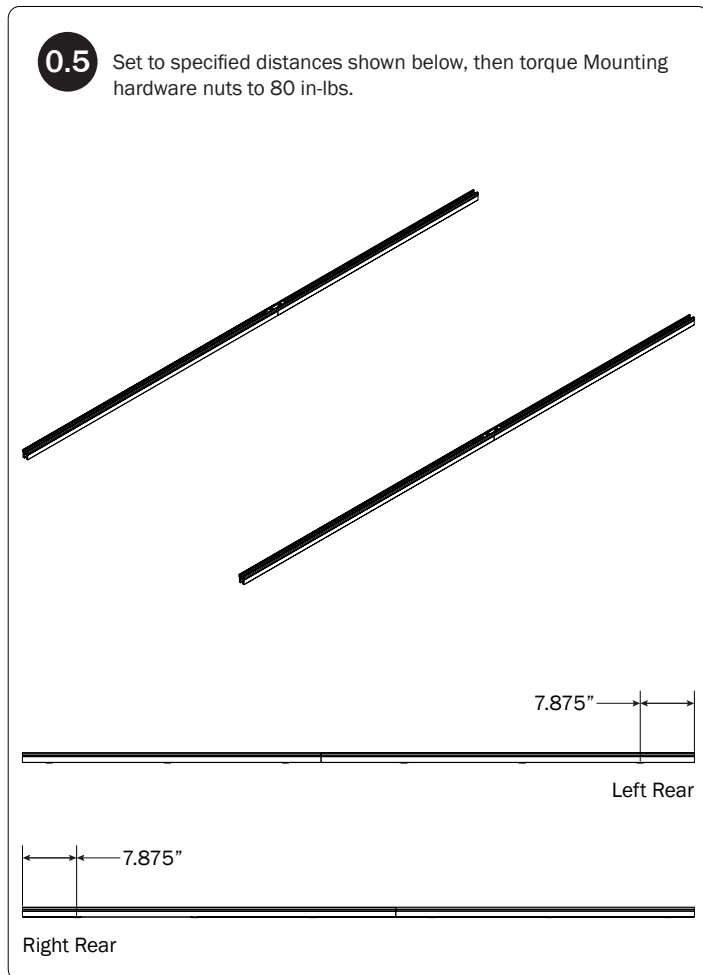
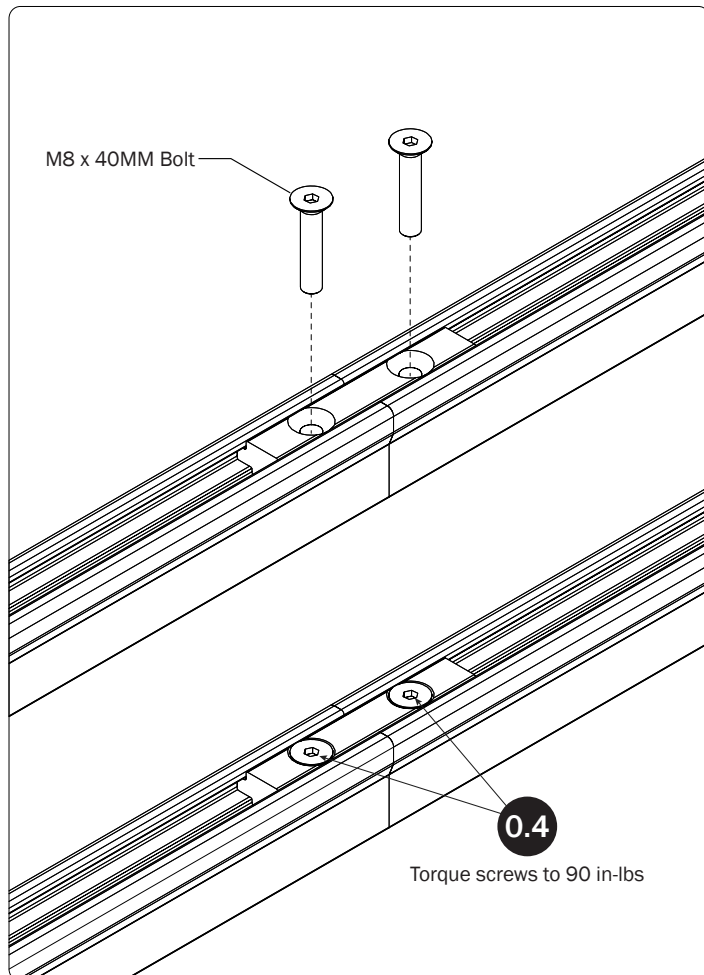
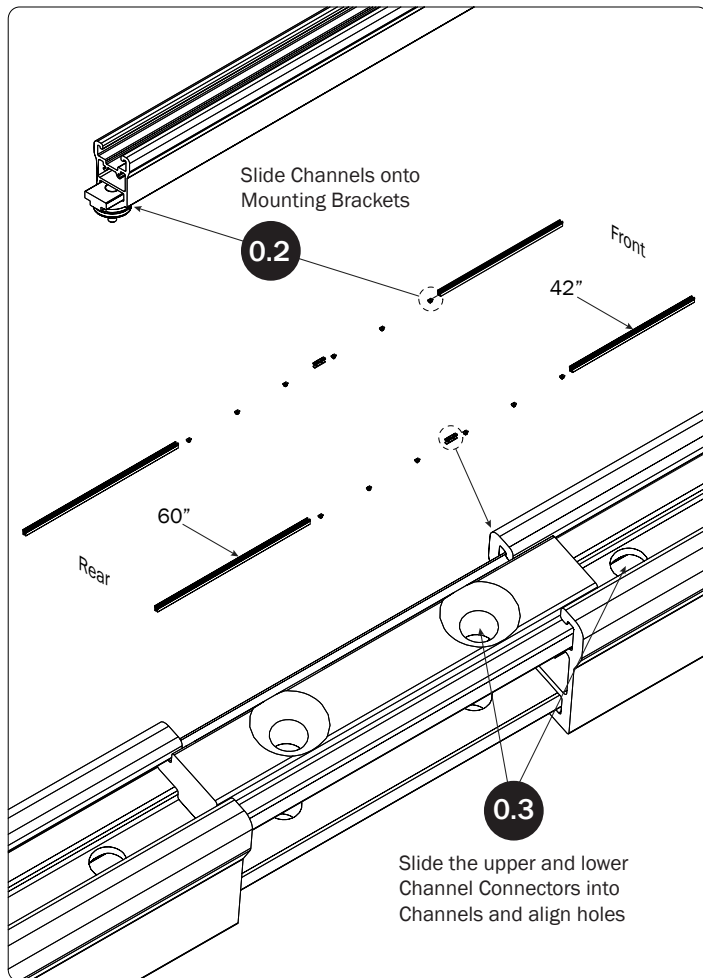
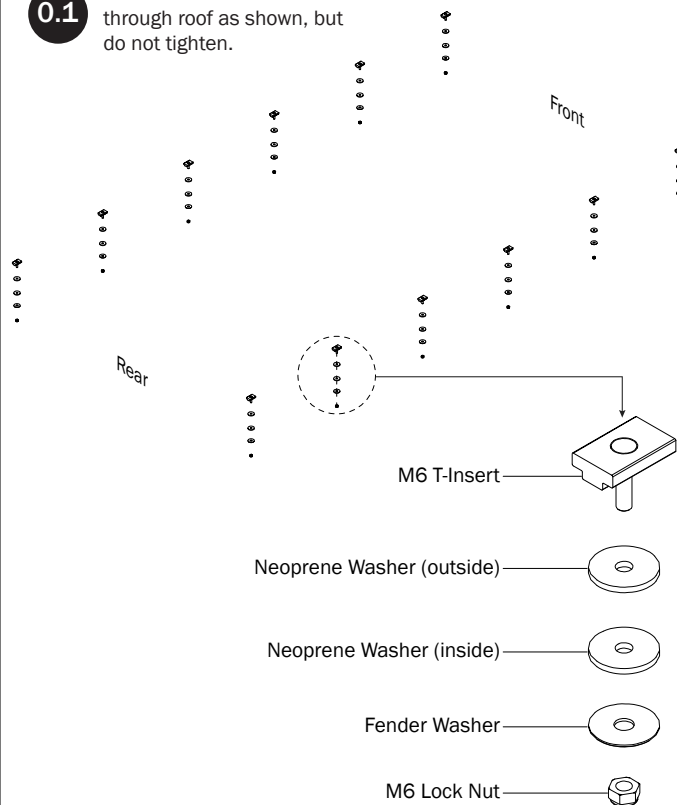

0.7 Set to distances then torque Rear Bracket nuts to 90 in-lbs leaving Center and Front Brackets loose

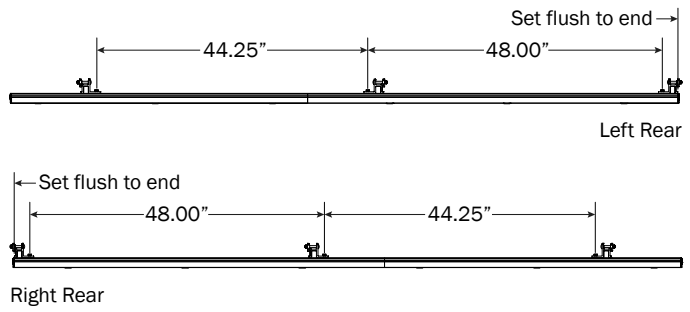

0.6 Loosen bolts

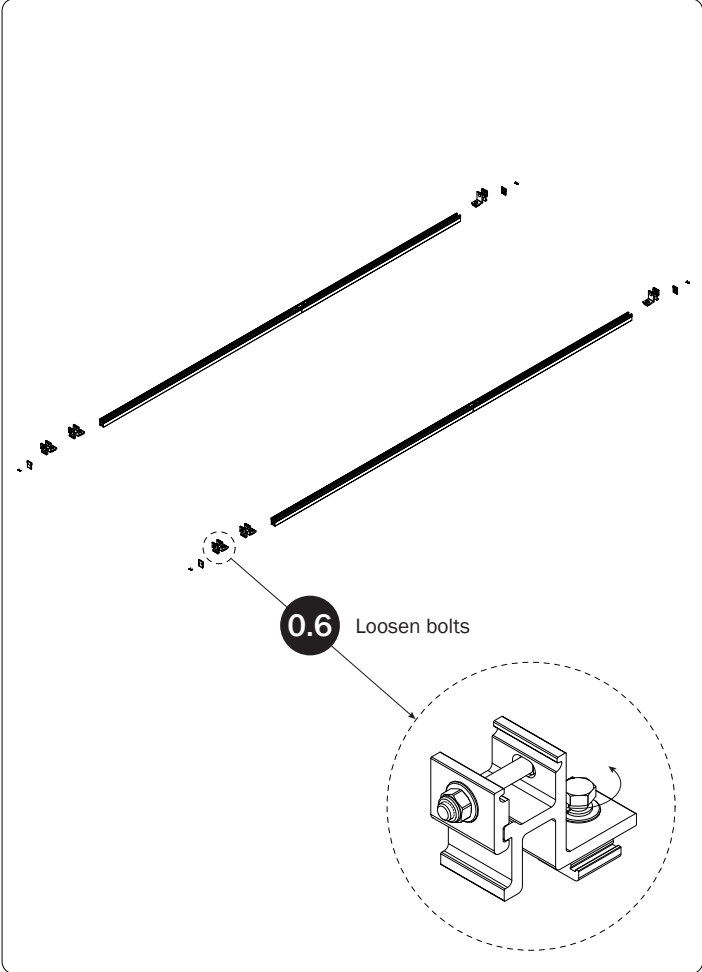
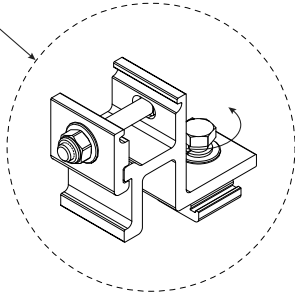

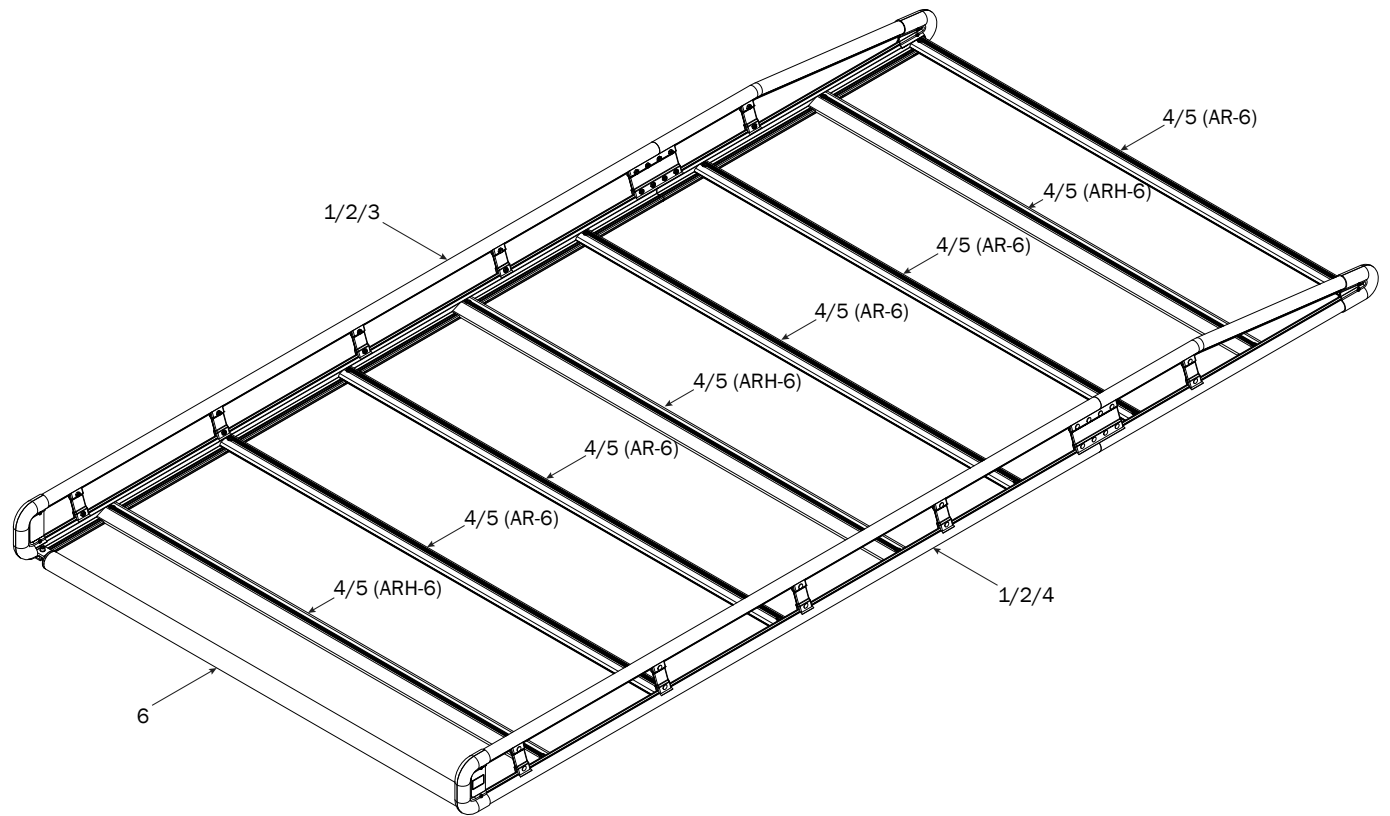
ALURACK ASSEMBLY SEQUENCE**STRIP NUT ASSEMBLY**

- 1** Insert Strip Nuts (9x) per side into Side Rails as shown

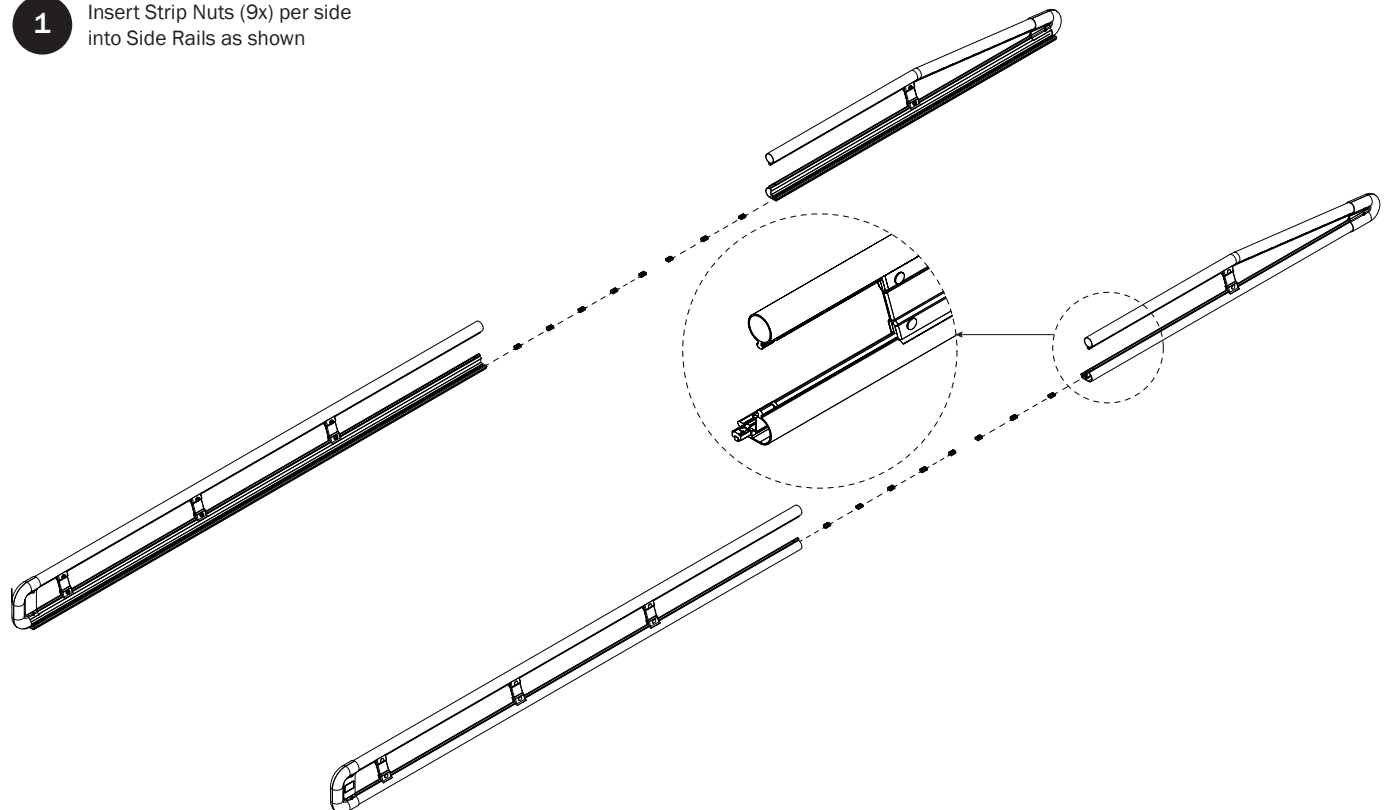

SIDE RAIL ASSEMBLY

2.1 Assemble Side rails as shown

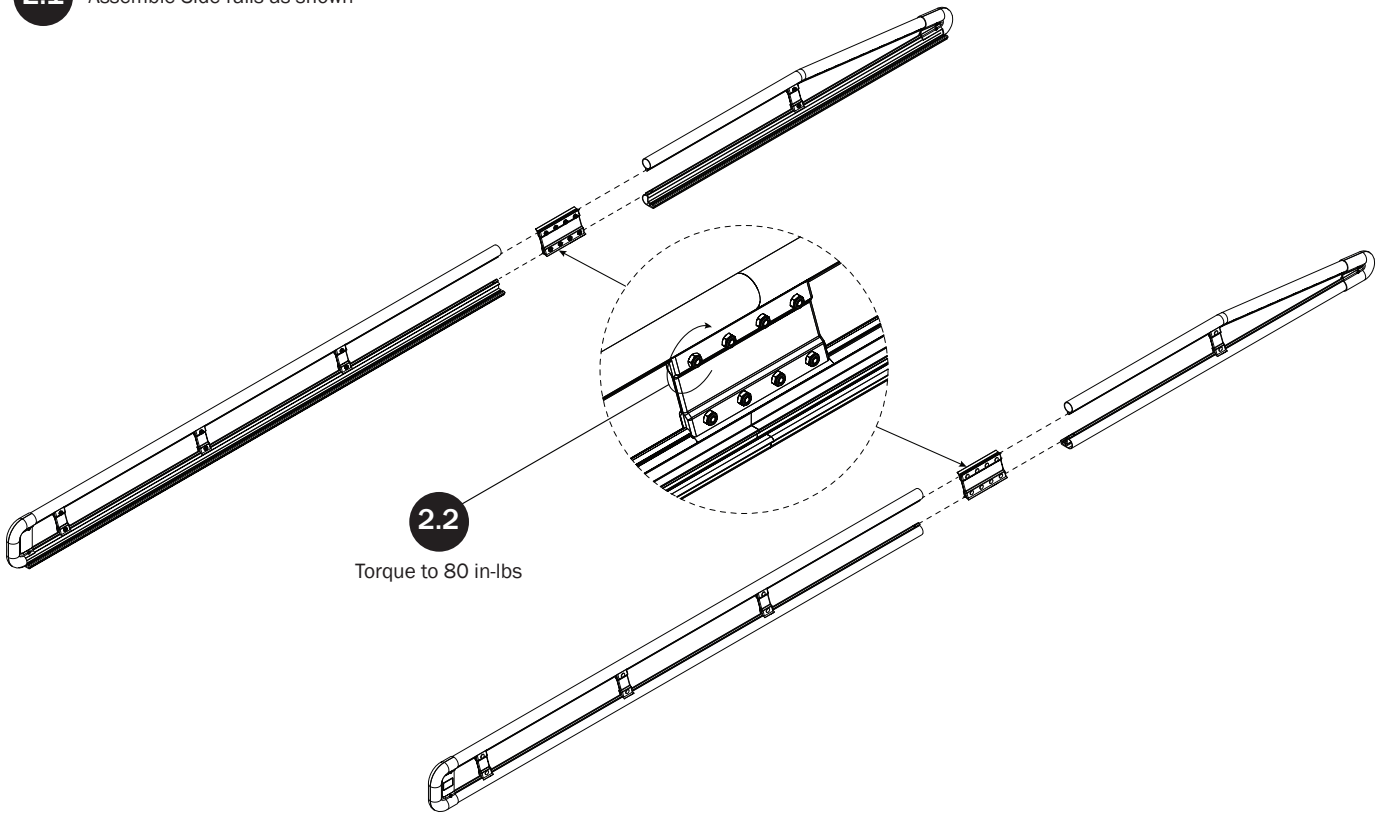

2.2
Torque to 80 in-lbs

LEFT SIDE RAIL AND CROSSBARS

3.1 Attach Crossbars to Side Rails as shown

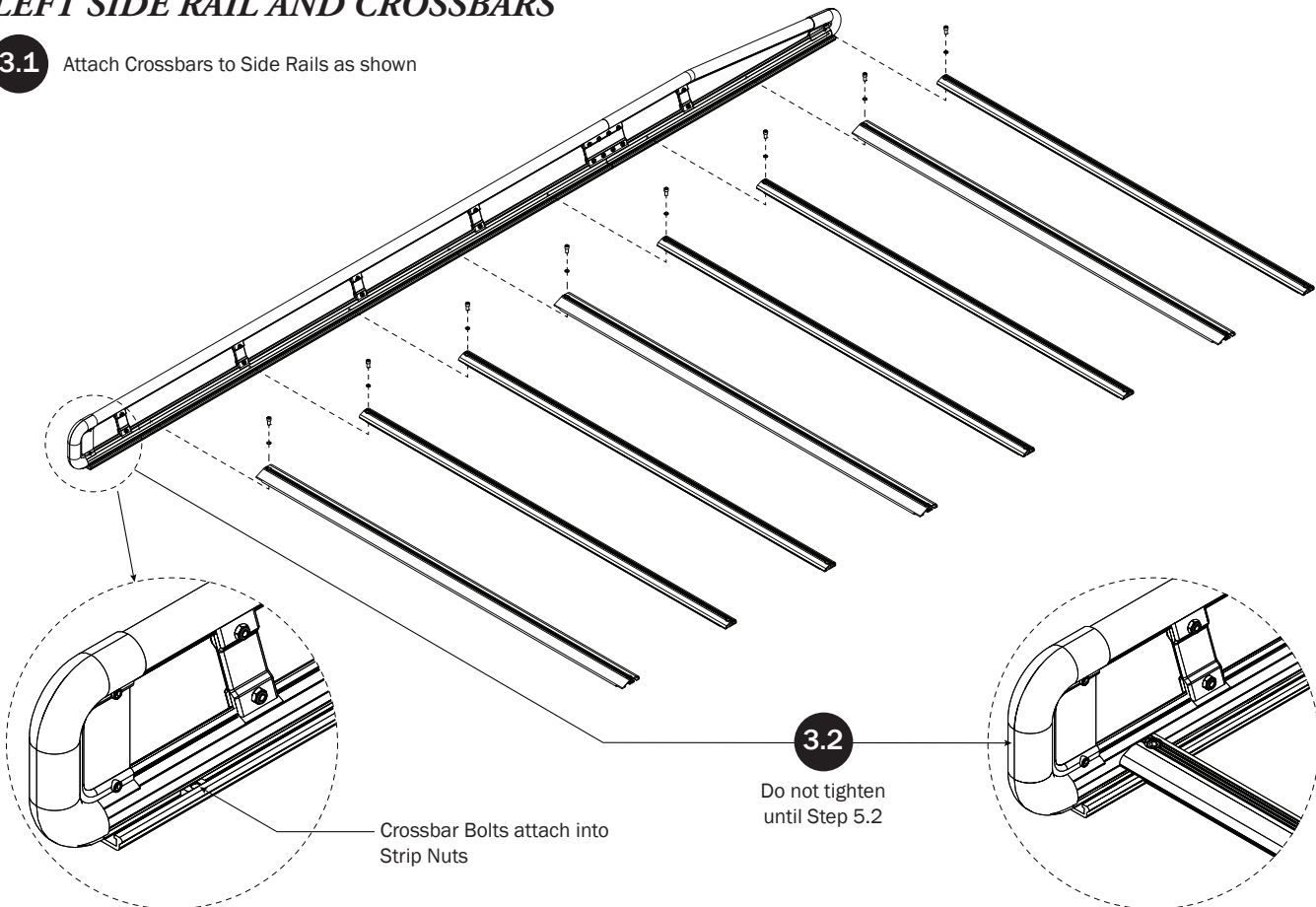

Crossbar Bolts attach into
Strip Nuts

3.2
Do not tighten
until Step 5.2

RIGHT SIDE RAIL AND CROSSBARS

4.1 Attach Crossbars to Side Rails as shown.

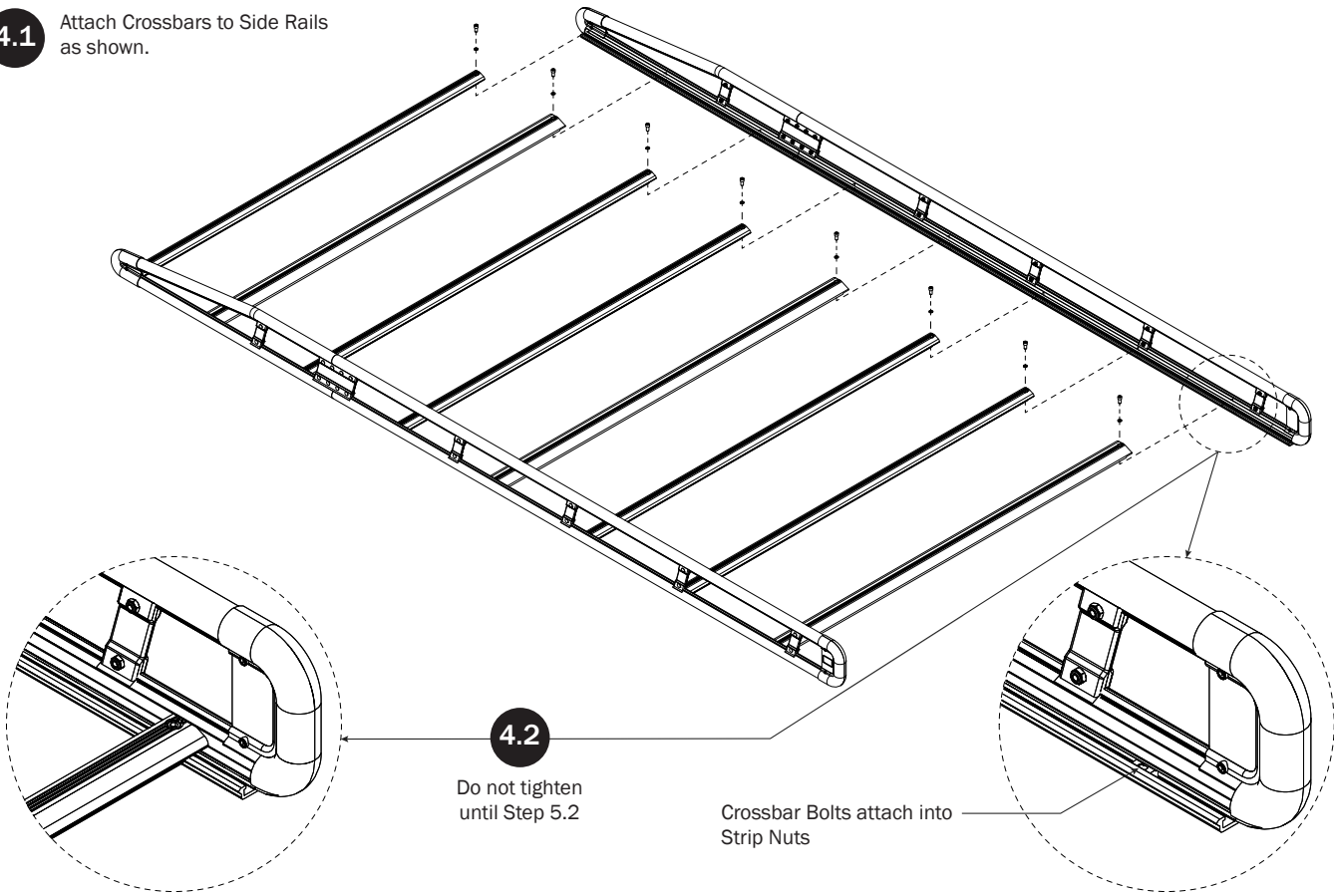

CROSSBAR ADJUSTMENT



ROLLER ASSEMBLY

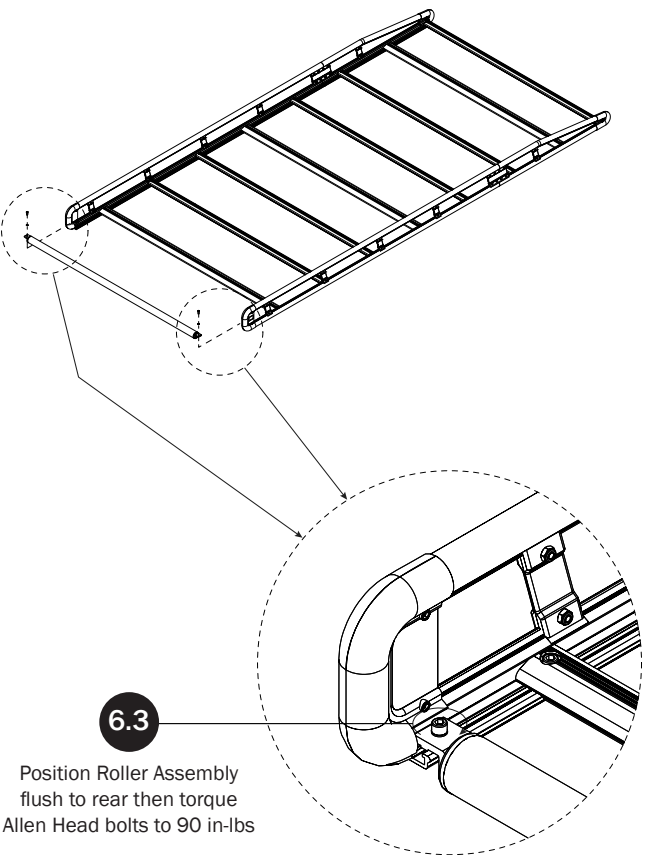
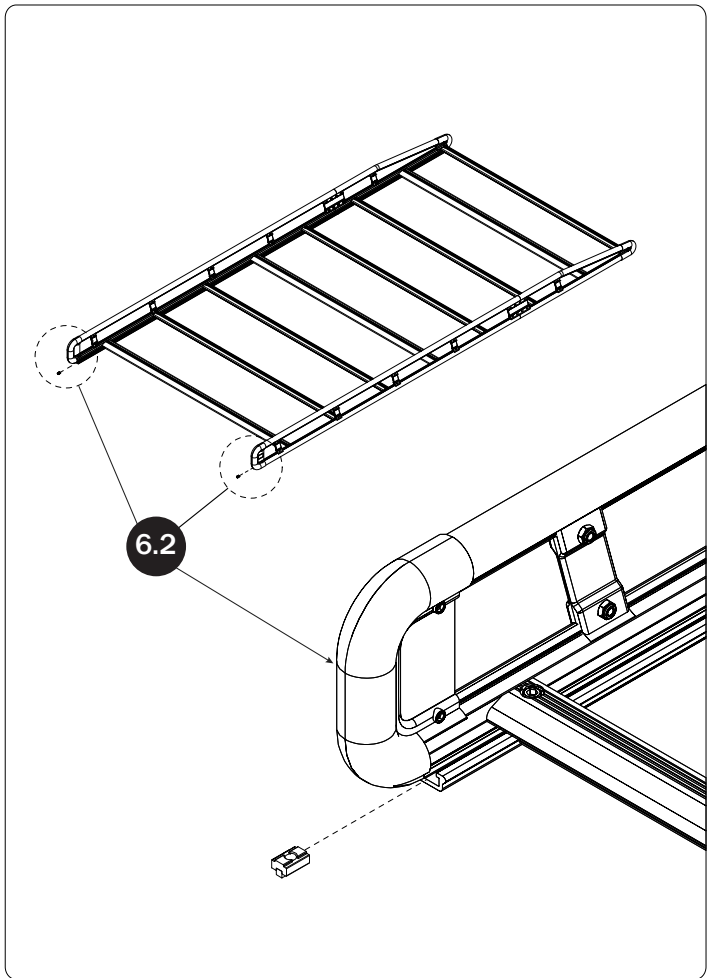
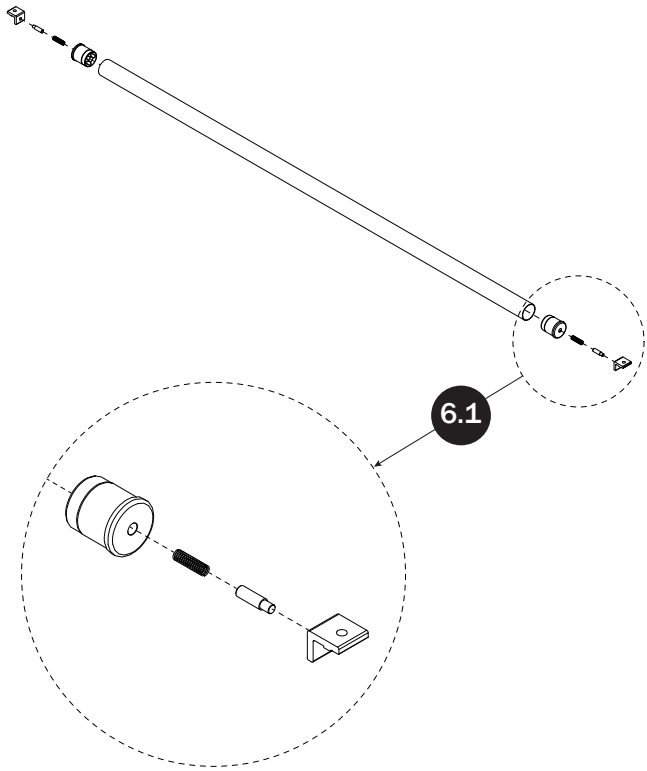

MOUNTING RACK TO CHANNELS

