

# **PRIME DESIGN™**

A Safe Fleet Brand

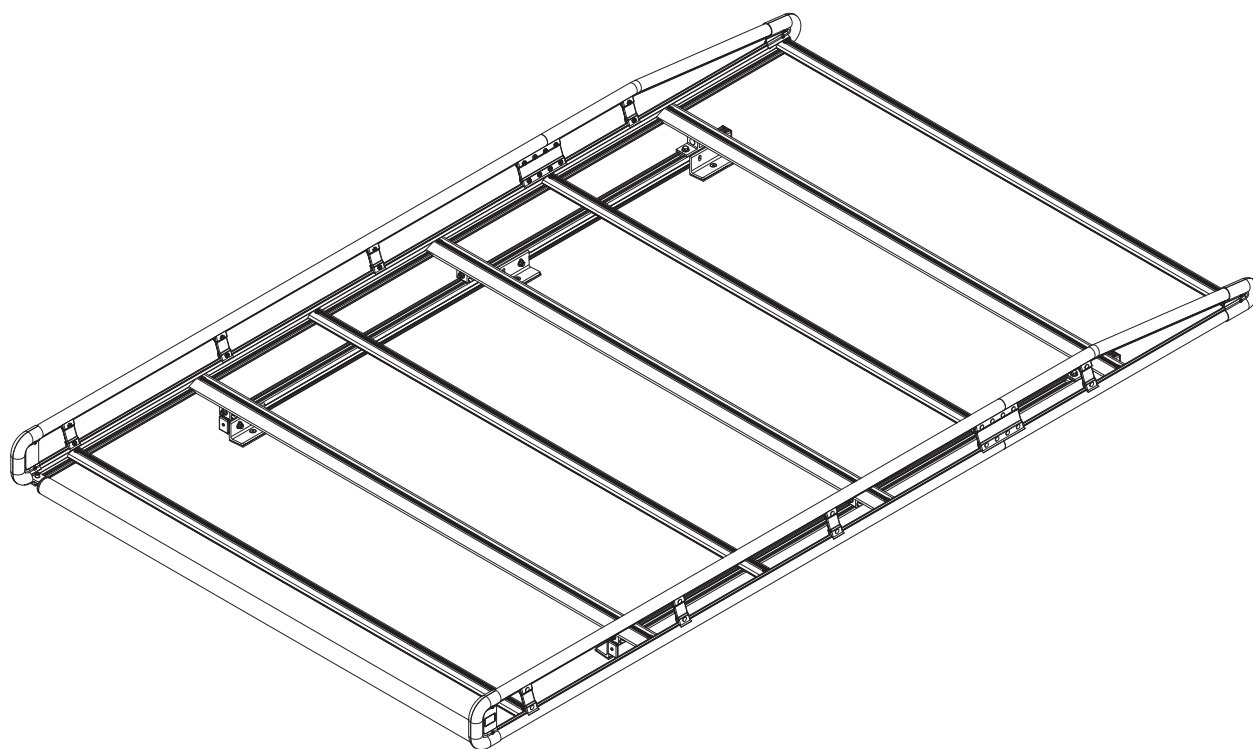

## **AR1910**

## CONTENTS OVERVIEW

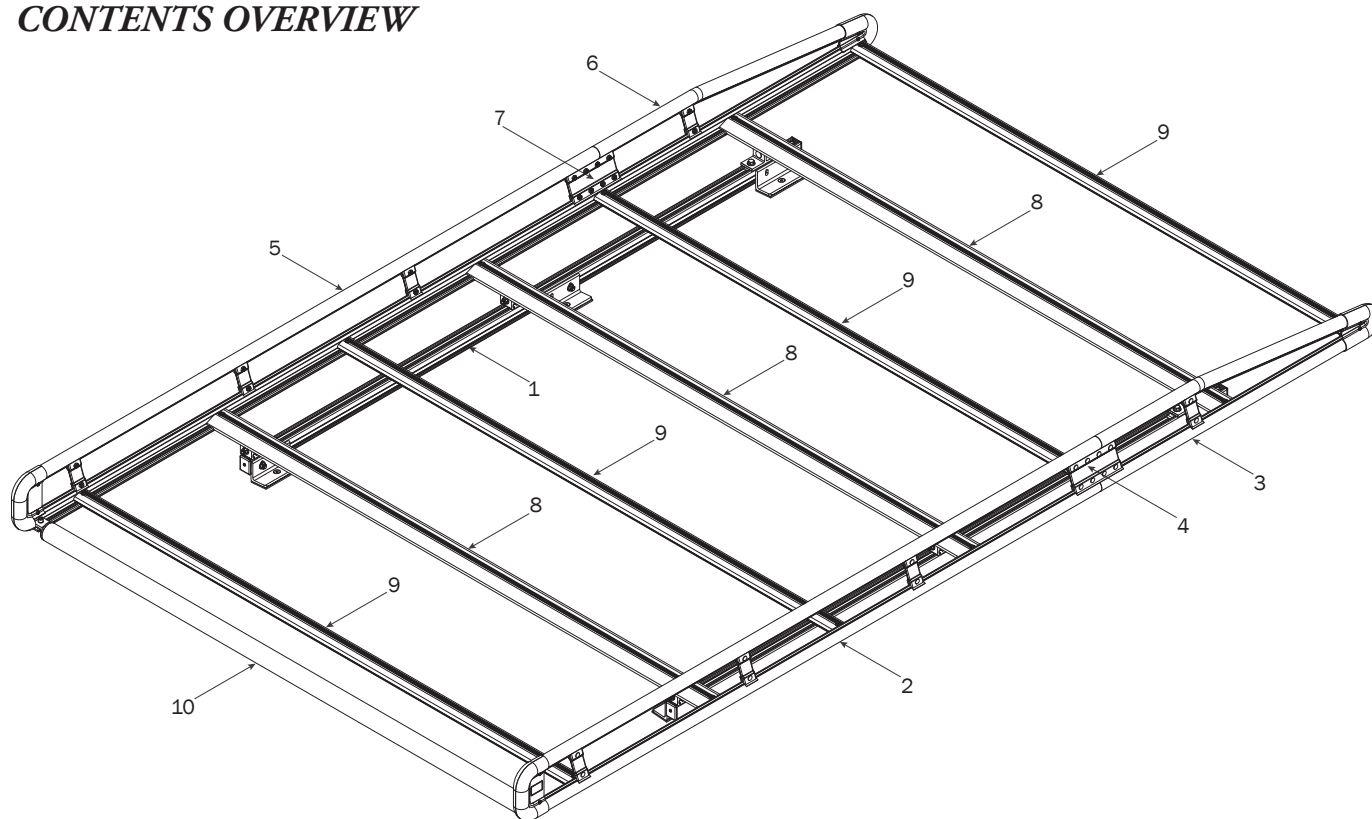

1—FBM3-0096-A..... (Qty 1)

Channels with hardware

74" Channels, Pre-assembled (2X)



Mounting Bracket (6X)



Foam Pad (6X)



Channel Bracket (4X)

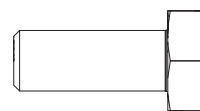

M8 x 20MM (4X)



M8 X 25MM (6X)

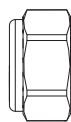

M8 Lock Nut (6X)

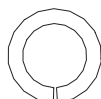

$\frac{5}{16}$ " Lock Washer (4X)

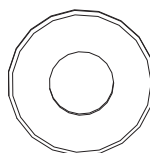

$\frac{5}{16}$ " Flat Washer (10X)



Anti-Seize (1X)

2—Side Rail Assembly ..... (Qty 1)

Rear, Right Hand, 76.00"

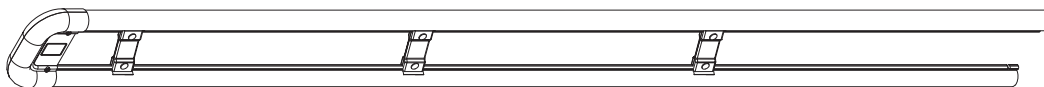

3—Side Rail Assembly ..... (Qty 1)

Front, Right Hand, 36.00"

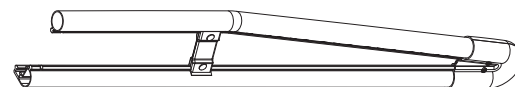

4—Side Rail Connector ..... (Qty 1)

Right Hand, 6.00"

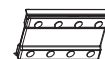

- 5—Side Rail Assembly ..... (Qty 1)  
Rear, Left Hand, 76.00"

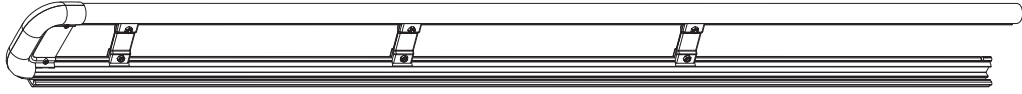

- 6—Side Rail Assembly ..... (Qty 1)  
Front, Left Hand, 36.00"

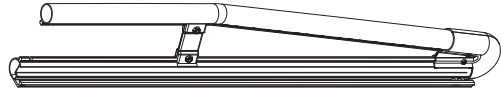

- 7—Side Rail Connector ..... (Qty 1)  
Left Hand, 6.00"

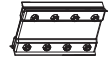

- 8—AluRack Construction Crossbar ..... (Qty 3)  
With hardware, 67.00"



- 9—AluRack Standard Crossbar ..... (Qty 4)  
With hardware, 67.00"



- 10—Roller Tube Assembly ..... (Qty 1)  
With caps, 63.75"



#### HKT-0082-Hardware Kit

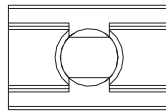

M8 Strip Nut (16X)

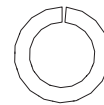

M8 Lock Washer (16X)

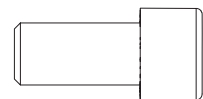

M8 Cap Head Bolt (16X)



Roller Holder (2X)



Roller Tube Pin (2X)

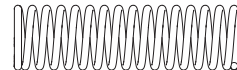

Roller Spring (2X)



**FBM3-0096-A MOUNTING ASSEMBLY**

- 0.1** Apply Anti-Seize to all M8 x 25MM Flat Head Screws and install the Channel Mounting Brackets with Foam Pads onto the vehicle's roof mounting holes. Do not tighten screws until Step 0.5

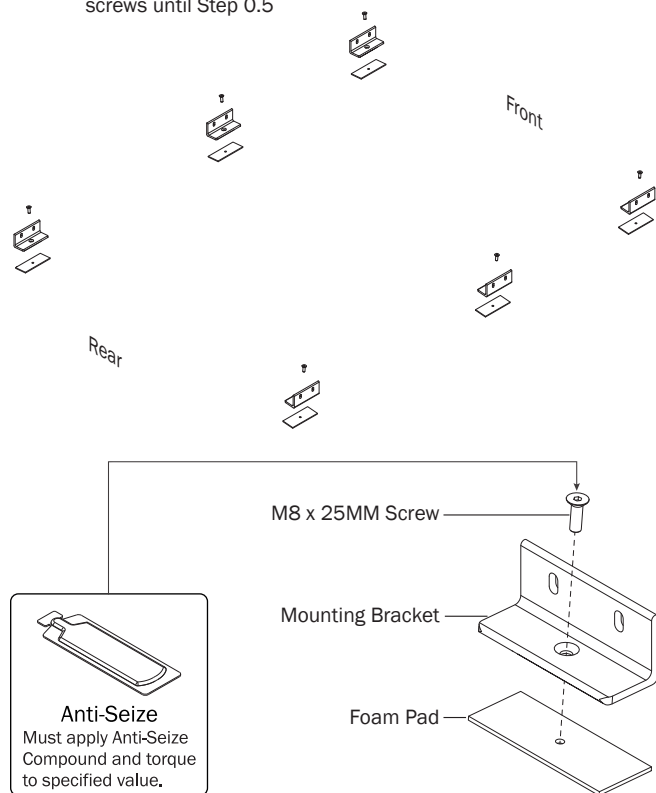

- 0.2** Apply Anti-Seize to all M8 T Bolt studs, then attach the Channels to the Mounting Brackets using the indicated hardware. Do not tighten until Step 0.4

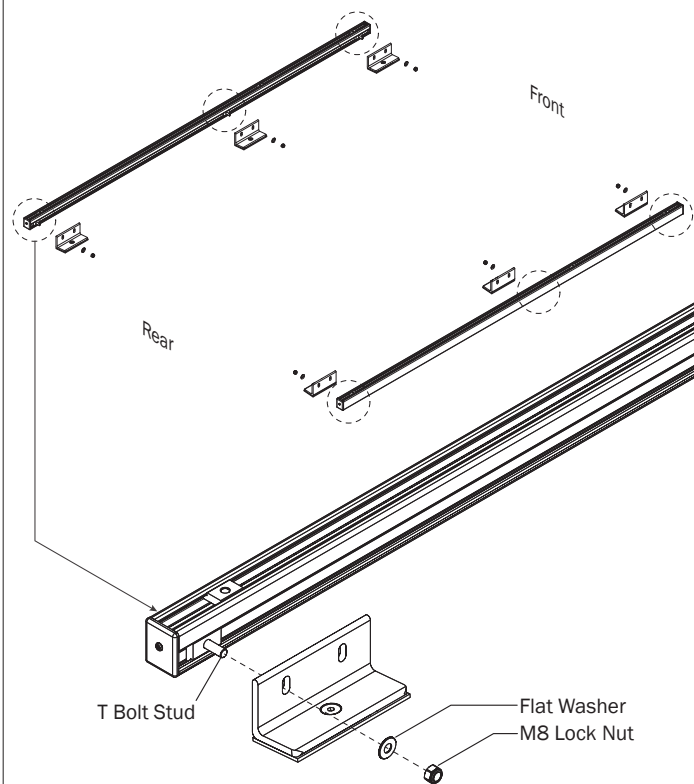

- 0.3** Remove End Caps, then slide aluminum Strip Nuts provided with your Mid Crossbar Kit into each rear of the Channels, then reattach the Channel Caps

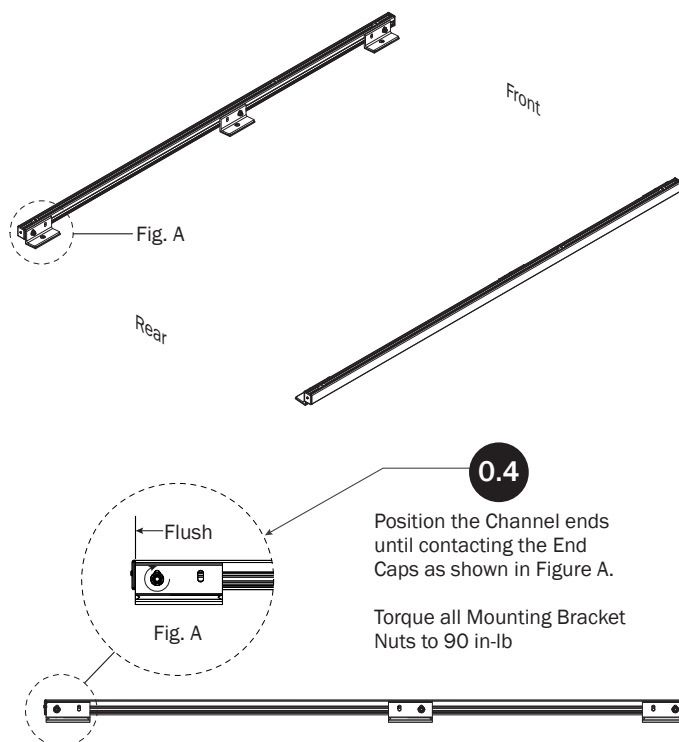
**0.4**

Position the Channel ends until contacting the End Caps as shown in Figure A.

Torque all Mounting Bracket Nuts to 90 in-lb

- 0.5** Torque all M8 x 25MM Flat Head Screws to 150 in-lbs. Apply Silicone Sealant to screw heads to seal against water intrusion

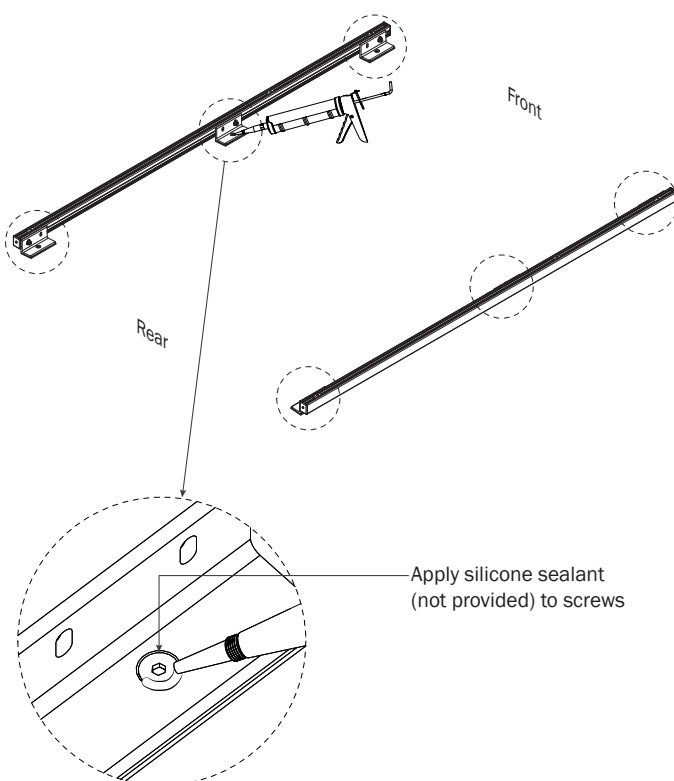

**0.6** Attach Mounting Brackets to the Aluminum Strip Nuts located in the Channels

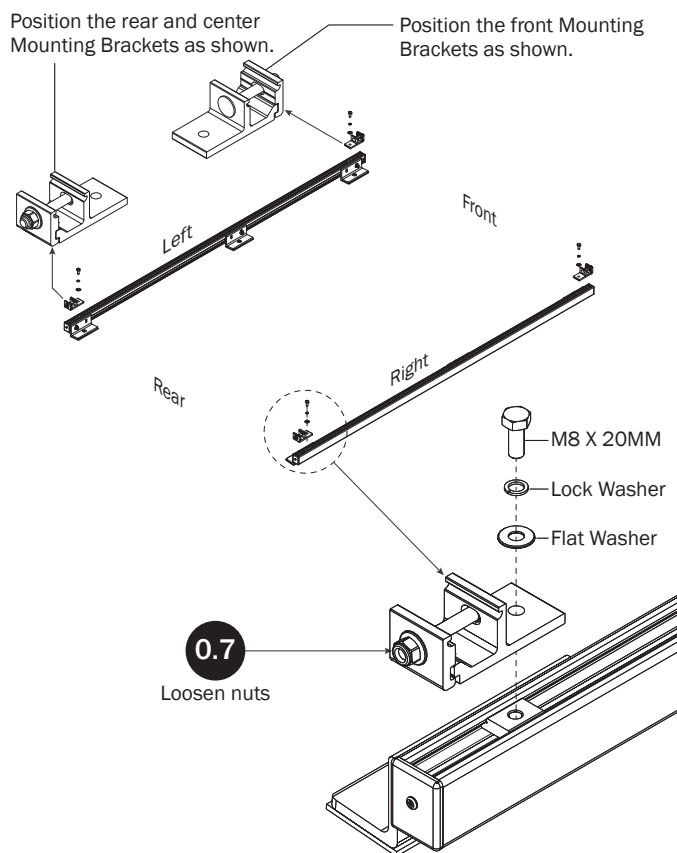

**0.8** Set to distances shown below. Do not torque the Crossbar Mounting Brackets until Step 7.5. Finger-tighten them into designated dimension to hold them in place, then proceed to Rack Assembly

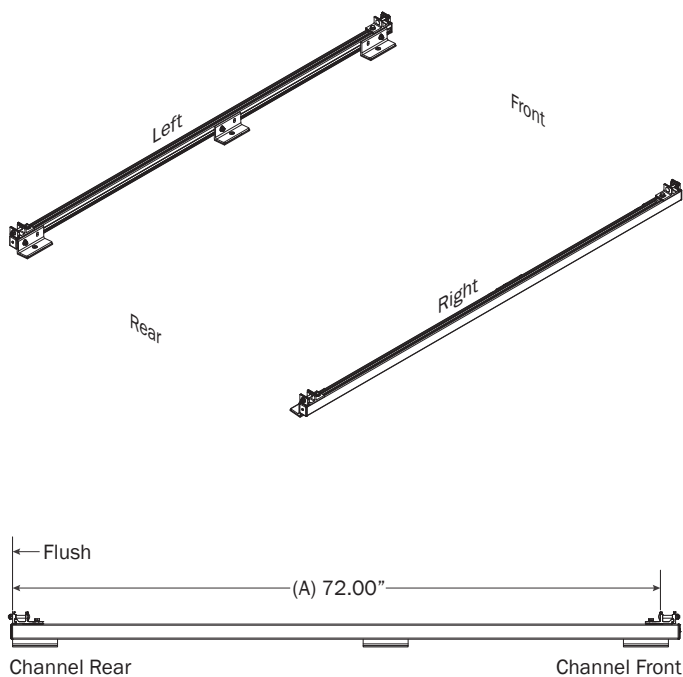

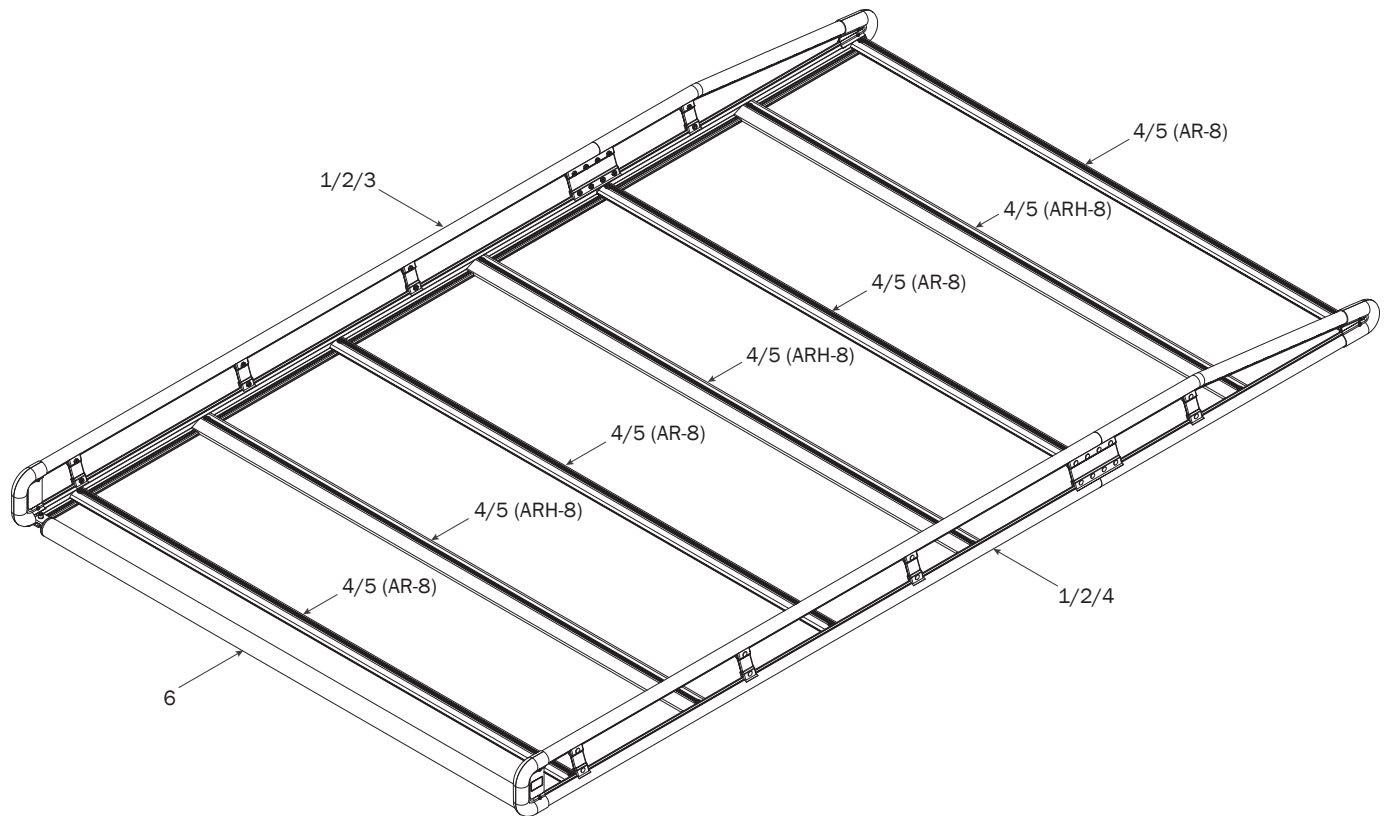
**ALURACK ASSEMBLY SEQUENCE****STRIP NUT ASSEMBLY**

- 1** Insert Strip Nuts (7x) per side into Side Rails as shown

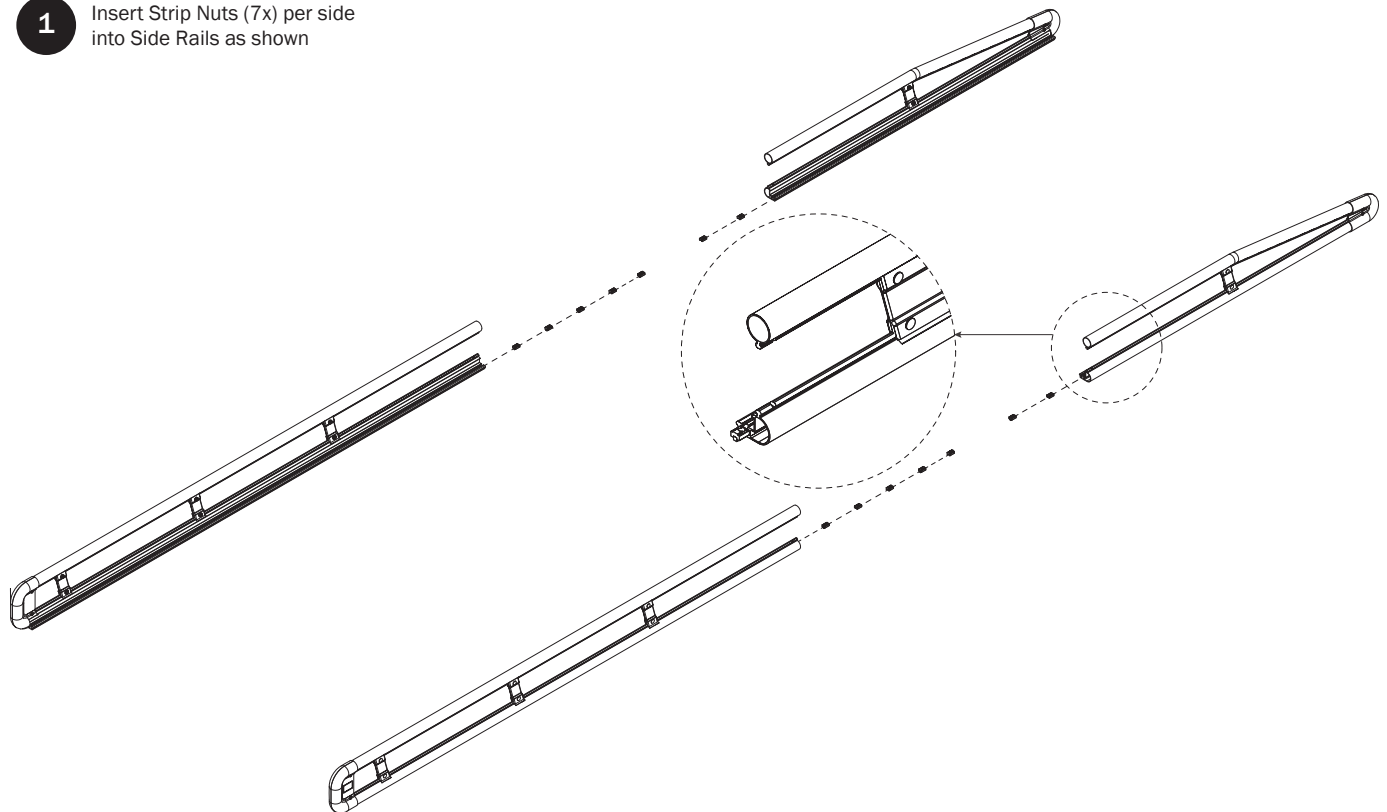

## SIDE RAIL ASSEMBLY

**2.1** Assemble Side rails as shown

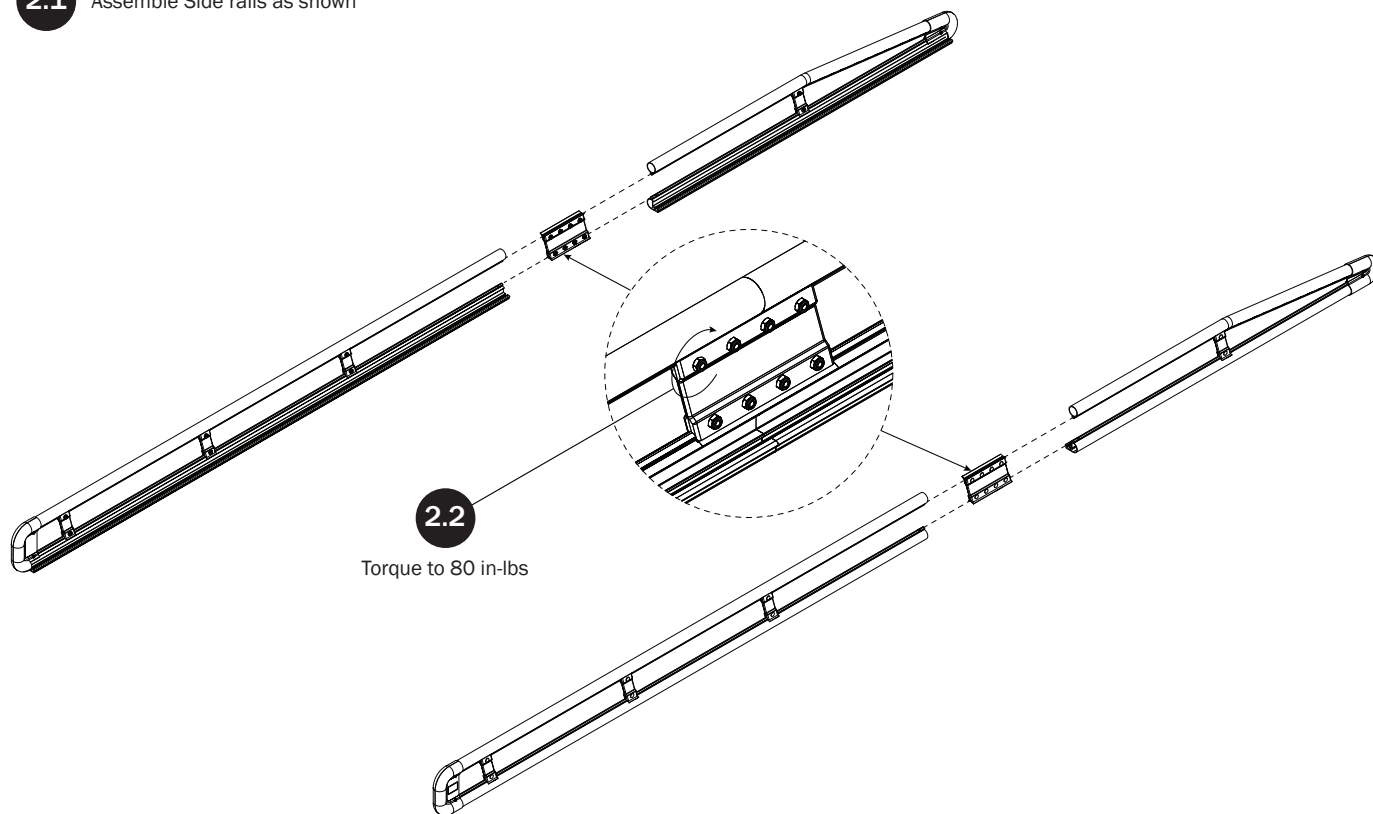

## LEFT SIDE RAIL AND CROSSBARS

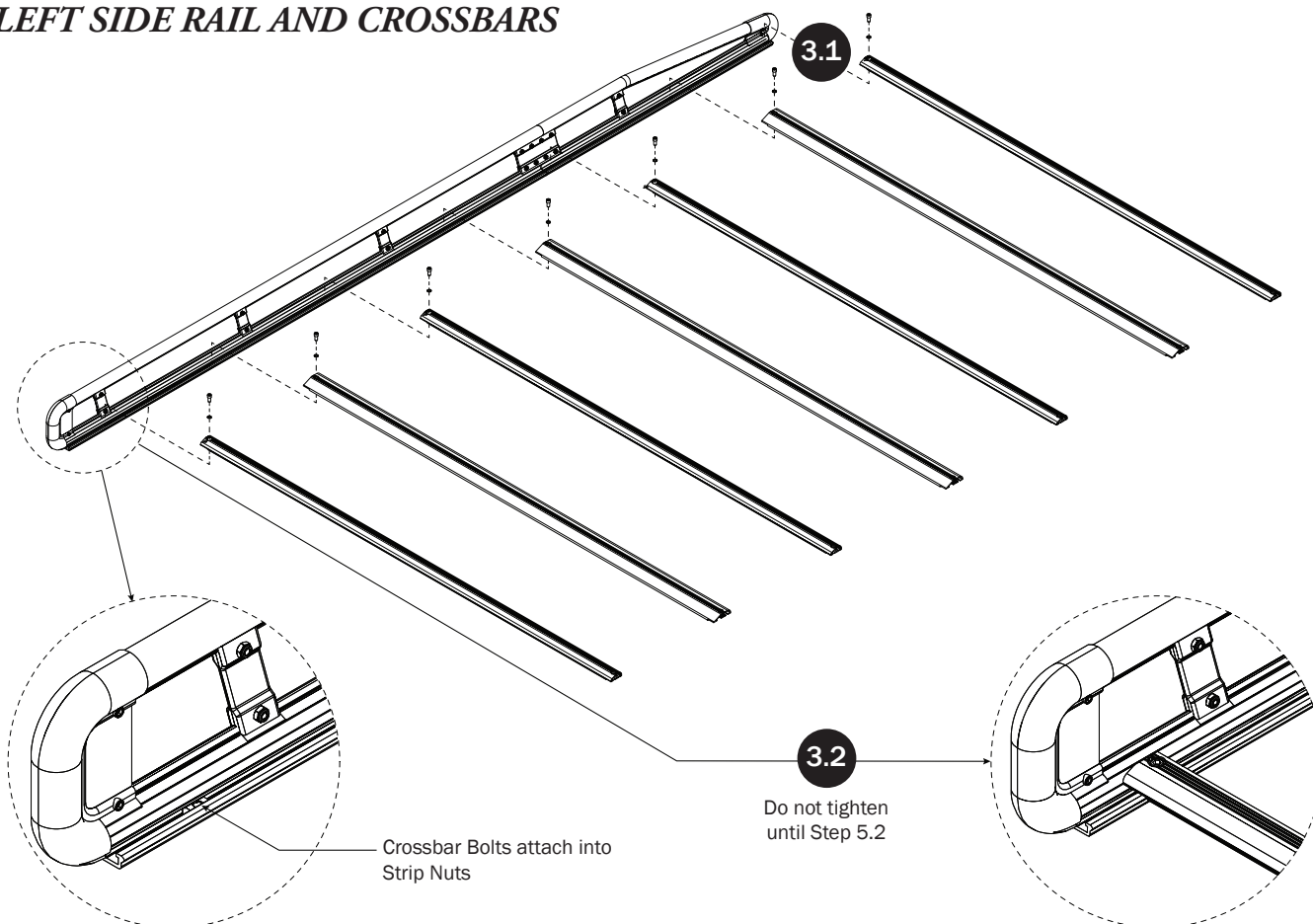

Crossbar Bolts attach into Strip Nuts

Do not tighten until Step 5.2

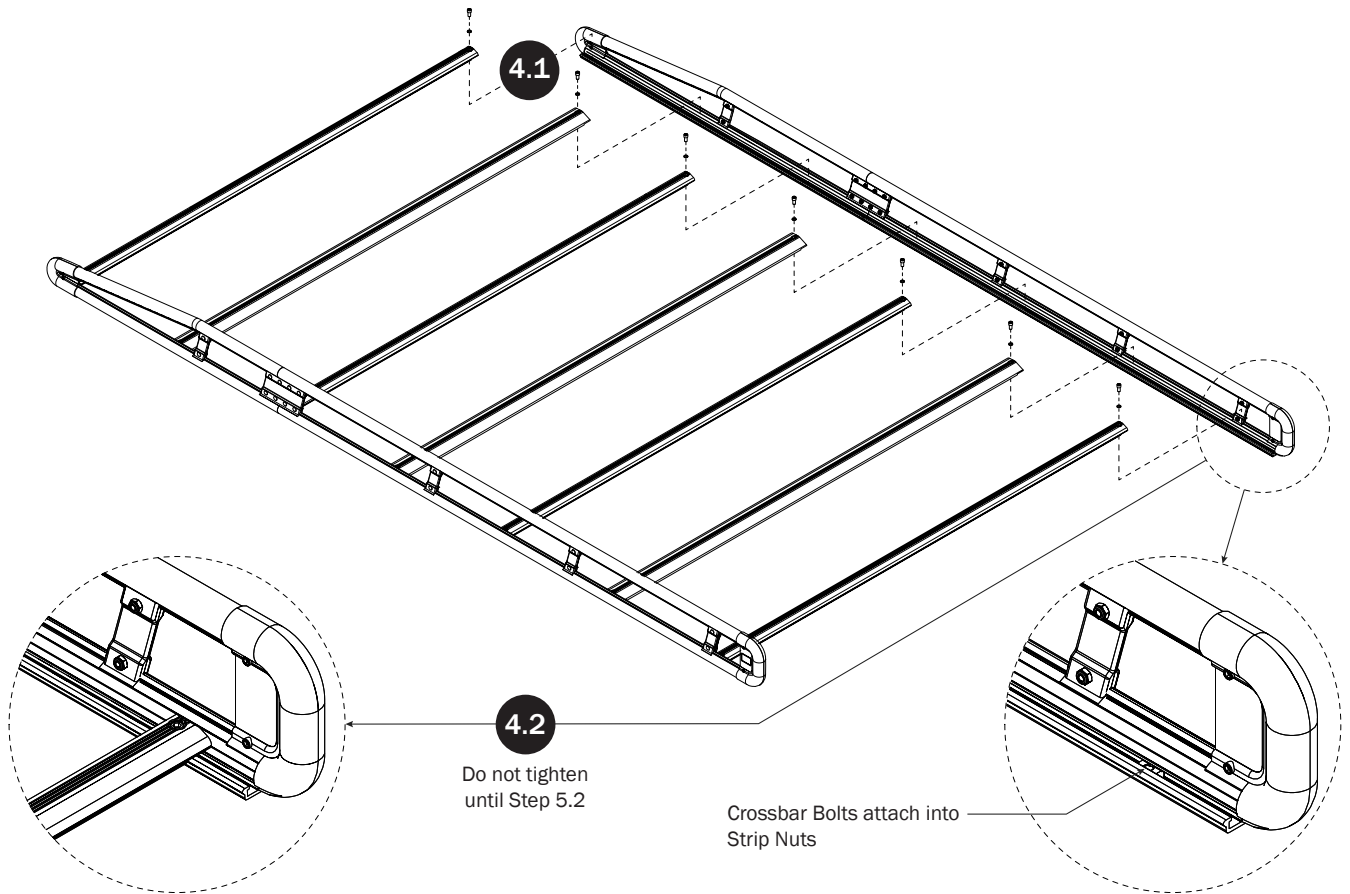
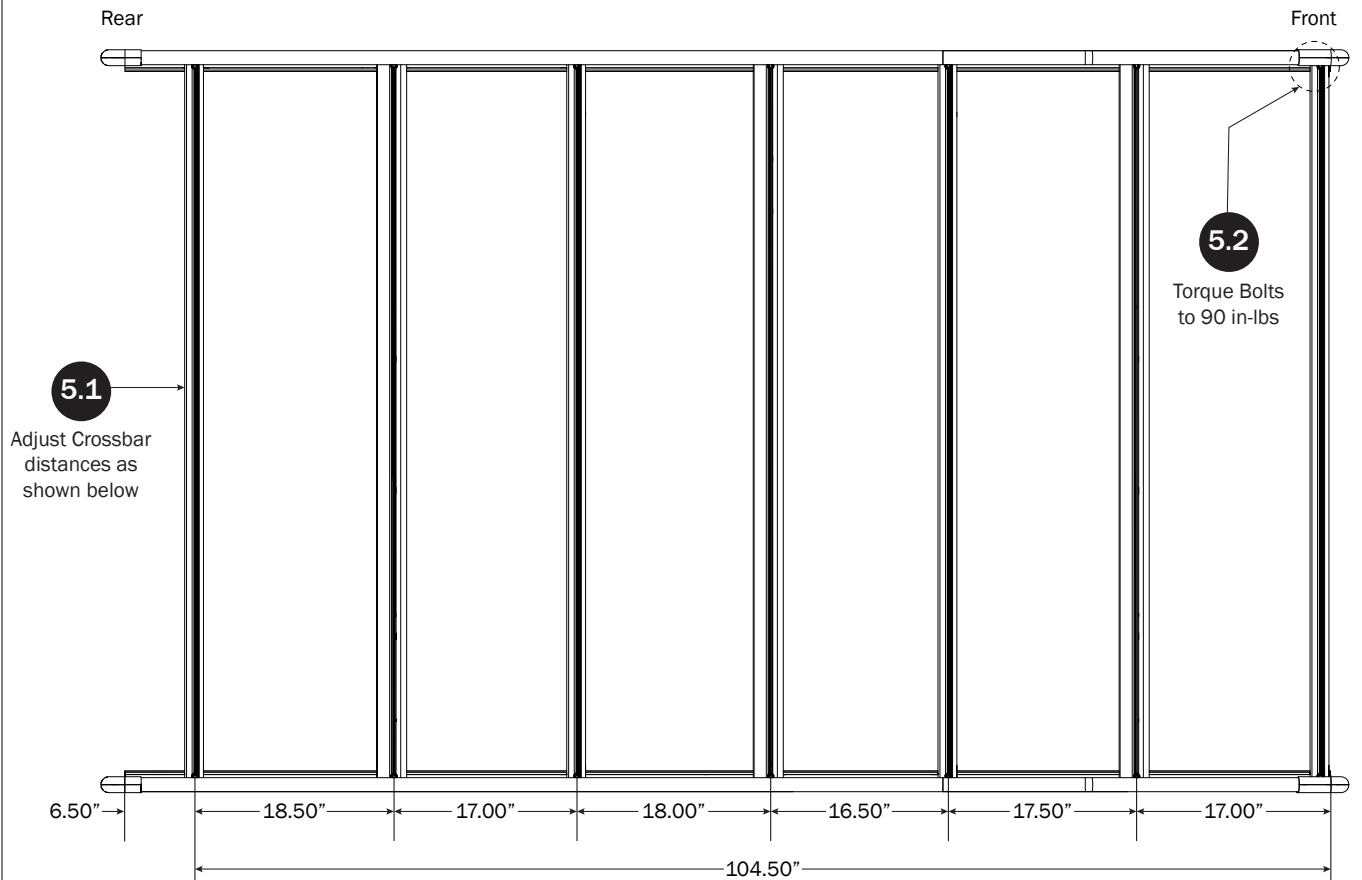
**RIGHT SIDE RAIL AND CROSSBARS****CROSSBAR ADJUSTMENT**



## ROLLER ASSEMBLY

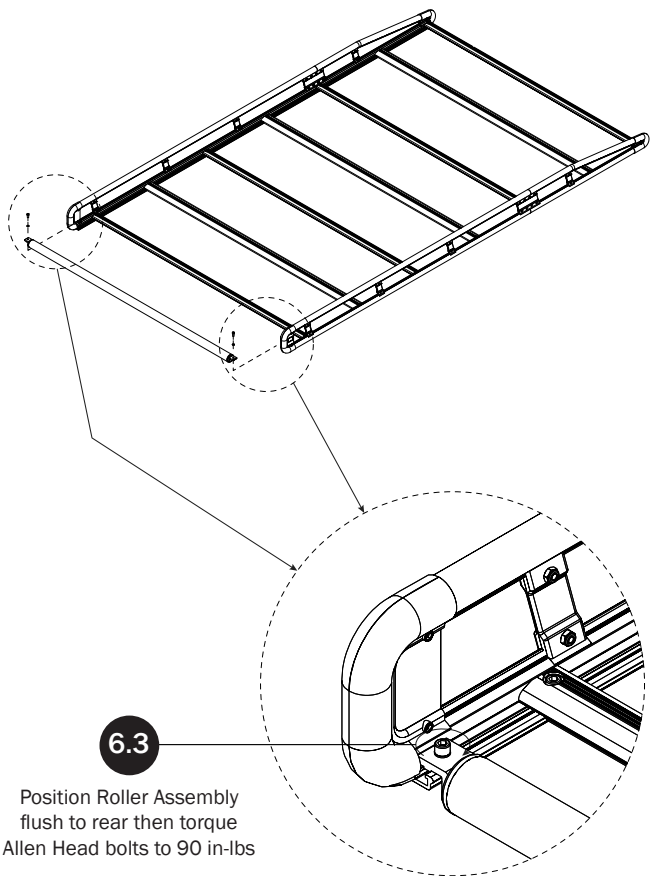
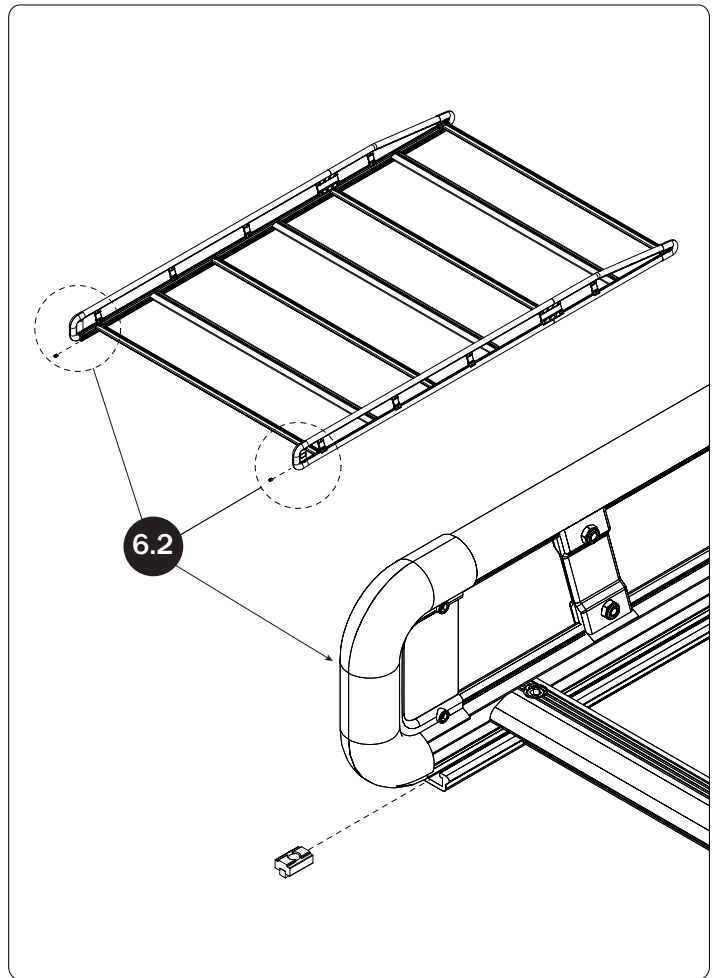
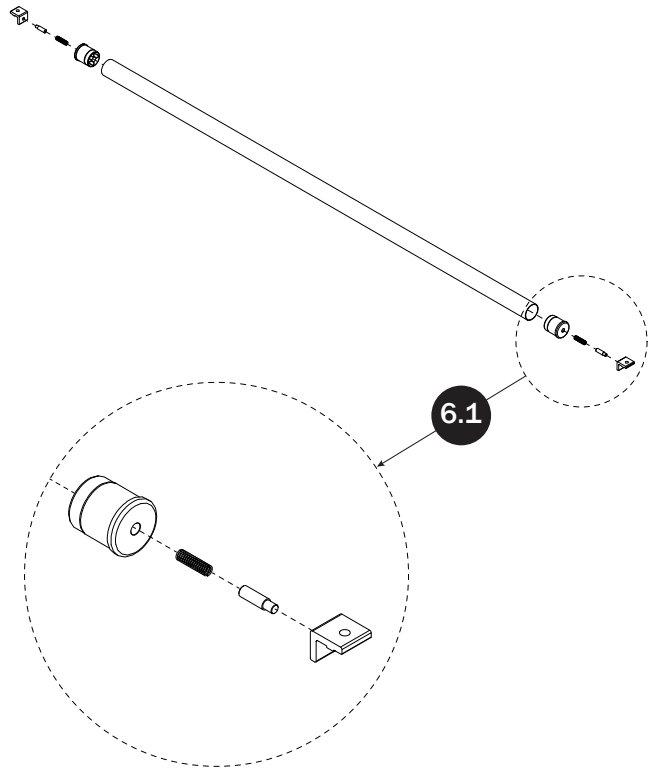

Position Roller Assembly  
flush to rear then torque  
Allen Head bolts to 90 in-lbs

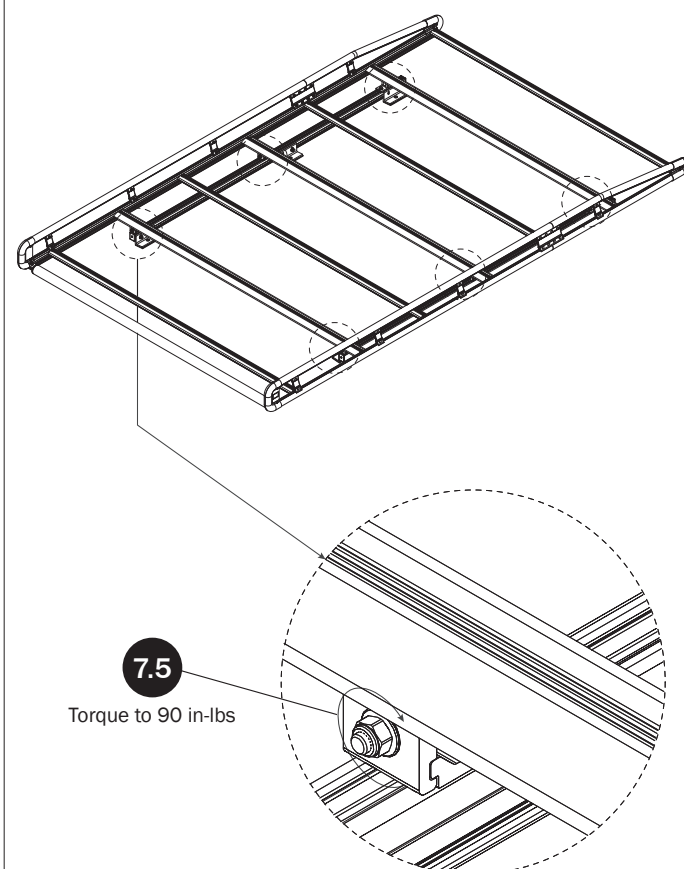
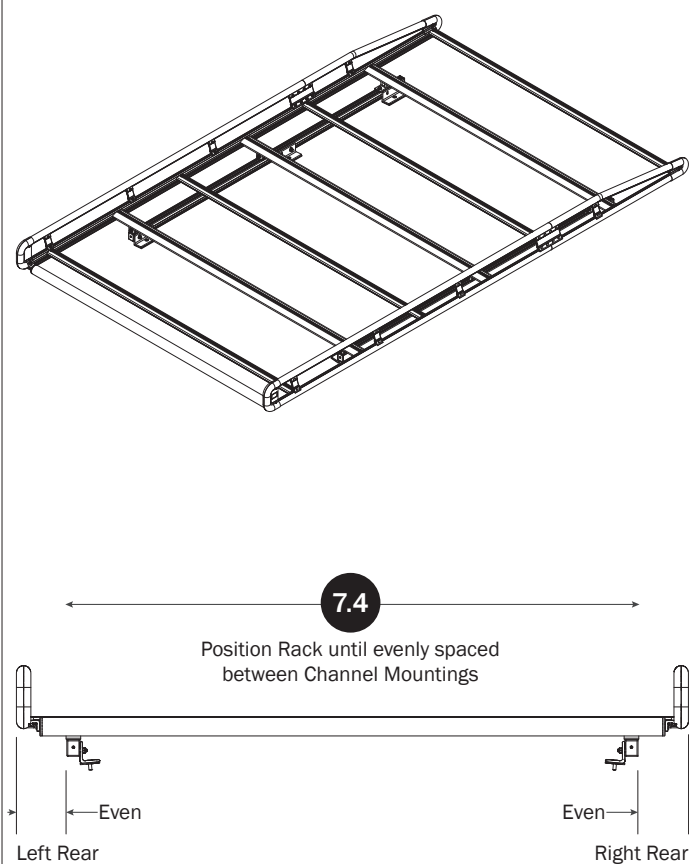
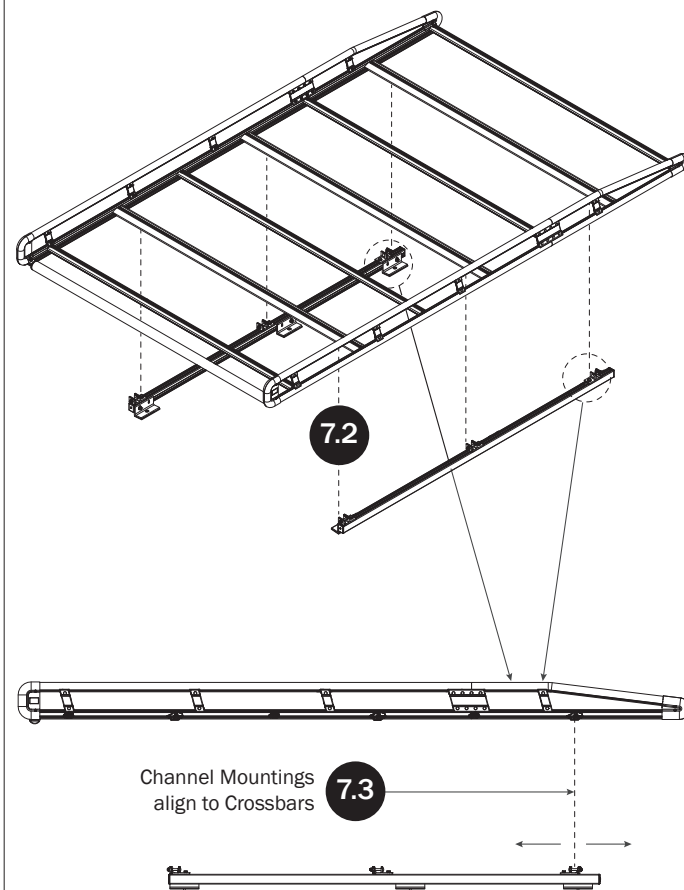
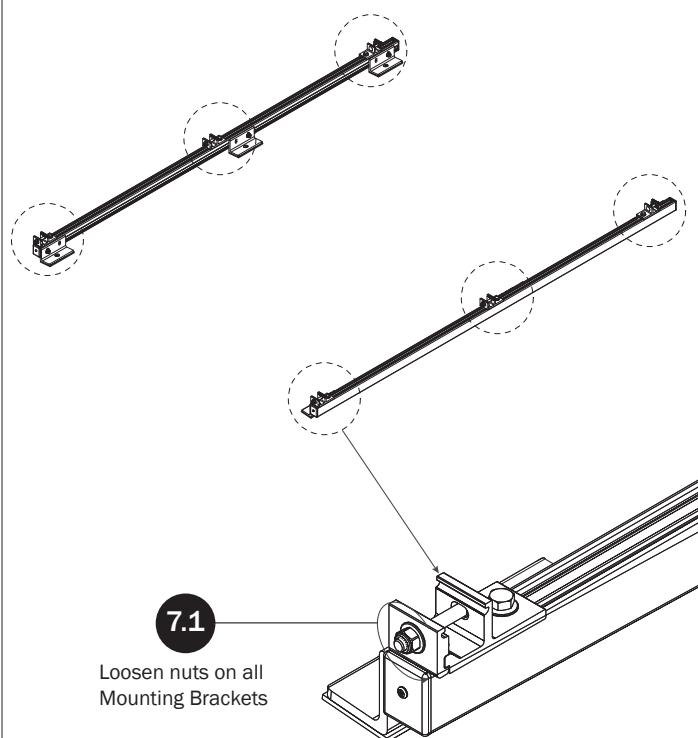
*MOUNTING RACK TO CHANNELS*

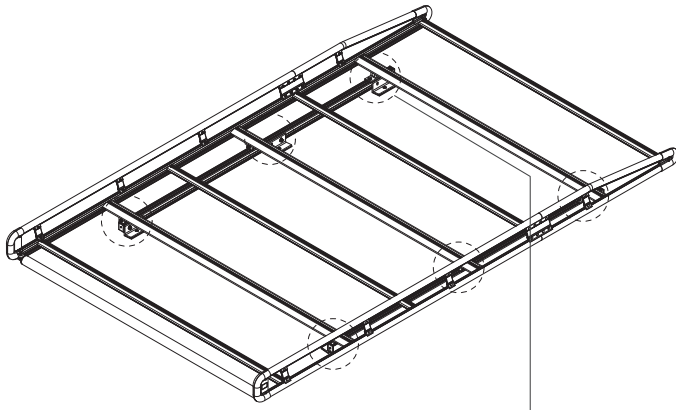

7.6

Torque to 90 in-lbs

