

PRIME DESIGN™

A Safe Fleet Brand

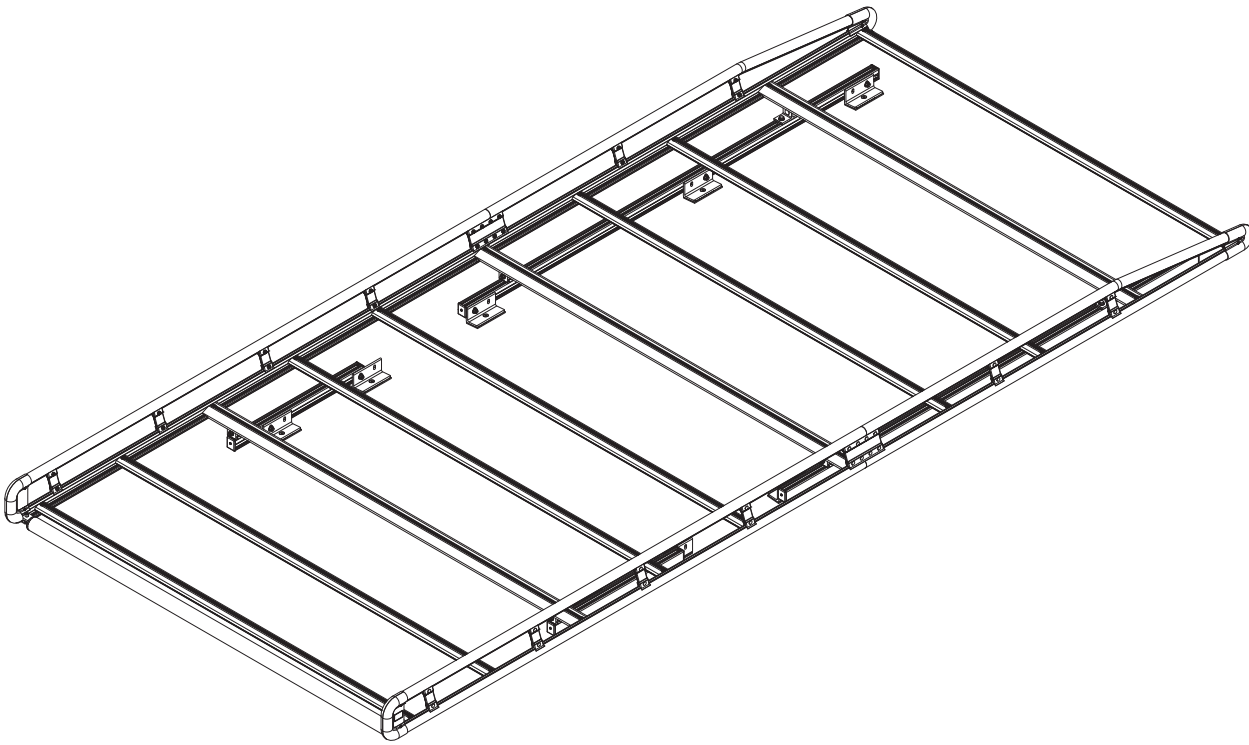

AR1913

CONTENTS OVERVIEW

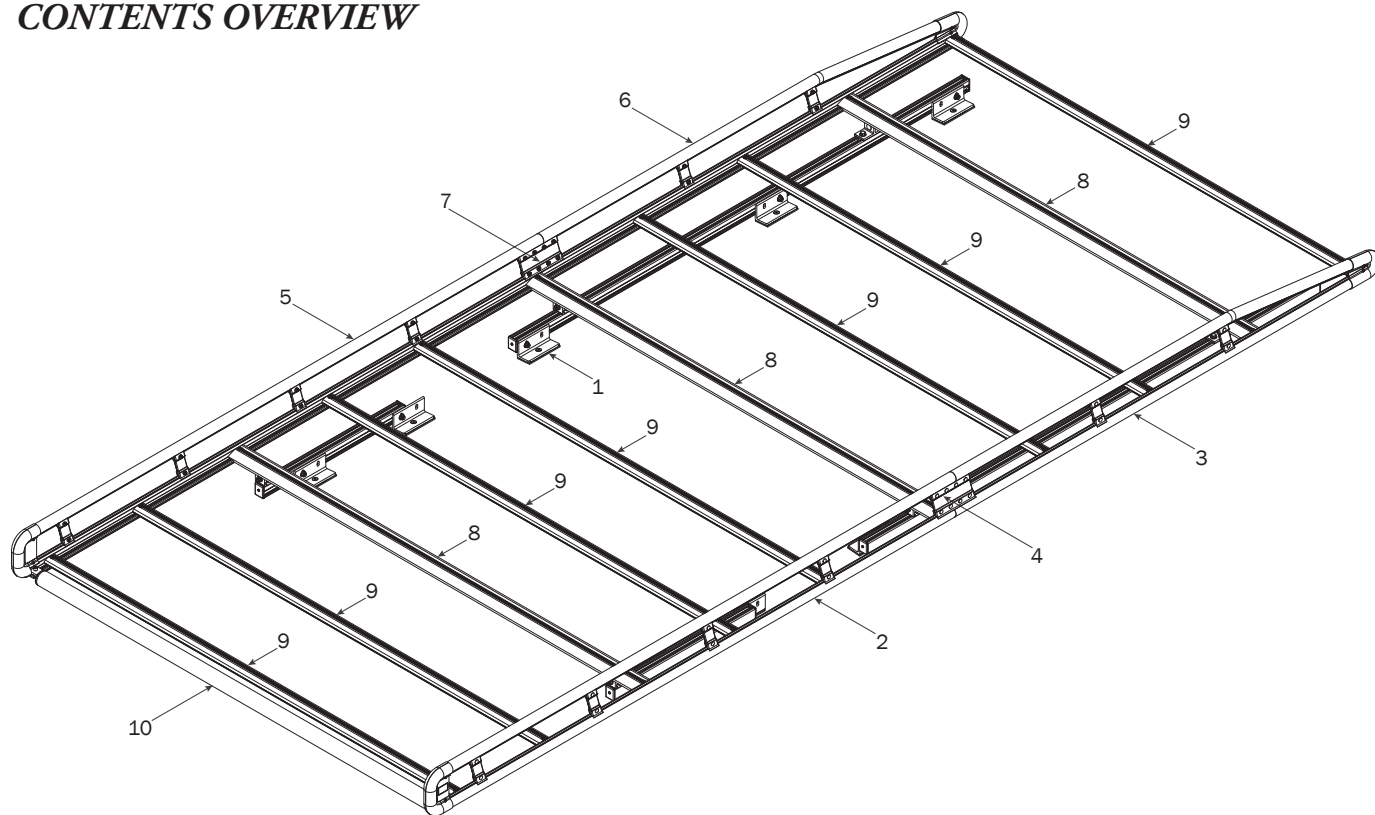

- 1—FBM3-0094-A..... (Qty 1)
Channels, 116" with Hardware



23" Channels (2X)



74" Channels, Pre-assembled (2X)

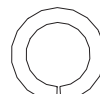
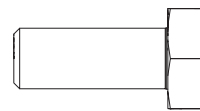

Channel Bracket (6X)

 $\frac{5}{16}$ " Lock Washer (6X)

M8 x 20MM (6X)

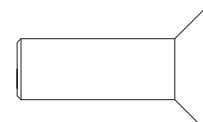

M8 X 25MM (10X)

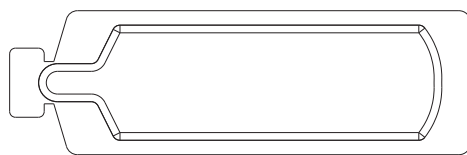

Anti-Seize (1X)

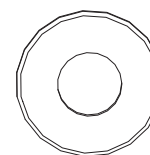

M8 Lock Nut (10X)

 $\frac{5}{16}$ " Flat Washer (16X)

Mounting Bracket (10X)



Foam Pad (10X)

- 2—Side Rail Assembly (Qty 1)
Rear, Right Hand, 84.00"

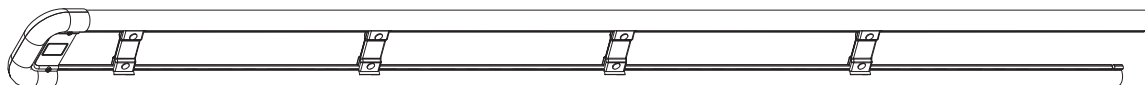

- 3—Side Rail Assembly (Qty 1)
Front, Right Hand, 68.00"

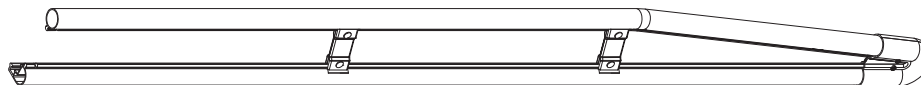

- 4—Side Rail Connector (Qty 1)
Right Hand, 6.00"

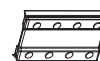

- 5—Side Rail Assembly (Qty 1)
Rear, Left Hand, 84.00"

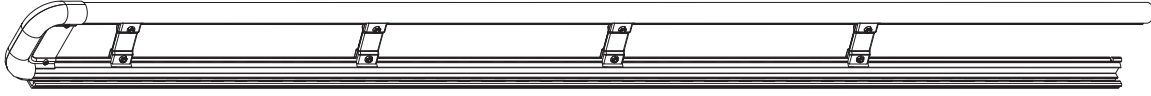

- 6—Side Rail Assembly (Qty 1)
Front, Left Hand, 68.00"



- 7—Side Rail Connector (Qty 1)
Left Hand, 6.00"

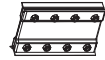

- 8—AluRack Construction (Qty 3)
Crossbar With hardware, 67.00"



- 9—AluRack Standard Crossbar (Qty 7)
With hardware, 67.00"



- 10—Roller Assembly (Qty 1)
With caps, 63.75"



HKT-0085-Hardware Kit

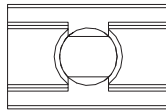

M8 Strip Nut (22X)

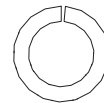

M8 Lock Washer (22X)

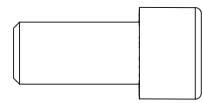

M8 Cap Head Bolt (22X)



Roller Holder (2X)



Roller Tube Pin (2X)

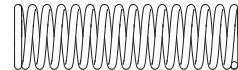

Roller Spring (2X)

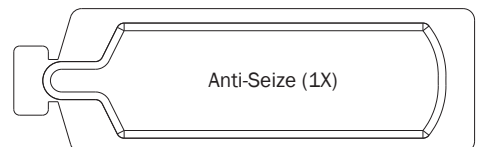

Anti-Seize (1X)

MOUNTING BRACKETS

- 0.1** Apply Anti-Seize to all M8 x 25MM Flat Head Screws and install the Channel Mounting Brackets with Foam Pads onto the vehicle's roof mounting holes. Do not tighten screws until Step 0.5

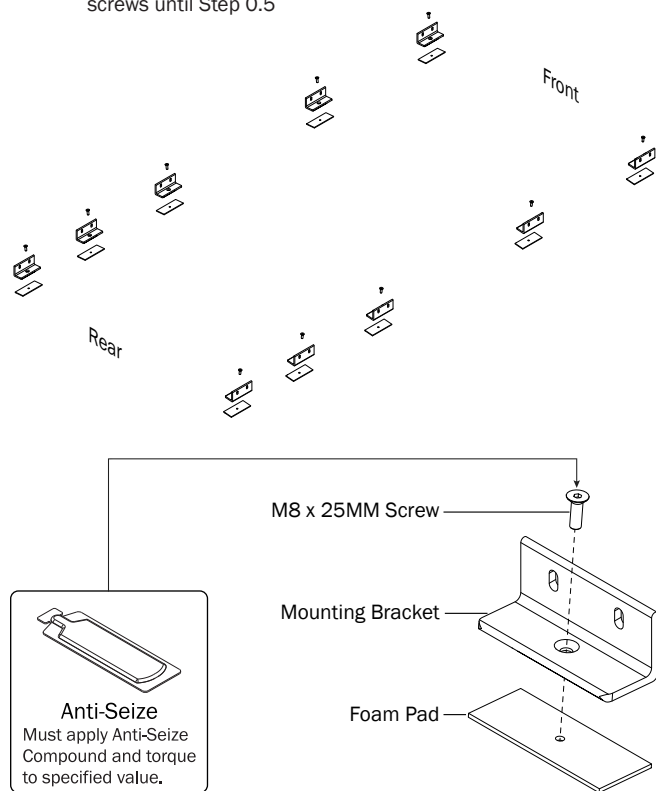

- 0.2** Apply Anti-Seize to all M8 T Bolt studs, then attach the Channels to the Mounting Brackets using the indicated hardware. Do not tighten until Step 0.3

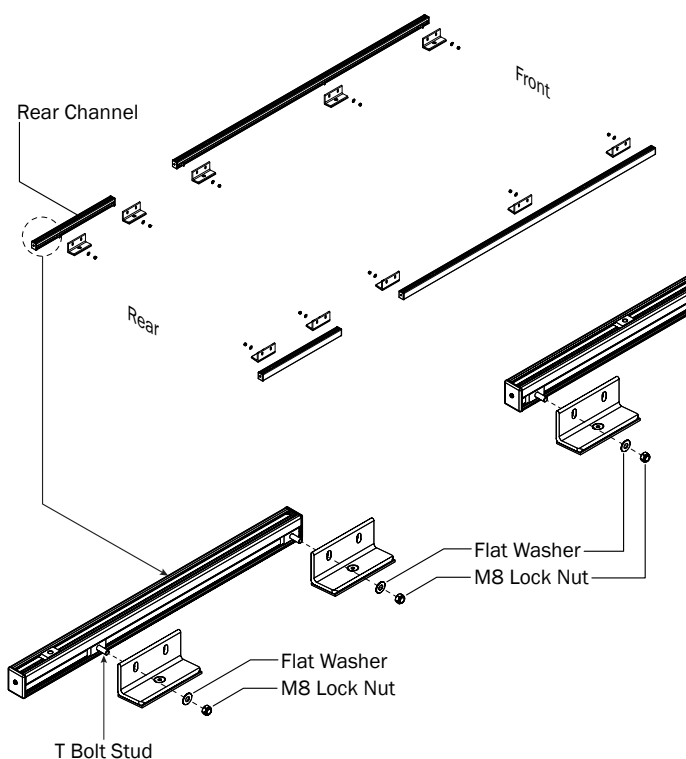

- 0.4** Torque all M8 x 25MM Flat Head Screws to 150 in-lbs. Apply Silicone Sealant to screw heads to seal against water intrusion

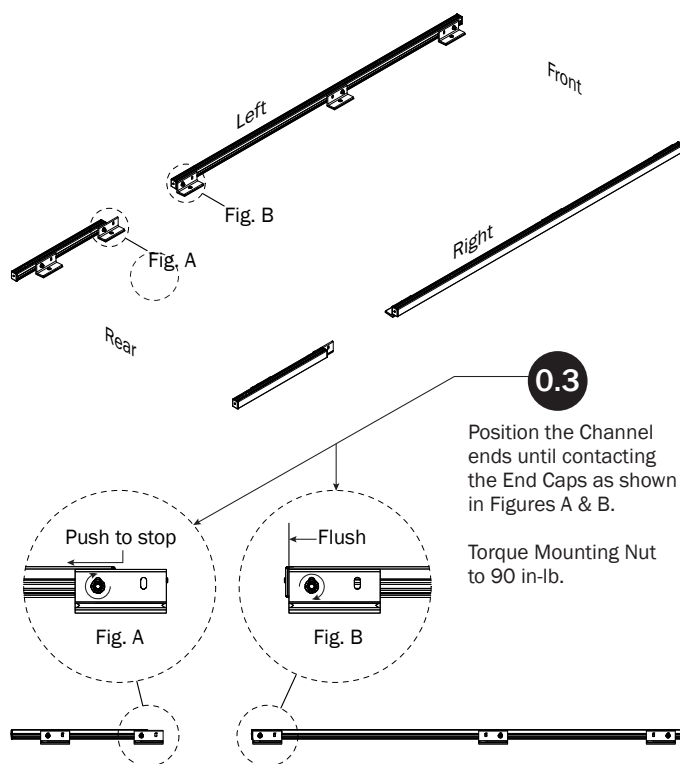
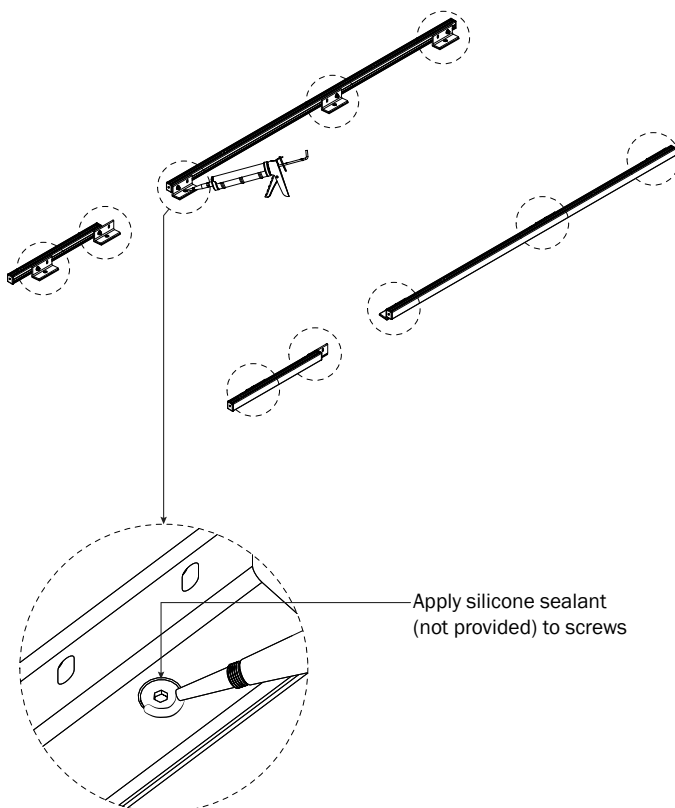

0.5 Attach Mounting Brackets to the Aluminum Strip Nuts located in the Channels

Position the rear and center Mounting Brackets as shown.

Position the front Mounting Brackets as shown.

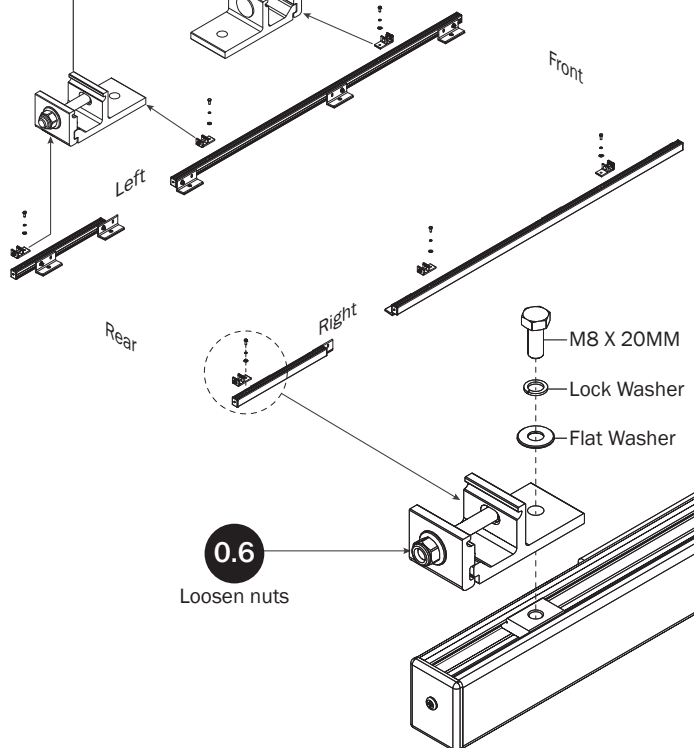

0.7

Set to distances shown below. Do not torque the Crossbar Mounting Brackets until Step 7.5. Finger-tighten them into designated dimension to hold them in place, then proceed to Rack Assembly

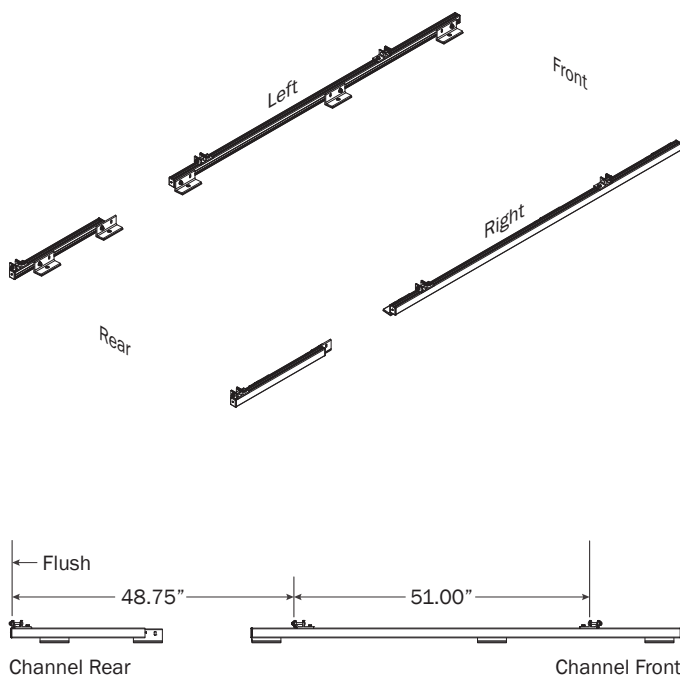

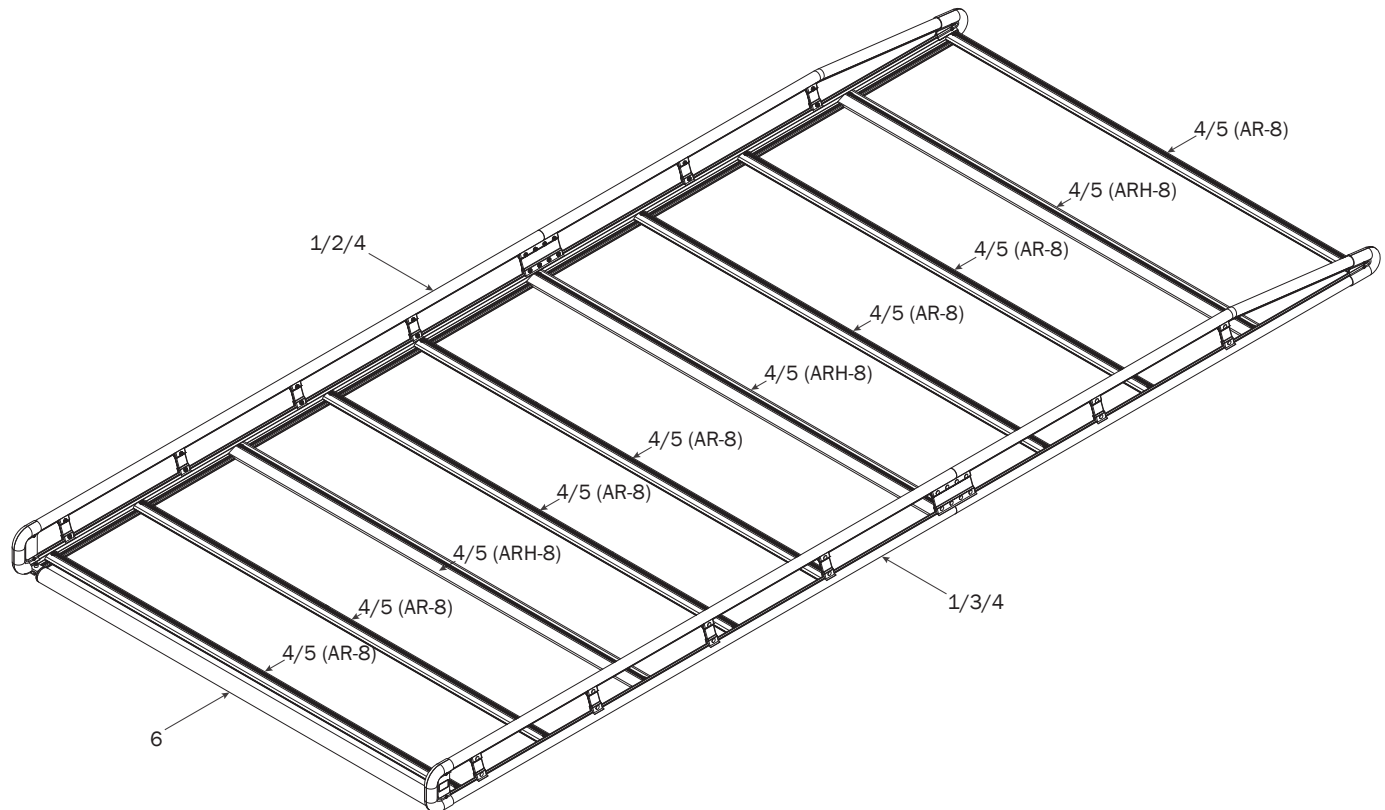
ALURACK ASSEMBLY SEQUENCE**STRIP NUT ASSEMBLY**

- 1** Insert Strip Nuts (10x) per side into Side Rails as shown

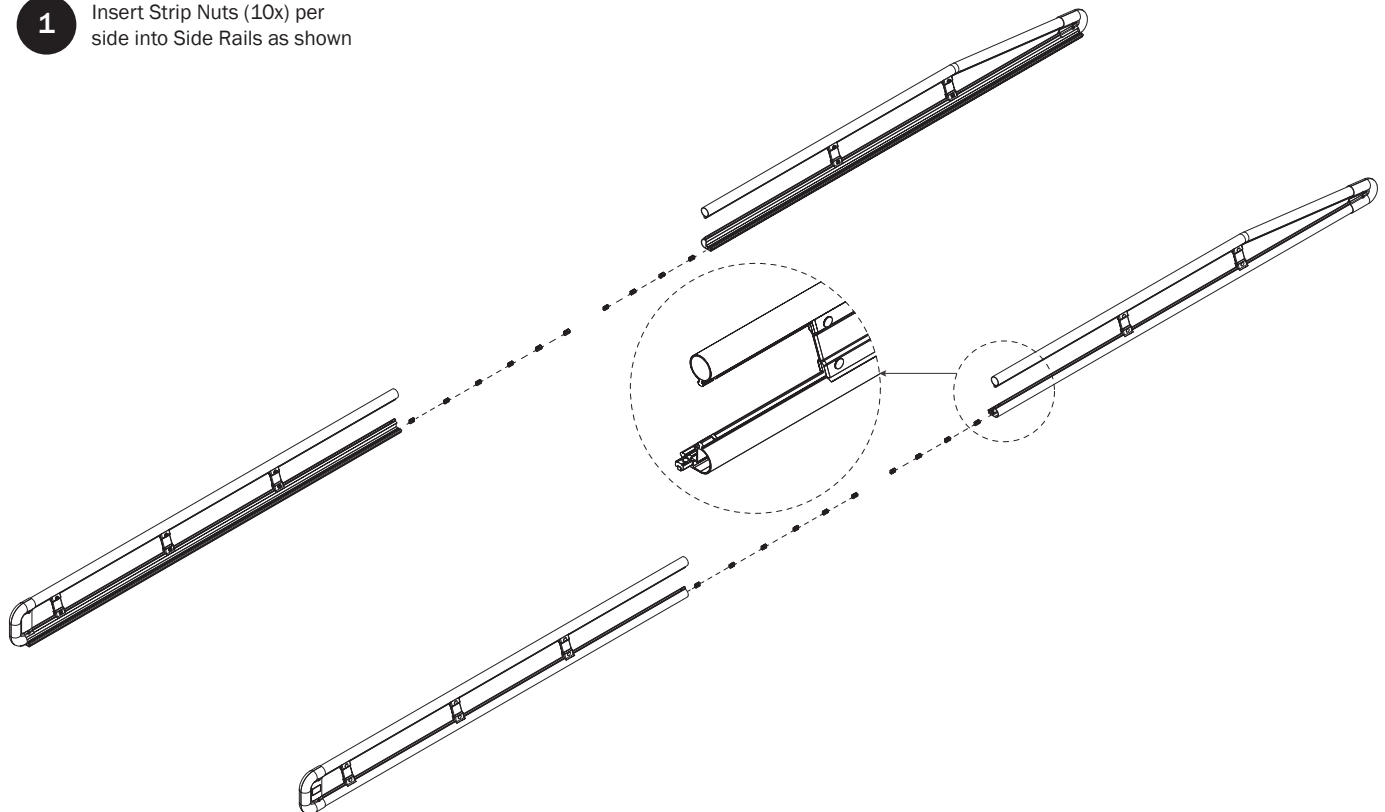

SIDE RAIL ASSEMBLY

2.1 Assemble Side rails as shown

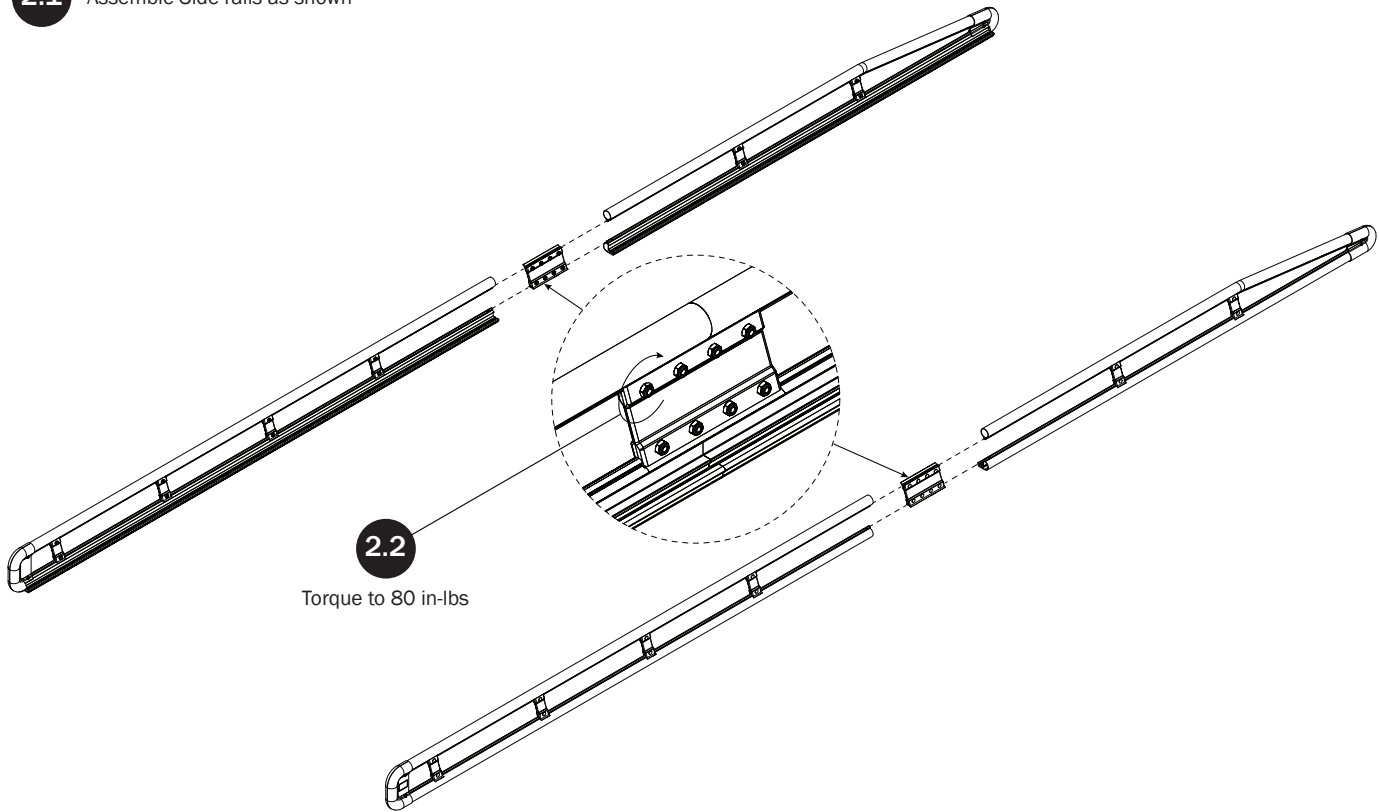

LEFT SIDE RAIL AND CROSSBARS

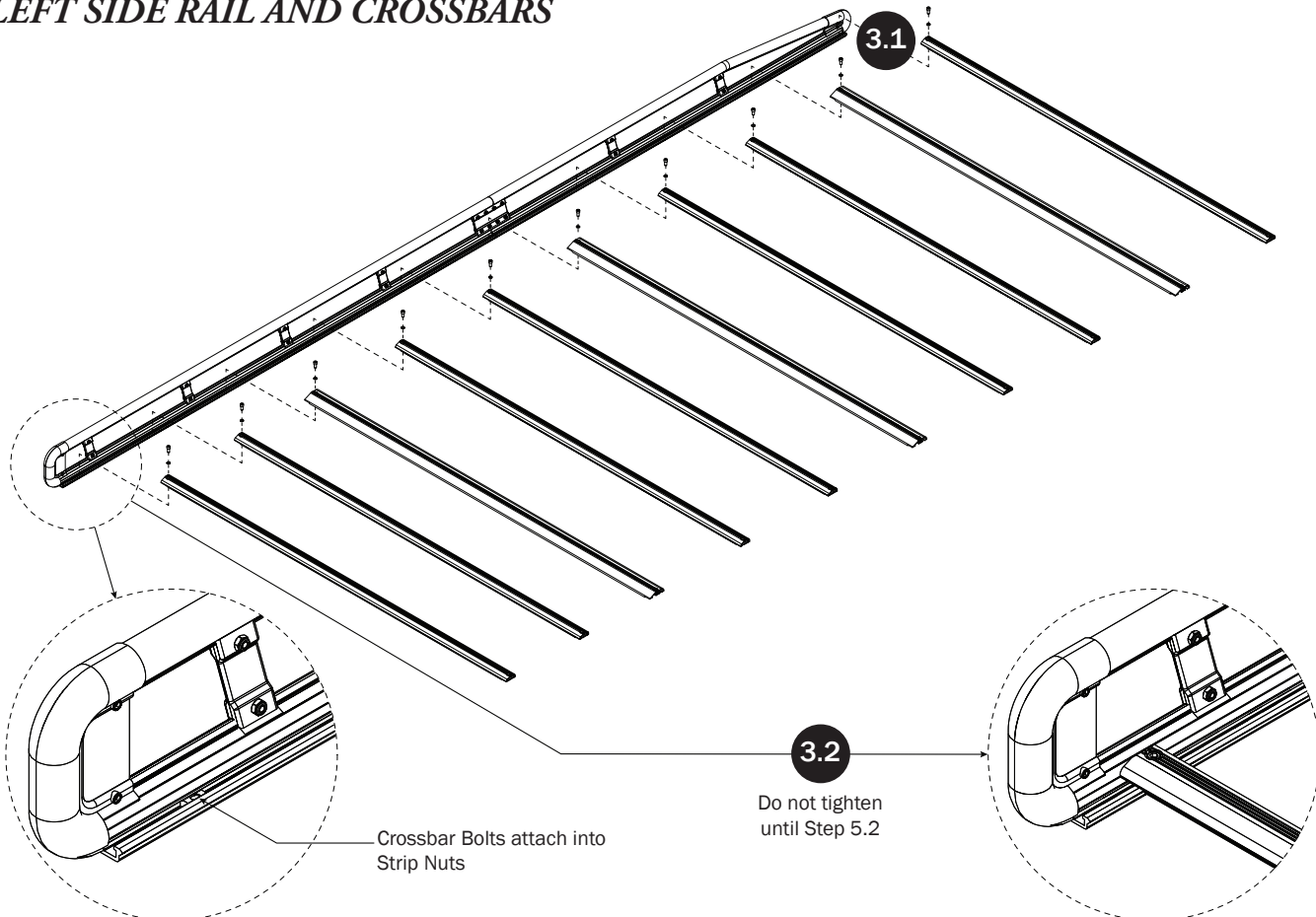

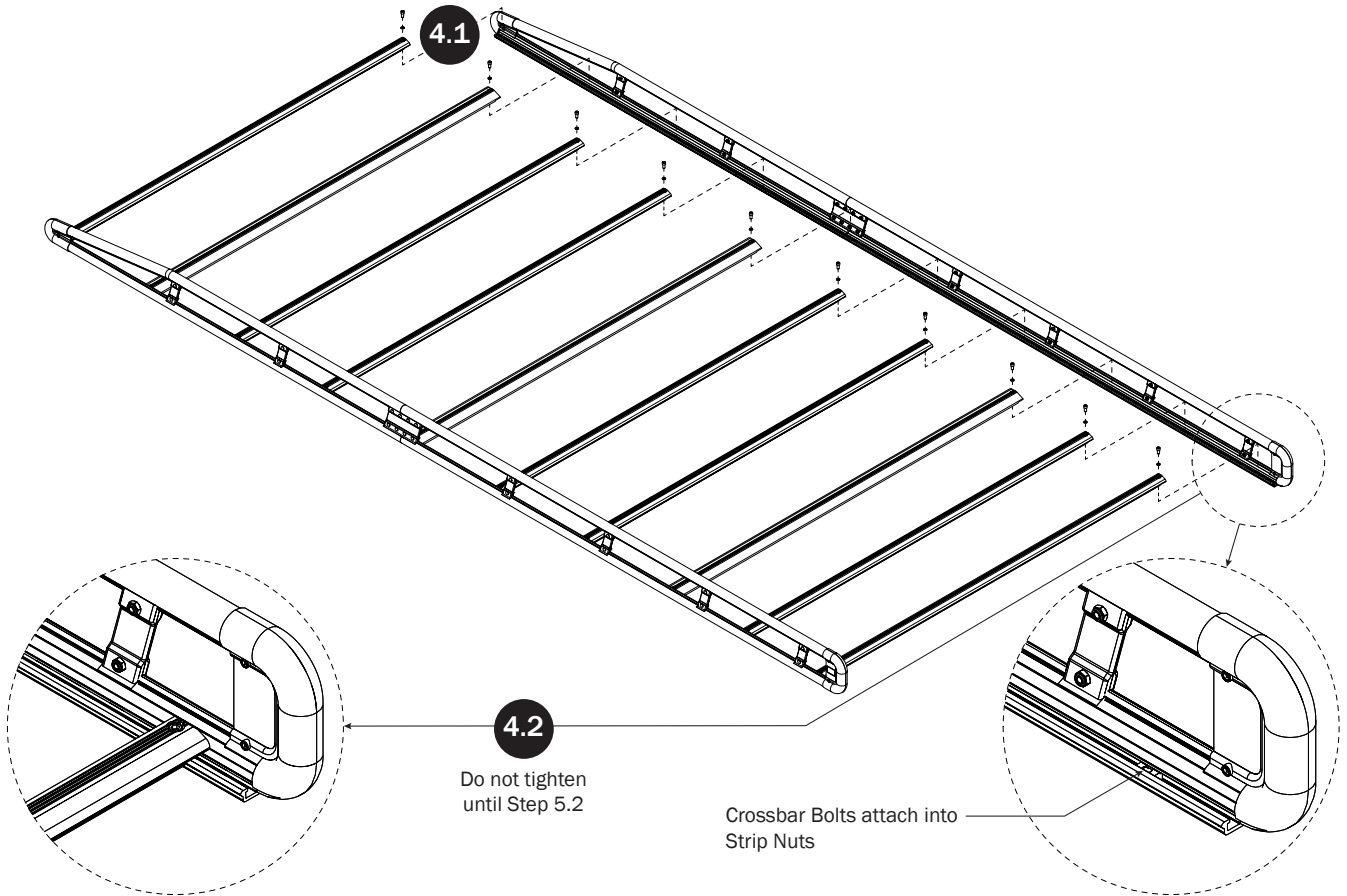
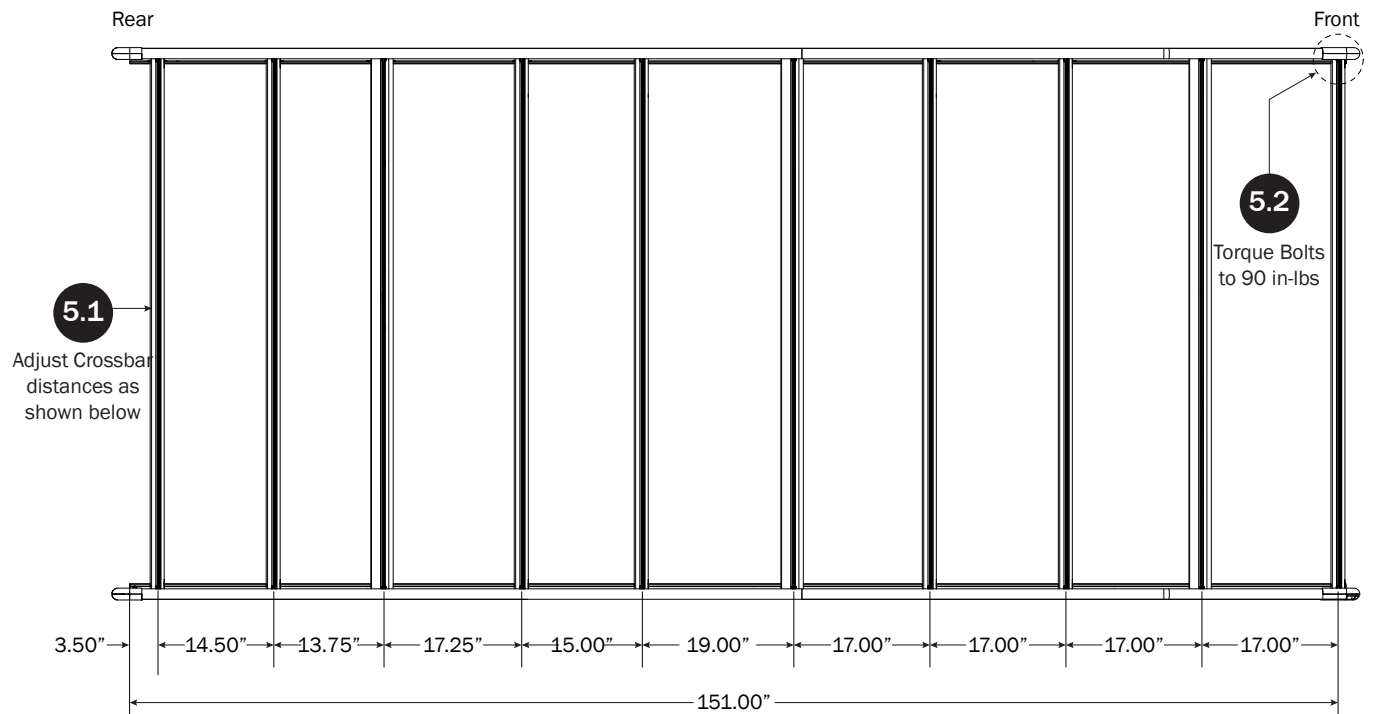
RIGHT SIDE RAIL AND CROSSBARS**CROSSBAR ADJUSTMENT**

ROLLER ASSEMBLY

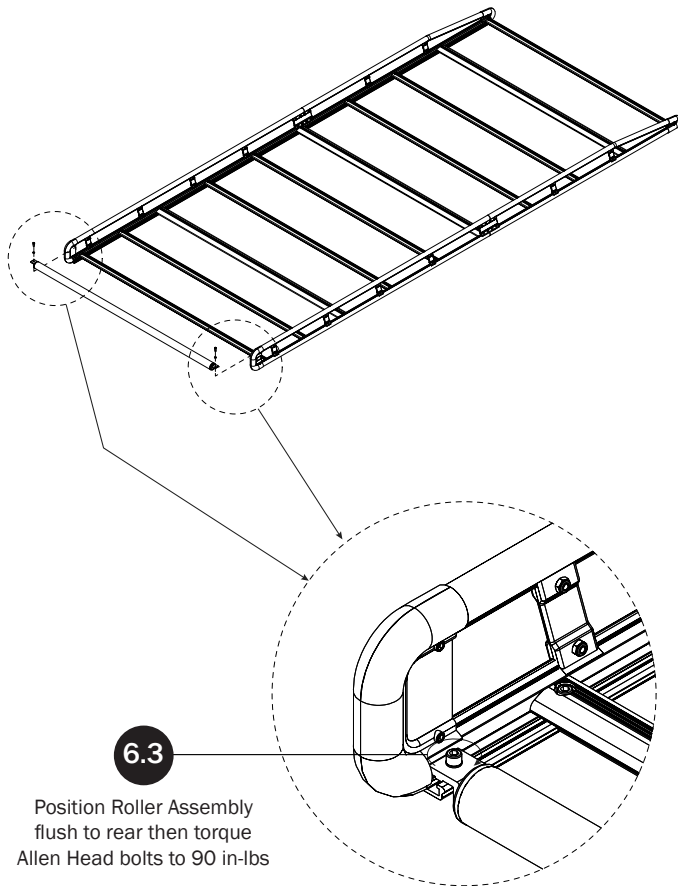
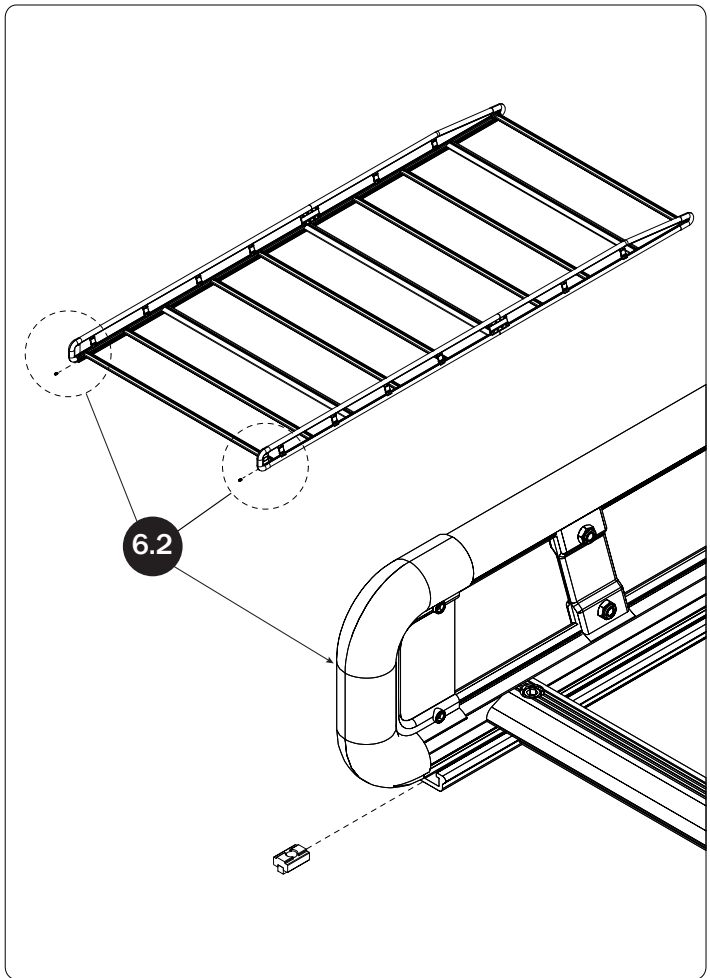
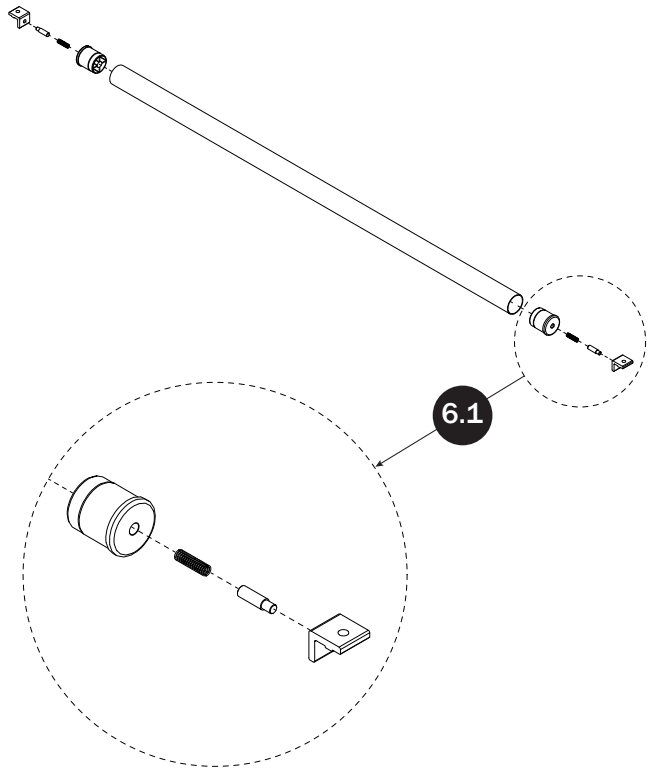

6.3

Position Roller Assembly
flush to rear then torque
Allen Head bolts to 90 in-lbs

MOUNTING RACK TO CHANNELS