

PRIME DESIGN™

A Safe Fleet Brand

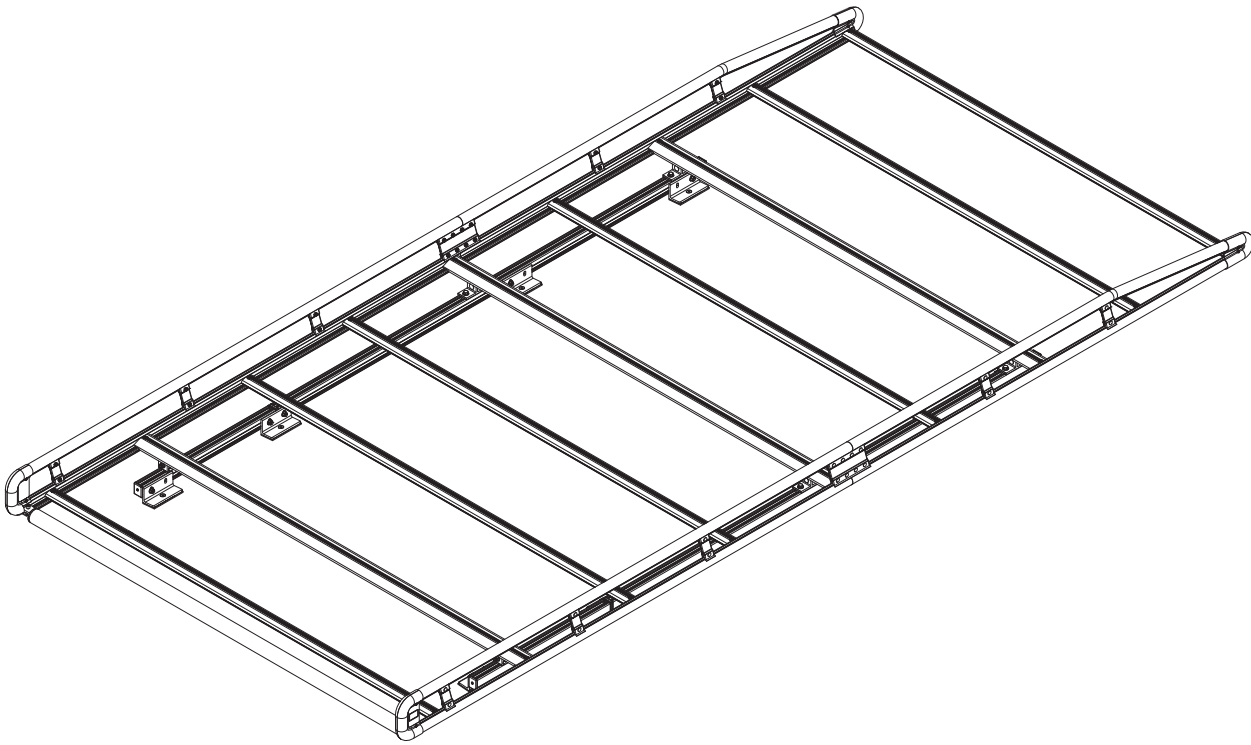

AR1909

CONTENTS OVERVIEW

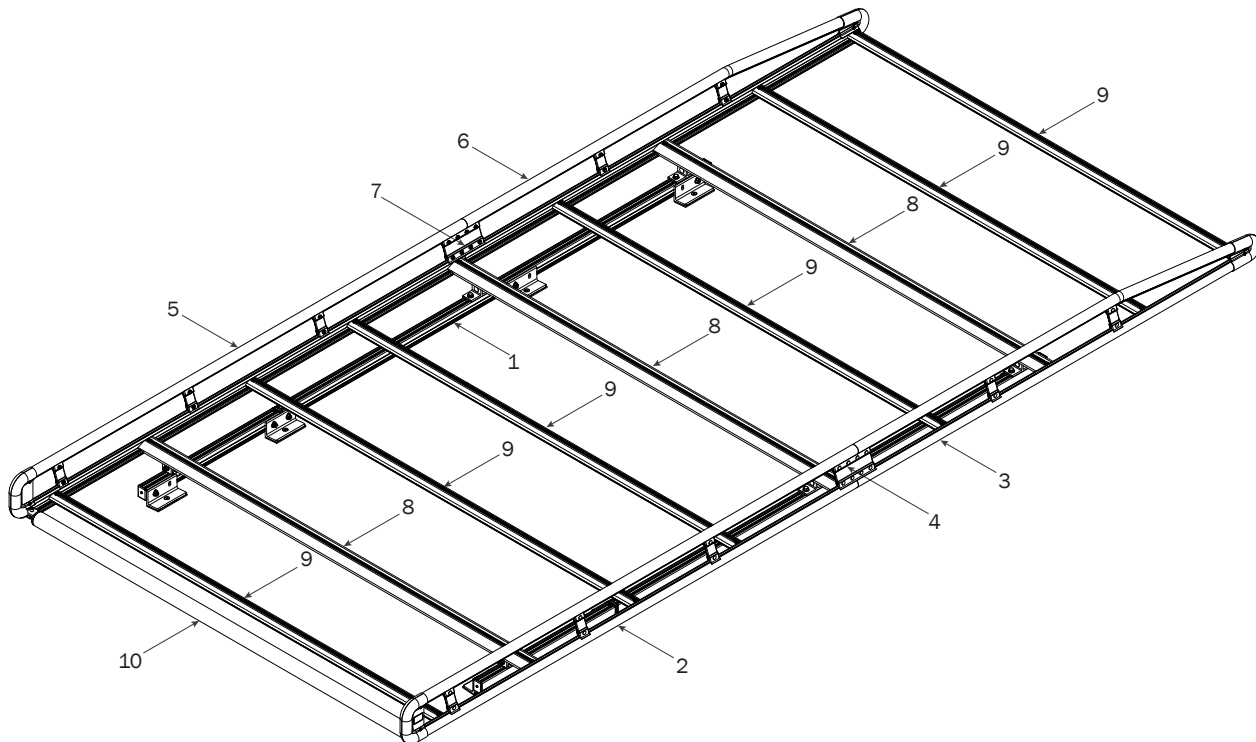

1—FBM3-0095-A..... (Qty 1)
Channels with hardware



23" Channels (2X)



74" Channels, Pre-assembled (2X)



Channel Bracket (6X)



5/16" Lock Washer (6X)

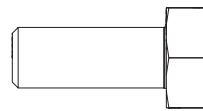

M8 x 20MM (6X)



M8 X 25MM (8X)

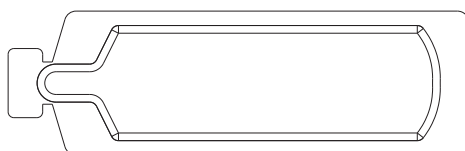

Anti-Seize (1X)

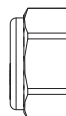

M8 Lock Nut (10X)

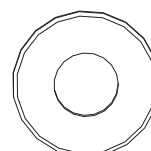

5/16" Flat Washer (16X)



Mounting Bracket (8X)



Foam Pad (8X)

2—Side Rail Assembly (Qty 1)
Rear, Right Hand, 76.00"

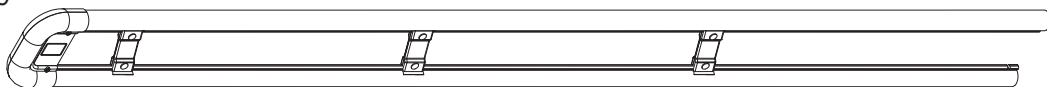

3—Side Rail Assembly (Qty 1)
Front, Right Hand, 68.00"

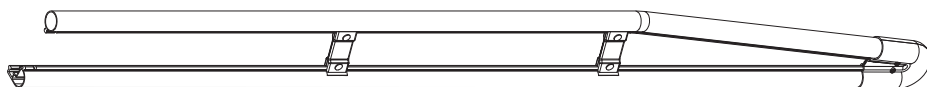

4—Side Rail Connector (Qty 1)
Right Hand, 6.00"

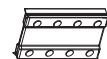

5—Side Rail Assembly..... (Qty 1)
Rear, Left Hand, 76.00”

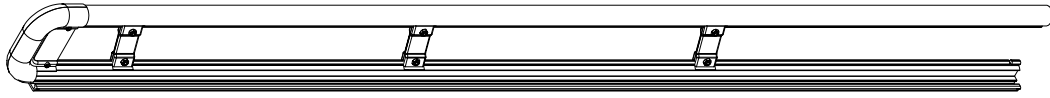

6—Side Rail Assembly..... (Qty 1)
Front, Left Hand, 68.00”

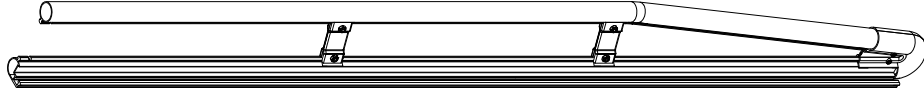

7—Side Rail Connector (Qty 1)
Left Hand, 6.00”

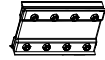

8—AluRack Construction Crossbar (Qty 3)
With hardware, 67.00”



9—AluRack Standard Crossbar (Qty 6)
With hardware, 67.00”



10—Roller Tube Assembly (Qty 1)
With caps, 63.75”



HKT-0084-Hardware Kit

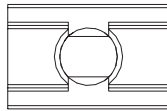

M8 Strip Nut (20X)

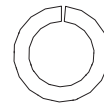

M8 Lock Washer (20X)

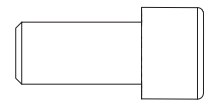

M8 Cap Head Bolt (20X)



Roller Holder (2X)



Roller Tube Pin (2X)

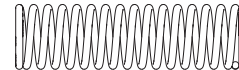

Roller Spring (2X)



Anti-Seize (1X)

FBM3-0095-A MOUNTING ASSEMBLY

- 0.1** Apply Anti-Seize to all M8 x 25MM Flat Head Screws and install the Channel Mounting Brackets with Foam Pads onto the vehicle's roof mounting holes. Do not tighten screws until Step 0.5

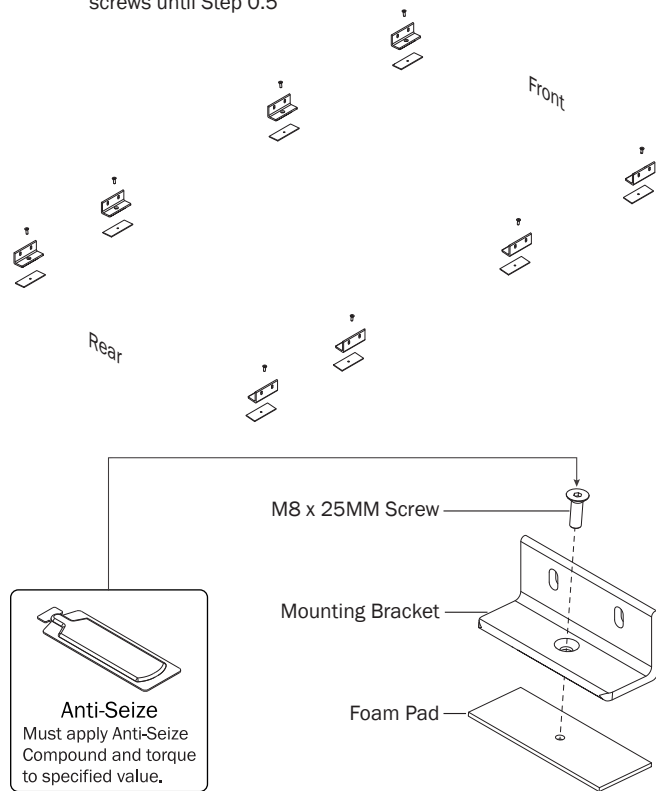

- 0.2** Remove the End Cap, Screw, one (1) aluminum Strip Nut, and one (1) T Bolt from the back of each Front Channel. Slide one (1) T Bolt into the back end of each Rear Channel. Slide the Channel Splice into the front end of the Rear Channels, then slide the Front Channels rearward until they contact the Rear Channels. Apply Anti-Seize to all M8 T Bolt studs, then attach to Mounts using the indicated hardware. Do not tighten until Step 0.4

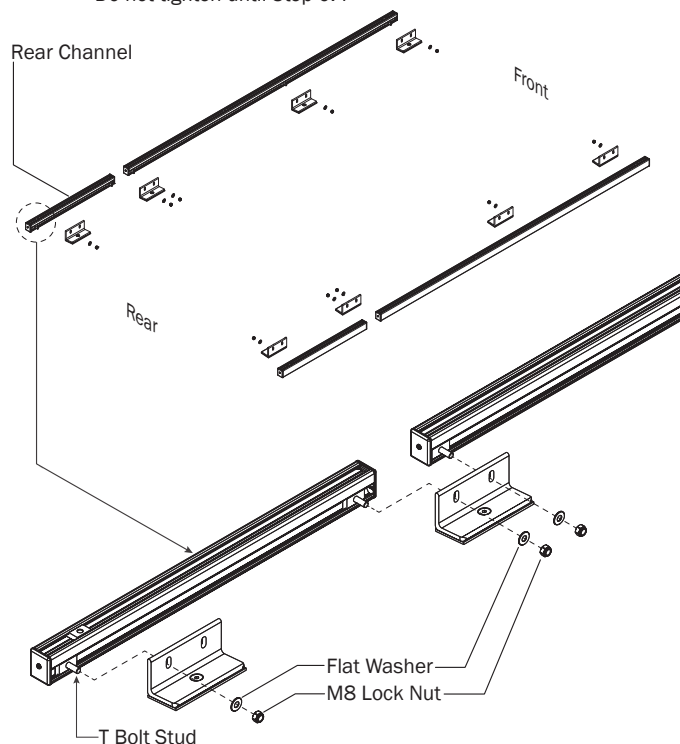

- 0.3** Slide both aluminum Strip Nuts into each end of the Rear Channels, and attach the Channel Caps

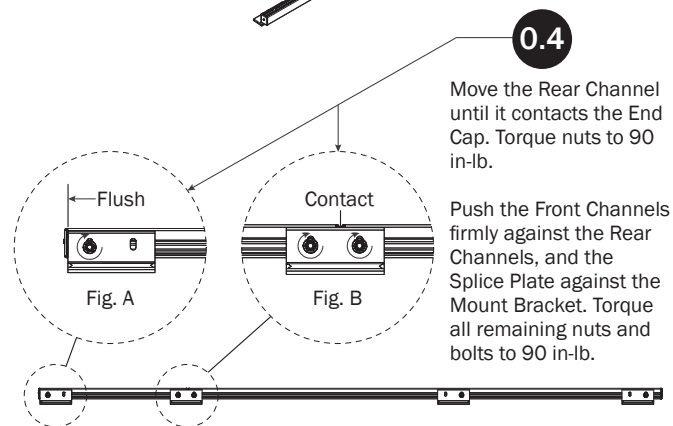
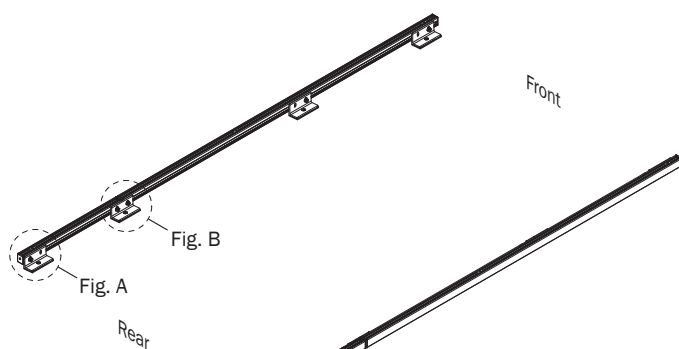

- 0.5** Torque all M8 x 25MM Flat Head Screws to 150 in-lbs. Apply Silicone Sealant to screw heads to seal against water intrusion.

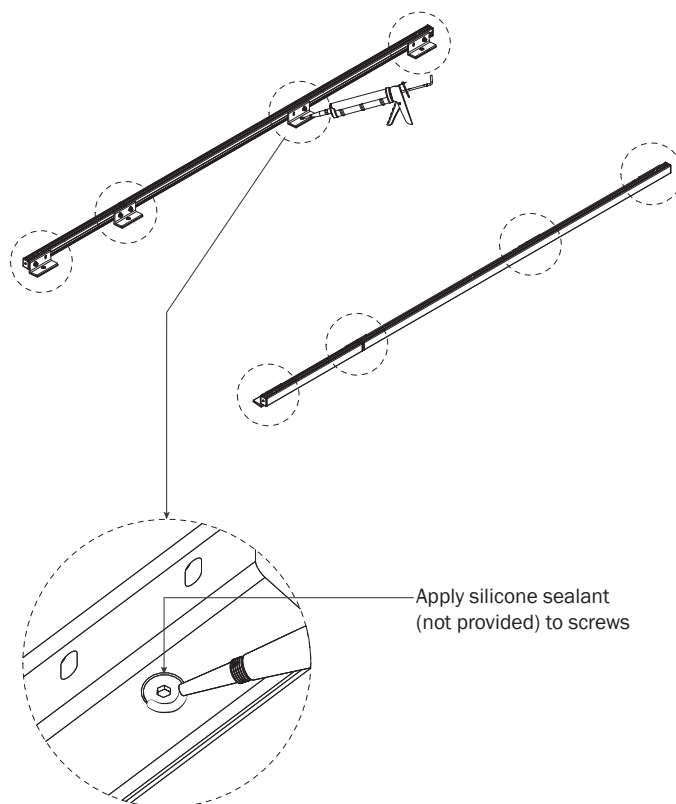

0.6 Attach Mounting Brackets to the Aluminum Strip Nuts located in the Channels

Position the rear and center Mounting Brackets as shown. Position the front Mounting Brackets as shown.

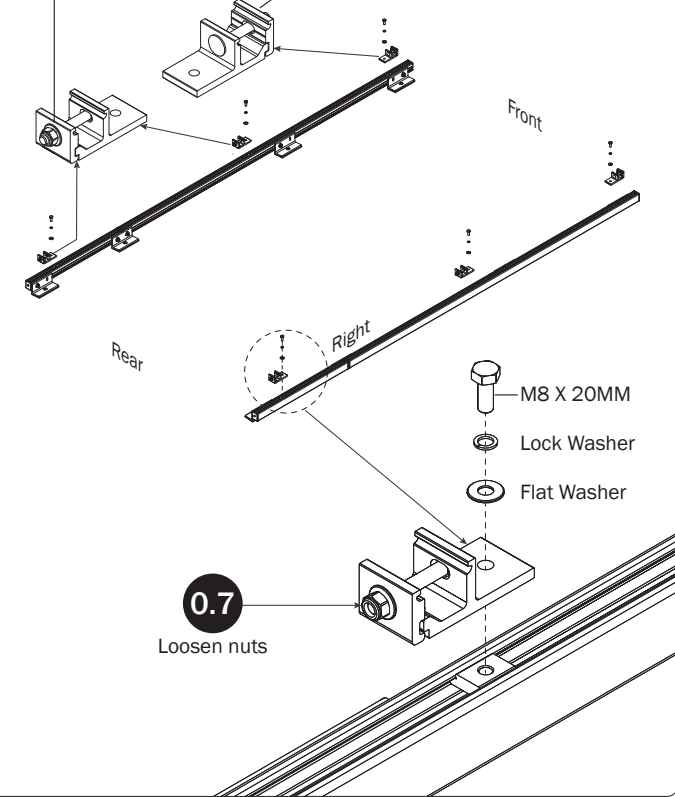

0.8 Set to distances shown below. Do not torque the Crossbar Mounting Brackets until Step 7.5. Finger-tighten them into designated dimension to hold them in place, then proceed to Rack Assembly.

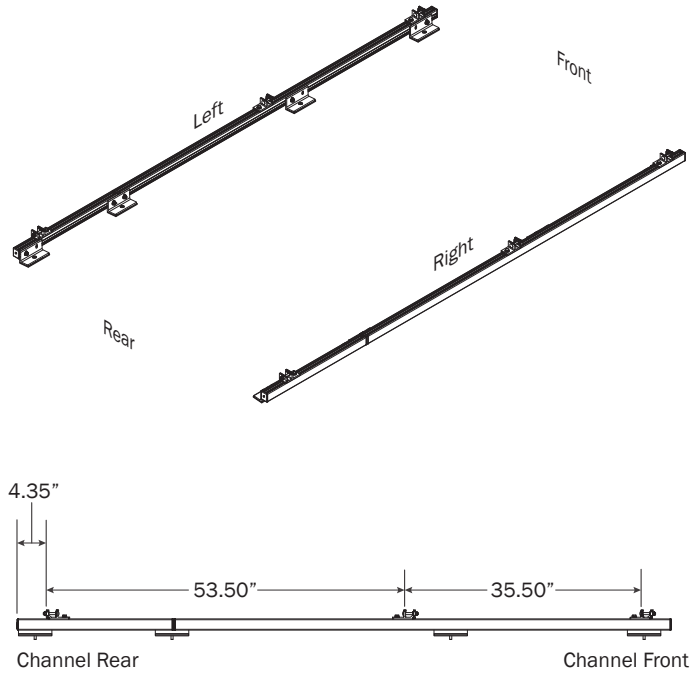

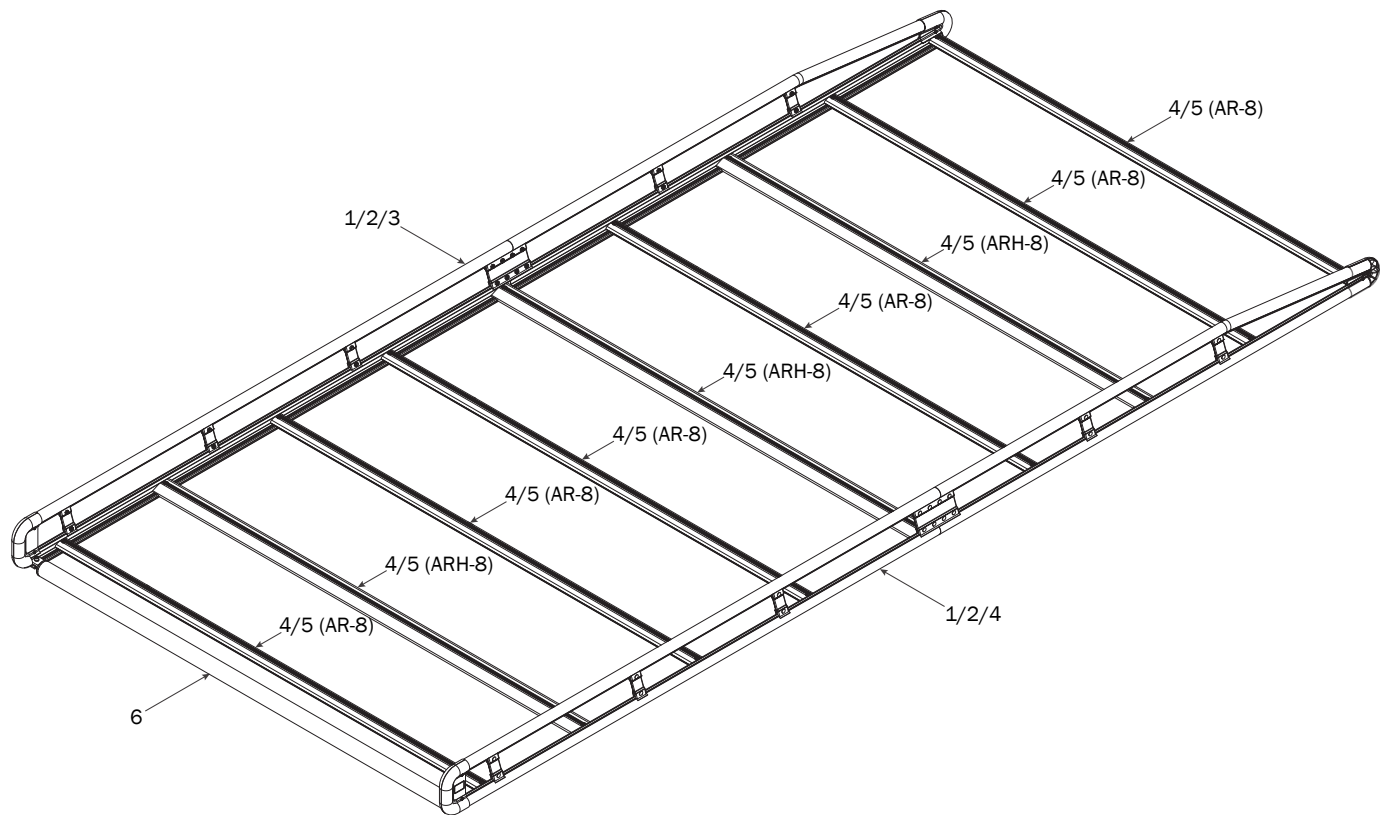
ALURACK ASSEMBLY SEQUENCE**STRIP NUT ASSEMBLY**

1

Insert Strip Nuts (9x) per side into Side Rails as shown

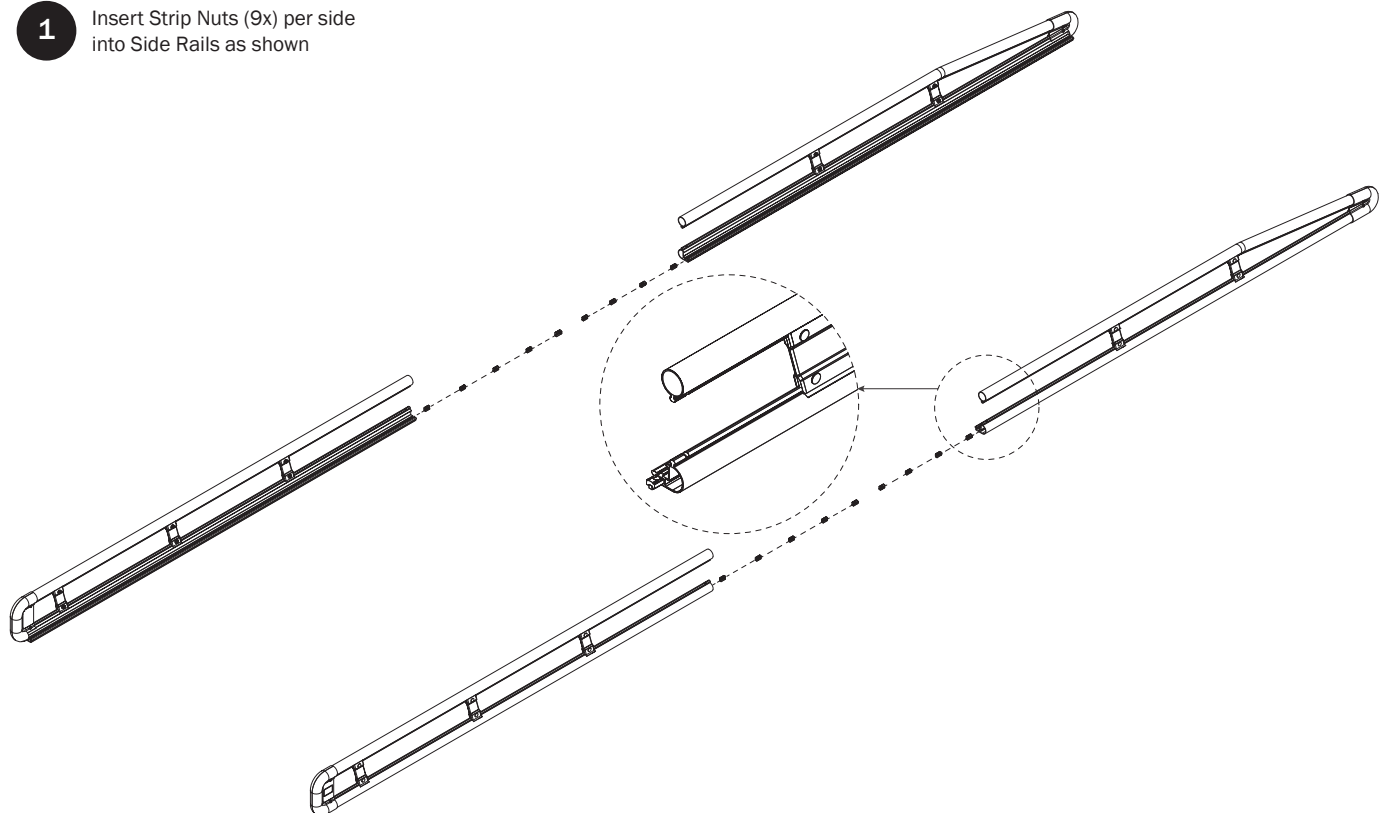

SIDE RAIL ASSEMBLY

2.1 Assemble Side rails as shown

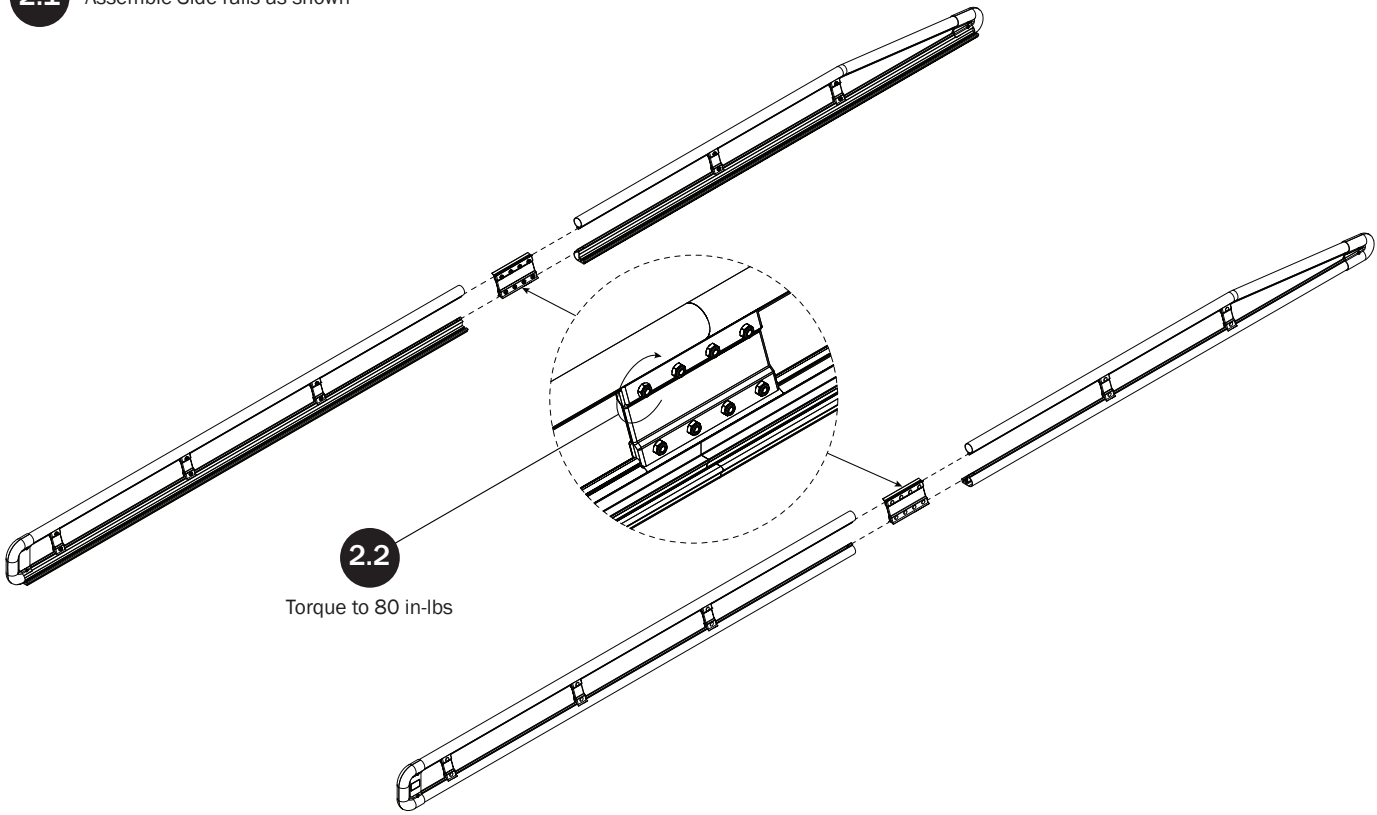

LEFT SIDE RAIL AND CROSSBARS

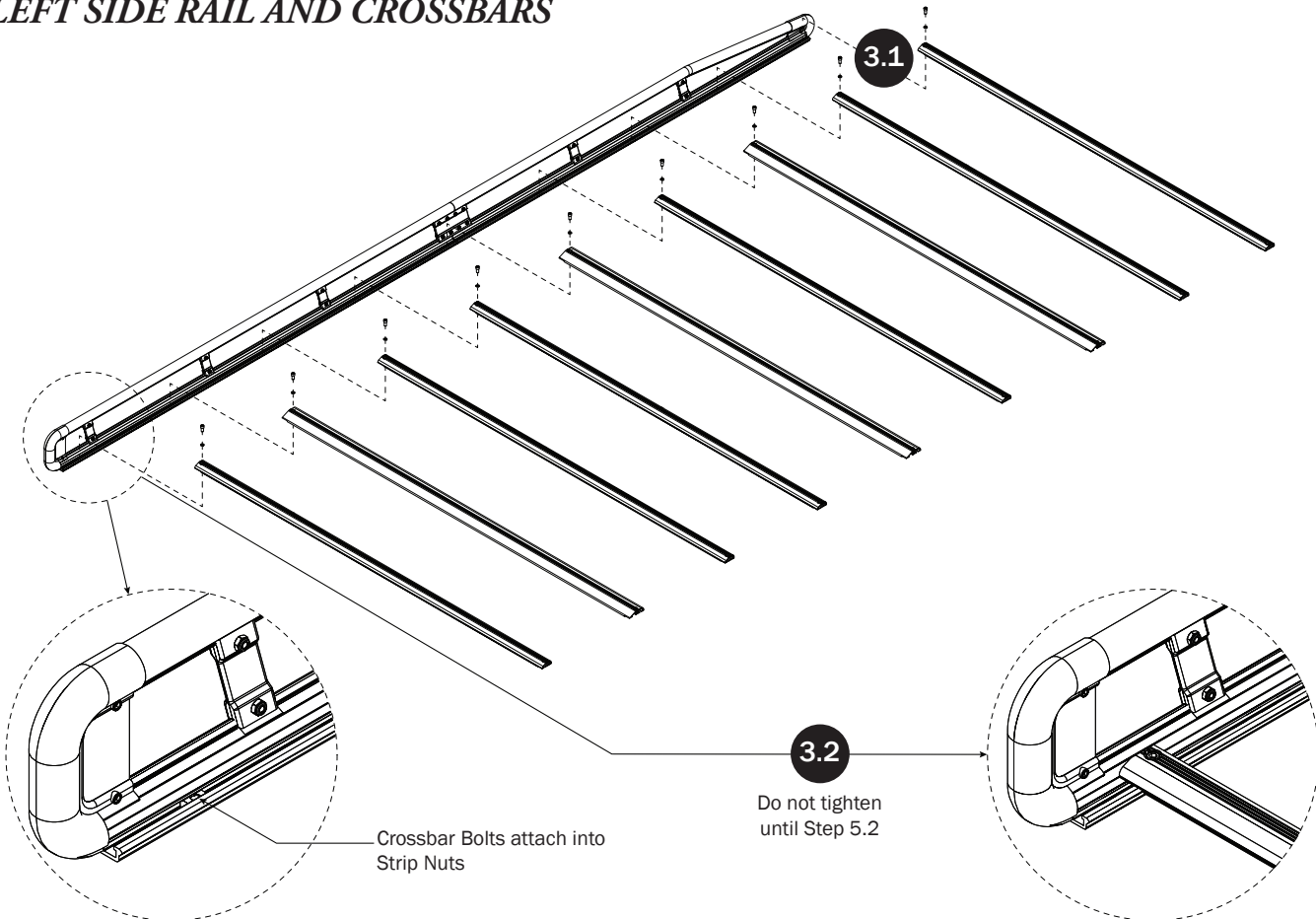

RIGHT SIDE RAIL AND CROSSBARS

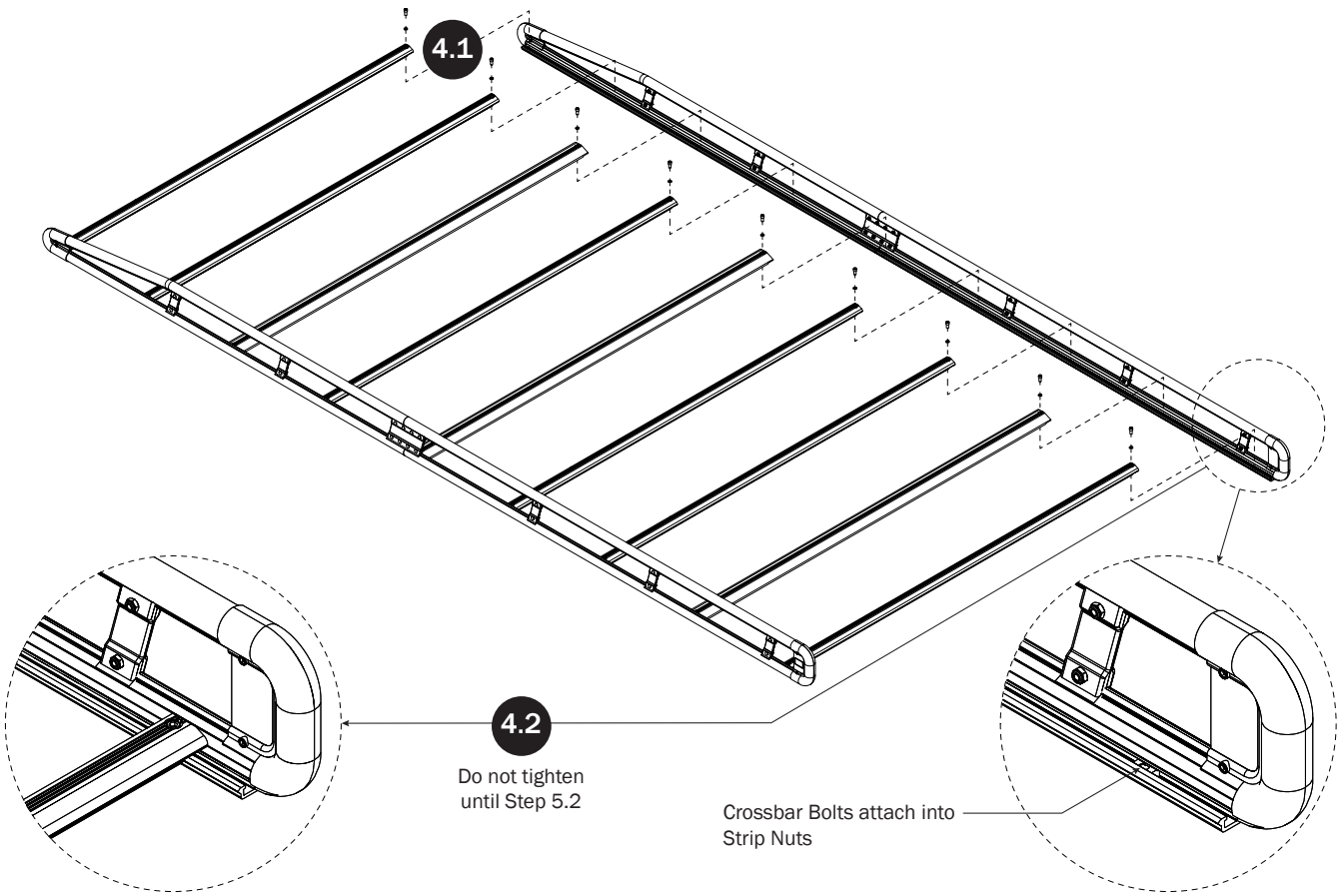

CROSSBAR ADJUSTMENT

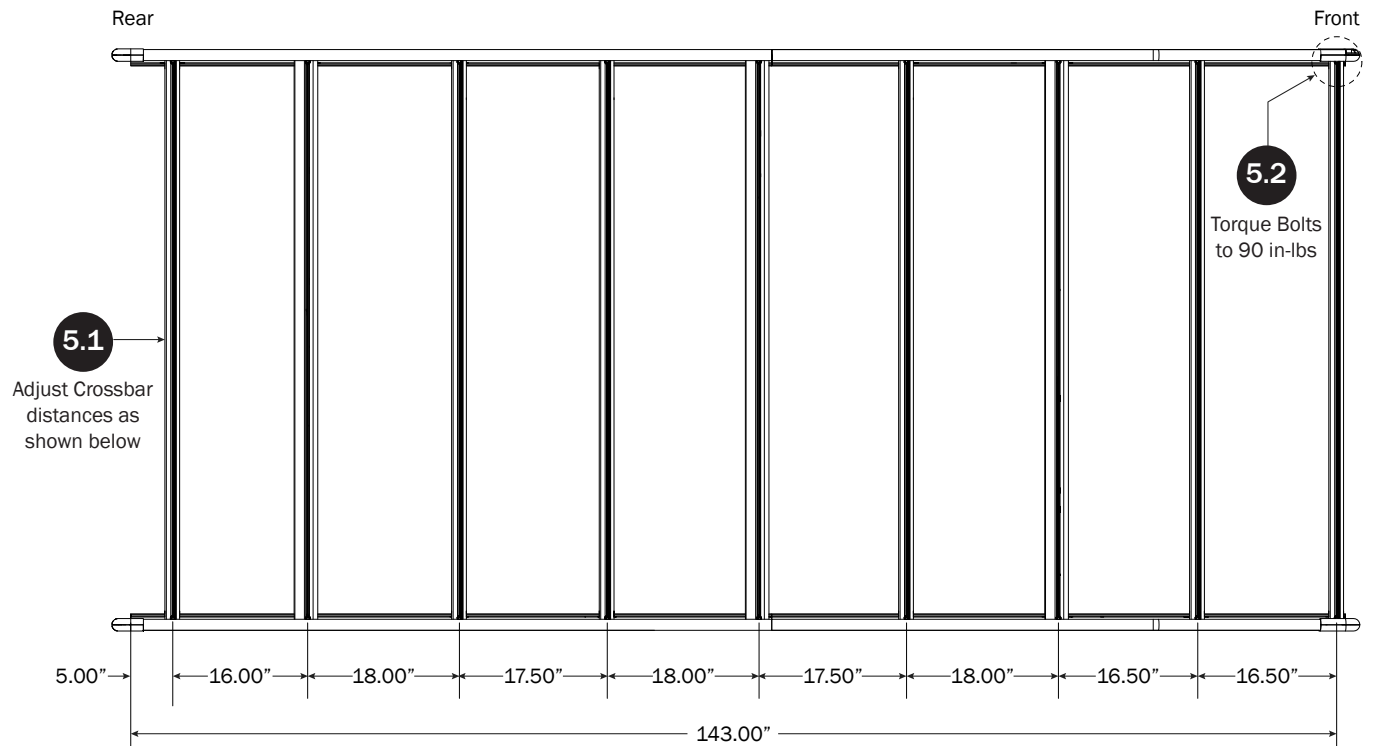

ROLLER ASSEMBLY

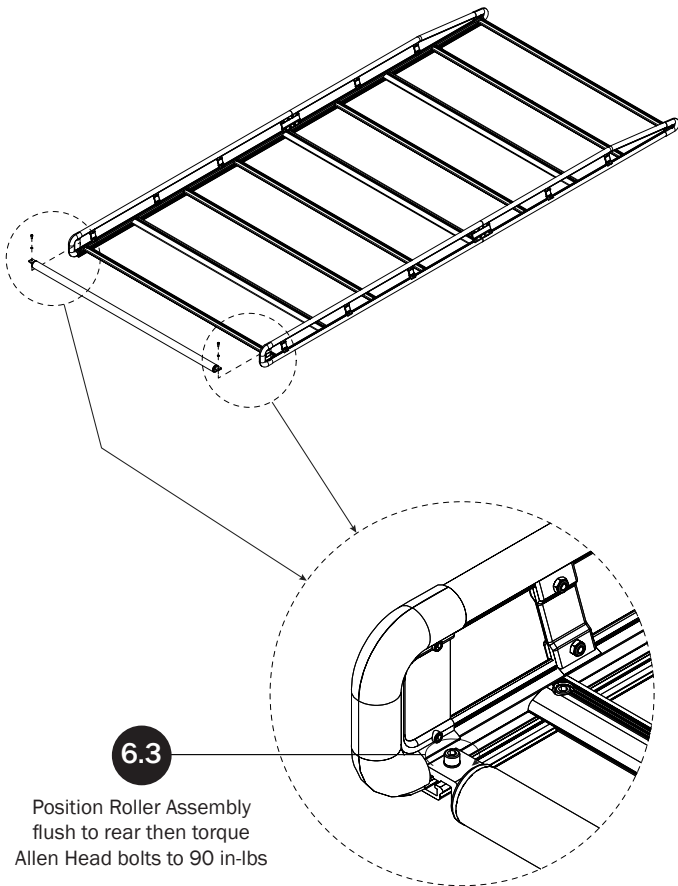
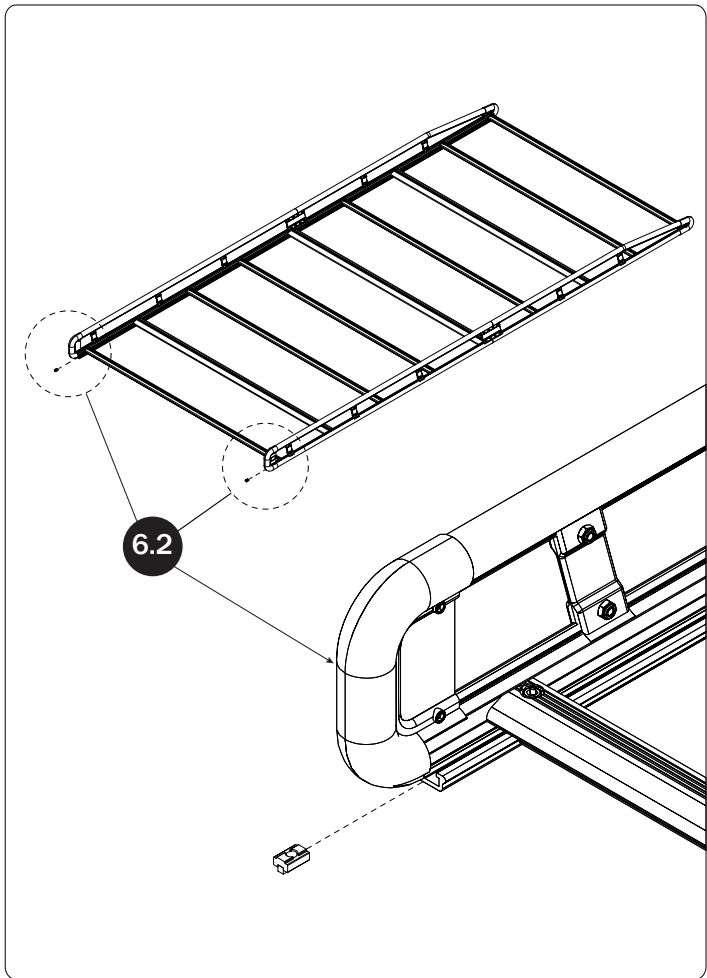
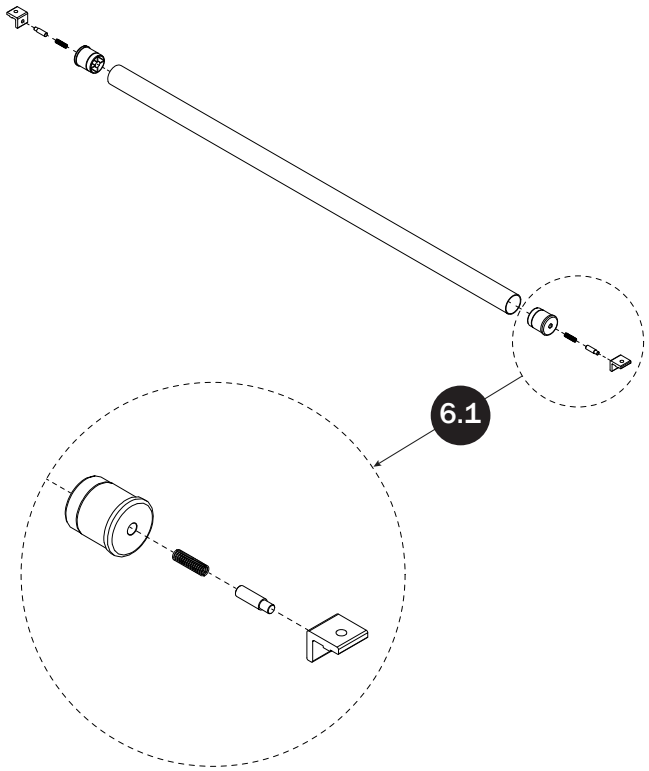

MOUNTING RACK TO CHANNELS

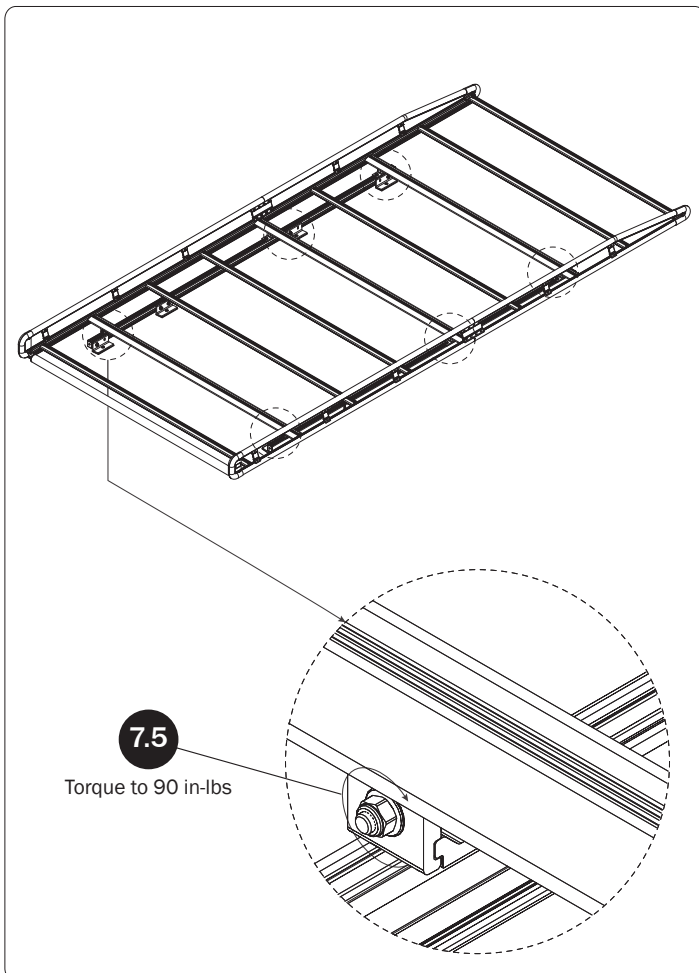
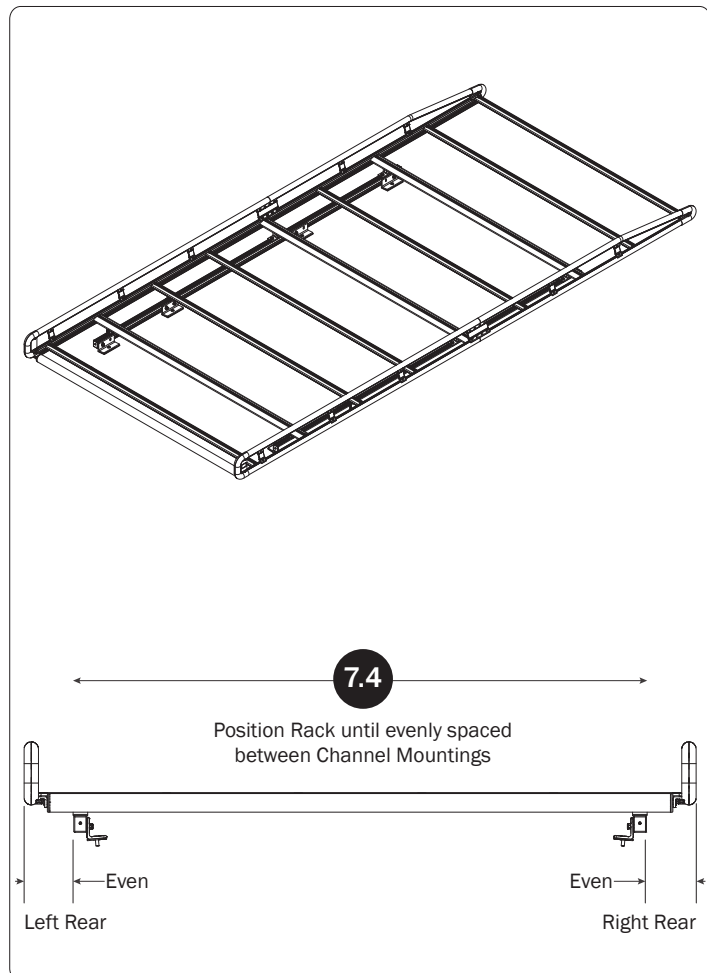
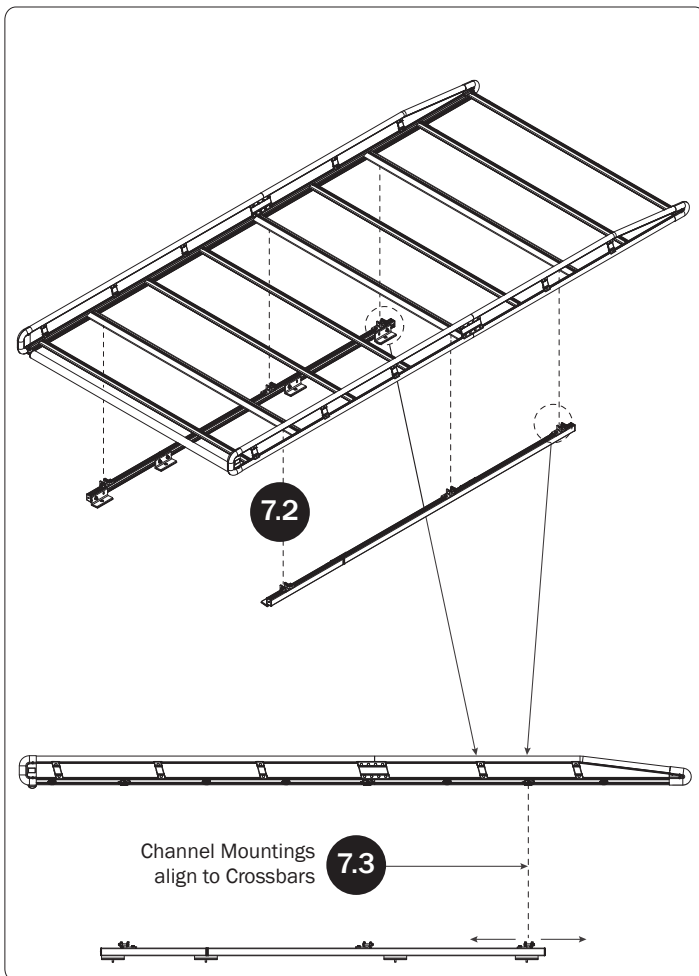
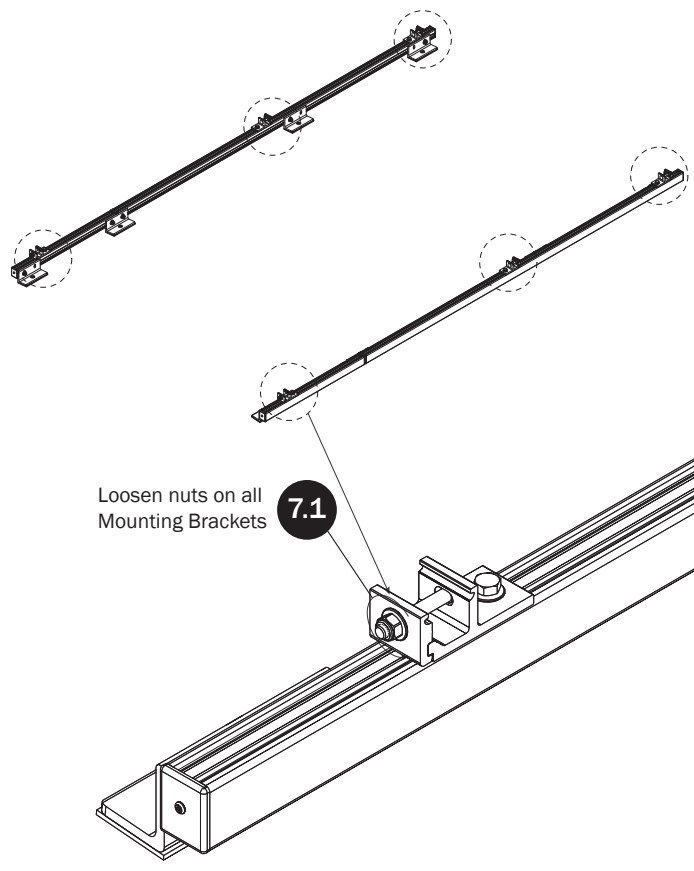

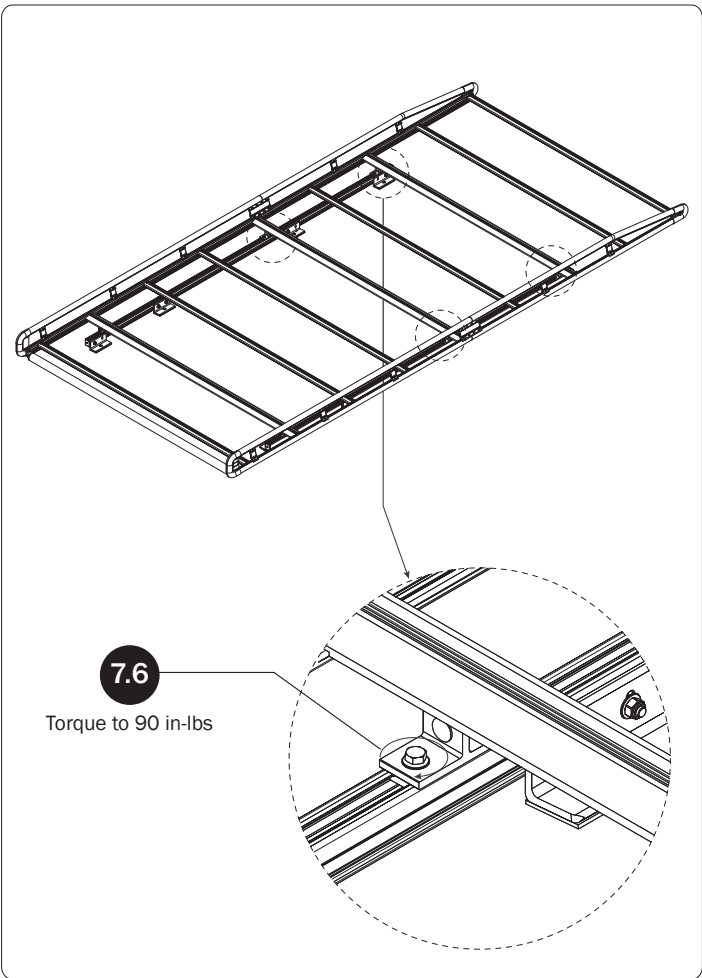

7.6

Torque to 90 in-lbs

