



PROMASTER 159" EXT. WB HIGH ROOF WALL LINERS

INSTALLATION INSTRUCTIONS



NOTES:

1. Before commencing, remove all wall liners and "D" Rings already installed in the vehicle.
2. Consult layout PDF and compare vehicle layout
3. Prepare hardware shown below and have them ready for installation.
4. Wall liners will be installed in the order shown in the instructions.
5. A drill with a Phillips driver is required to install hardware (**C**) #8 Screws, shown below.
6. Reinstall all "D" Rings once the wall liner kit installation is completed.

Hardware

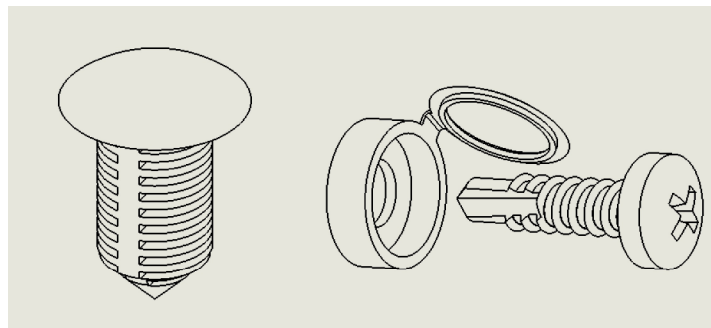

A) Retainer **B) #8 Screw Cap** **C) #8 Screw**

PROMASTER 159" EXT. WB HIGH ROOF WALL LINERS

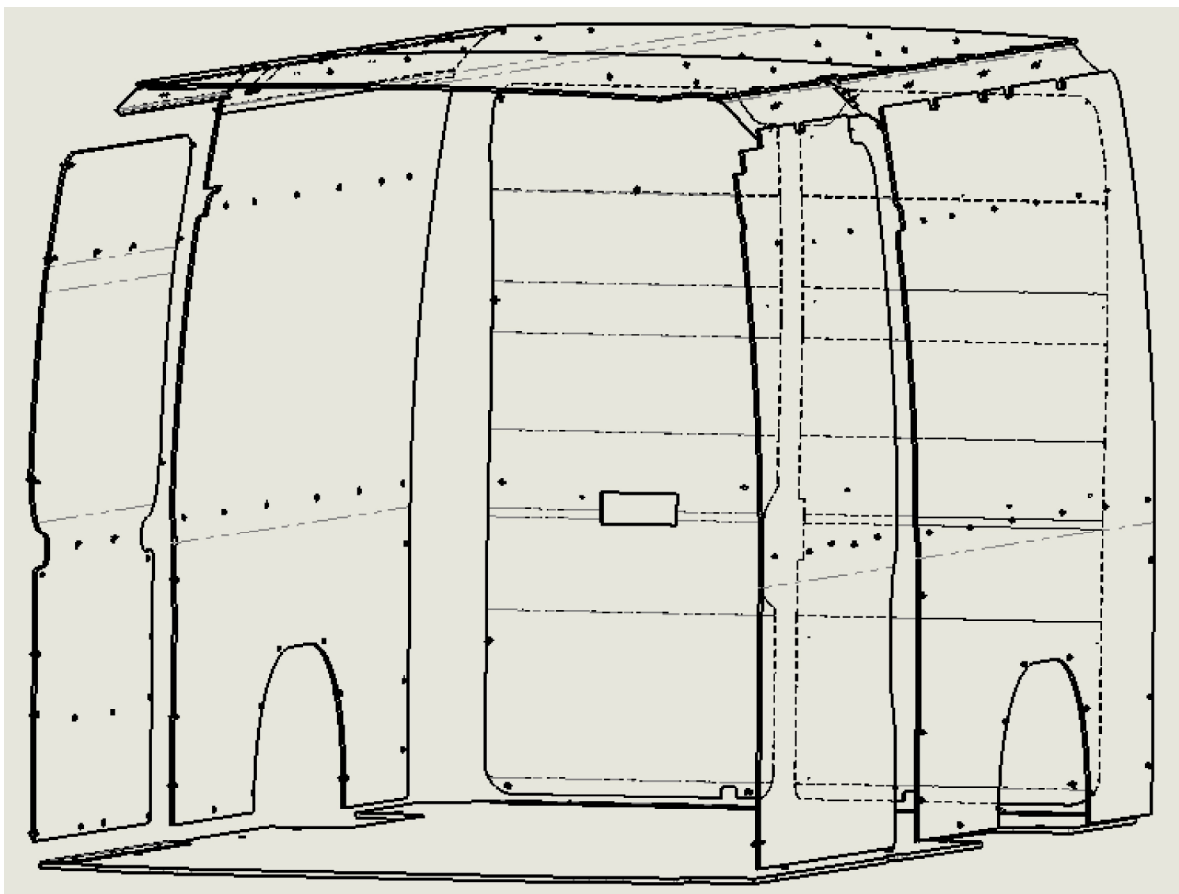

ITEM NO.	DESCRIPTION	QTY.
1	GREY FRONT WALL PANEL DRIVER SIDE PROMASTER 159" EXT WB HR	1
2	GREY REAR WALL PANEL DRIVER SIDE PROMASTER 159" EXT. WB HR	1
3	SILL "D" PROMASTER 159" EXT. WB HR	1
4	SILL "C" PROMASTER 159" EXT. WB HR	1
5	RETAINER- BLACK NYLON	97
6	SCREW CAP	33
7	SCREW - PHIL. PAN HD #8X.75 SELF DRILLING	72
8	JOINER PLATE- CEILING SILL	2
9	GREY REAR WALL PANEL PASSENGER SIDE PROMASTER 159" EXT. WB HR	1
10	SILL "A" PROMASTER 159" EXT. WB HR	1
11	SILL "B" PROMASTER 159" EXT. WB HR	1
12	GREY CEILING FRONT PANEL PROMASTER 159" EXT. WB HR	1
13	GREY CEILING REAR PANEL PROMASTER 159" EXT. WB HR	1
14	GREY SLIDING DOOR PANEL PROMASTER 159" EXT. WB HR	1
15	GREY REAR DOOR PANEL PASSENGER SIDE PROMASTER 159" EXT. WB HR	1
16	GREY REAR DOOR PANEL DRIVER SIDE PROMASTER 159" EXT. WB HR	1
17	FLOOR - PROMASTER 159 EXT. WB	1
18	REAR DOOR FLOOR SILL PROMASTER	1
19	SIDE DOOR FLOOR SILL PROMASTER	1

Note:

Model may differ depending if the vehicle purchased came with an OEM partition or not.

Driver Side Wall Liner Installation

ITEM 2
REAR DRIVERS SIDE PANEL

ITEM 1
FRONT
DRIVERS SIDE
PANEL

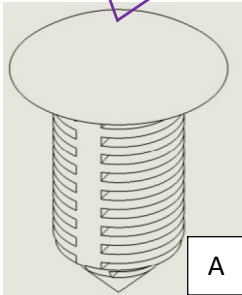
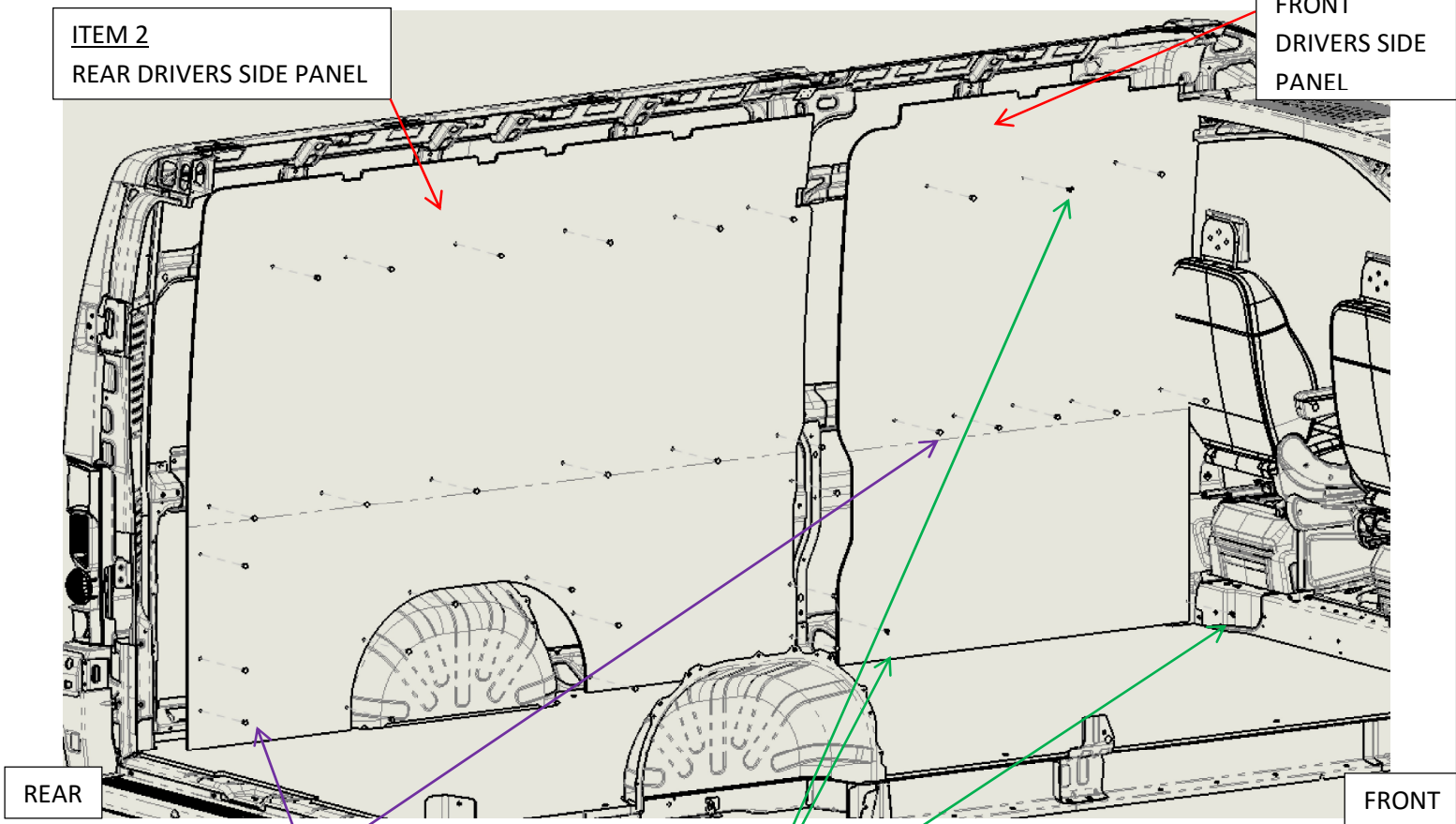

A

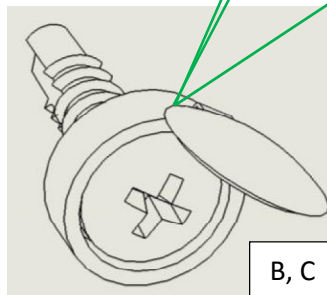

B, C

Installation completed



1: Install Item 1, Front Driver Side Panel.

- Align notch and edge of panel with the feature on the vehicle driver side front then align opposite side of panel edge with the contour features.
- Install hardware (A) and (B,C), in the holes provided, on the bottom of the panel first, working your way up the panel to the top.

2: Install Item 2, Rear Driver Side Panels.

- Align wheel well edge of the panel with the feature on the vehicle; position the contour of the panel to the vehicle wall.
- Install hardware (A), in the holes provided, on the bottom of the panel first, working your way up the panel to the top.

Back Door Wall Liner Installation

ITEM 15
REAR DOOR
PASSENGER SIDE
PANEL

ITEM 16
REAR DOOR
DRIVERS SIDE
PANEL

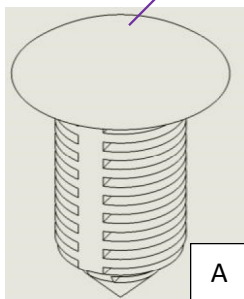
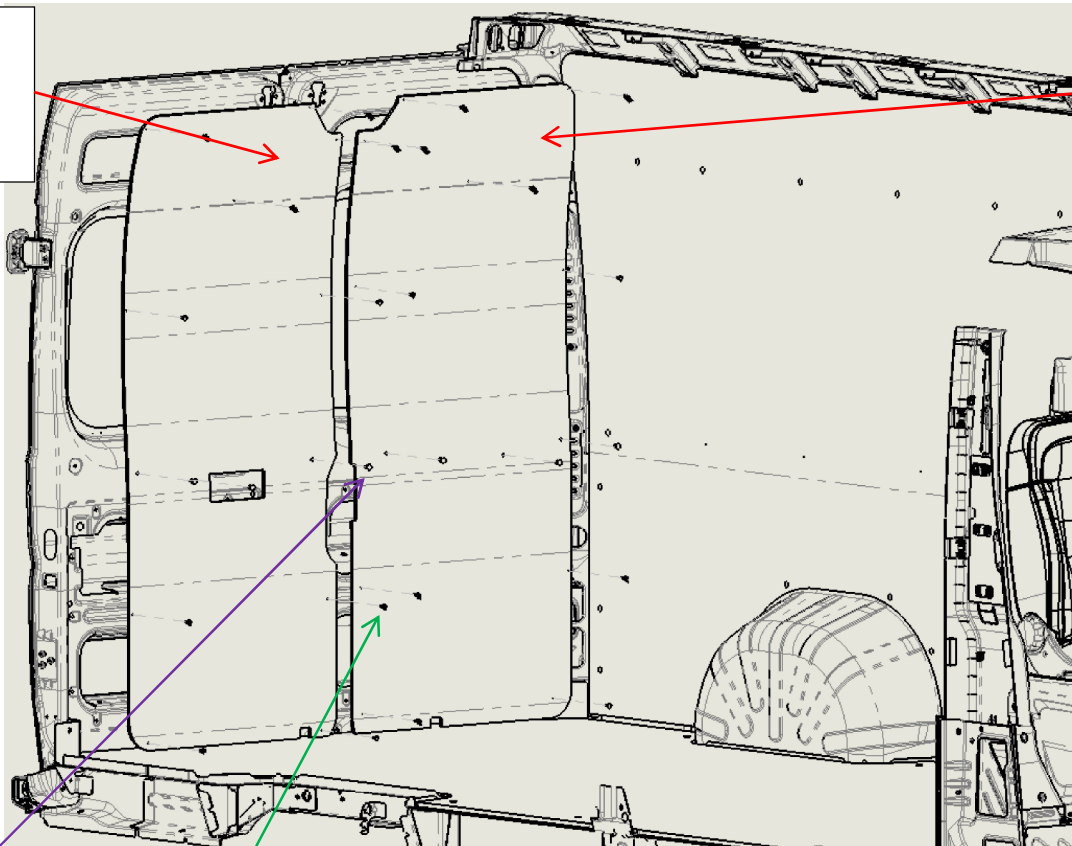

A

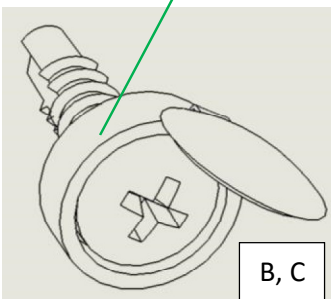

B, C

3: Install Item 15 and 16, Rear door panels,

Note: Rear doors must be closed when installing door panels.

- Align the panels with the upper door contours, do not mount tight against the door seals.
- Install hardware (A) first in the holes provided, this will align the panel then install hardware (B, C) on the top of the panel first, working your way down the panel to the bottom.

Installation completed

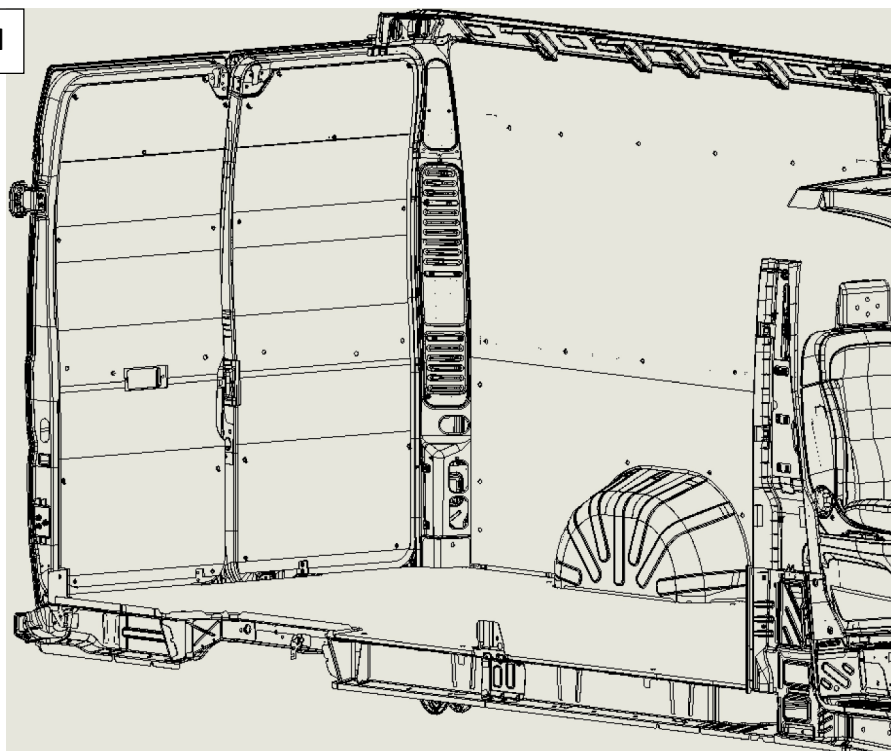

Passenger Side Wall Liner Installation

ITEM 14
SLIDING DOOR
PANEL

B, C

ITEM 9
REAR PASSENGER
SIDE PANEL

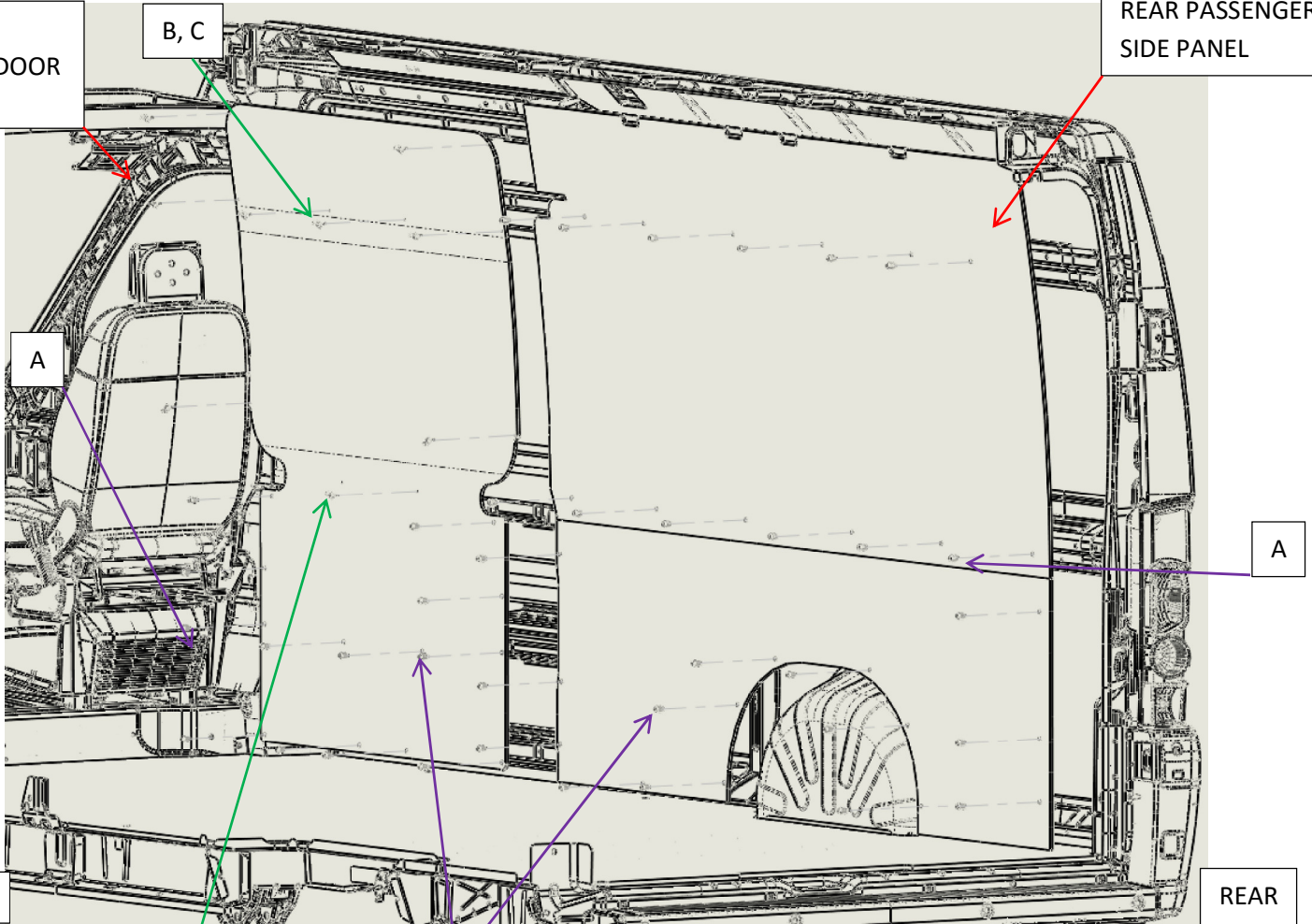

FRONT

REAR

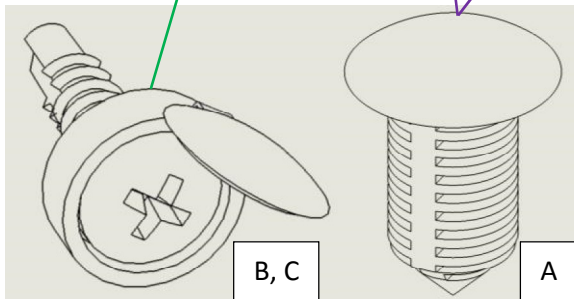

Installation completed

4: Install Item 9, Rear Passenger Side Panel.

- Align wheel well edge of the panel with the feature on the vehicle; position the contour of the panel to the vehicle wall.
- Install hardware (A), in the holes provided, on the bottom of the panel first, working your way up the panel to the top.

5: Install Item 14, Sliding Door Panel. First remove OEM bottom panel.

Note: Sliding door must be closed to install panel;

- Insert panel into the sliding door sill cavity, align holes at the bottom half of the panel to the one on the door and insert hardware (A) in all of the holes provided.
- Install hardware (B, C) in the holes provided in the middle to the top part of the panel; make sure the panel does not interfere with the door seal.

