



TRANSIT 130" MEDIUM ROOF WALL LINERS

INSTALLATION INSTRUCTIONS

NOTES:

1. Before commencing, remove all wall liners and "D" Rings already installed in the vehicle.
2. Consult layout PDF and compare vehicle layout
3. Prepare hardware shown below and have them ready for installation.
4. Wall liners will be installed in the order shown in the instructions.
5. A drill with a Phillips driver is required to install (**C**) #8 Screws) shown below.
6. Reinstall all "D" Rings once the wall liner kit installation is completed.

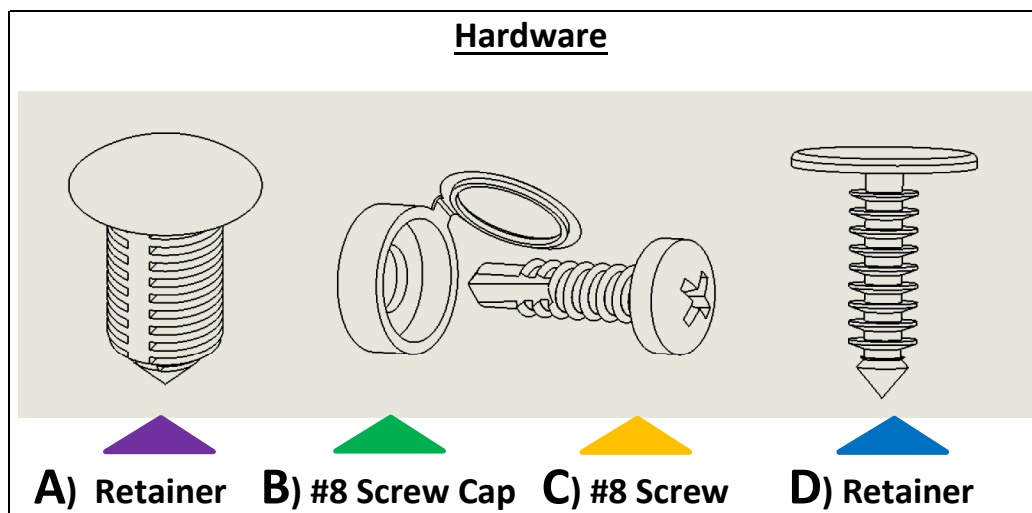

TRANSIT 130" MEDIUM ROOF WALL LINERS

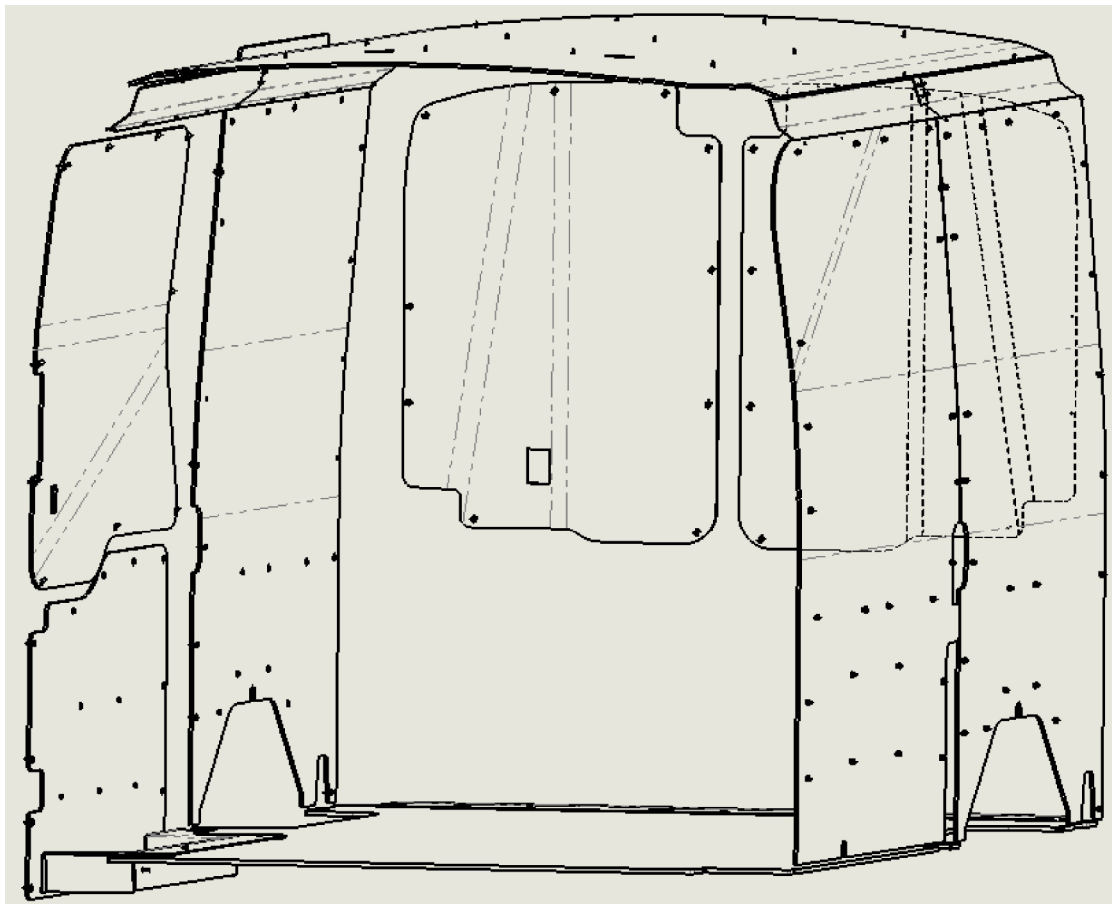

ITEM NO.
1
2
3
4
5
6
7
8
9
10
11
12
13
14
15
16
17
18
19
20

DESCRIPTION	QTY.
GREY FRONT PANEL DRIVER SIDE TRANSIT 130" MR	1
GREY REAR PANEL DRIVER SIDE TRANSIT 130" MR	1
GREY REAR PANEL PASSENGER SIDE 130" MR	1
GREY CEILING FRONT PANEL TRANSIT 130" MR	1
SCREW - PHIL. PAN HD #8X.75 SELF DRILLING	74
CEILING SILL 1 TRANSIT 130" MR	2
CEILING SILL 2 TRANSIT 130" MR	2
SCREW CAP	42
RETAINER- BLACK NYLON	91
FLOOR SLIDING DOOR SILL 3 - TRANSIT	1
FLOOR SLIDING SILL 1- TRANSIT	1
FLOOR SLIDING DOOR SILL 2 - TRANSIT	1
FLOOR REAR SILL- TRANSIT	1
RETAINER- BLACK NYLON 31163211	12
GREY REAR DOOR PANEL DRIVER SIDE TRANSIT 130" MR	1
GREY REAR DOOR PANEL PASSENGER SIDE TRANSIT 130" MR	1
GREY SIDE DOOR TOP PANEL TRANSIT 130" MR	1
GREY SIDE DOOR BOTTOM PANEL TRANSIT 130" MR	1
FLOOR - TRANSIT 130" WB	1
SILL JOINER PLATE TRANSIT 130" MR	2

Driver Side Wall Liner Installation

ITEM 2

REAR DRIVERS
SIDE PANEL

ITEM 1

FRONT
DRIVERS SIDE
PANEL

REAR

FRONT

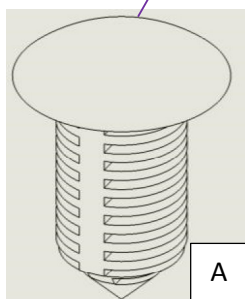

A

1: Install Item 1, Front Driver Side Panel.

- Align notch and edge of panel with the feature on the vehicle driver side front then align opposite side of panel edge with the contour features.
- Install hardware (A), in the holes provided, on the bottom of the panel first, working your way up the panel to the top.

2: Install Item 2, Rear Driver Side Panel.

- Align wheel well edge of the panel with the feature on the vehicle, position the contour of the panel to the vehicle wall.
- Install hardware (A), in the holes provided, on the bottom of the panel first, working your way up the panel to the top.

Installation completed

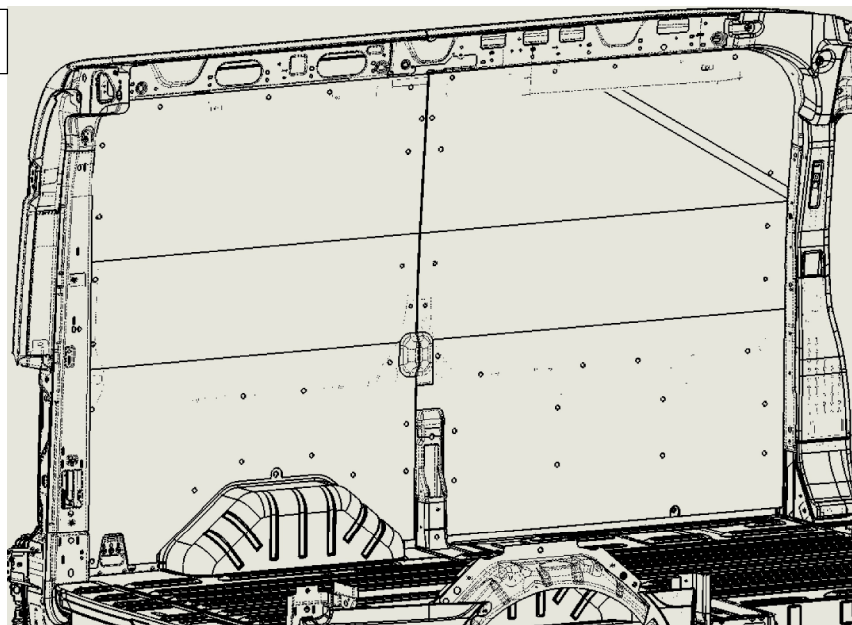

Back Door Wall Liner Installation

ITEM 16
UPPER DOOR
PASSENGER SIDE
PANEL

ITEM 15
UPPER DOOR
DRIVERS SIDE
PANEL

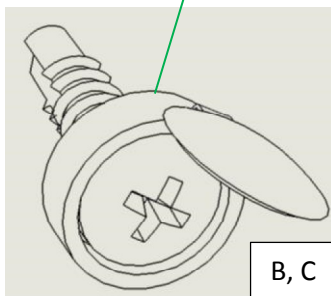
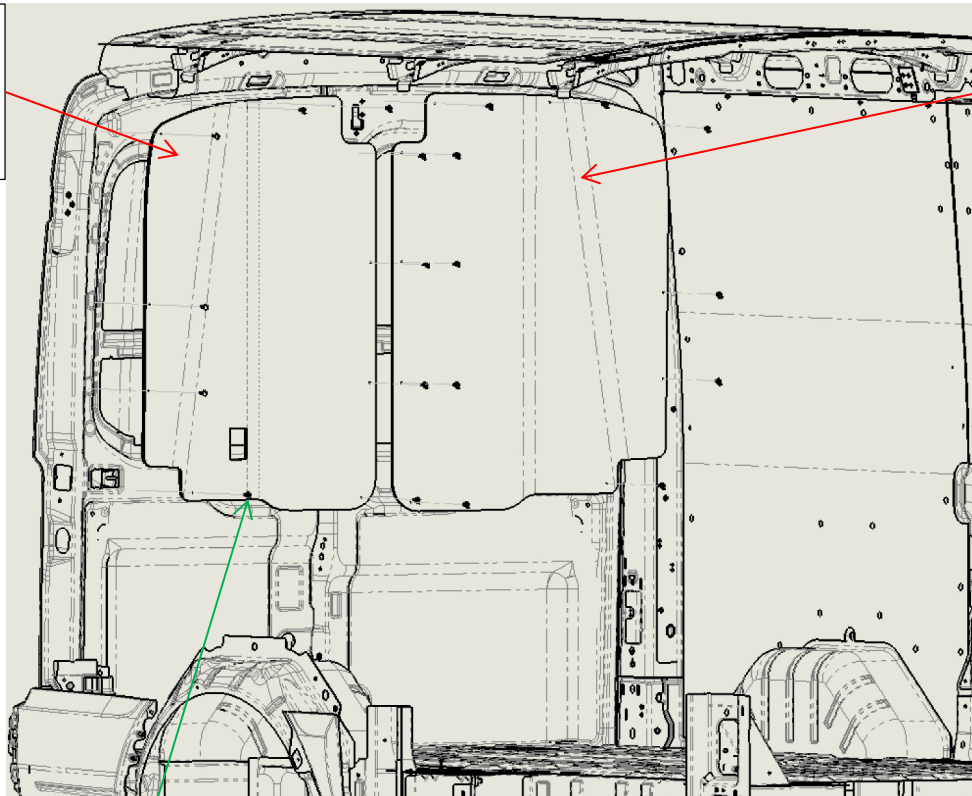

3: Install Item 15 and 16, Upper door panels,

- Align the Upper panels with the upper door contours as well as with the door lock opening.
- Install hardware (B, C), in the holes provided, on the top of the panel first, working your way down the panel to the bottom.

Installation completed

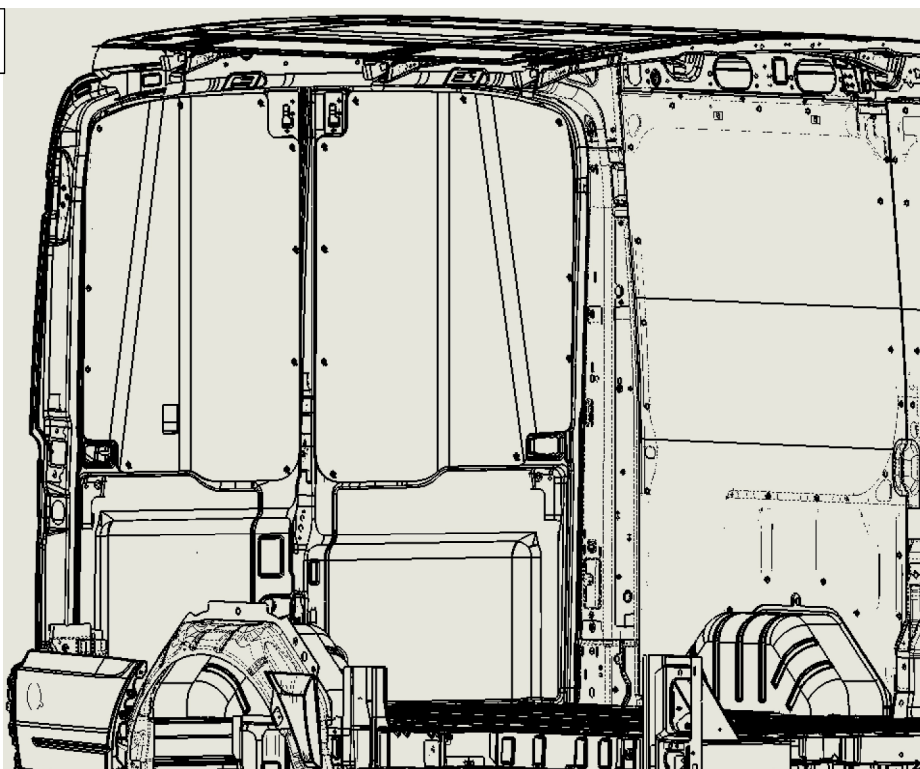

Passenger Side Wall Liner Installation

ITEM 17
SLIDING DOOR
TOP PANEL

B, C

A

FRONT

REAR

A

ITEM 3
REAR PASSENGER
SIDE PANEL

ITEM 18
SLIDING DOOR
BOTTOM PANEL

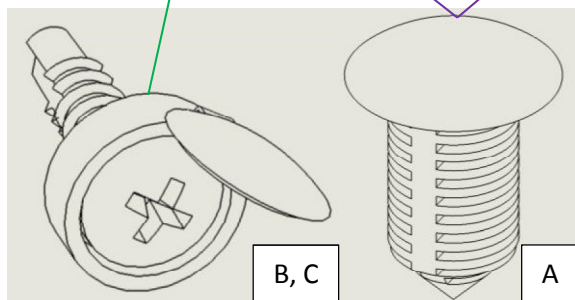

Installation completed

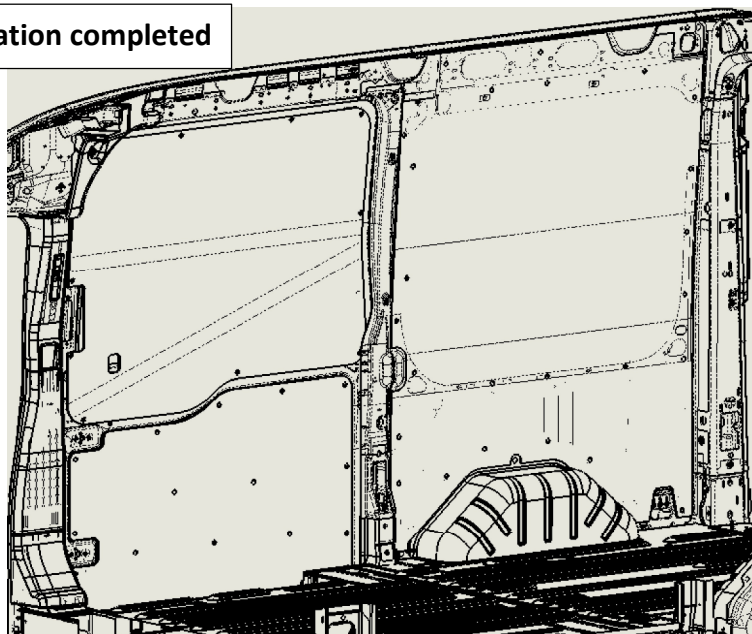

4: Install Item 3, Rear Passenger Side Panel.

- Align wheel well edge of the panel with the feature on the vehicle; position the contour of the panel to the vehicle wall.
- Install hardware (A), in the holes provided, on the bottom of the panel first, working your way up the panel to the top.
- Install hardware (A), in the holes provided.

5: Install Item 18, Bottom Sliding Door Panel.

First remove OEM bottom panel.

- Note: Sliding door must be closed to install panel;
- Insert panel into the sliding door sill cavity, align holes at the bottom half of the panel to the one on the door and insert hardware (A) in all of the holes.
- Install Item 17, Top Sliding Door Panel with hardware (B, C) in the holes provided, align the panel with the door seal leaving an equal space between the door seal and the panel, make sure the door lock opening is aligned with the door lock.